



STEEDA

2020+ Explorer ST Intercooler 555-3623

Instructions

Tools Needed:

1. 7mm socket
2. 10mm socket
3. 13mm socket
4. Torx 30
5. ¾" wrench

Removal of Factory Intercooler:

1. Disconnect the (-) negative cable from the battery and remove the front inner fender from the front fascia and lower bumper cover by removing the 15 screws using 7mm socket. See Figure 1.
2. Remove the fender trim from the front fenders and disconnect the two proximity sensors and remove the 7mm bolts under the sensors. Remove the two bolts which hold the bumper cover to front fender by using a 10mm socket. See Figure 2.
3. Remove the 4 screws from the front upper grill using 10mm socket. See Figure 2.
4. Unplug the front camera and disconnect line, 4-way connector, headlight harness and TMAP sensor connector from intercooler on the passenger side.
5. Disconnect both electrical connectors on the driver side inner fender and the one on the radiator support.
6. Release the grill and remove from the vehicle, also remove the both front headlights by unscrew the 10mm bolts. See Figure 3.

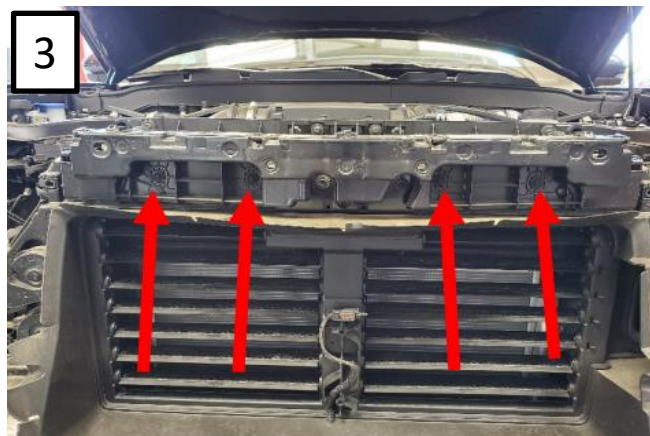
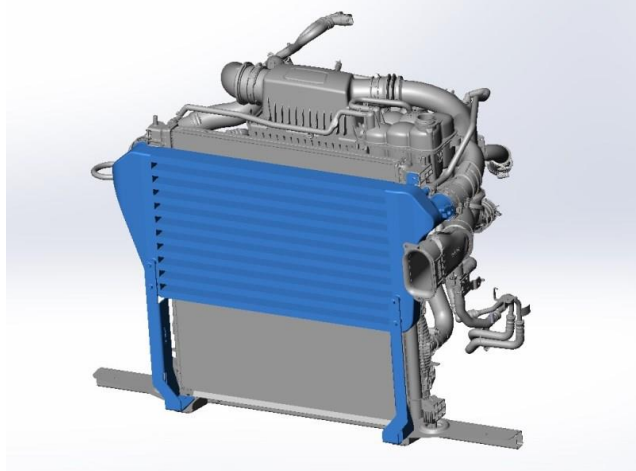

7. Unclip the hood release prop rod. Remove the 8 bolts holding the bumper crash bar by using a 13mm socket.
8. Remove the 10mm bolts from lower bumper supports. **Note: some Explorers come with rivets instead of bolts in this lower position. Drill the head off the factory rivets to remove. Reinstall with provided rivets, this will require the use on rivet gun designed for use with 3/16" rivets.**
9. Cut the factory zip-ties and remove the upper shroud using 8mm socket.
10. Disconnect the hose from the stock intercooler outlet tank and disconnect TMAP sensor. See Figure 4.
11. Loosen the intercooler clamps from the inlet and outlet connection hoses and remove the bolt from the intercooler mount flange. Remove the factory intercooler from the vehicle. See Figure 5.

Installation of Steeda intercooler:

1. Transfer the TMAP sensor to the Steeda intercooler outlet tank using Torx 30. See Figure 6
2. Apply the thread sealant to the provided 1/4" NPT to quick connect fitting and install it to the Steeda intercooler using 3/4" wrench. See Figure 6.
3. Install the provided mounting bracket to Steeda IC using 6mm bolts. Apply a light amount of blue Loctite to threads before install.
4. Mount the provided support bracket to Steeda IC and install to the vehicle. Secure the upper driver side bracket with factory bolt and connect the hoses to the inlet and outlet points using factory clamps.
5. Secure the provided support bracket to the Steeda IC using the four 6mm supplied bolts. See Figure 7.
6. Repeat the procedure by replacing the 4 zip-ties which was cut while removing the stock intercooler shroud.
7. Reassemble the vehicles front grill, belly panels and fascia in reverse order.

