

## ***advanced FLOW engineering***

### **Instruction Manual** P/N: 56-70062DR

Make: Honda  
Make: Acura

Model: Civic Type R  
Model: Integra Type S

Year: 2023-2024  
Year: 2024-2024

Engine: L4-2.0L(t)  
Engine: L4-2.0L(t)

Cold Air Intake System



- Please read the entire instruction manual before proceeding.
- Ensure all components listed are present.
- If you are missing any of the components, call customer support at 951-493-7185.
- Ensure you have all necessary tools before proceeding.
- Do not attempt to work on your vehicle when the engine is hot.
- Retain factory parts for future use.

| Label | Qty. | Description  | Part Number  |
|-------|------|--|--------------|
| A     | 1    | Air Filter (Pro DRY S) For 56-70062D or 56-70062DR | 21-91103     |
| B     | 1    | Tube   | 05-5670062R1 |
| C     | 1    | Housing  | 05-5670062R2 |
| D     | 2    | Screw, M4 x 10mm                                   | 03-50490     |
| E     | 1    | Alcohol Wipes, (Single-Use Packet)                 | 05-01716     |
| F     | 2    | Clip, Harness Holder                               | 05-01760     |
| G     | 1    | Gasket   | 05-01782     |
| H     | 1    | Extension Harness: MAF sensor                      | 05-70045     |

**Installation will require the following tools:**

Socket Set, Torx Set, Extensions, Ratchet wrench, Pliers, Screwdriver Set, Trim Removal Tool

Warranty Information available at: <https://afepower.com/contact#warranty>

**Emissions Disclaimer:** This product is not currently CARB exempt and is not available for purchase in California or for use on any vehicle registered with the California Department of Motor Vehicles.

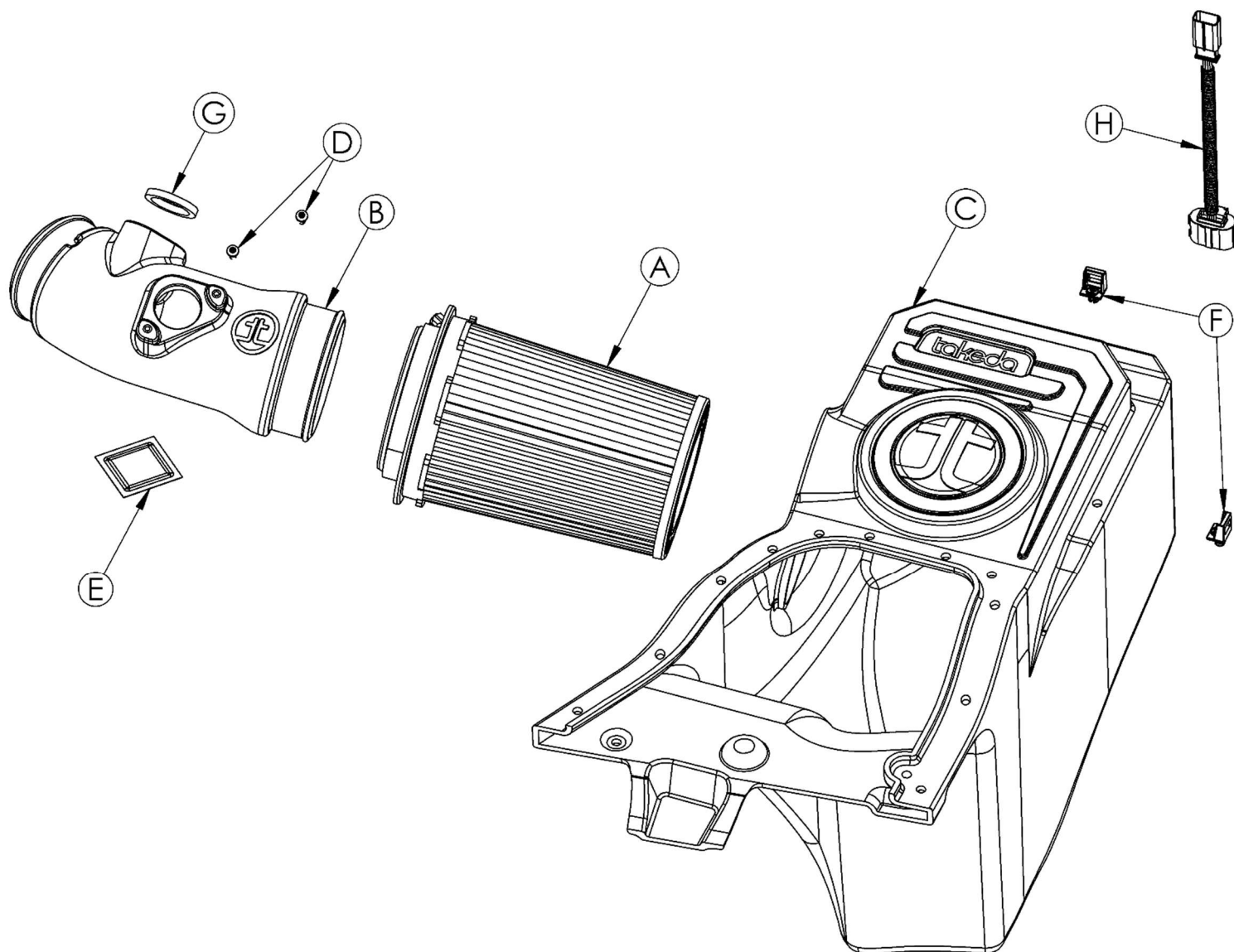





### **Refer to Figure A for Steps 1-2**

Step 1: Disconnect the (MAF) Mass Air Flow sensor connector.

Step 2: Unclip (MAF) Mass Air Flow sensor harness from the housing.



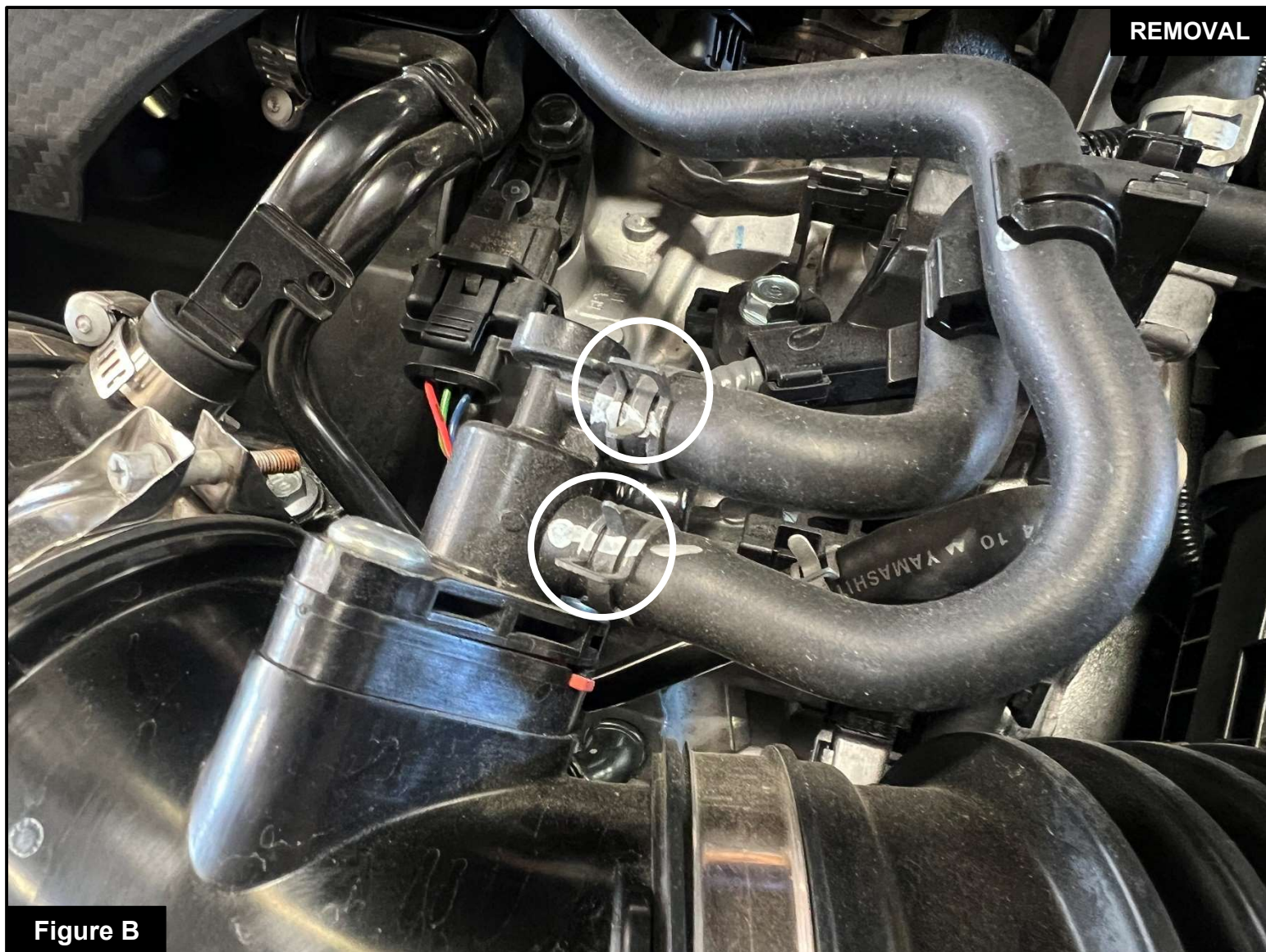

### **Refer to Figure B for Step 3**

Step 3: Use pliers to slide back hose clamps on jet purge assembly and carefully remove hoses.





**Refer to Figure C for Step 4**

Step 4: Use a pry tool or flat head screwdriver to remove battery harness from the back of the housing.



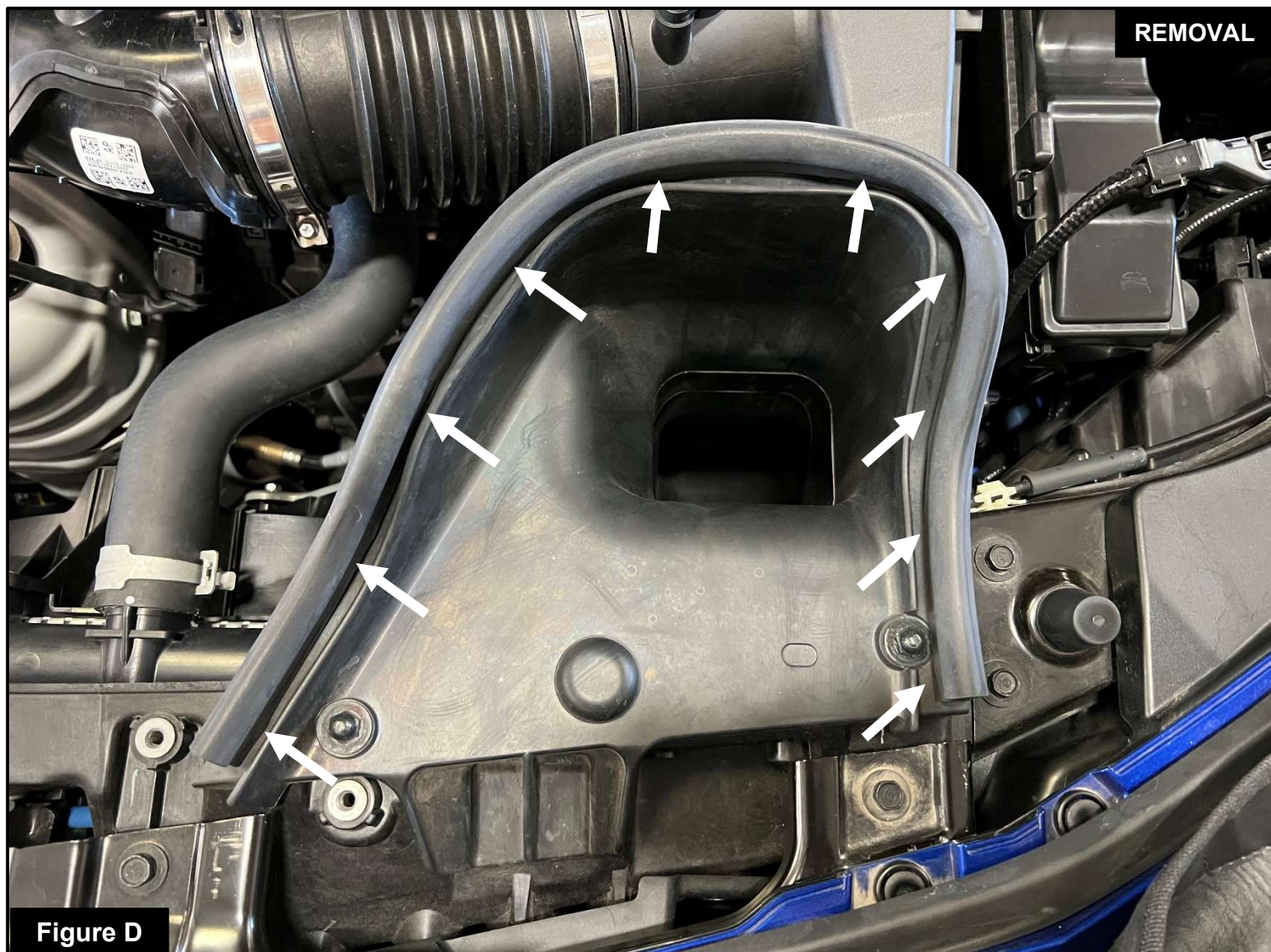
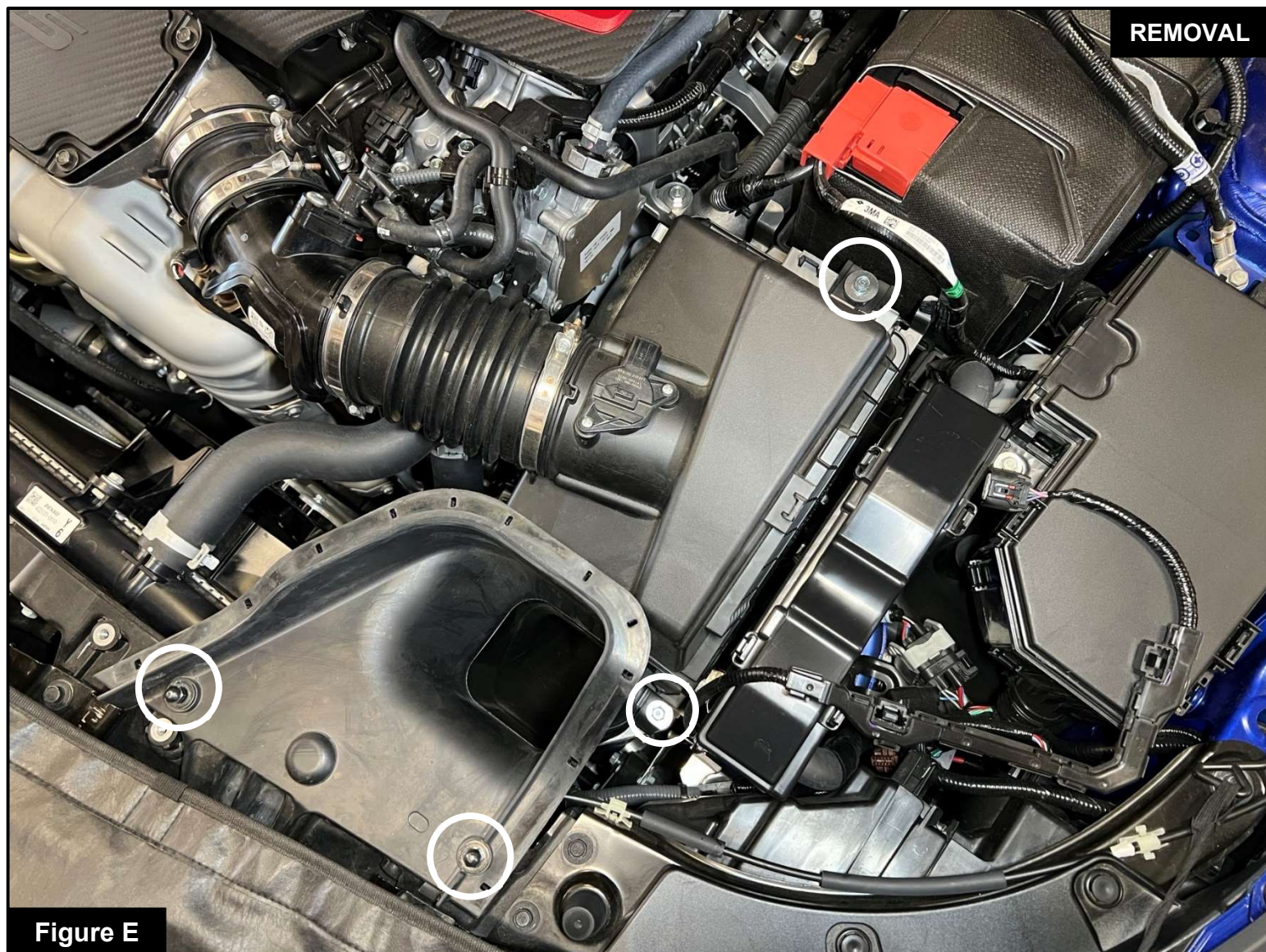

**Figure D**

### **Refer to Figure D for Step 5**

Step 5: Use a pry tool to carefully remove factory trim seal. Trim seal will be used for the TAKEDA installation.





**Figure E**

### **Refer to Figure E for Steps 6-8**

Step 6: Use a 10mm driver or ratchet wrench with a long extension to fully loosen the screw at the bottom of housing (this screw does not come out).

Step 7: Remove screw located at the back of the housing, near the battery.

Step 8: Remove 2 screws located at the front of the housing, near the front of the vehicle. Screws will be used later in the installation.





**Refer to Figure F for Step 9**

Step 9: Use a 5.5mm driver or ratchet wrench to loosen hose clamp on intake tube. Do not remove hose clamp.



**Refer to Figure G for Step 10**

Step 10: Pull out tube from coupler and remove entire factory airbox out of the vehicle.



**Figure H****Refer to Figure H for Step 11**

Step 11: Use a T-30 Torx to remove the factory screws and jet purge assembly from factory tube. Jet purge assembly and factory screws will be used later in the installation.



REMOVAL

Figure I

## **Refer to Figure I for Step 12**

Step 12: Remove the factory grommet from the bottom of the factory housing. Grommet will be used later in the installation.



**Figure J**

### **Refer to Figure J for Steps 13-14**

Step 13: Remove the factory grommet located towards the back of the housing. Grommet will be used later in the installation.

Step 14: Use a Phillips screwdriver to remove the MAF sensor from the factory tube. Grommet will be used later in the installation.



**Figure K**

### **Refer to Figure K for Step 15**

Step 15: Use the alcohol wipe provided in the kit to clean the gasket groove on the TAKEDA intake tube, then remove the white film from the foam gasket and apply the sticky side of gasket into the groove.



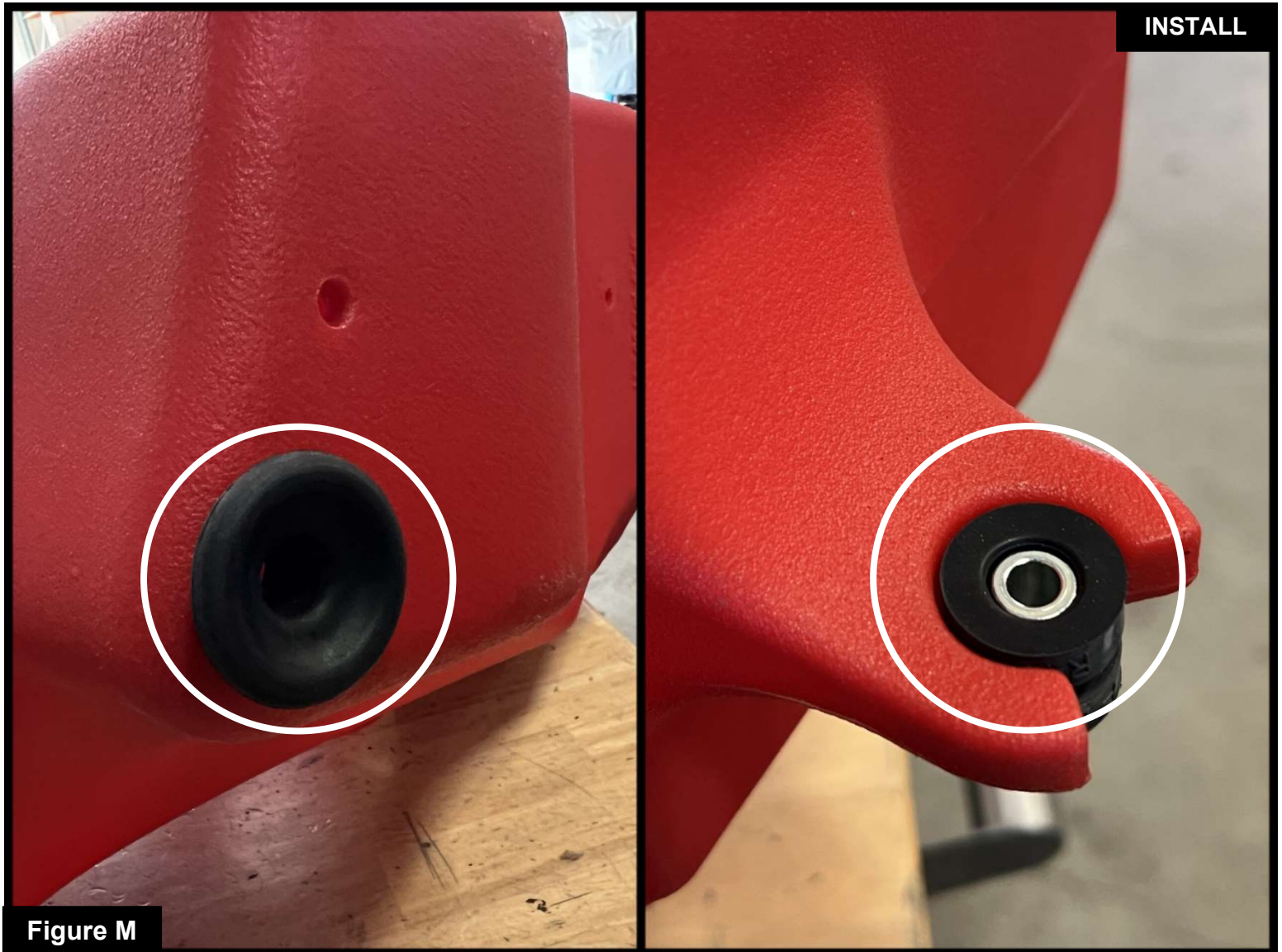

**Figure L**

### **Refer to Figure L for Steps 16-17**

Step 16: Install the factory MAF sensor onto the TAKEDA intake tube using the provided black T-20 Torx M4 screws

Step 17: Install the factory jet purge assembly in the position shown using the factory T-30 Torx screws that were removed in Step 11.



**Figure M**

**Refer to Figure M for Step 18**

Step 18: Install the factory grommets on the TAKEDA housing, that were removed on Step 12 &13.





**Figure N**

**Refer to Figure N for Step 19**

Step 19: Install the TAKEDA housing into the vehicle.





Figure O

### Refer to Figure O for Steps 20-21

Step 20: Install the factory trim seal that was removed in Step 5.

Step 21: Install the aFe POWER air filter into the TAKEDA housing by firmly pushing it into the housing until the filter tabs lock it into place. Do not tighten hose clamp at this time.





Figure P

## Refer to Figure P for Step 22

Step 22: Install the TAKEDA tube in the correct position. Do not tighten the clamps at this time.





**Figure Q**

## **Refer to Figure Q for Step 23**

Step 23: Use a 10mm driver or ratchet wrench to install the back screw and the 2 front screws.





**Refer to Figure R for Step 24**

Step 24: Use pliers to install the jet purge assembly hoses and hose clamps.





Figure S

**Refer to Figure S for Steps 25-26**

Step 25: Connect the Mass Air Flow (MAF) sensor extension to the MAF sensor.

Step 26: Install TAKEDA harness holder clips.





INSTALL

Figure T

## **Refer to Figure T for Step 27**

Step 27: Install harness onto TAKEDA harness holder clips and connect the MAF sensor harness to the MAF sensor extension harness.



**Figure U**

### **Refer to Figure U for Steps 28-29**

Step 28: Use a 8mm driver or rachet wrench to tighten the hose clamp between tube and filter.

Step 29: Use a 5.5mm driver or rachet wrench to tighten factory hose clamp to the TAKEDA tube.





**Your installation is now complete. Thank you for choosing Takeda USA!**

**NOTE: Check to ensure that all screws, clamps, and connectors are secure after 100-200 miles.**



PAGE LEFT BLANK INTENTIONALLY





PAGE LEFT BLANK INTENTIONALLY



***advanced FLOW engineering, inc.***

Corona, CA 92879

<https://afepower.com/contact>