

CRAWLTEK

REVOLUTION

491 W. GARFIELD AVE., COLDWATER, MI 49036 • 517.278.1039
CRAWLTEKREVOLUTION.COM • E-MAIL: TECH-CRAWLTEK@RIDEFOX.COM

INSTALLATION INSTRUCTIONS

BRONCO TIRE RELOCATION KIT

CWLFB38011

FOR USE WITH ALL
FORD BRONCO MODELS FROM 2021-2023

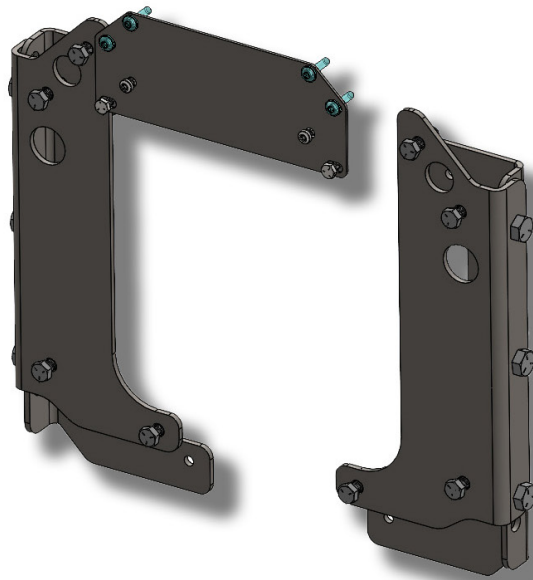

CrawTek YouTube

PLEASE READ THROUGH INSTRUCTIONS BEFORE INSTALLING

2023-10-17

WHAT'S IN THE BOX?

PLEASE VERIFY KIT CONTENTS BEFORE BEGINNING INSTALLATION

PART #	Qty	DESCRIPTION
06300	1	BRONCO ADJUSTABLE SPARE TIRE RELOCATION BRKT - VEHICLE MOUNT - DS
06301	1	BRONCO ADJUSTABLE SPARE TIRE RELOCATION BRKT - VEHICLE MOUNT - PS
06302	1	BRONCO ADJUSTABLE SPARE TIRE RELOCATION BRKT - TIRE BRKT MOUNT - DS
06303	1	BRONCO ADJUSTABLE SPARE TIRE RELOCATION BRKT - TIRE BRKT MOUNT - PS
06304	1	BRONCO SPARE TIRE 3RD BRAKE LIGHT RELOCATION BRKT
C0056		BOLT PACK
	6	1/2"-13 X 1-1/4" BOLT - GRADE 5 - CLEAR ZINC
	6	1/2" SAE WASHER - CLEAR ZINC
	6	1/2"-13 SERRATED EDGE FLANGED NUT - CLEAR ZINC
	8	3/8"-16 X 1-1/4" BOLT - GRADE 5 - CLEAR ZINC
	8	3/8" SAE WASHER - CLEAR ZINC
	8	3/8"-16 SERRATED EDGE FLANGED NUT - CLEAR ZINC
	2	1/4"-20 X 3/4" HHCS ZINC
	2	1/4" SAE WASHER ZINC
	2	1/4"-20 SERRATED FLANGE LOCKNUT ZINC
	2	M6 X 14MM THREAD FORMING SCREWS FOR THIN PLASTIC

TOOLS REQUIRED

SAFETY GLASSES

RATCHET

ASSORTED SOCKETS AND/OR WRENCHES

TORX HEAD DRIVERS

TRIM TOOL



REAR TIRE MOUNT LOCATION KIT

STEP 1:

REMOVE TIRE FROM REAR TAILGATE MOUNT. **FIG. 1**



FIGURE 1

STEP 2:

REMOVE THE SCREWS RETAINING THE LIGHT ASSEMBLY TO THE TIRE MOUNT. **FIG. 2**

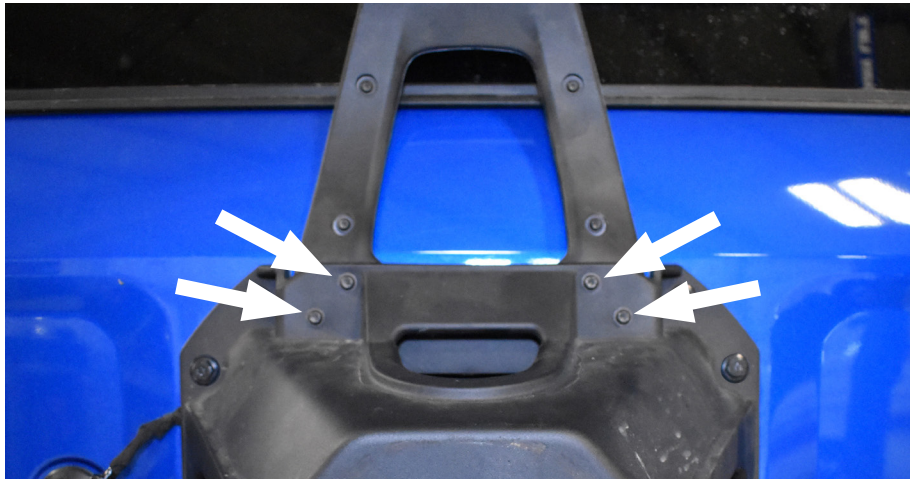

FIGURE 2



STEP 3:

REMOVE LIGHT ASSEMBLY, UNCLIP WIRING FROM ASSEMBLY. THIS IS NECESSARY TO NOT INTERFERE WITH THE INSTALLATION OF THE EXTENSION PLATE. **FIG. 3**



FIGURE 3

STEP 4:

INSTALL NEW EXTENSION PLATE RE-USING THE 4 FACTORY TORX BOLTS. **FIG. 4**

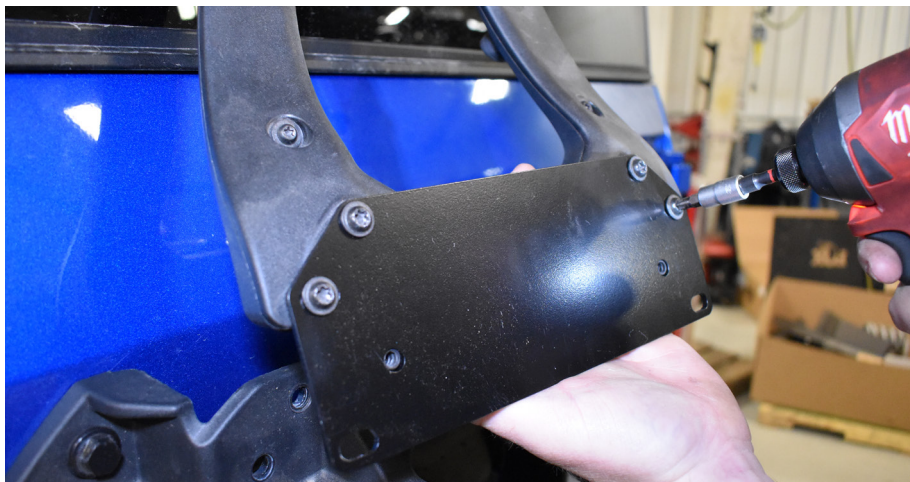

FIGURE 4



STEP 5:

RE-ATTACH LIGHT ASSEMBLY TO TIRE MOUNT ASSEMBLY USING PROVIDED COURSE THREAD BOLTS IN THE TOP 2 HOLES. USE THE PROVIDED BOLTS, WASHERS AND NUTS IN THE 2 BOTTOM HOLES. **FIG. 5**



FIGURE 5

STEP 6:

REMOVE THE 8 BOLTS TO UNBOLT THE TIRE MOUNT ASSEMBLY FROM THE TAILGATE. RETAIN ALL HARDWARE FOR LATER USE. CAREFULLY ALLOW THE ASSEMBLY TO HANG BY THE WIRING. **FIG. 6, 7**

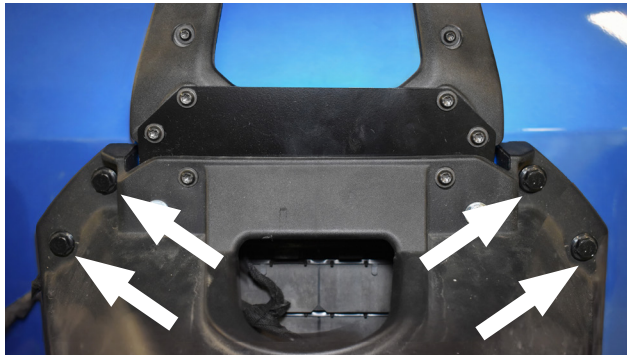

FIGURE 6

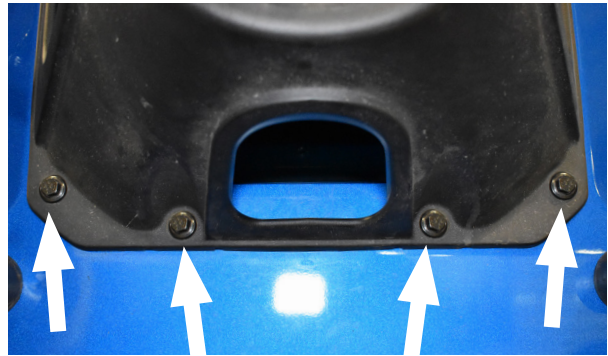

FIGURE 7

STEP 7:

INSTALL THE NEW INNER BRACKETS TO THE TAILGATE USING THE FACTORY HARDWARE. **FIG. 8**

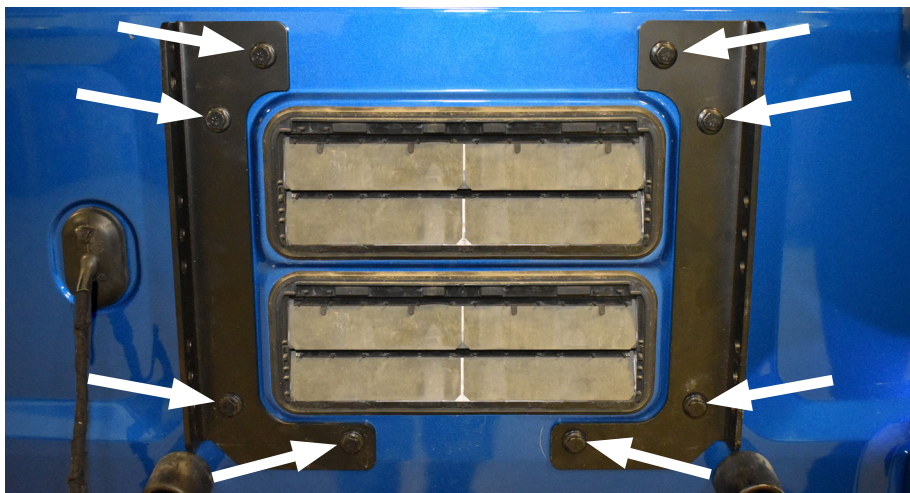

FIGURE 8



STEP 8:

INSTALL THE OUTER BRACKETS TO THE INNER BRACKETS USING THE 3 PROVIDED BOLTS. DETERMINE THE CORRECT HEIGHT FOR YOUR WHEEL MOUNT TO ALLOW FOR CLEARANCE OF BUMPER. THE LARGER THE WHEEL TIRE COMBINATION, THE HIGHER THE HOLES WILL NEED TO BE USED. **FIG. 9, 10**



FIGURE 9

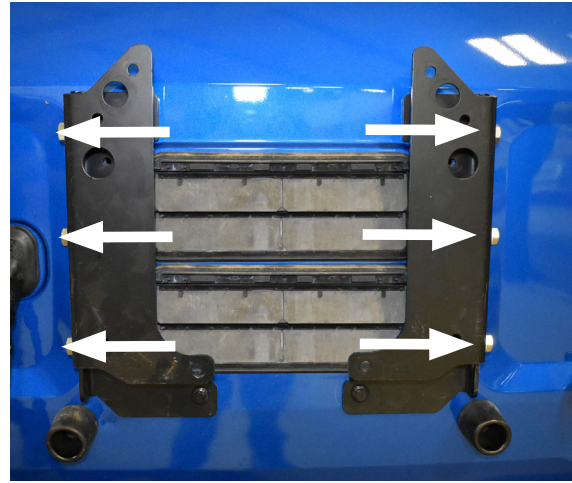

FIGURE 10

STEP 9:

INSTALL FACTORY WHEEL MOUNT TO THE OUTER BRACKET USING PROVIDED HARDWARE. **FIG. 11**

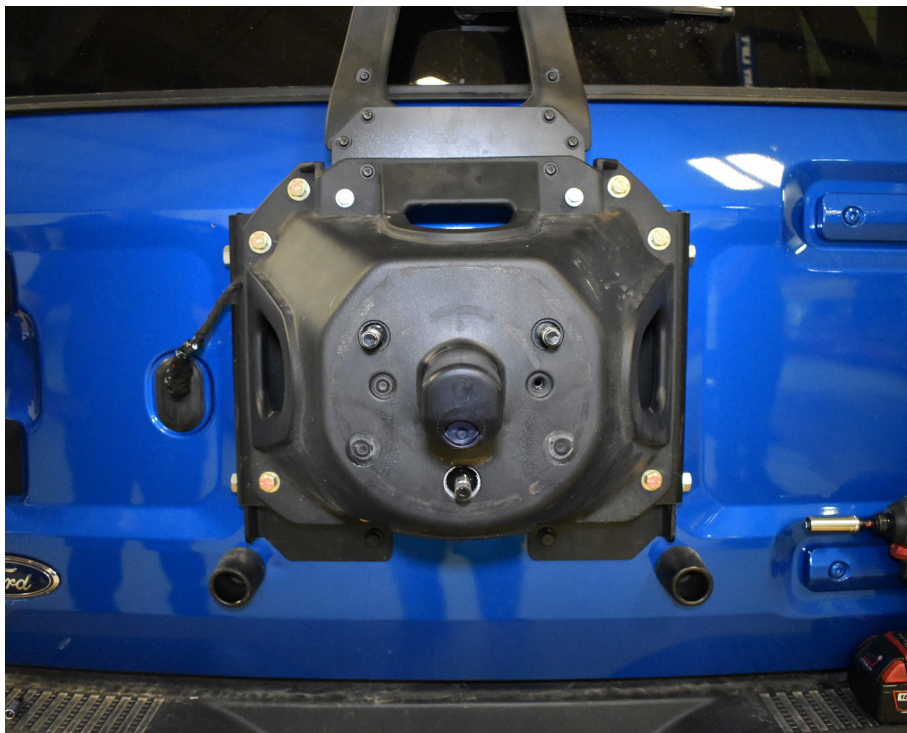

FIGURE 11



STEP 10:

TEST FIT WHEEL AND TIRE TO THE TIRE MOUNT AND CHECK FOR CLEARANCE. REMOVE TIRE AND MAKE ADJUSTMENTS IF NEEDED.



YOU'RE NOT DONE YET!

Thank you for your new CrawlTek Revolution purchase! Follow us on facebook for up to date coverage of new product releases. We love feedback, if you have any questions about the installation or parts were missing please contact us at sales-crawltek@ridefox.com or call us at 517.278.1039.

*Be sure to show off your jeep to the rest of the CrawlTek Revolution online.
Find us on facebook and instagram to keep up on new products, upcoming events and more action.
Tag us @crawltek for a chance to get featured*

