

***advanced FLOW engineering***  
**Instruction Manual** P/N: 46-33026N

Silver Bullet Throttle Body Spacer

Make: **FORD** Model: **Mustang GT**  
Make: **FORD** Model: **Mustang Dark Horse**

Year: **2024-2024** Engine: **V8-5.0L NA**  
Year: **2024-2024** Engine: **V8-5.0L NA**



- Please read the entire instruction manual before proceeding.
- Ensure all components listed are present.
- For technical support please call 951-493-7185.
- Ensure you have all necessary tools before proceeding.
- Do not attempt to work on your vehicle when the engine is hot.
- Retain factory parts for future use.

Label	Qty.	Description	Part Number
A	2	Silver Bullet Throttle Body Spacer	R46-33026N
B	2	TBS Gaskets	05-01631
C	8	Screw, Hex Head: M6 x 1 x 60mm	03-50674
D	8	Washers, Lock: M6	03-50071
E	8	Washers, Flat: M6	03-50177

**Installation will require the following tools:**

Flathead screwdriver, 7mm Nut Driver, Panel Popper Tool, 8mm & 10mm sockets and driver.

Warranty Information available at <https://afepower.com/contact#warranty>

**Emissions Disclaimer:** This product is not currently CARB exempt and is not available for purchase in California or for use on any vehicle registered with the California Department of Motor Vehicles.

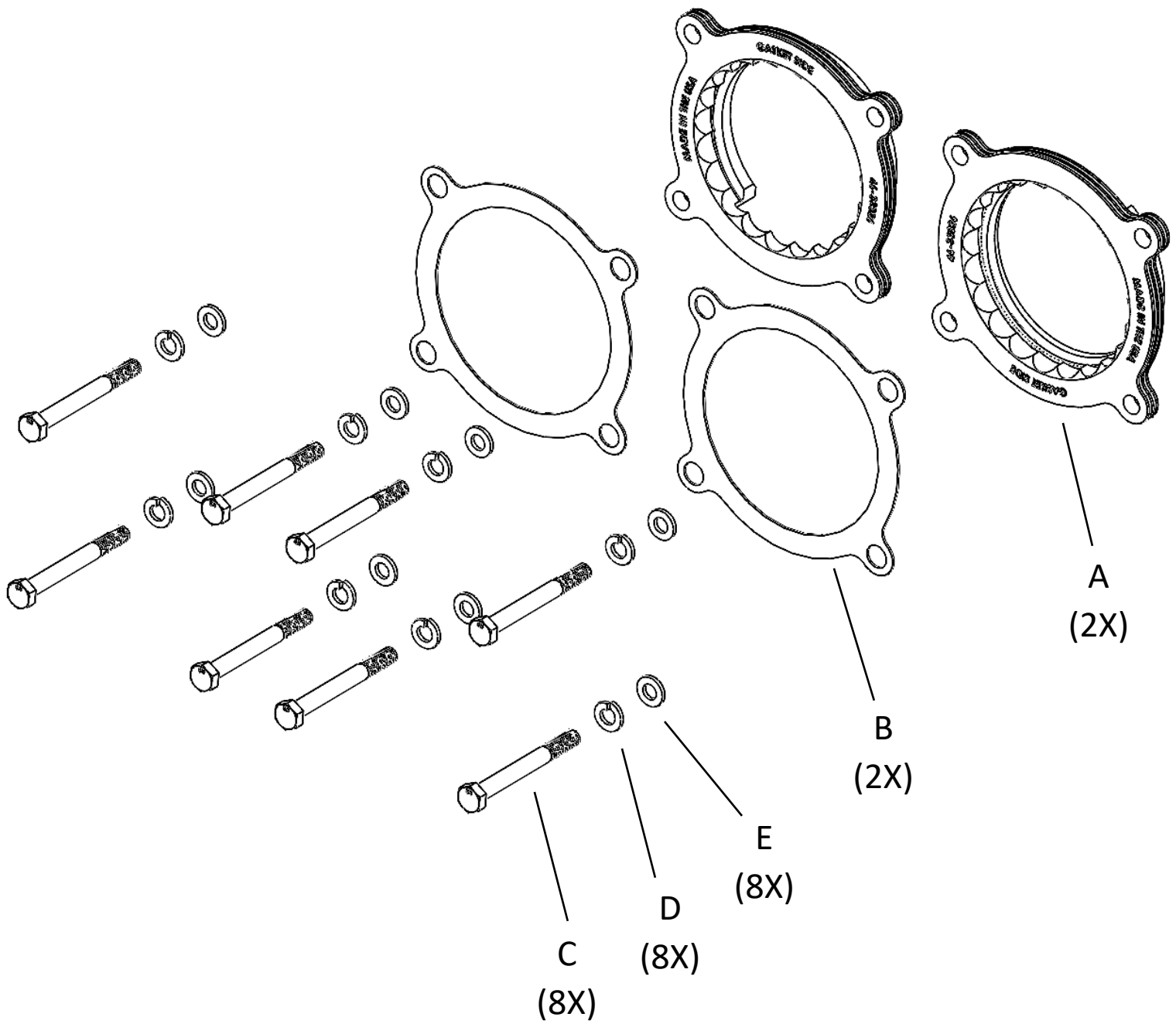



### **Refer to Figure A for Step 1**

Step 1: Remove the factory air intake covers on both the driver side and passenger side intakes by unclipping the covers from the front and lifting them out of the vehicle ①.



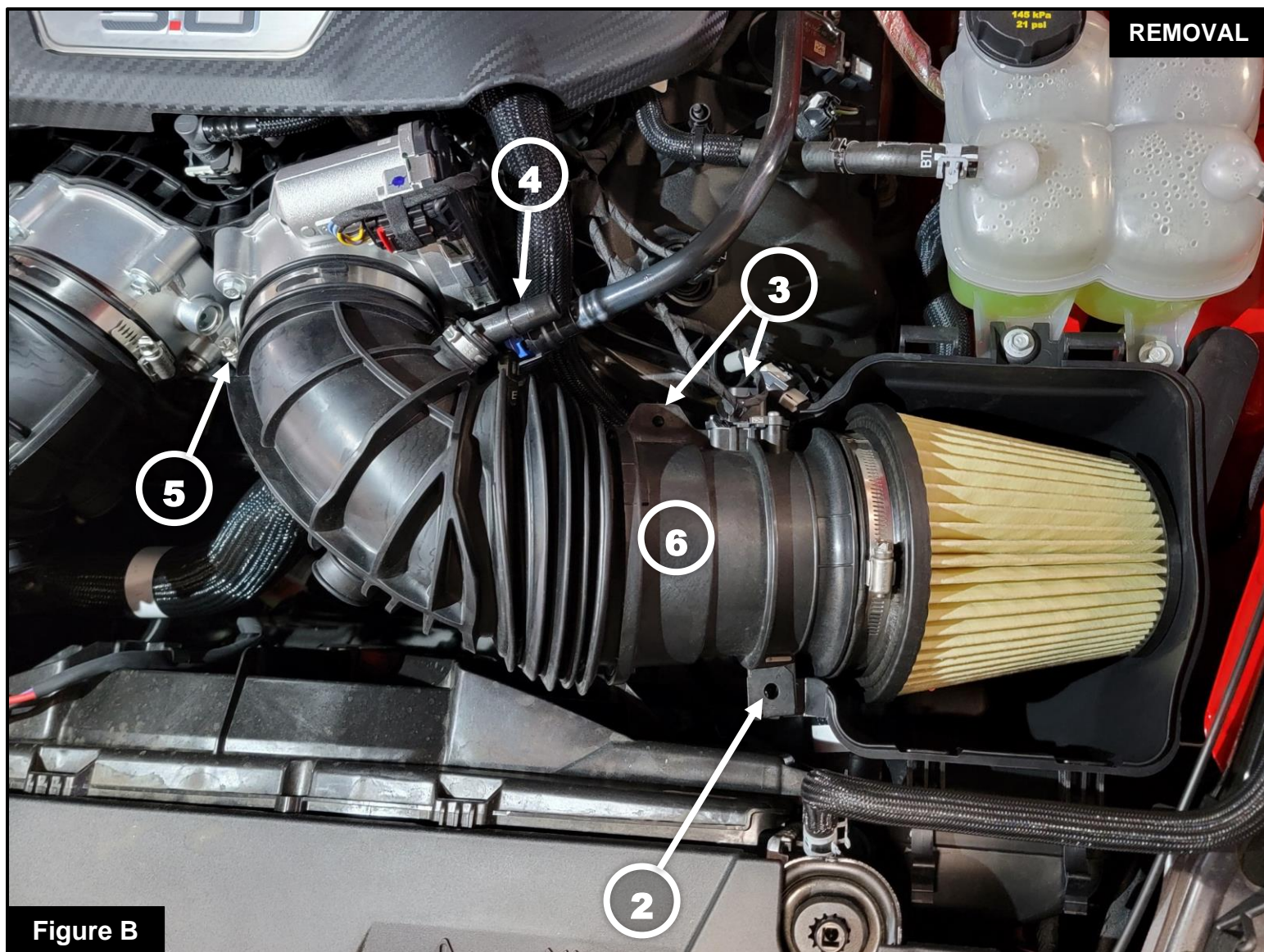

Figure B

## **Refer to Figure B for Steps 2-6**

- Step 2: Using a 10mm socket and driver, remove the screw ② securing the intake tube to the intake housing on the driver side.
- Step 3: Disconnect the wire harness from the Mass Air Flow (MAF) sensor and from the intake tube on the driver side ③.
- Step 4: Disconnect the Crank Case Ventilation (CCV) line from the intake tube on the driver side by pressing down on the push button and sliding the hose backwards ④.
- Step 5: Using a 7mm nut driver or flathead screwdriver, loosen the clamp at the driver side throttle body ⑤.
- Step 6: Remove the driver side intake tube from the vehicle to gain access to the throttle body ⑥.



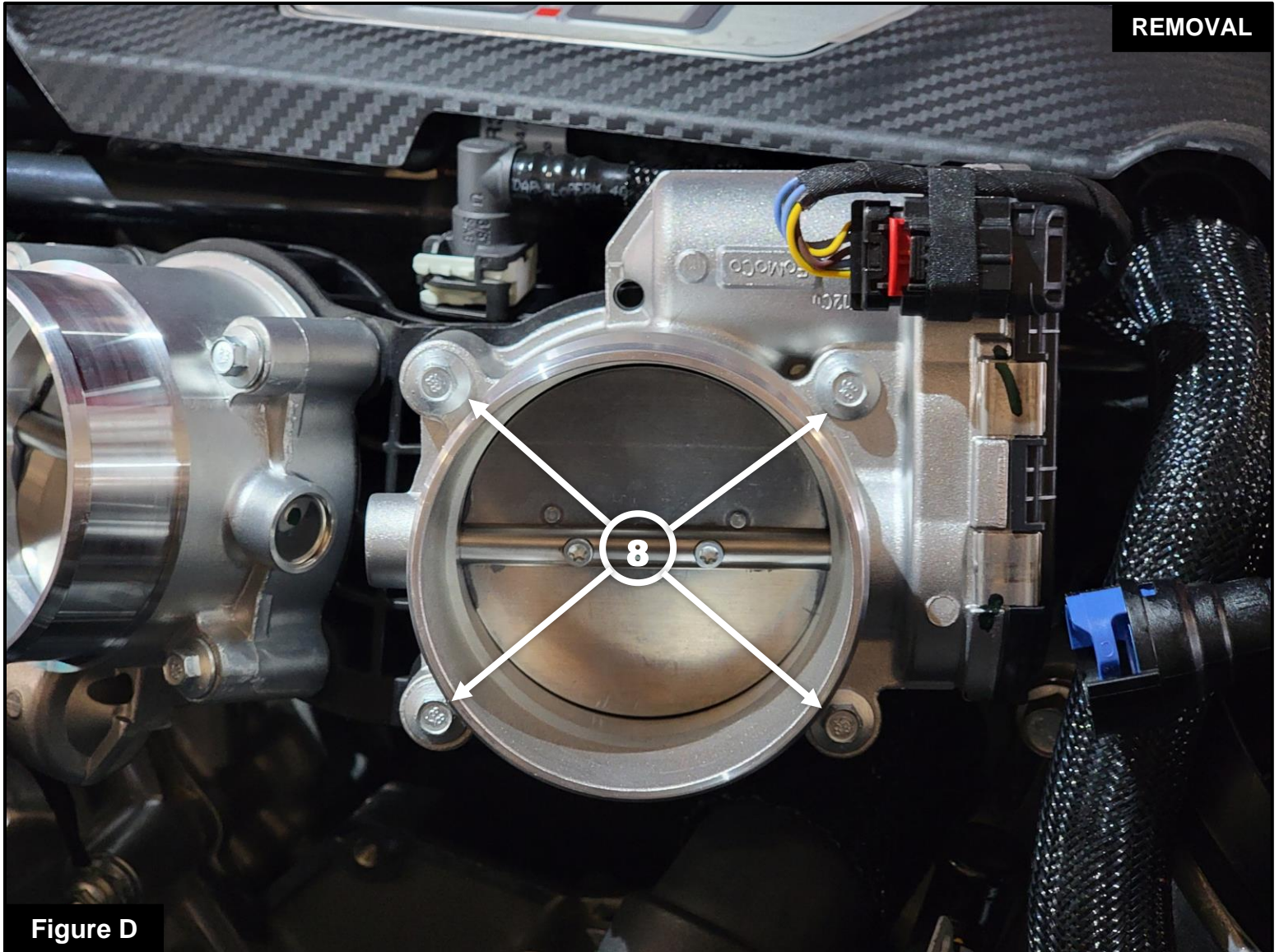

Figure C

### Refer to Figure C for Step 7

Step 7: Repeat Steps 2-6 on the passanger side and remove the passanger side tube from the vehicle (7).





**Figure D**

### **Refer to Figure D for Step 8**

Step 8: Using an 8mm socket and driver, remove the four (4) screws from the driver side throttle body (8). You do not have to unplug the electrical connector from the throttle body. Move the throttle body to the side to gain access to the intake manifold.

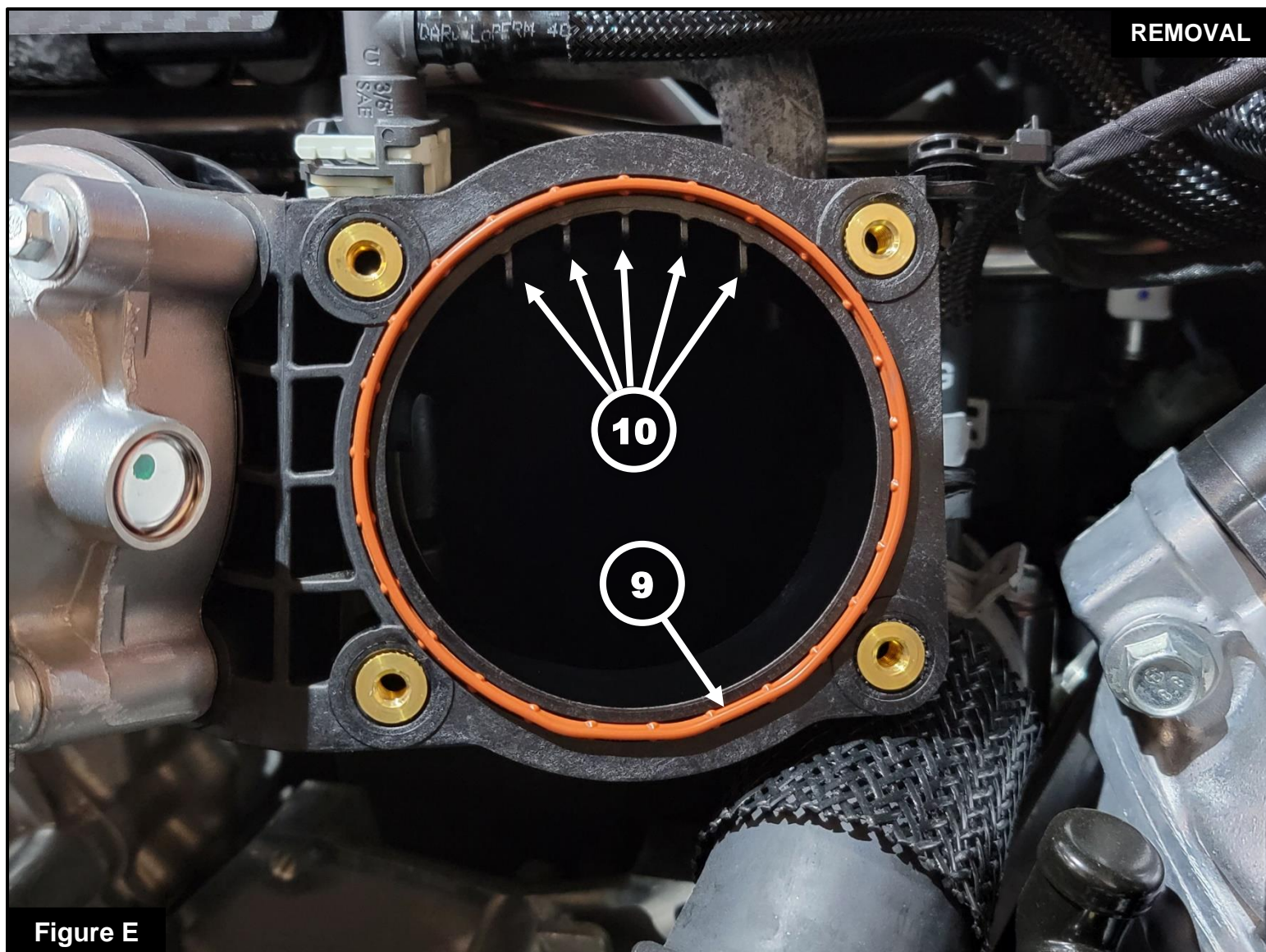

Figure E

### **Refer to Figure E for Steps 9-10**

Step 9: Ensure that the factory O-Ring is in place and is in good condition (9).

Step 10: Note the position of the fins on the inside of the intake manifold (10). The driver side inlet will have fins at the top of the intake manifold and the passenger side will have fins at the bottom of the intake manifold. This is important for the correct clocking of the Silver Bullet Throttle Body Spacer.



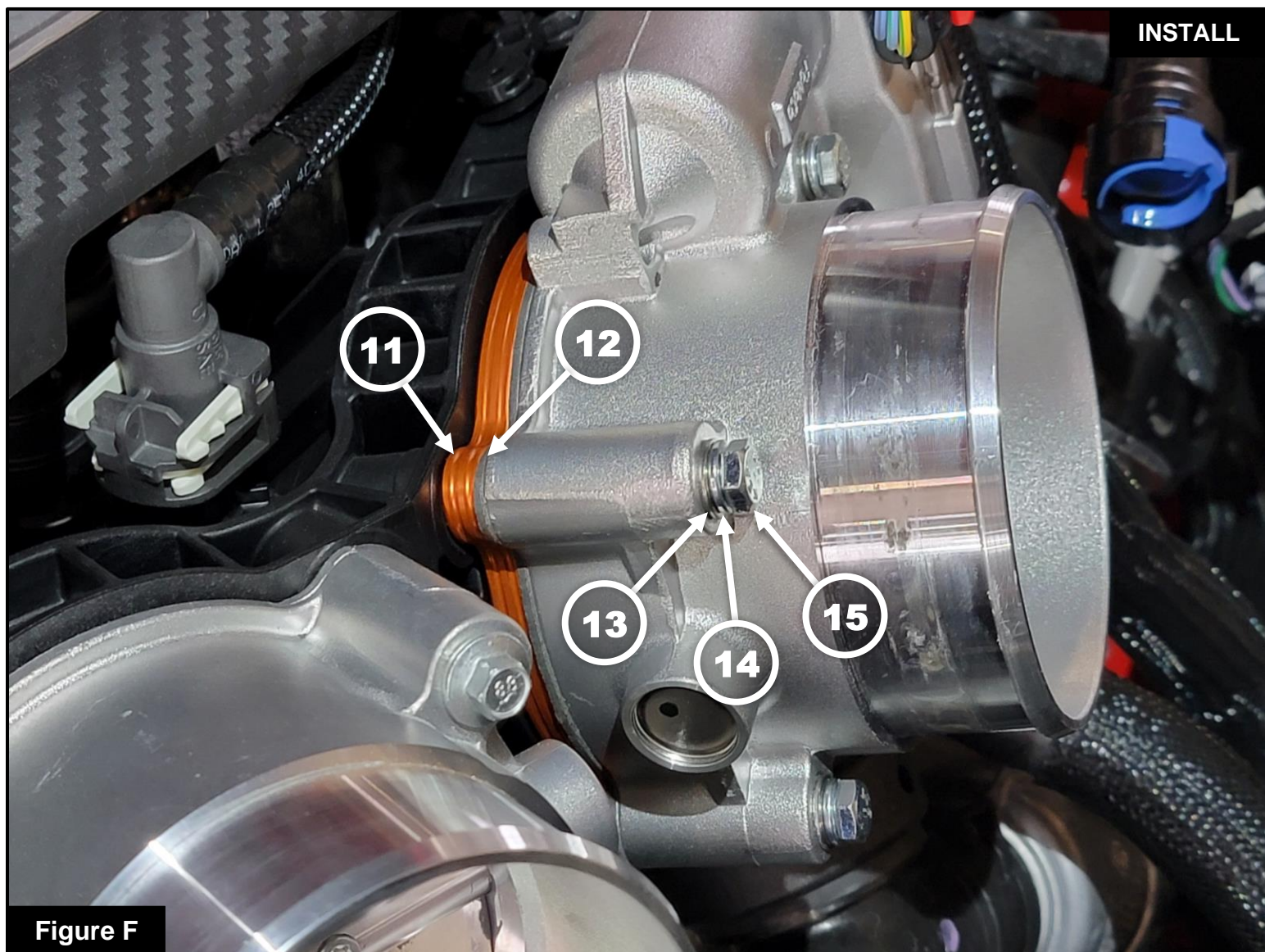

**Figure F**

### **Refer to Figure F for Steps 11-13**

Step 11: Install the Silver Bullet Throttle Body Spacer (11) into the intake manifold with the notch on the spacer facing the fins identified in the previous step.

Step 12: Place a gasket (12) on top of the Silver Bullet Throttle Body Spacer and then place the throttle body back into position.

Step 13: Secure the throttle body and Silver Bullet Throttle Body Spacer with the provided hardware. Place the flat washer (13) against the face of the throttle body, then place the lock washer (14) between the flat washer and the head of the bolt (15). Using a 10mm socket and driver, tighten the screws in a crisscross fashion to the factory specifications.





Figure G

## **Refer to Figure G for Steps 14-15**

Step 14: Repeat Steps 8-13 to install the Silver Bullet Throttle Body Spacer onto the passenger side.

Step 15: Note the position of the fins inside the intake manifold before installing the spacer as it is not the same orientation as the driver side.



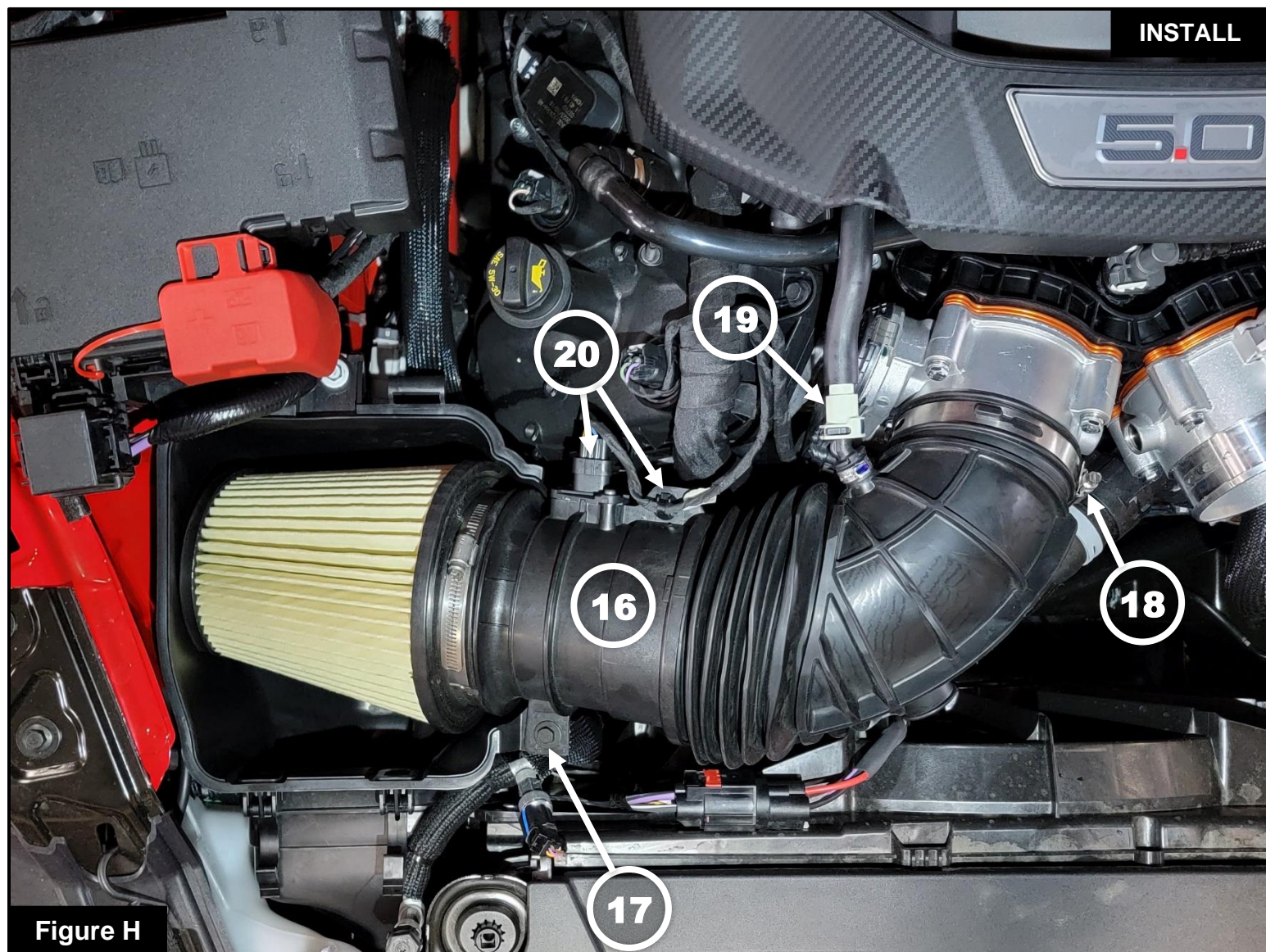

**Figure H**

## **Refer to Figure H for Steps 16-20**

Step 16: Reinstall the intake tube on the passanger side (16).

Step 17: Secure the tube to the intake housing with the factory bolt (17), and tighten to factory spec using a 10mm socket and driver.

Step 18: Tighten the clamp at the throttle body (18) using a 7mm nut driver or flathead screw driver.

Step 19: Connect the CCV line (19) to the intake tube. Check that the line is securly connected by trying to pull it backwards.

Step 20: Reconnect the wire harness to the MAF sensor and the intake tube (20).



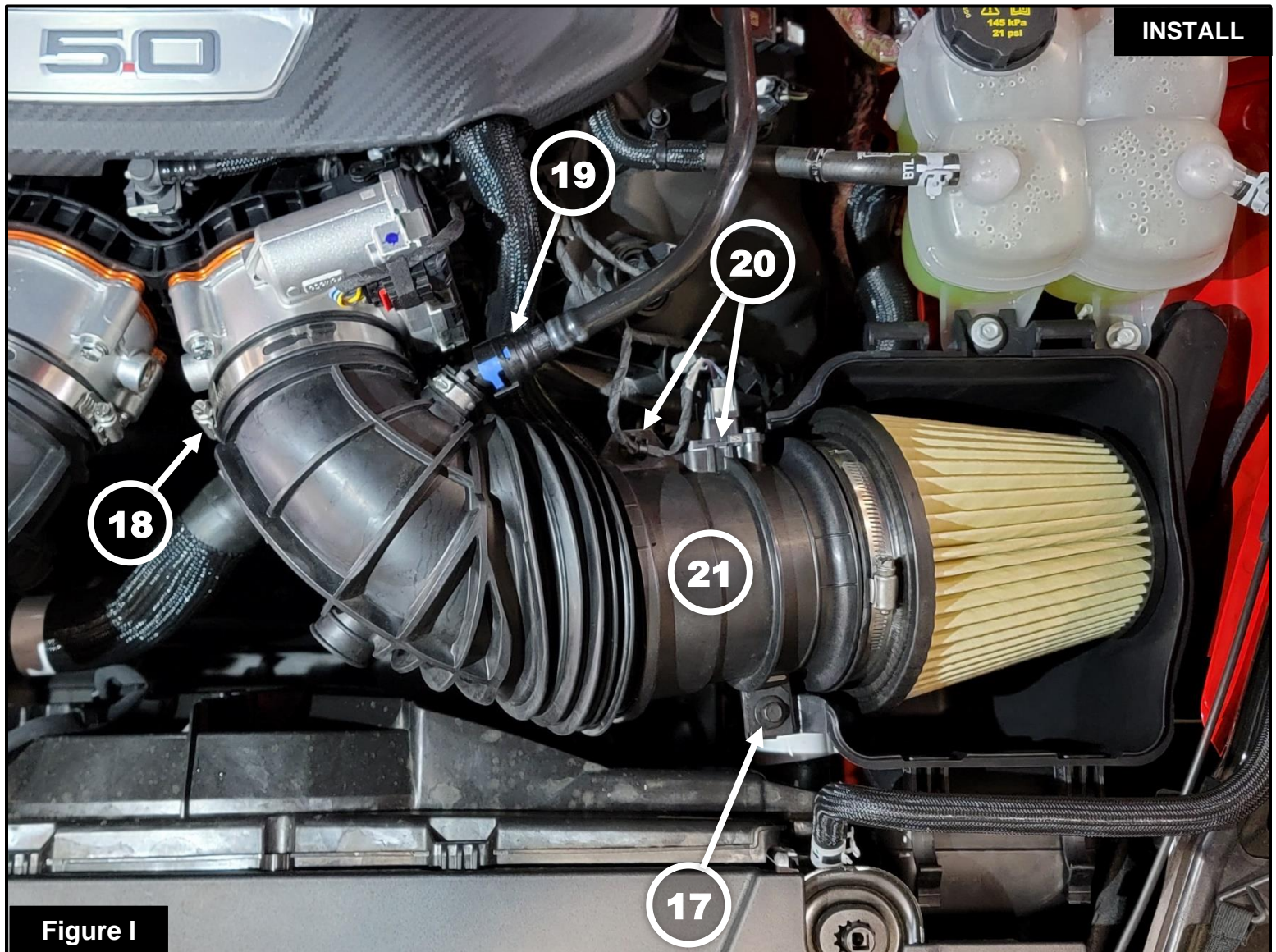

Figure I

## Refer to Figure I for Step 21

Step 21: Repeat steps 16-20 to reinstall the driver side intake tube (21).





Figure J

## **Refer to Figure J for Steps 22-23**

Step 22: Reinstall the intake covers and clip them into place (22).

Step 23: Confirm that all connections are secure and clamps tightened. Your installation is now complete.

Thank you for choosing aFe POWER!

**NOTE: Check all clamps, and connectors are secure after 100-200 miles**



**PAGE LEFT BLANK INTENTIONALLY**





**PAGE LEFT BLANK INTENTIONALLY**



***advanced FLOW engineering, inc.***

Corona, CA 92879  
[www.aFepower.com](http://www.aFepower.com)