



S103508  
S502926

## 50" Curved LED Light Bar Mount 2014-2015 Chevy Silverado 1500 / GMC Sierra 1500 2015 Chevy Silverado 2500/3500 / GMC

**NOTE:** Please read instructions before beginning installation. Check all of the kit's hardware to ensure it has all the proper contents. Be sure you have all needed parts and know where they go.

**Contents of Kit:** Driver Light bar mount (1), Passenger Light bar mount (1), Gaskets (2), 3/16" rivets (6)

**Tools Needed:** 3/16" Drill bit, Pop rivet gun, tape measure, permanent marker

### Installation Instructions:

1. Install the gaskets on the back side of the light mounts.
2. Open the driver's door and measure 16" from the top of the fender to the edge of the light mount. Once in place mark the position of the light mount.
3. With the light mount in position, drill three holes through the metal with a 3/16" drill bit. **NOTE: Placing a piece of tape on the drill bit about 1/2" from the end of the bit (closer to the drill's chuck) will aid in not drilling too far into the cab of the truck.**

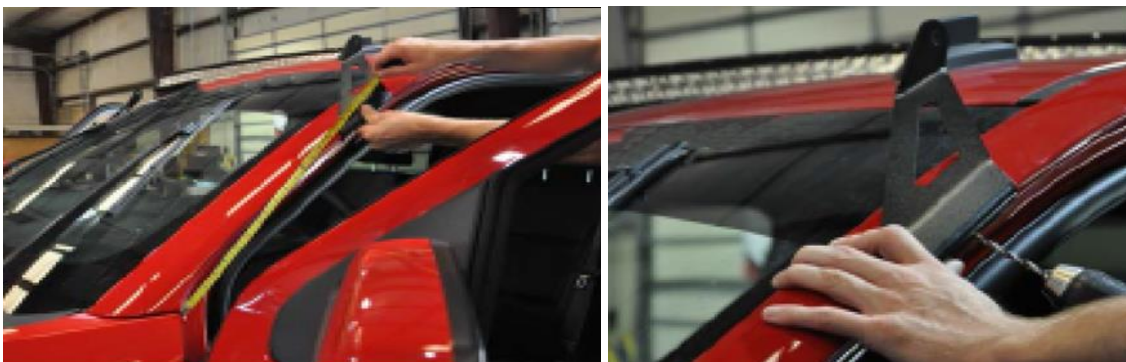

4. Use the supplied 3/16" rivets to secure the light brackets. **NOTE: Repeat steps on the driver side.**
5. Install the Led Light with the supplied instructions.

