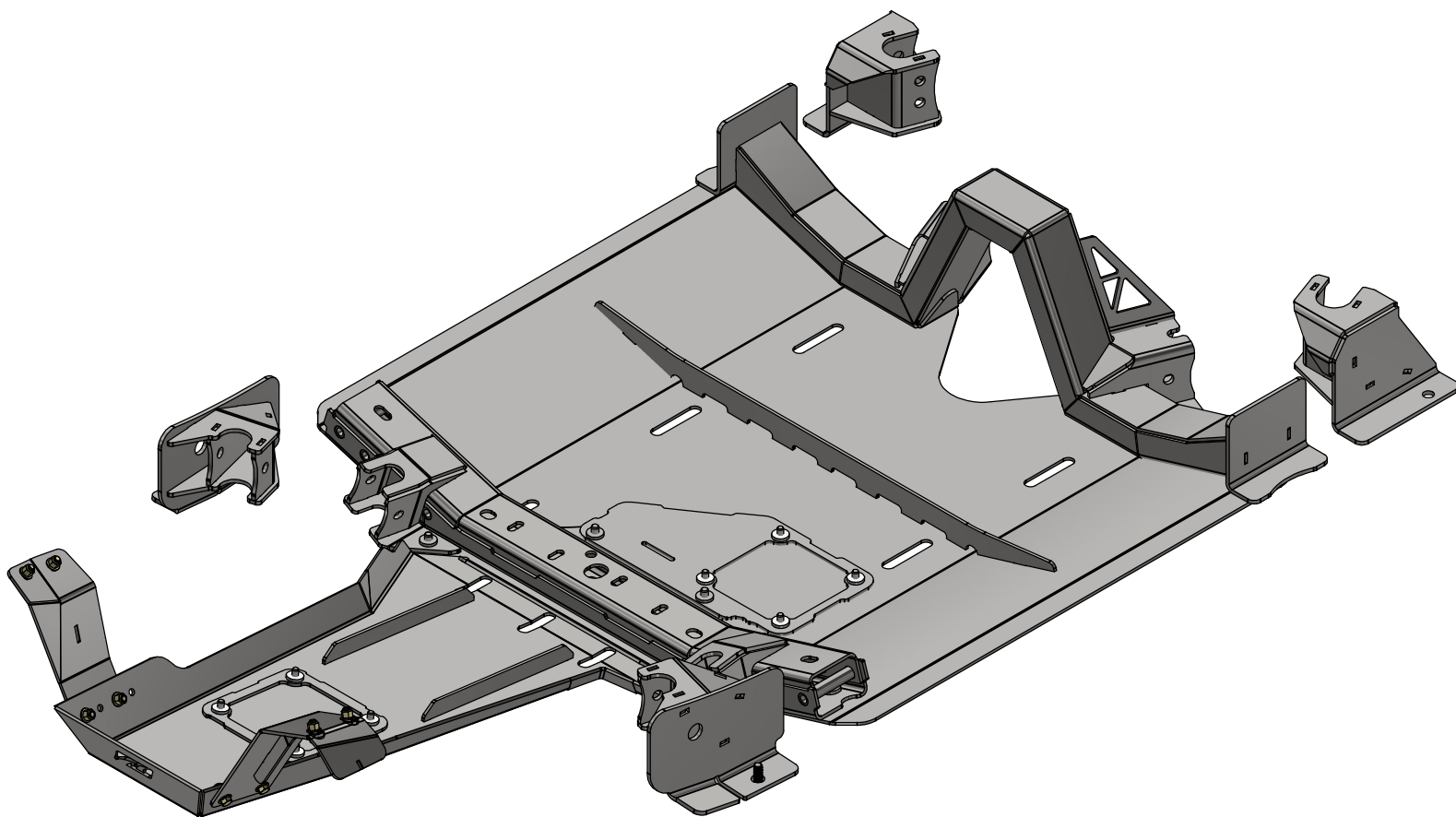
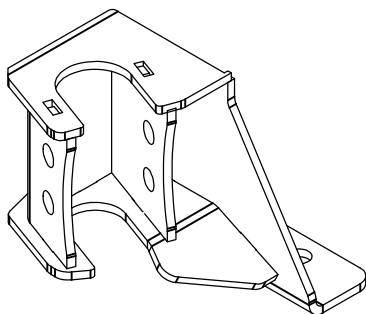

MB7000-ES - Assembly Instructions JKU 4 Link Suspension & Skid**MB7000-ES JKU 4 LINK SUSPENSION & SKID**

Compatible with Year Model (2007-2011)

**ASSEMBLY INSTRUCTIONS**

MB7000-ES - Shipping JKU 4 Link Suspension & Skid**CONTENTS**

MB3030-02
Qty 1

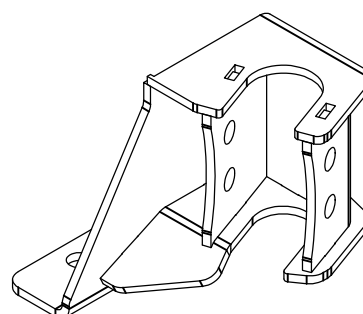

MB3030-01
Qty 1

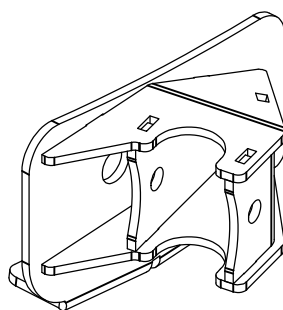

MB3029-10
Qty 1

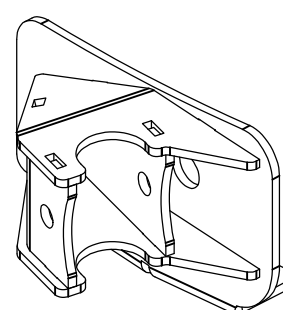

MB3029-11
QTY 1

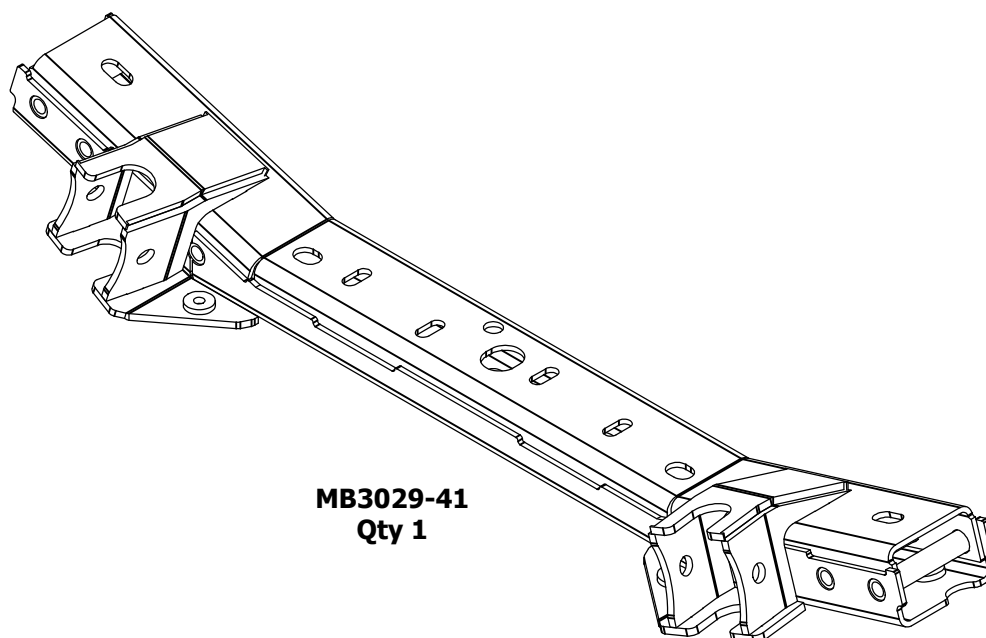

MB3029-41
Qty 1

MB7000-ES - Shipping JKU 4 Link Suspension & Skid

CONTENTS

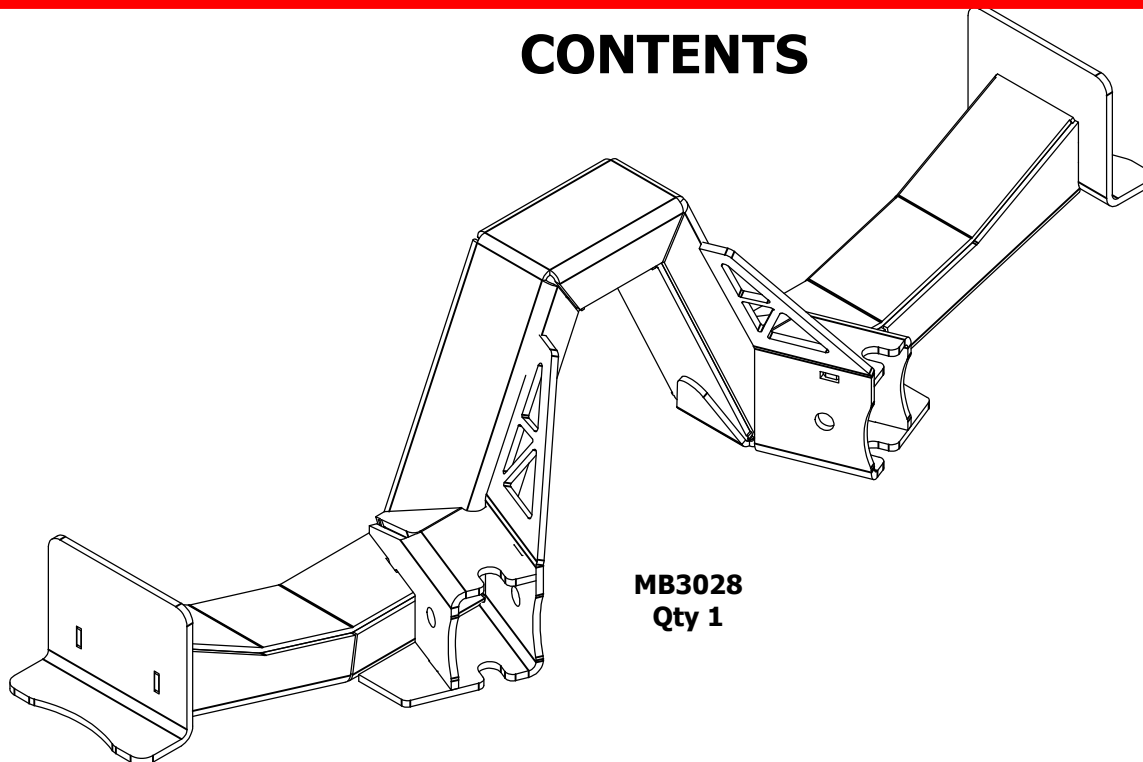

MB3028
Qty 1

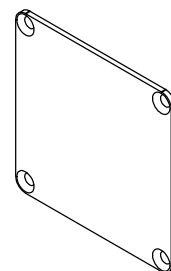

MB3031-01 C
Qty 1

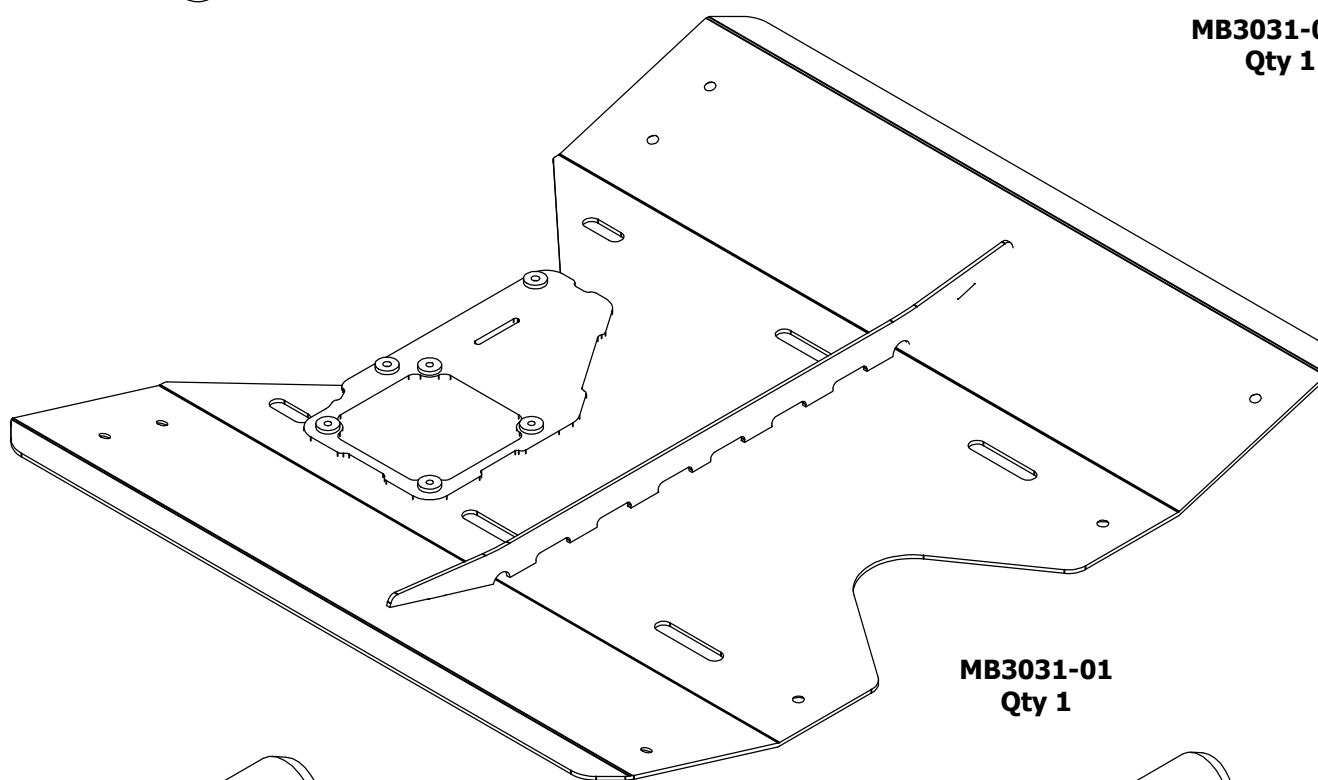

MB3031-01
Qty 1

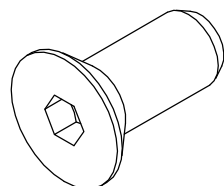

7/16-14 x 1" Flat Head Screw
Qty 13

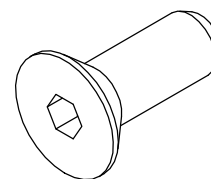

3/8-16 x 1 Flat Head Screw
Qty 8

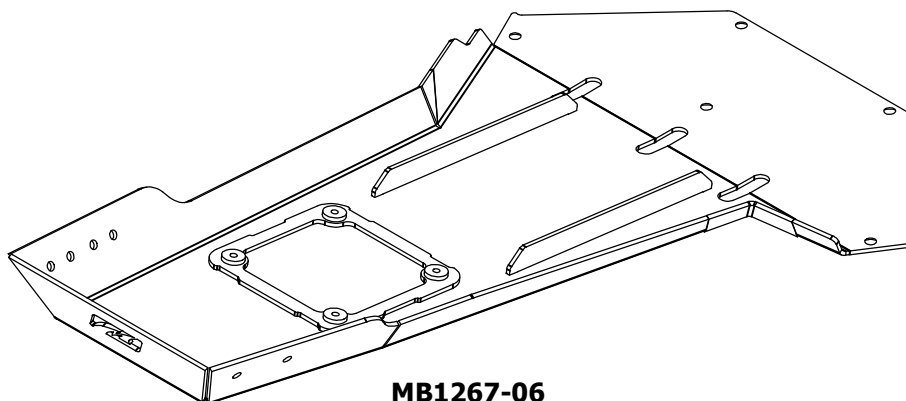
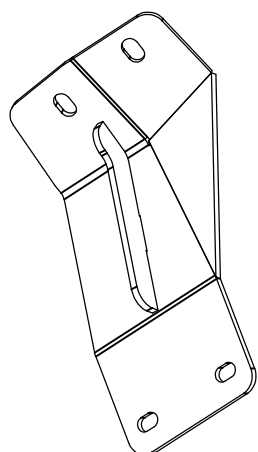
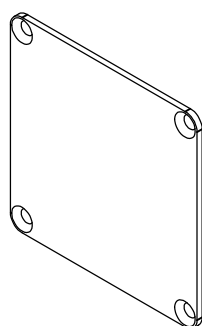
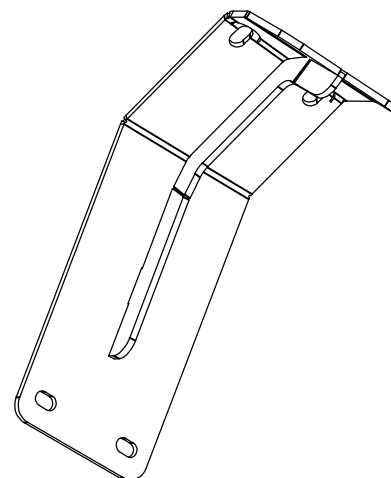
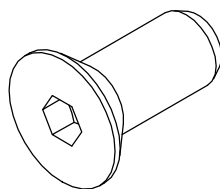
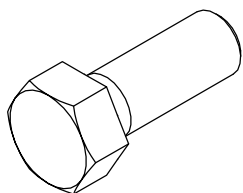
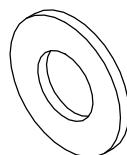
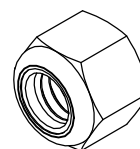
MB7000-ES - Shipping JKU 4 Link Suspension & Skid**CONTENTS****MB1267-06**
Qty 1**MB1267-02**
Qty 1**MB1267-01 C**
Qty 1**MB1267-01**
Qty 1**7/16-14 x 1" Flat Head Screw**
Qty 5**3/8-16 x 1" Hex Bolt**
Qty 8**3/8" Flat Washer**
Qty 16**3/8"-16 Nylon Insert Hex Locknut**
Qty 8



Preparation and Installation Guide

Compatibility: This suspension system ships in bare steel and is designed to replace your suspension with a triangulated front and rear or a triangulated rear and 3 link front. These assembly instructions cover the basic steps of how to install the suspension brackets. This Kit is designed for a 2 5/8" wide joint with a 5/8 bolt. This kit does not require the removal of the Jeep body/tub.

1. Prepare and Inspect: Unbox and inspect all components to ensure everything is included and free of damage.

2. Prep for Install: Remove all axles and all suspension and follow the instructions on what parts need to be cut from frame.

3. Fit Up and Weldout: Attach all the brackets to the frame and tack weld to ensure proper suspension travel. Fully weld brackets to frame after ensuring suspension travel is not impeded.

4. Hardware: This Kit is designed to use a 5/8" x 4 1/2" Grade 8 bolt combined with washers and a locking nut on all the suspension brackets.

5. Exhaust: This kit requires exhaust modifications to work with a 4 link front.

Pro Tip: Use STEEL-IT paint, which can be welded through and easily touched up afterward.

For questions or assistance, Please contact Motobilt support. Enjoy your new Motobilt suspension.

MB7000-ES - Assembly Instructions JKU 4 Link Suspension & Skid

REMOVE THE HIGHLIGHTED CROSS MEMBER AND CLEAN THE FRAME WHERE BRACKETS WERE ATTACHED

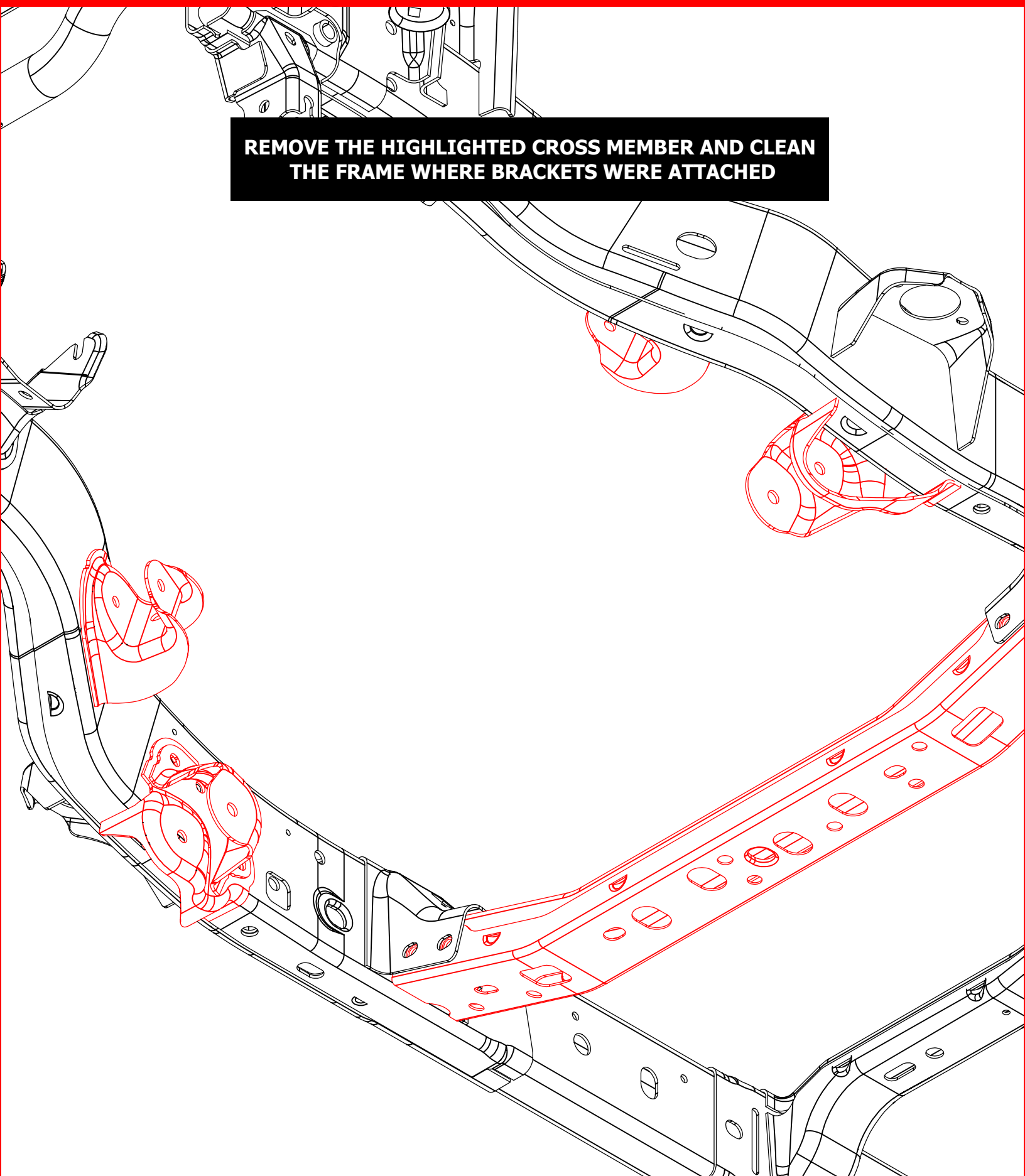

MB7000-ES - Assembly Instructions JKU 4 Link Suspension & Skid

REMOVE THE HIGHLIGHTED CROSS MEMBERS AND CLEAN THE FRAME WHERE BRACKETS WERE ATTACHED

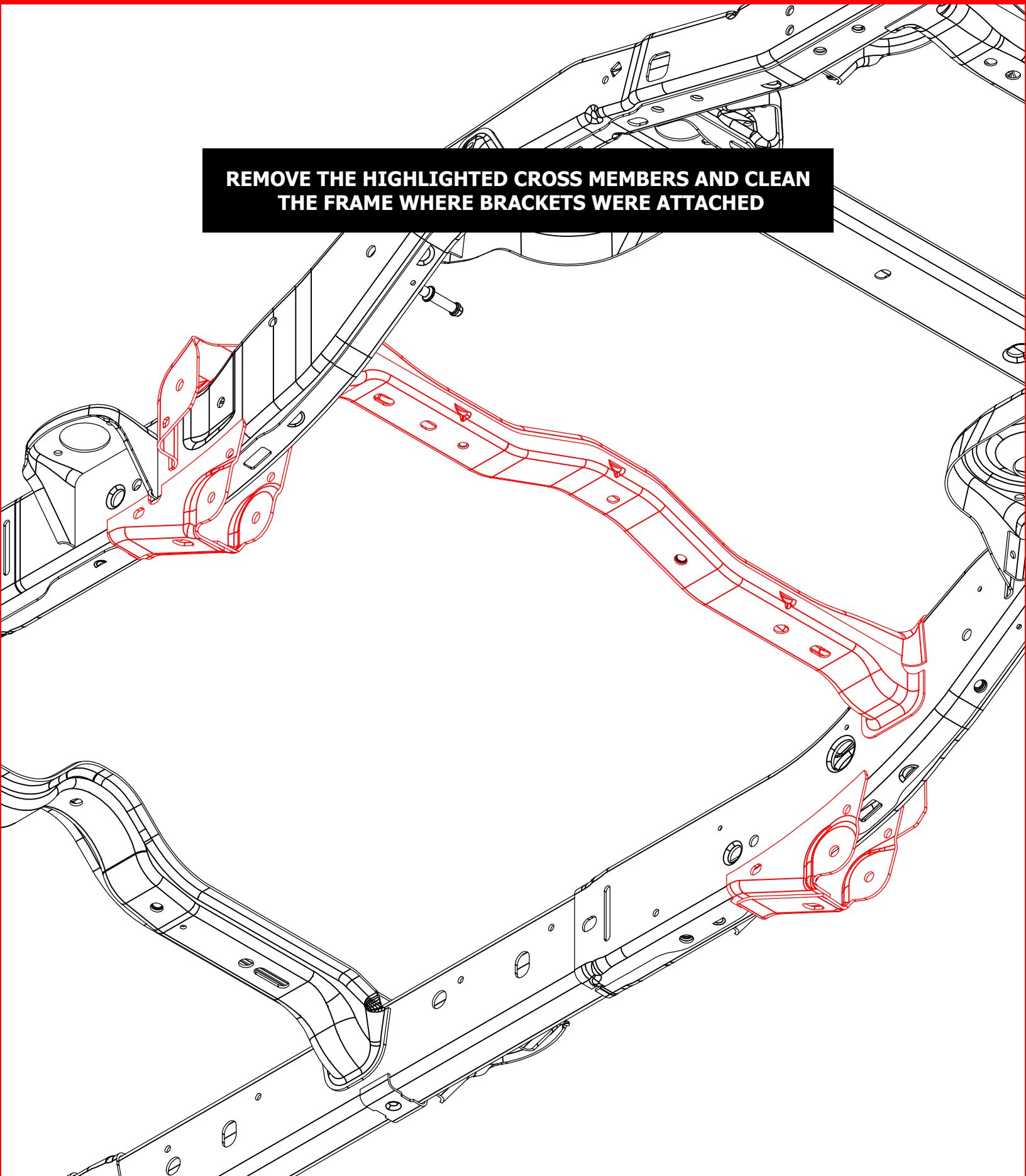

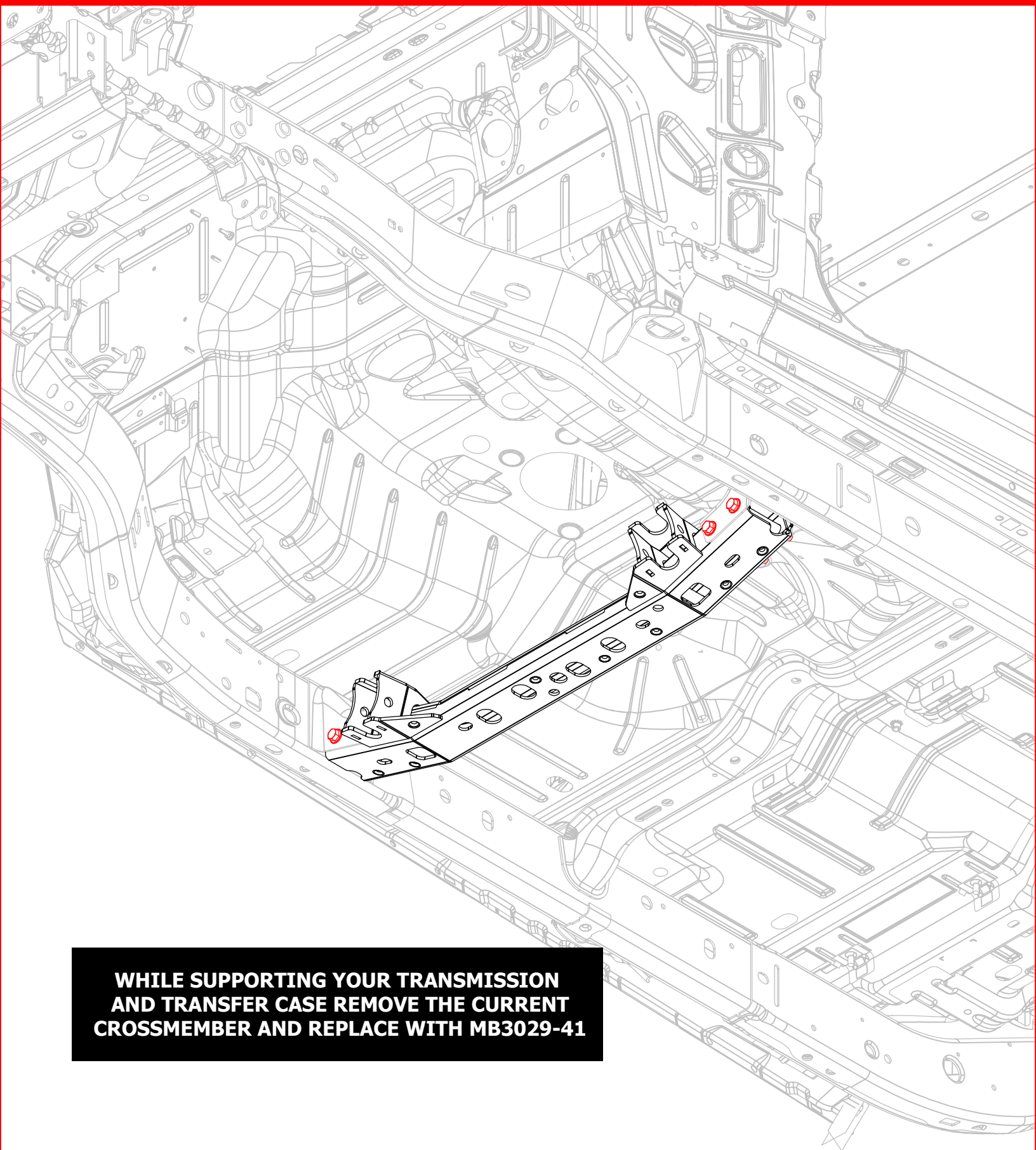
MB7000-ES - Assembly Instructions JKU 4 Link Suspension & Skid

**WHILE SUPPORTING YOUR TRANSMISSION
AND TRANSFER CASE REMOVE THE CURRENT
CROSSMEMBER AND REPLACE WITH MB3029-41**

MB7000-ES - Assembly Instructions JKU 4 Link Suspension & Skid

SECURE MB3028 REAR CROSSMEMBER TO THE SKID PLATE

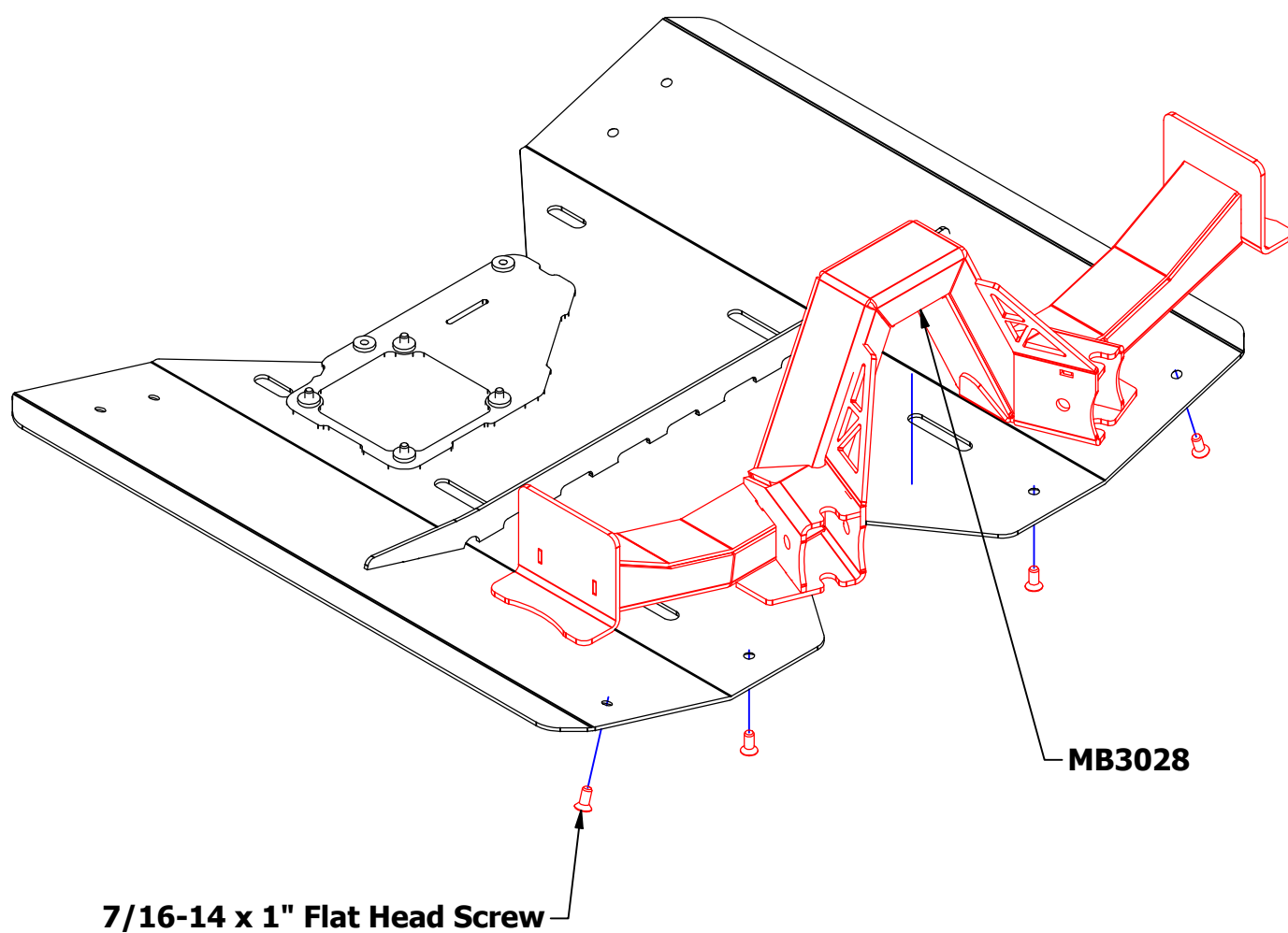

MB7000-ES - Assembly Instructions JKU 4 Link Suspension & Skid

USING THE SKID PLATE AS A JIG TO POSITION THE REAR CROSSMEMBER IN THE FRAME, SECURE THE SKID PLATE TO MB3029 WITH THE PROVIDED HARDWEAR. USE CLAMPS ON THE REAR CROSSMEMBER TO ENSURE PROPER FIT TO FRAME.

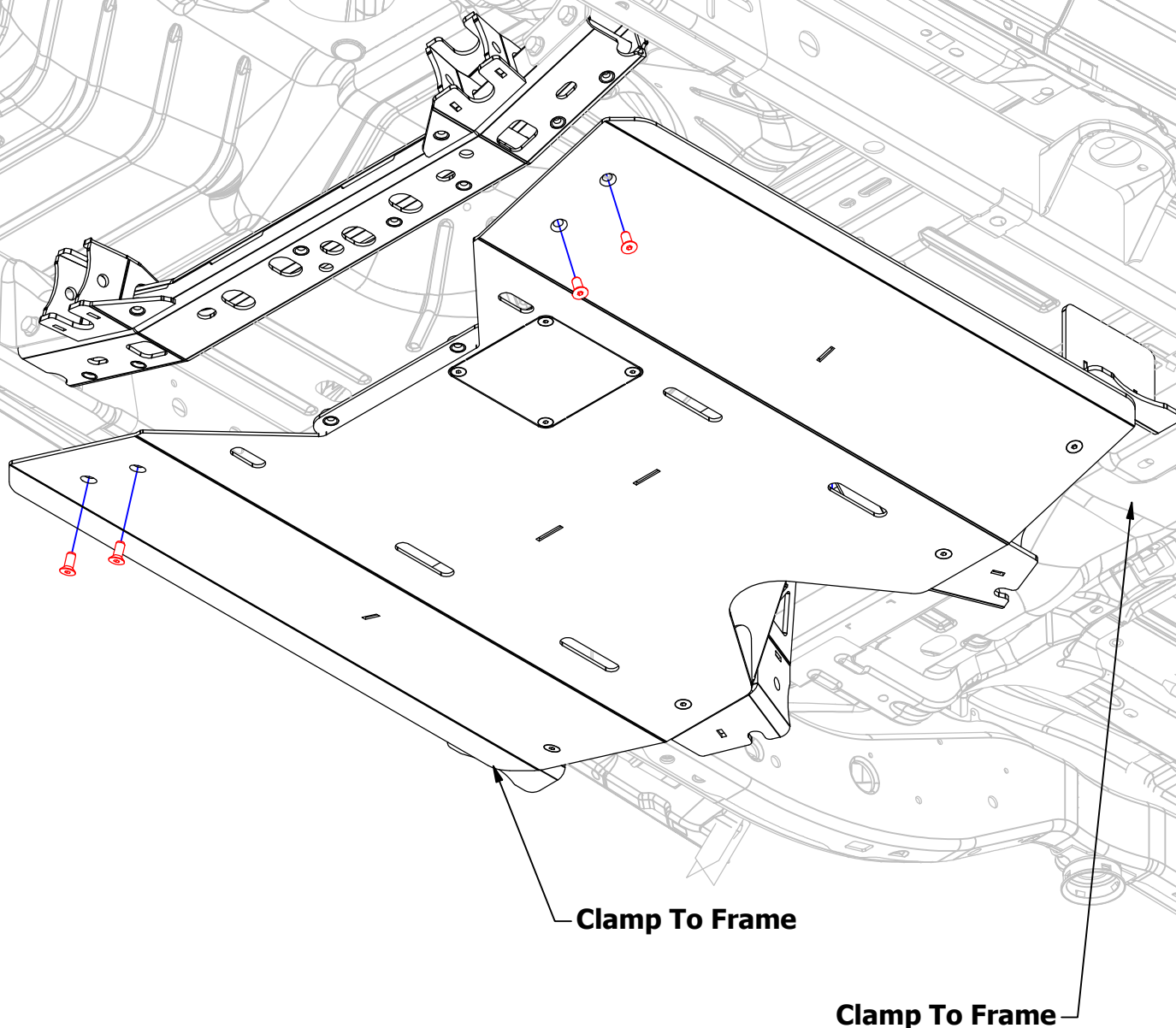

MB7000-ES - Assembly Instructions JKU 4 Link Suspension & Skid

PARTIALLY WELD THE NEW REAR CROSSMEMBER TO THE FRAME SO THAT YOU CAN REMOVE THE SKID PLATE.

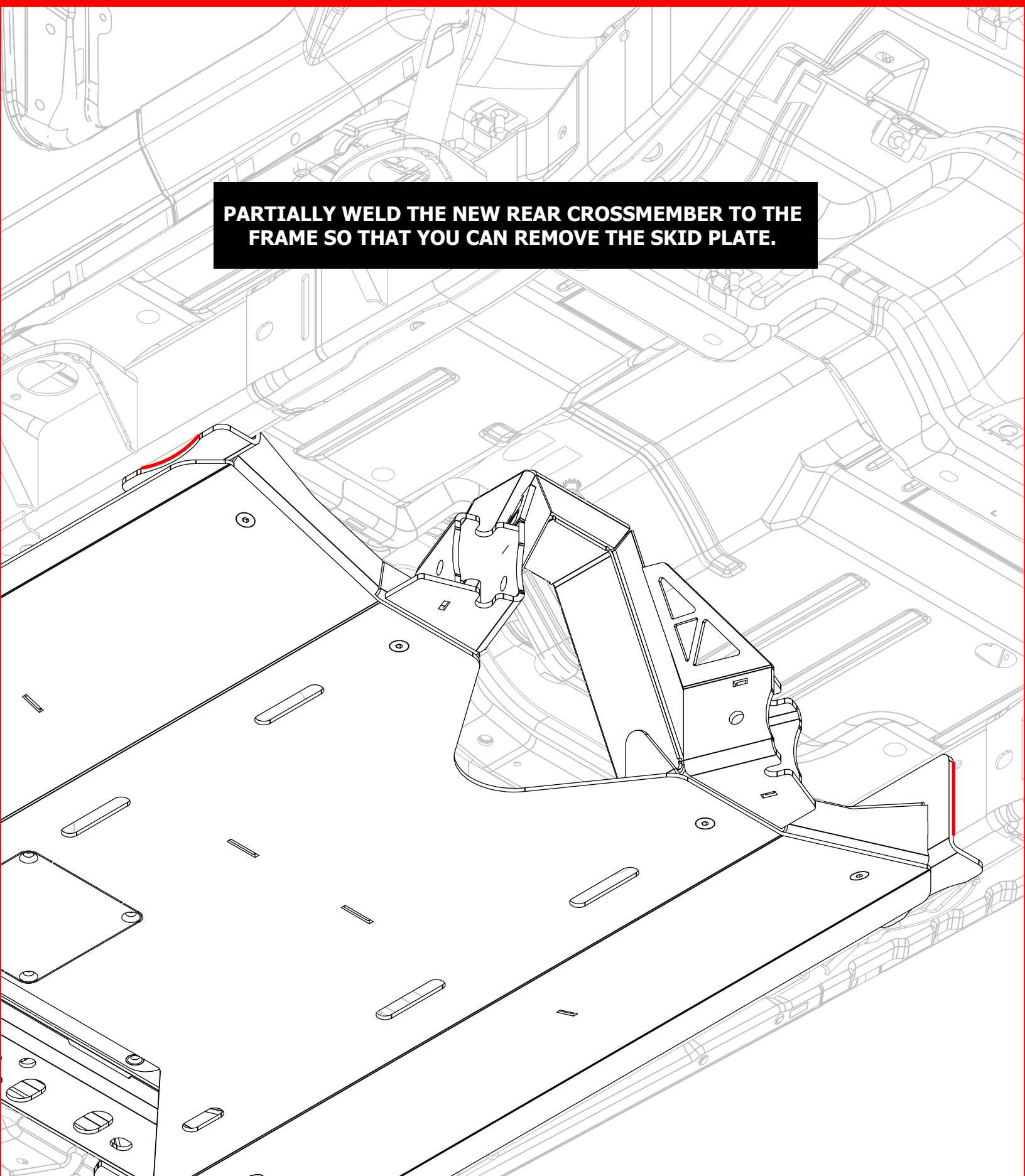

MB7000-ES - Assembly Instructions JKU 4 Link Suspension & Skid

USE THE FACTORY FRAME BOLT TO LOCATE MB3030-02 ON THE FRAME AND TACK WELD. SINCE THERE IS NO FACTORY TREADED HOLE ON DRIVER SIDE USE MEASUREMENTS FROM PASSENGER SIDE AND MATCH ON MB3030-01.

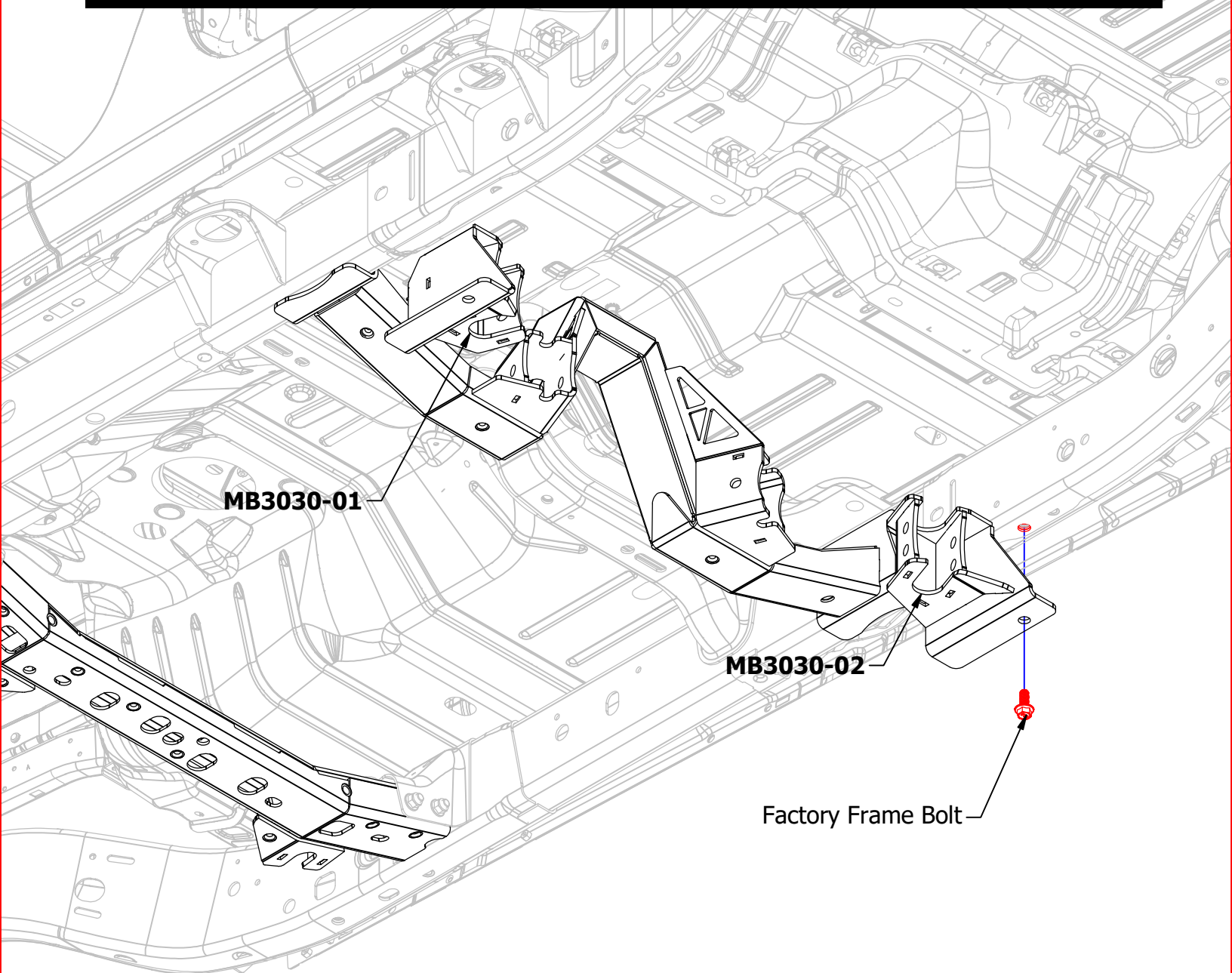

MB7000-ES - Assembly Instructions JKU 4 Link Suspension & Skid

SECURE MB3029-10 AND MB3029-11 WITH FACTORY FRAME BOLTS AND TACK WELD TO FRAME. IF YOU ARE DOING A 3 LINK ONLY USE DESIRED UPPER LINK MOUNT

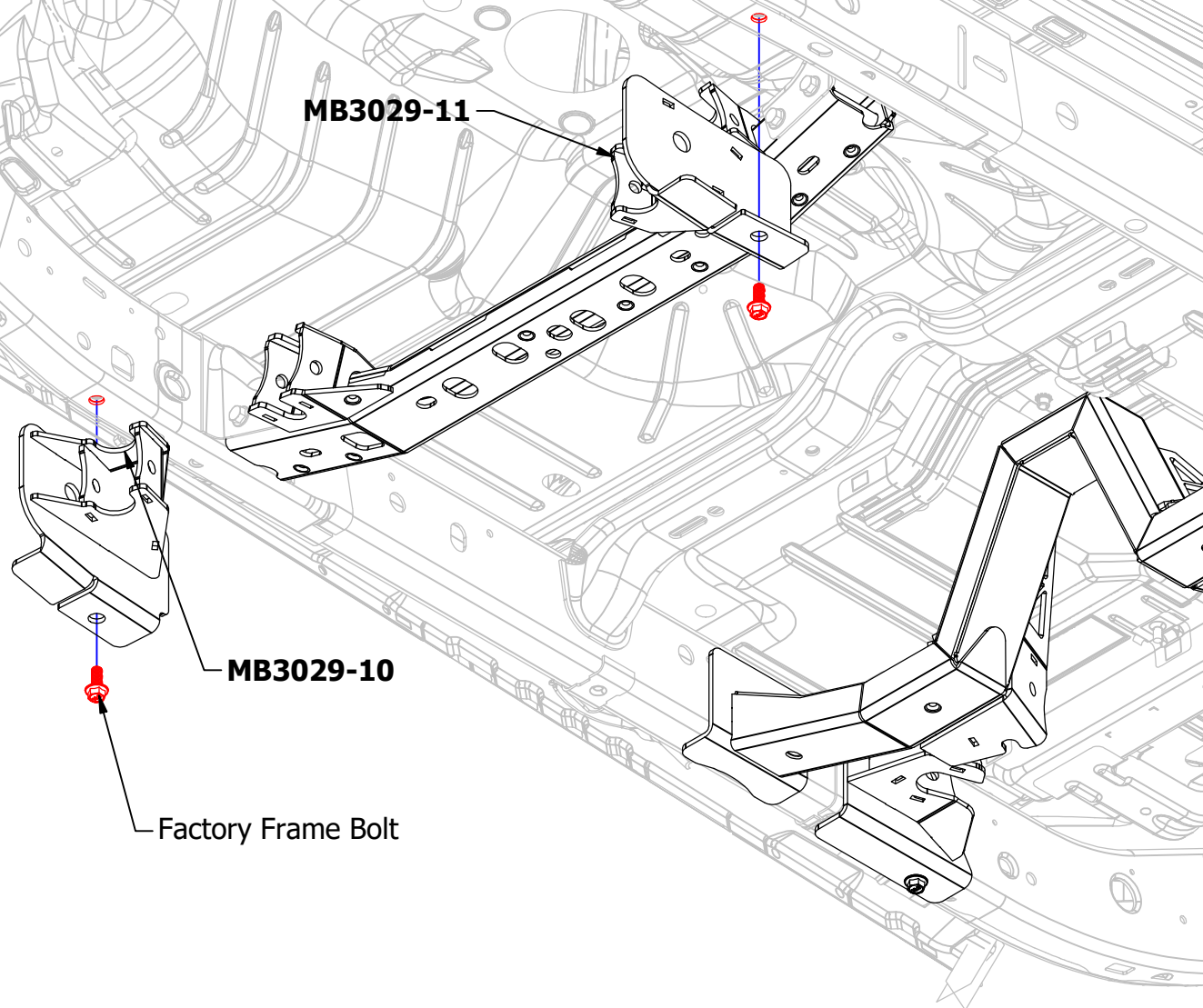

MB7000-ES - Assembly Instructions JKU 4 Link Suspension & Skid

AFTER CYCLING YOUR SUSPENSION WELD ALL THE BACKING PLATES TO THE FRAME

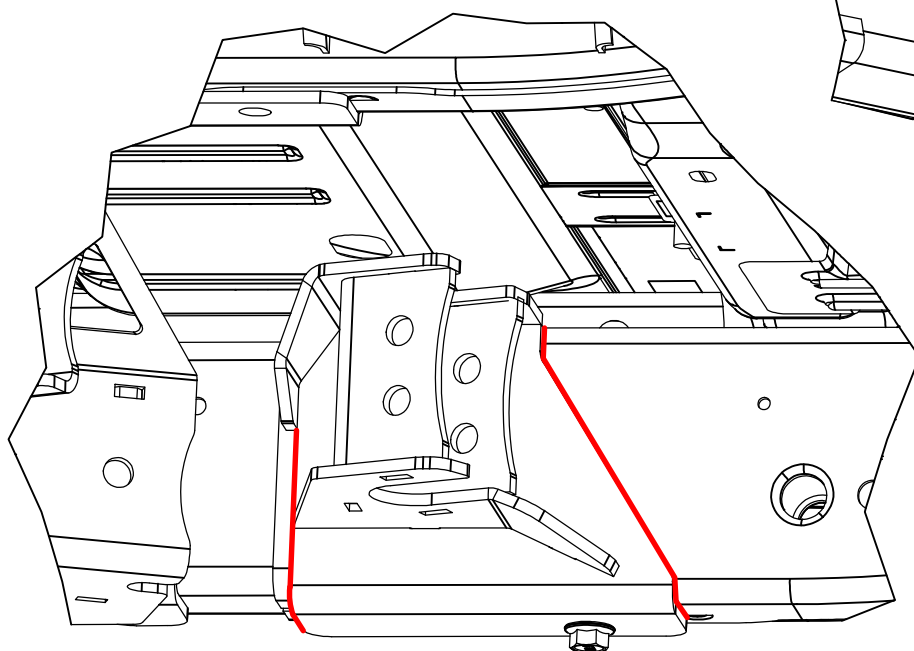
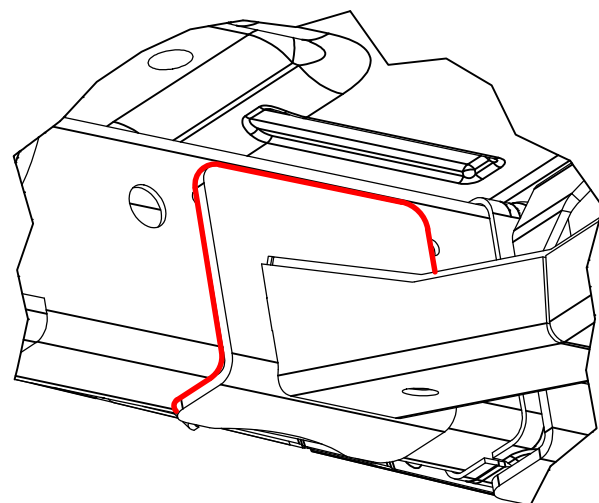
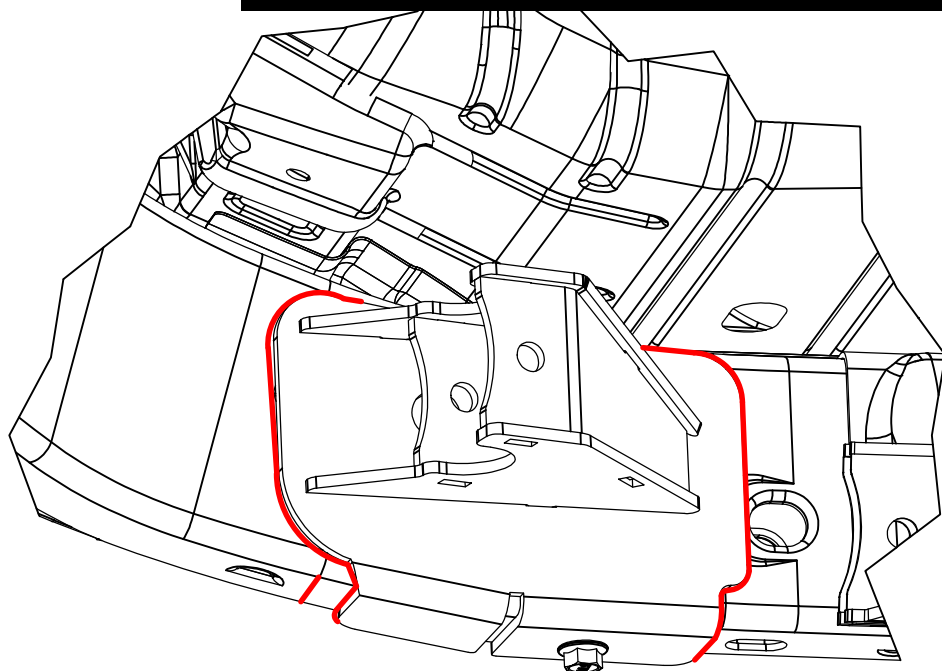

MB7000 - ES - Assembly Instructions Engine Skid for JK 4 Link Suspension

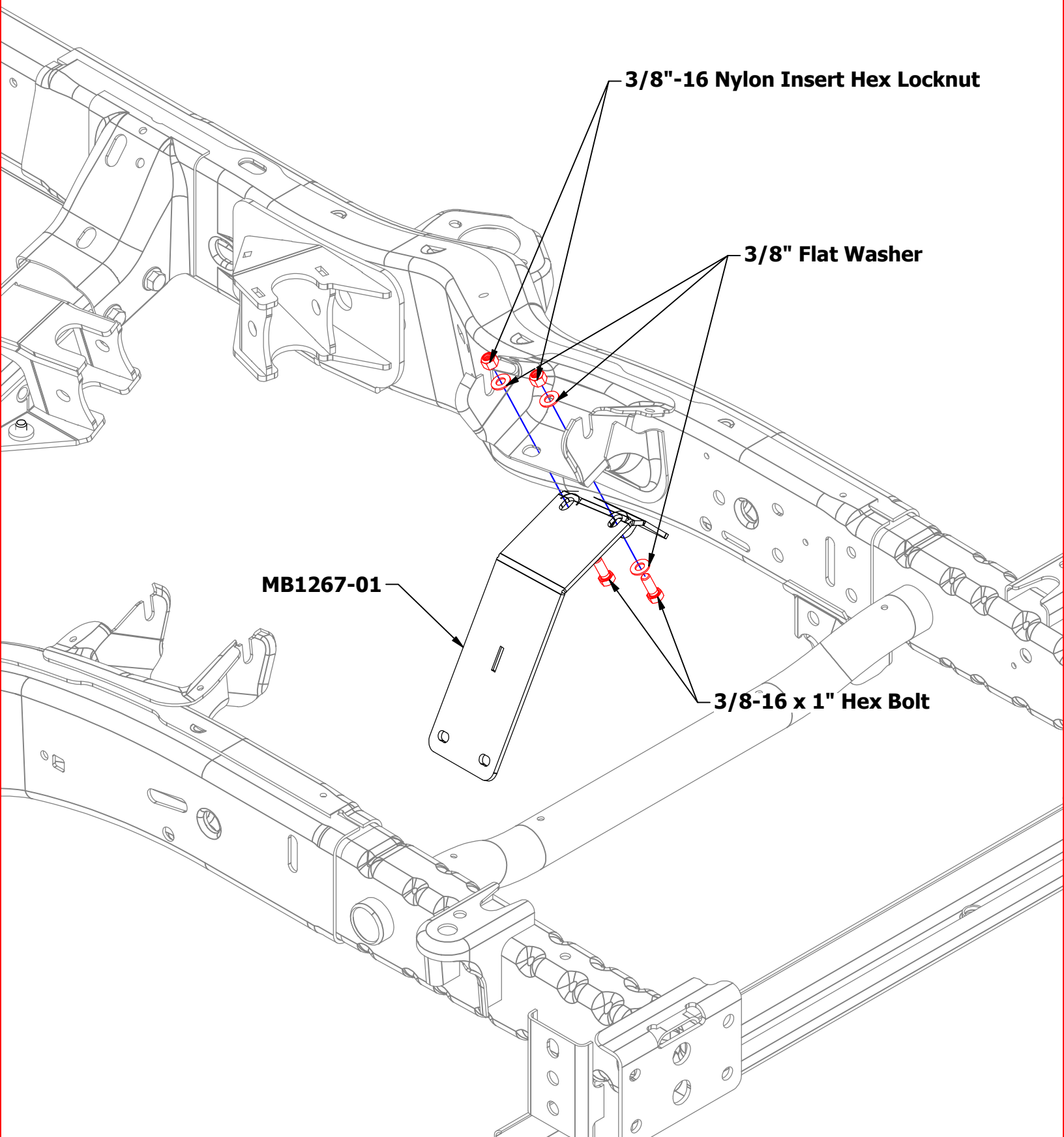

MB7000 - ES - Assembly Instructions Engine Skid for JK 4 Link Suspension

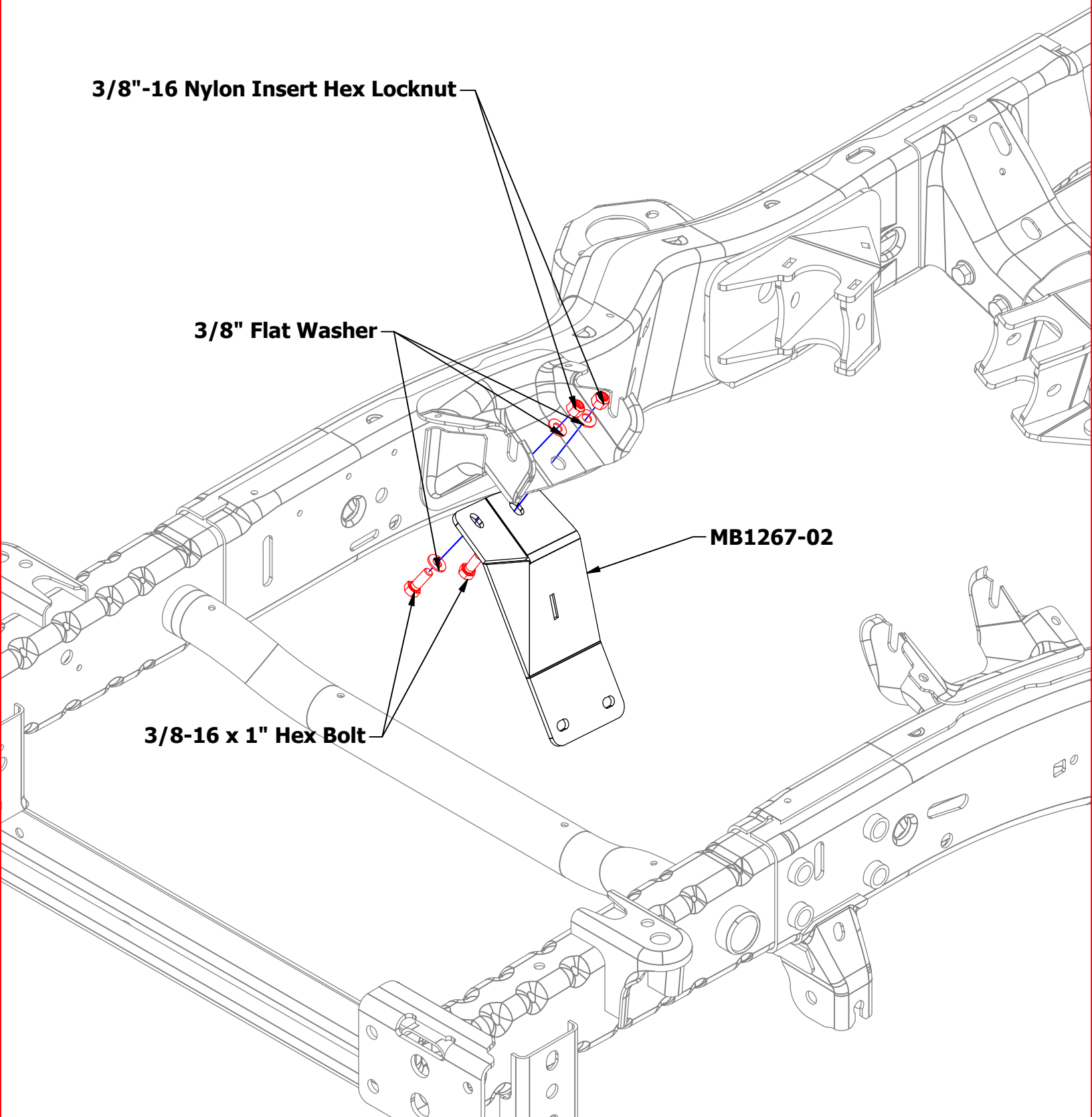

MB7000 - ES - Assembly Instructions Engine Skid for JK 4 Link Suspension

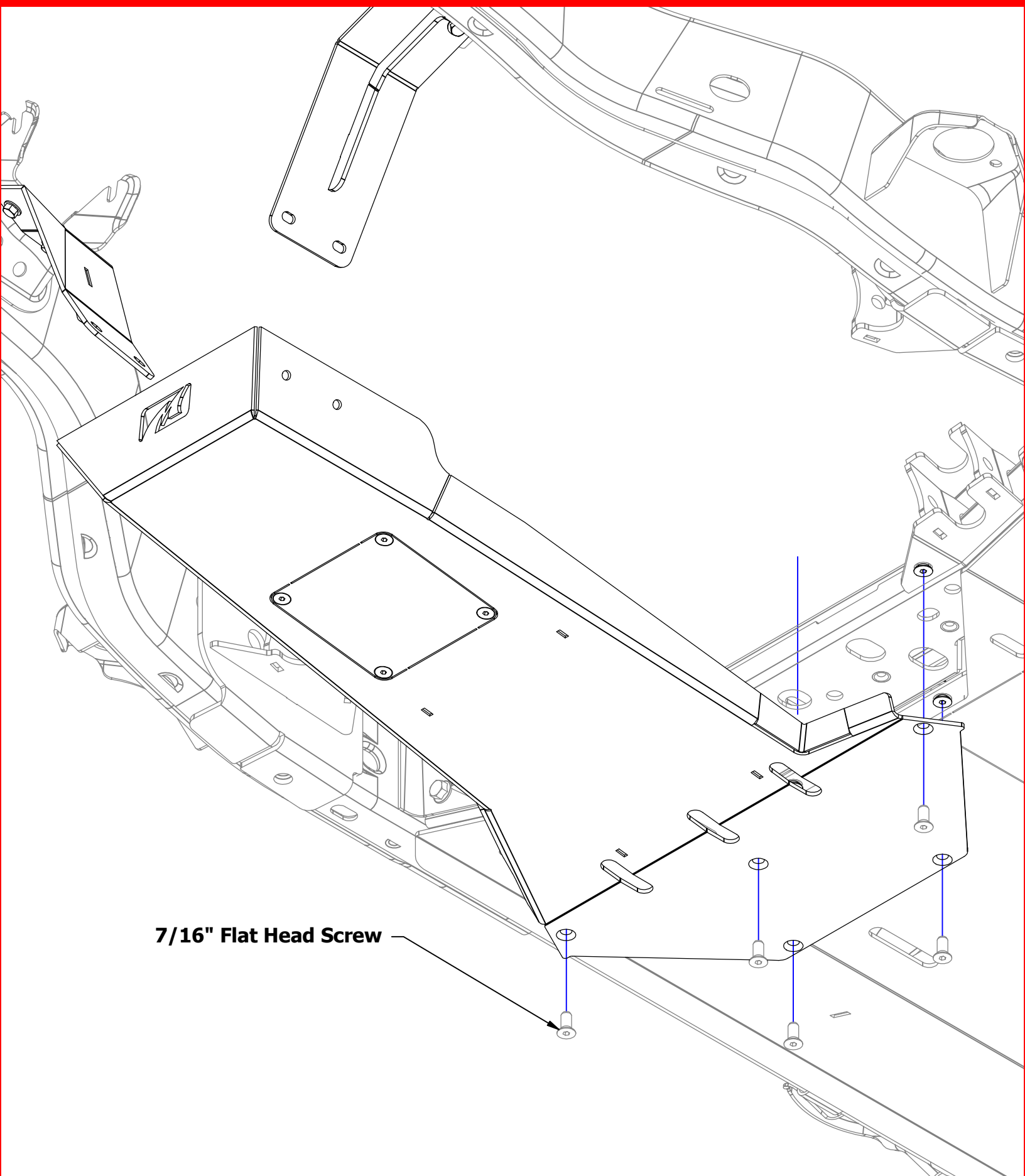

MB7000 - ES - Assembly Instructions Engine Skid for JK 4 Link Suspension

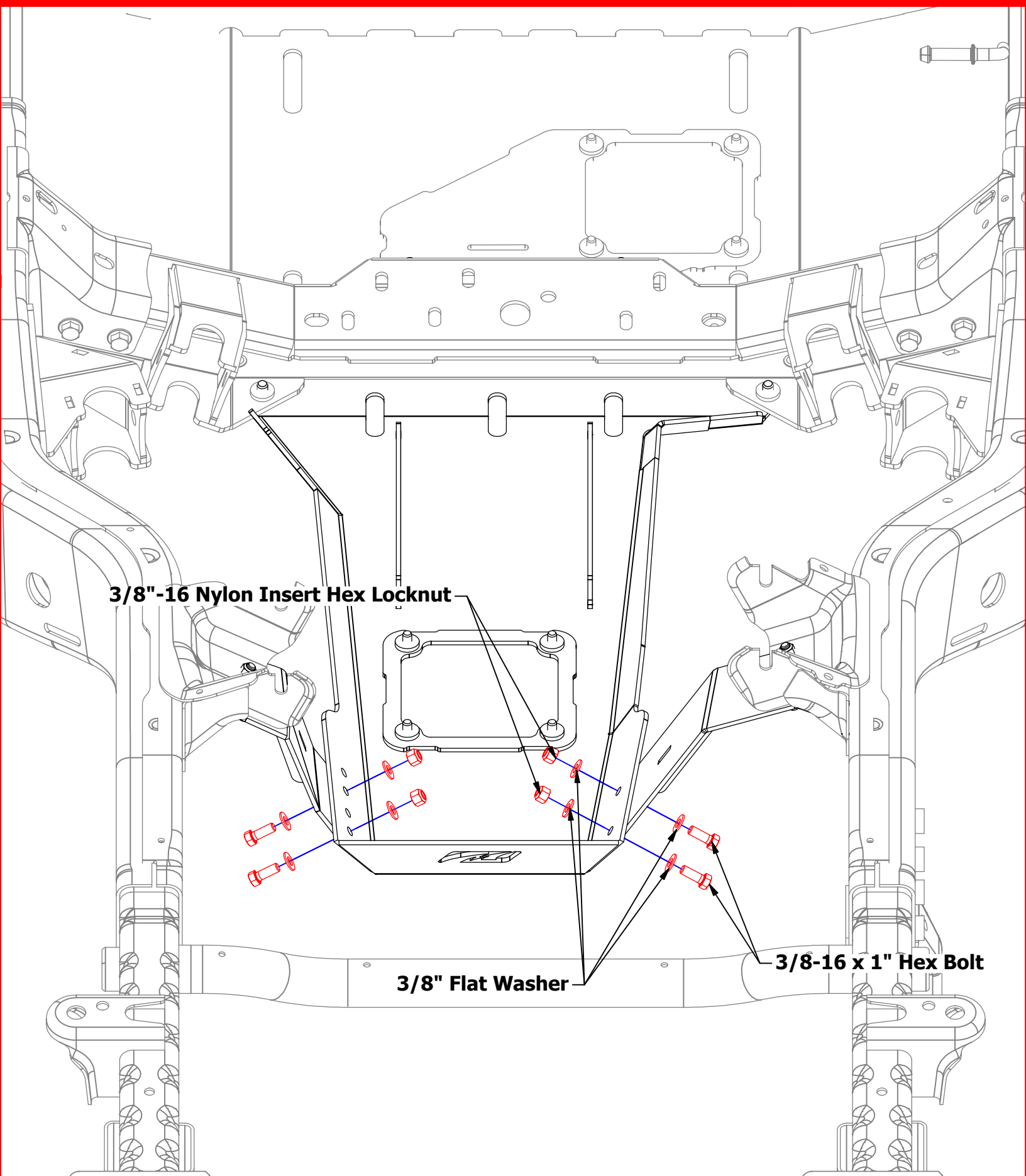

MB7000-ES - Assembly Instructions JKU 4 Link Suspension & Skid