

**MB1258 - Assembly Instructions Frame Mounted Rocker Guards for 4 Door**

# **FRAME MOUNTED ROCKER GUARDS FOR AFTERMARKET LONG ARM SUSPENSIONS**

Compatible with 2007-2018 JKU 4 Door  
Compatible with 2018-Present JLU 4 Door

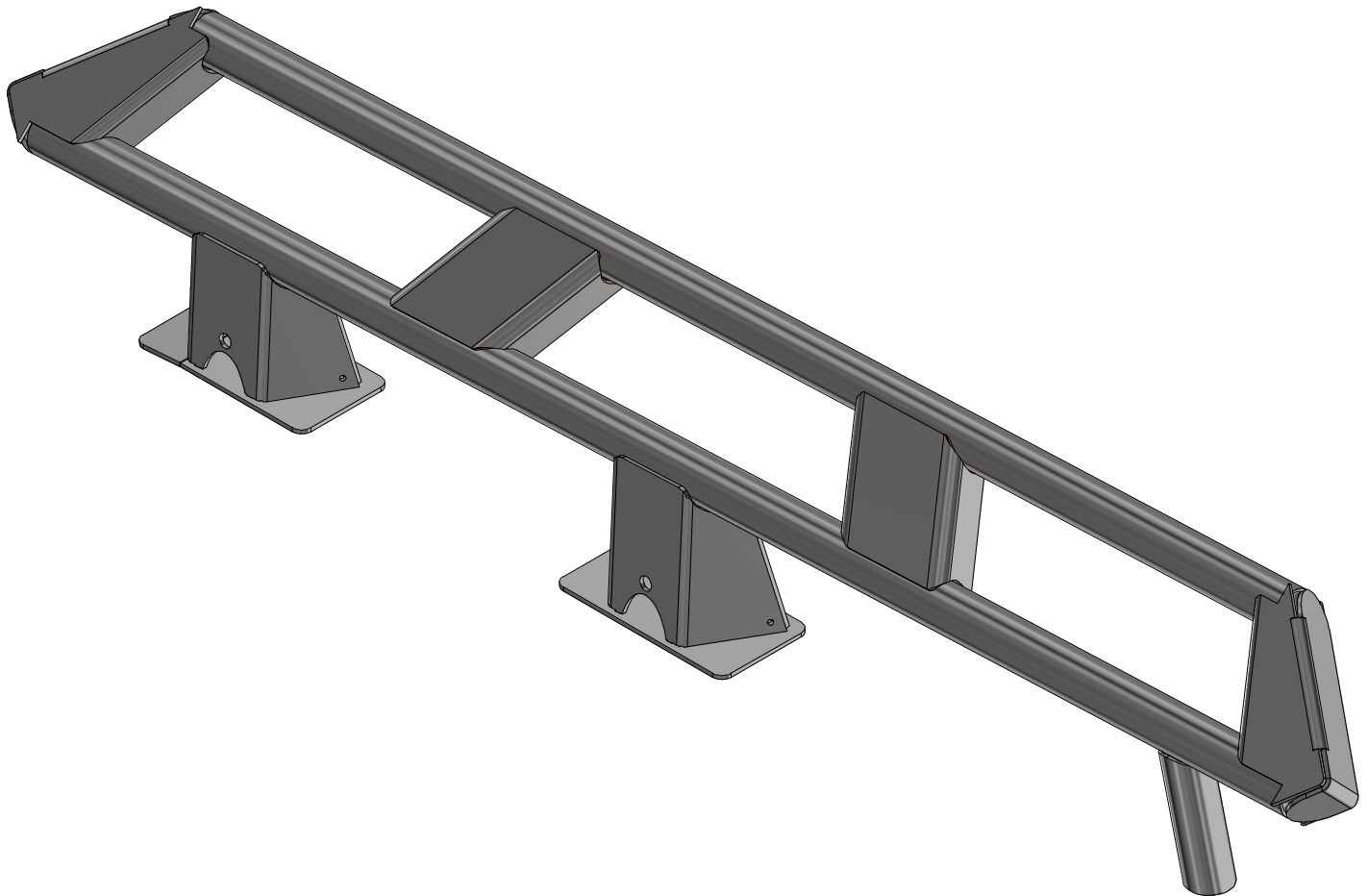

## **ASSEMBLY INSTRUCTIONS**

# MB1258 - Assembly Instructions Frame Mounted Rocker Guards for 4 Door

## CONTENTS

Compatible with 2007-2018 JKU 4 Door  
Compatible with 2018-Present JLU 4 Door

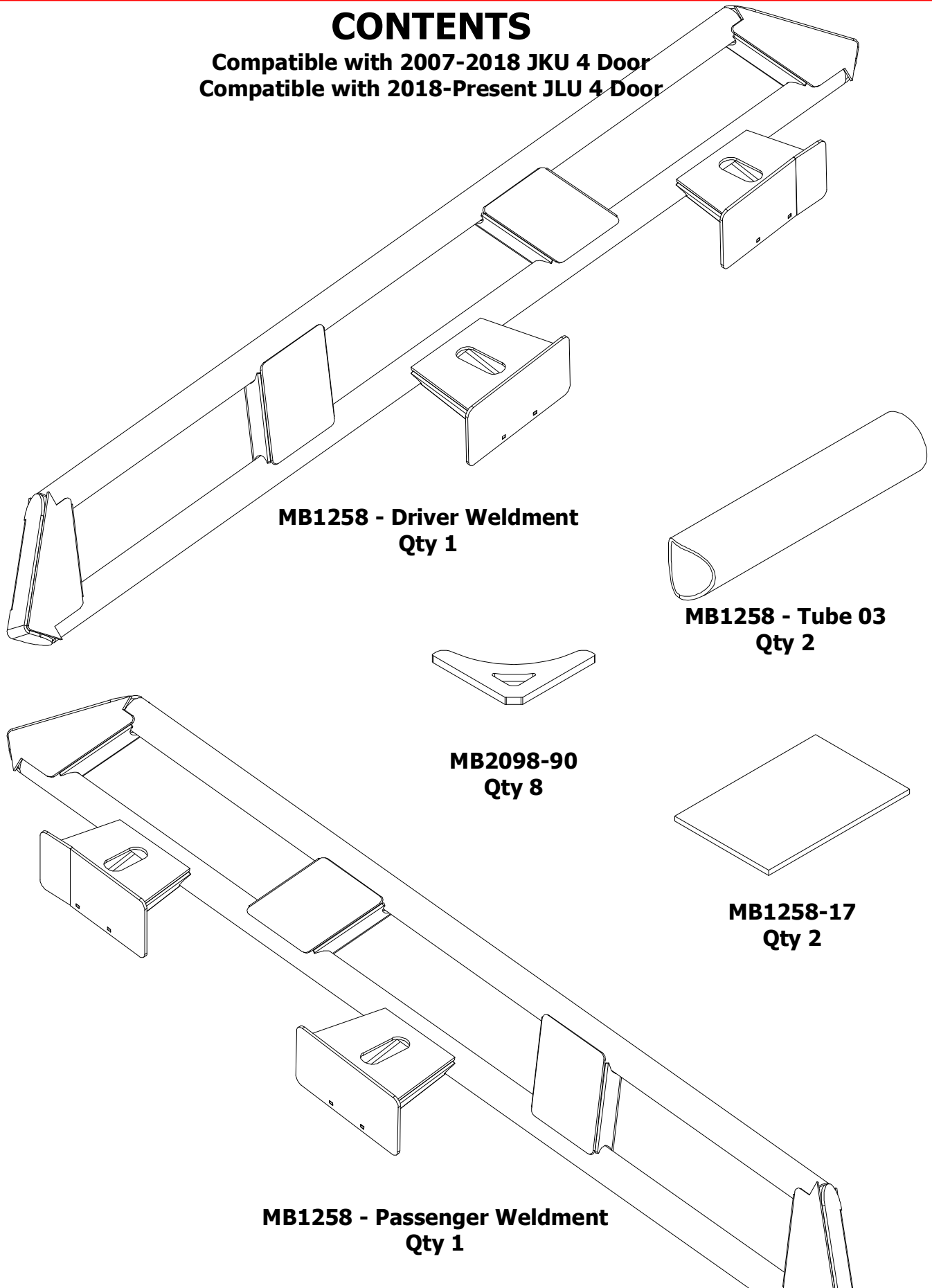

## MB1258 - Assembly Instructions Frame Mounted Rocker Guards for 4 Door

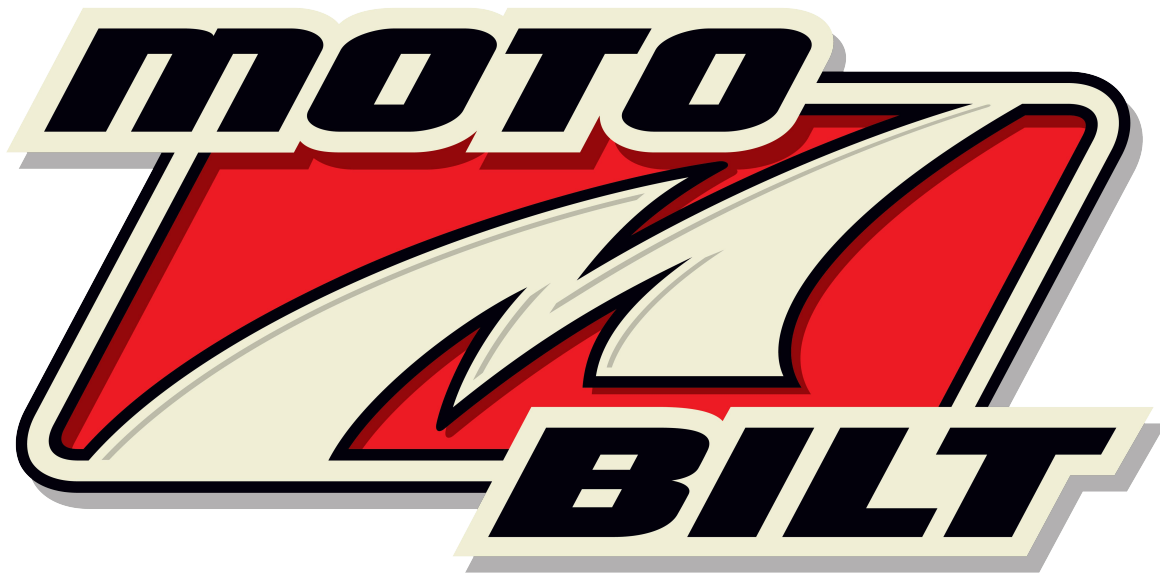
**Preparation and Installation Guide**

**Compatibility:** This product fits Jeep JKU and Jeep JLU 4 Door models. The assembly instructions feature a Jeep JLU body and frame, but the same procedures apply to the Jeep JKU model.

- 1. Disconnect Batteries:** Before starting the installation, disconnect all batteries.
- 2. Install Lower Rocker Armor:** If you plan to install lower rocker armor (e.g., MB1014 for Jeep JKU 2 Door or MB1195 for Jeep JLU 2 Door), do this first before proceeding with the weld-on Rocker Guards.
- 3. Prepare for Welding:**
  - Cover or mask all painted areas, glass, mirrors, and trim.
  - Ensure you have a fire extinguisher on hand.
- 4. Paint or Powder Coat Parts:** Paint or powder coat all parts before installation. Note that welding will require touch-ups on painted areas.
- 5. Remove Factory Paint:** Remove factory paint from the frame where welding will occur.
- 6. Weld the Product:** Weld the product to the frame of the vehicle.
- 7. Touch Up Paint:** After welding, touch up the frame and any affected areas with paint.

**Pro Tip:** Use STEEL-IT paint, which can be welded through and easily touched up afterward.

# MB1258 - Assembly Instructions Frame Mounted Rocker Guards for 4 Door

## STEP 1

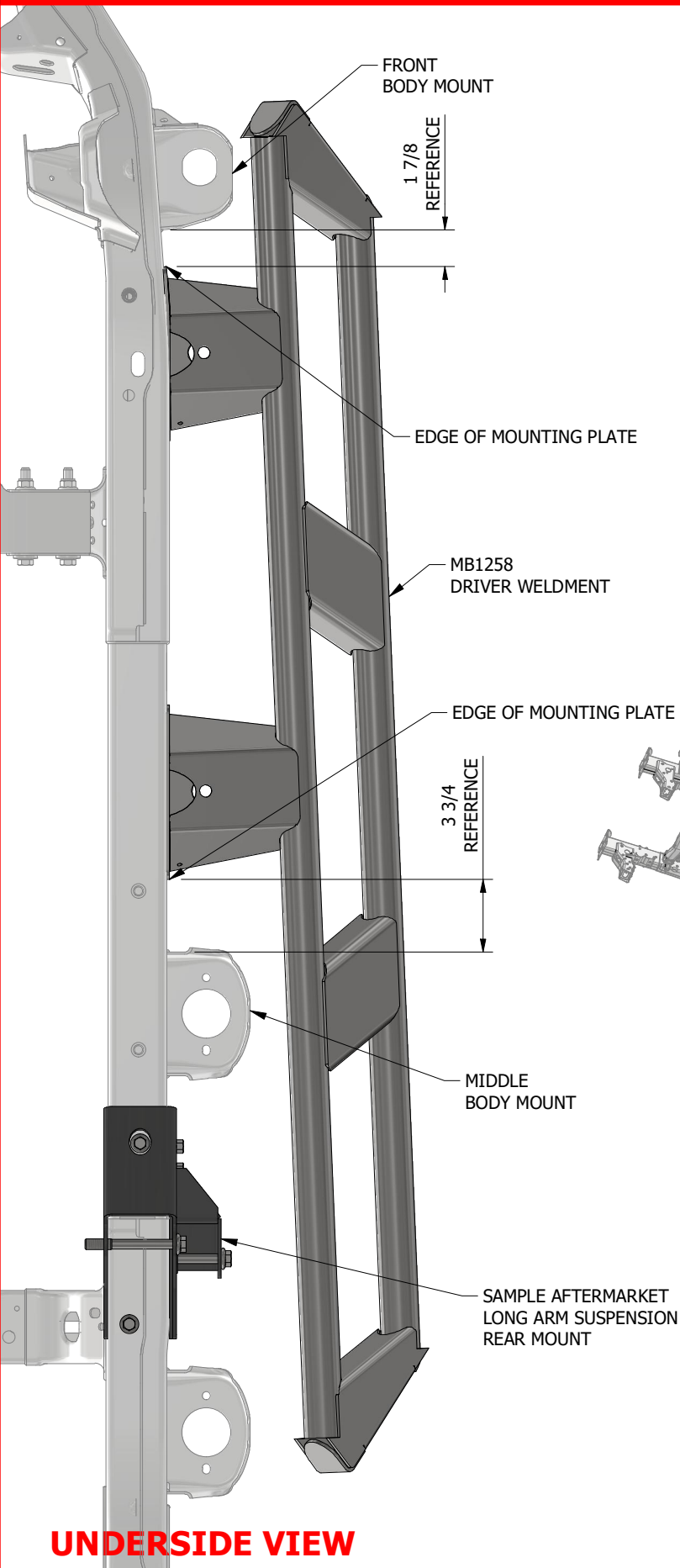

## UNDERSIDE VIEW

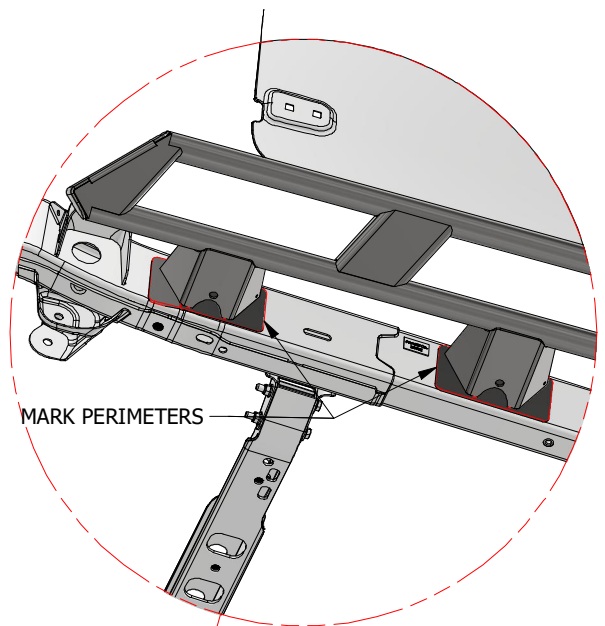

## DETAIL A

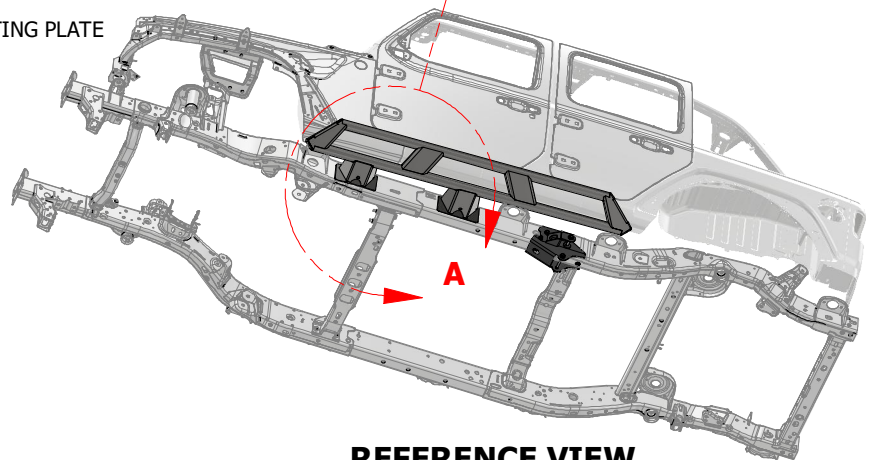

## REFERENCE VIEW

1. CLAMP THE DRIVER WELDMENT TO THE FRAME IN THE POSITION AS SHOWN.
2. MARK THE PERIMETER OF THE MOUNTING PLATES.
3. UNCLAMP & REMOVE THE DRIVER WELDMENT.
4. GRIND PAINT OFF FRAME IN MARKED LOCATIONS.
5. REINSTALL & CLAMP DRIVER WELDMENT IN POSITION SHOWN.
6. TACK WELD MOUNTING PLATES TO FRAME.

**REPEAT ON PASSENGER SIDE**

# MB1258 - Assembly Instructions Frame Mounted Rocker Guards for 4 Door

## STEP 2

YOUR CARDBOARD TEMPLATE

**NOTE:**  
YOUR TEMPLATE SHAPE MAY BE  
DIFFERENT THAN SHOWN

THE SHAPES & LOCATIONS OF AFTERMARKET LONG TRAVEL SUSPENSION BRACKETS WILL VARY BY MANUFACTURER. IF THERE IS ROOM, IDEALLY YOU WANT TO TIE INTO THE FRAME. YOU WILL CREATE YOUR OWN TUBE BACKING PLATE BY FIRST CREATING A CARDBOARD TEMPLATE OF THE AVAILABLE SPACE.

REPEAT ON PASSENGER SIDE

REMOVE PAINT  
FROM FRAME



# MB1258 - Assembly Instructions Frame Mounted Rocker Guards for 4 Door

## STEP 3

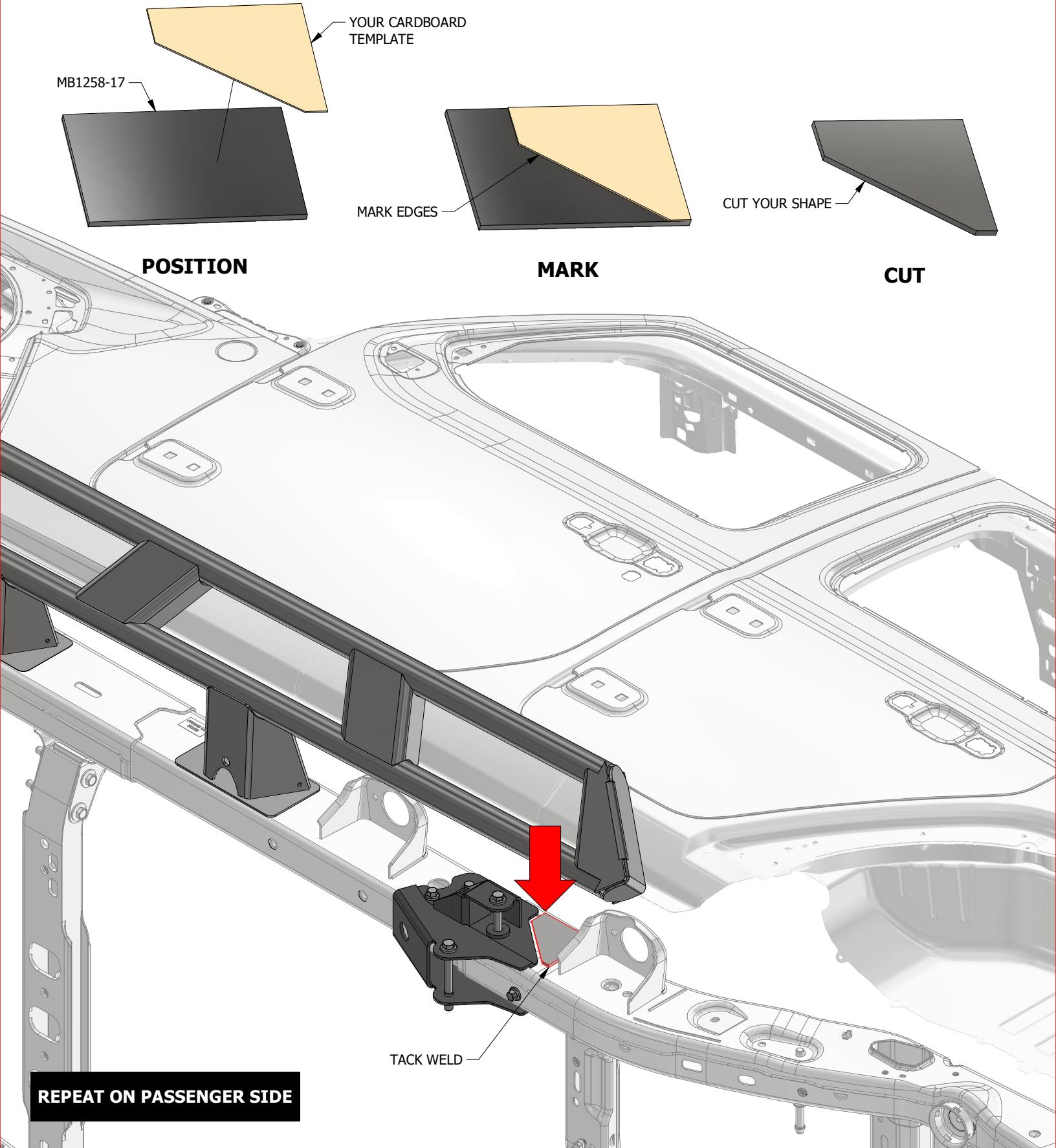

REPEAT ON PASSENGER SIDE

# MB1258 - Assembly Instructions Frame Mounted Rocker Guards for 4 Door

## STEP 4

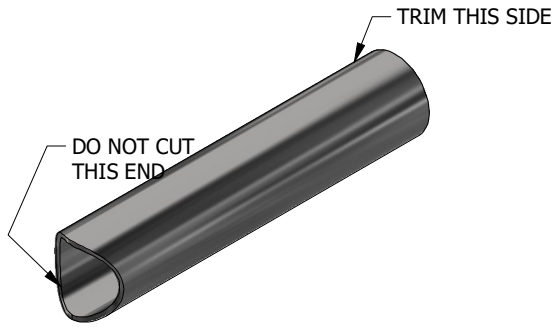

**MB1258-TUBE 03  
BEFORE YOUR CUSTOM TRIMMING**



**MB1258-TUBE 03  
AFTER YOUR CUSTOM TRIMMING**

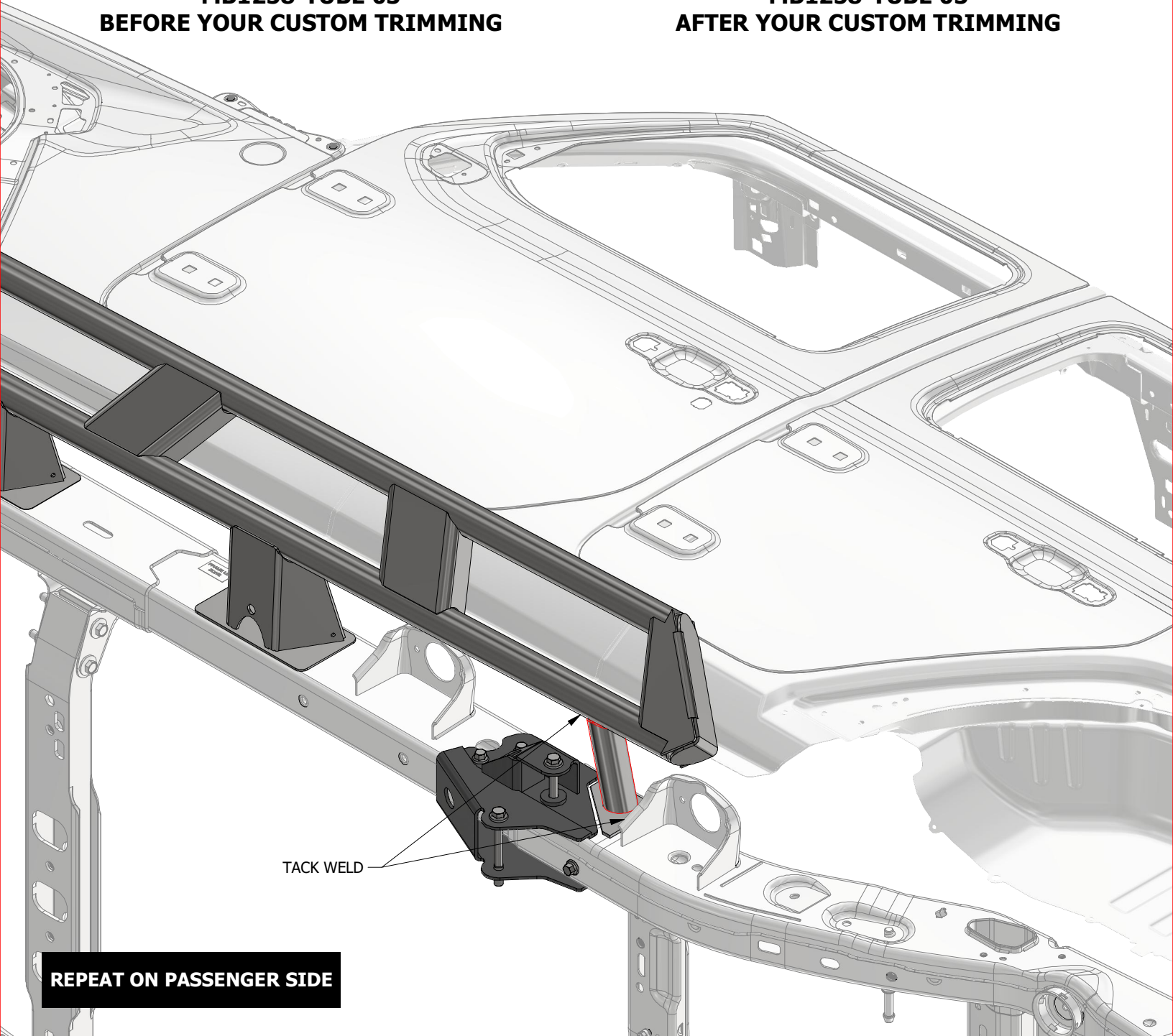

TACK WELD

**REPEAT ON PASSENGER SIDE**



# MB1258 - Assembly Instructions Frame Mounted Rocker Guards for 4 Door

## STEP 5

ONCE ALL PARTS ARE INSTALLED & TACK WELDED,  
FULLY WELD THE PERIMETERS OF THE  
MOUNTING PLATES AND TUBES YOU INSTALLED.

TOUCH UP ALL PAINT WHERE NEEDED.

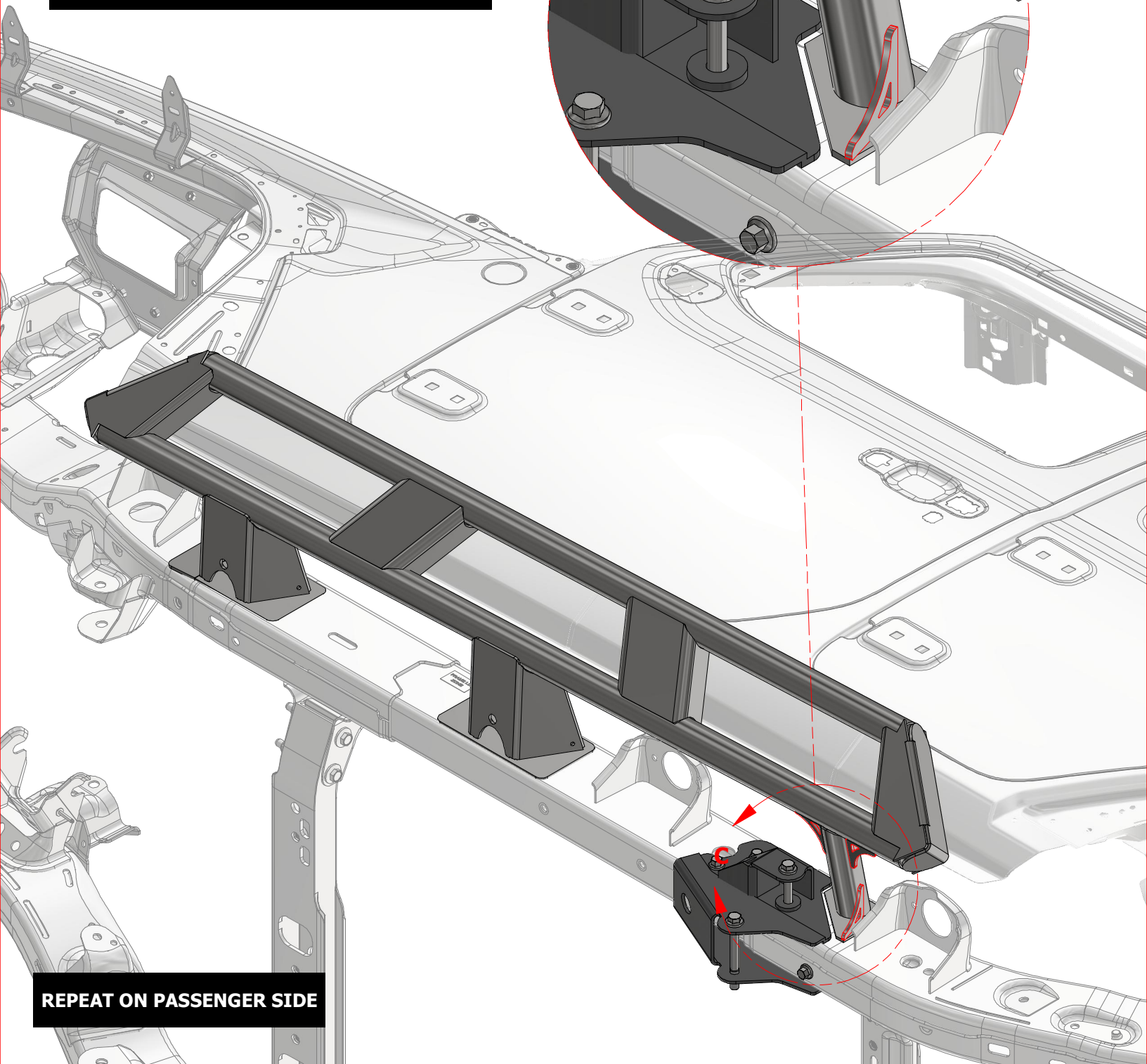

REPEAT ON PASSENGER SIDE



# MB1258 - Assembly Instructions Frame Mounted Rocker Guards for 4 Door

## ALTERNATIVE TUBE POSITIONING

YOUR AFTERMARKET SUSPENSION MAY  
HAVE ALTERNATIVE PLACES TO POSITION  
THE SUPPLIED MOUNTING TUBE

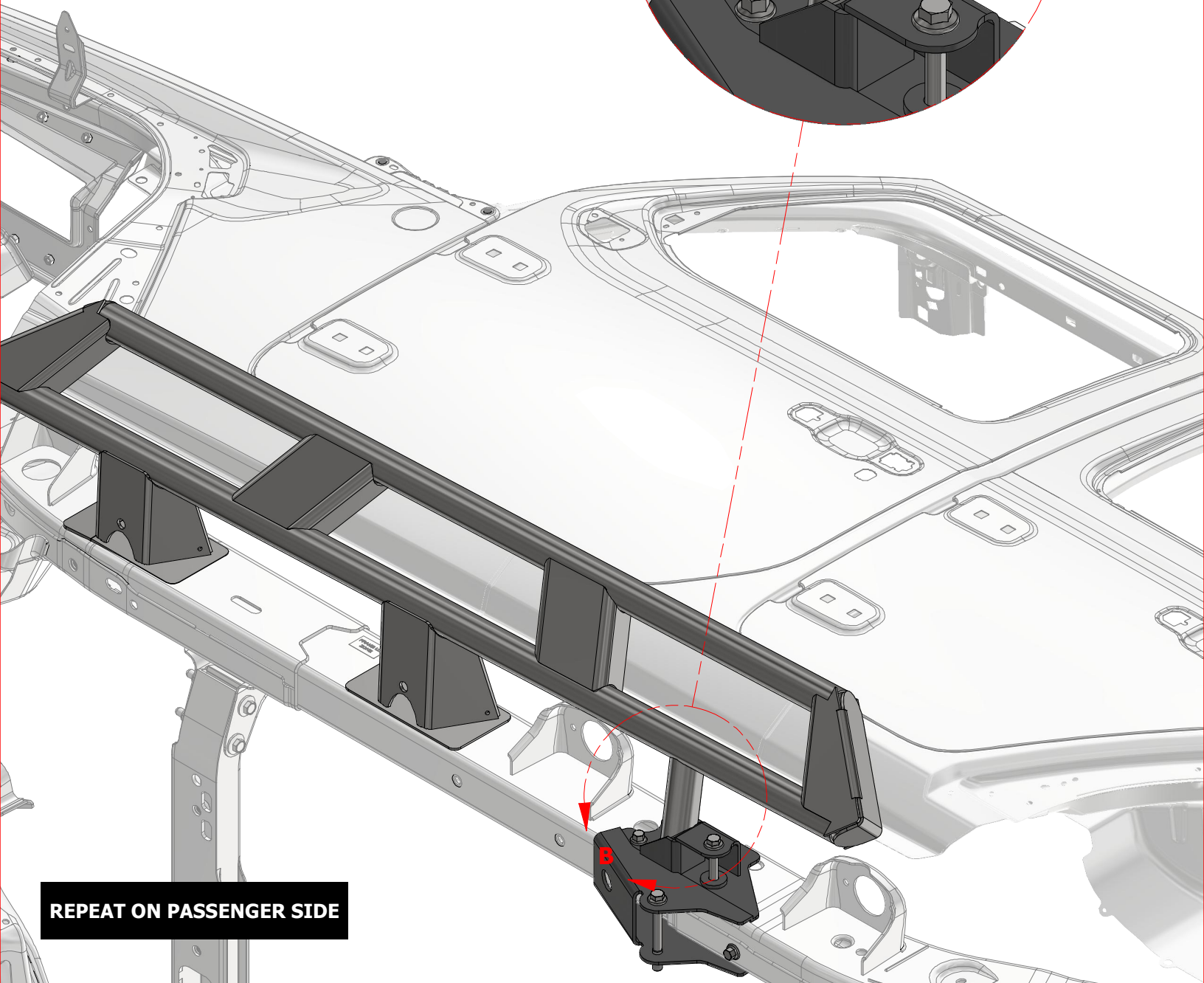
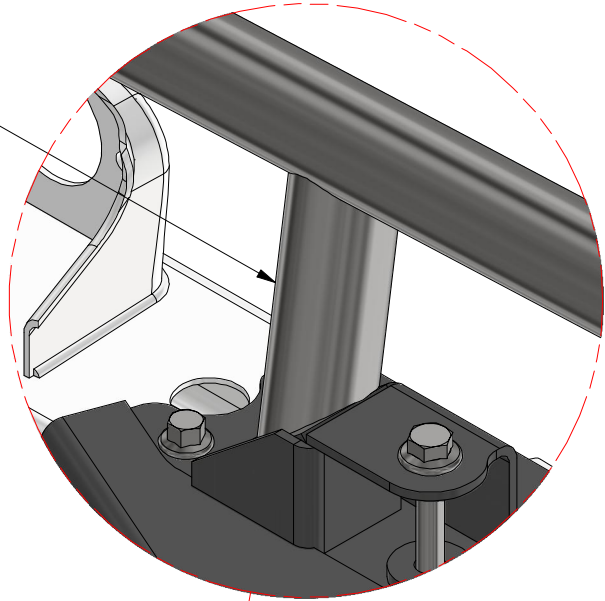

**REPEAT ON PASSENGER SIDE**