

MB1257 - Assembly Instructions Frame Mounted Rocker Guards for 2 Door JK / JL

FRAME MOUNTED ROCKER GUARDS FOR AFTERMARKET LONG ARM SUSPENSIONS

Compatible with 2007-2018 JK 2 Door
Compatible with 2018-Present JL 2 Door

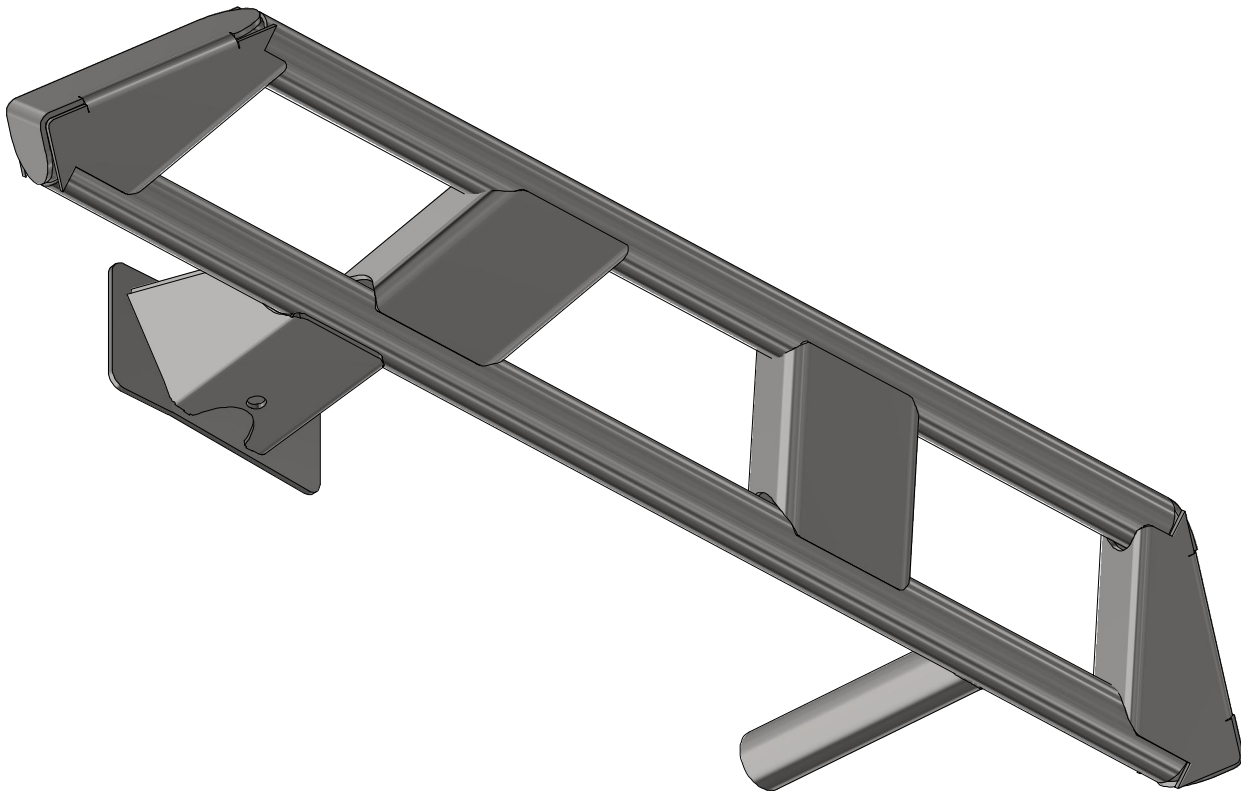

ASSEMBLY INSTRUCTIONS

MB1257 - Assembly Instructions Frame Mounted Rocker Guards for 2 Door JK / JL

CONTENTS

Compatible with 2007-2018 JK 2 Door
Compatible with 2018-Present JL 2 Door

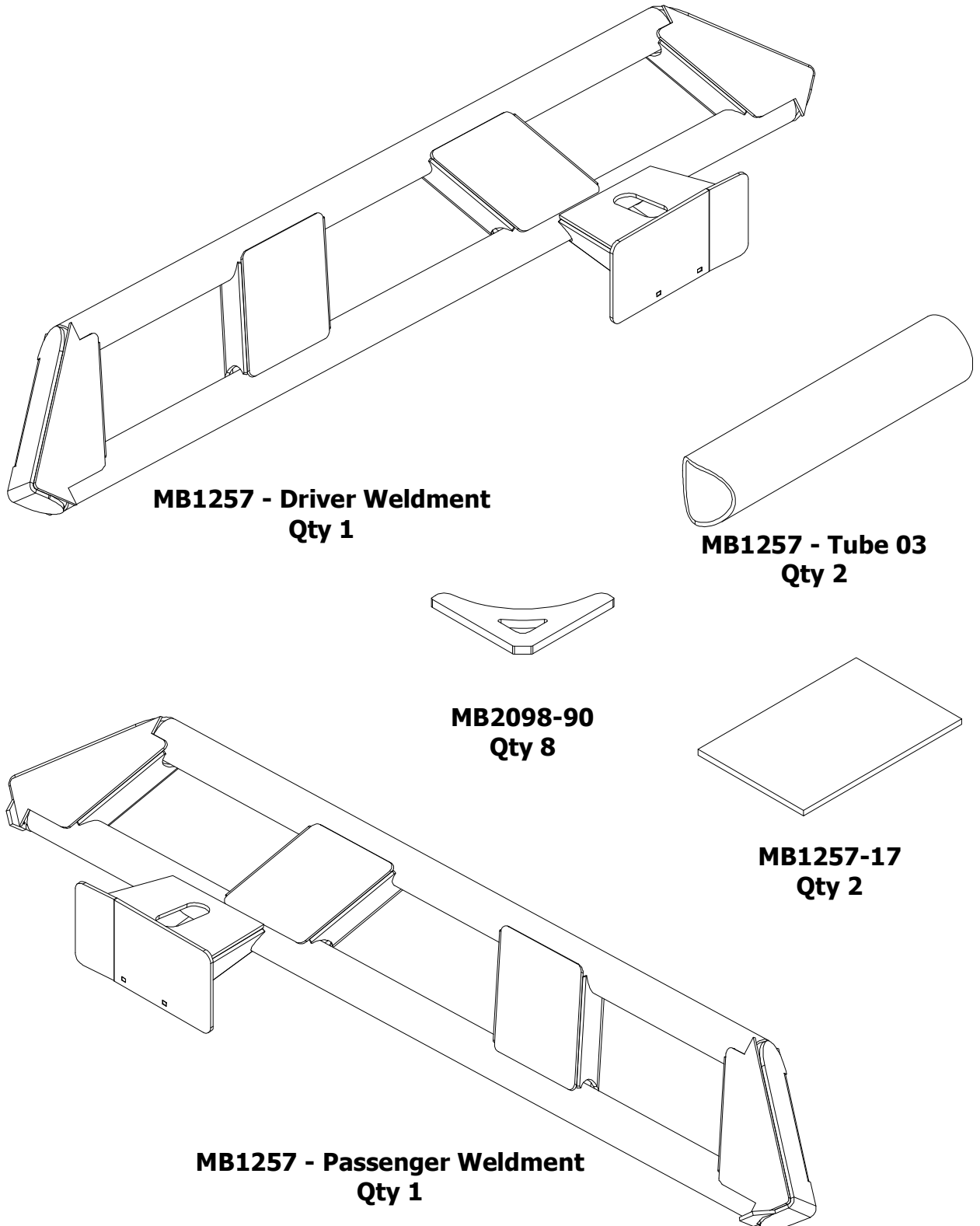

MB1257 - Assembly Instructions Frame Mounted Rocker Guards for 2 Door JK / JL

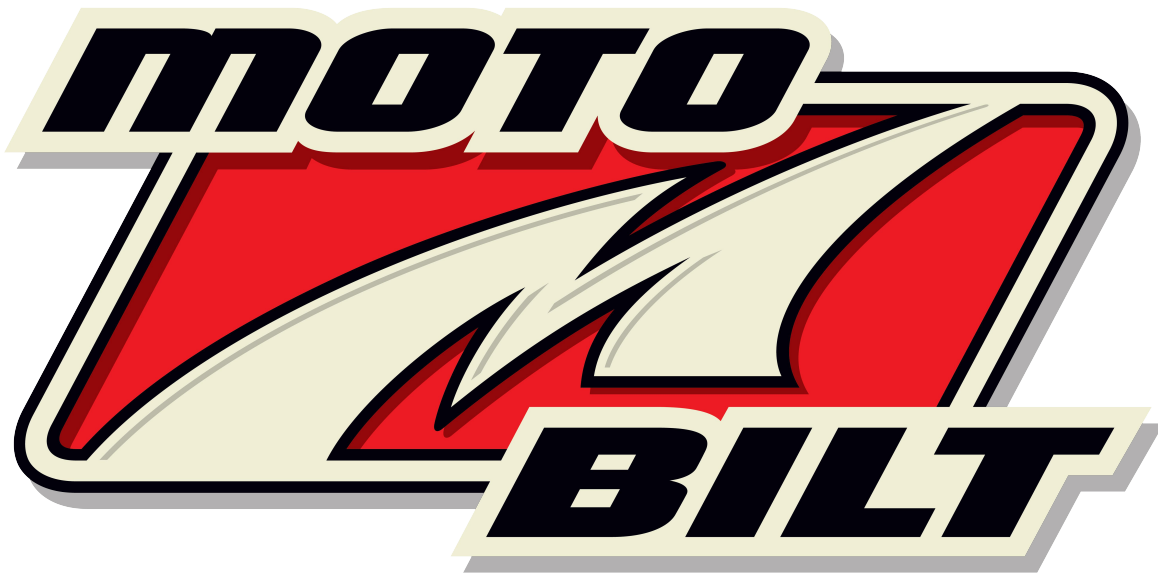

Preparation and Installation Guide

Compatibility: This product fits Jeep JK and Jeep JL 2 Door models. The assembly instructions feature a Jeep JL body and frame, but the same procedures apply to the Jeep JK model.

- 1. Disconnect Batteries:** Before starting the installation, disconnect all batteries.
- 2. Install Lower Rocker Armor:** If you plan to install lower rocker armor (e.g., MB1033 for Jeep JK 2 Door or MB1154 for Jeep JL 2 Door), do this first before proceeding with the weld-on Rocker Guards.
- 3. Prepare for Welding:**
 - Cover or mask all painted areas, glass, mirrors, and trim.
 - Ensure you have a fire extinguisher on hand.
- 4. Paint or Powder Coat Parts:** Paint or powder coat all parts before installation. Note that welding will require touch-ups on painted areas.
- 5. Remove Factory Paint:** Remove factory paint from the frame where welding will occur.
- 6. Weld the Product:** Weld the product to the frame of the vehicle.
- 7. Touch Up Paint:** After welding, touch up the frame and any affected areas with paint.

Pro Tip: Use STEEL-IT paint, which can be welded through and easily touched up afterward.

MB1257 - Assembly Instructions Frame Mounted Rocker Guards for 2 Door JK / JL

STEP 1

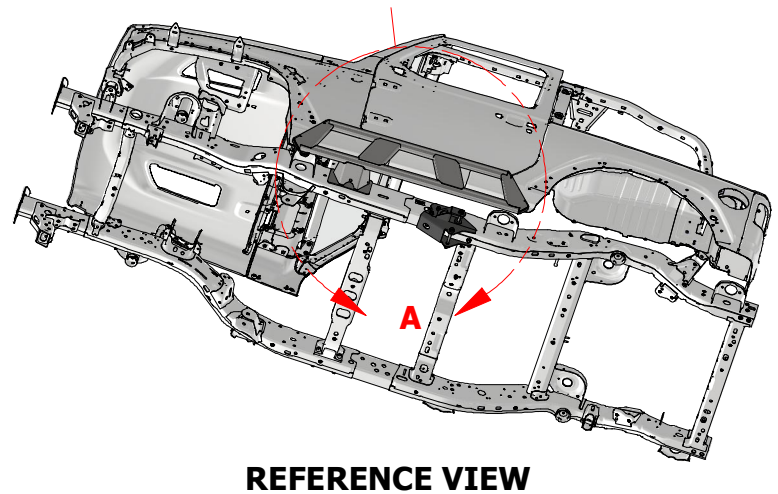
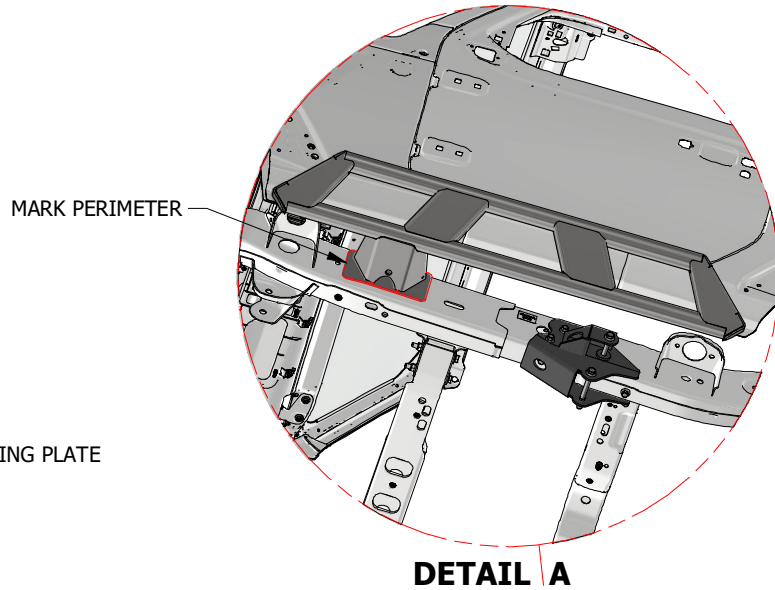
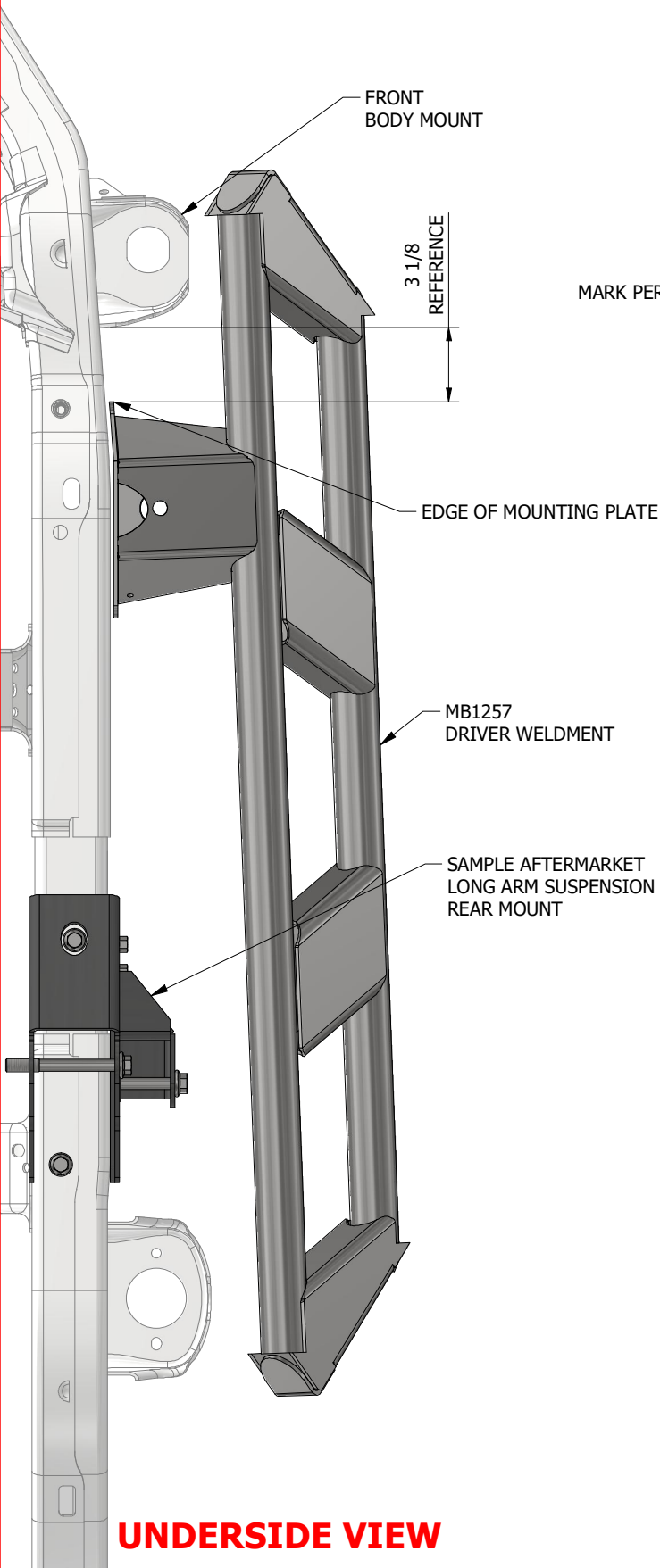

1. CLAMP THE DRIVER WELDMENT TO THE FRAME IN THE POSITION AS SHOWN.
2. MARK THE PERIMETER OF THE MOUNTING PLATE.
3. UNCLAMP & REMOVE THE DRIVER WELDMENT.
4. GRIND PAINT OFF FRAME IN MARKED LOCATION.
5. REINSTALL & CLAMP DRIVER WELDMENT IN POSITION SHOWN.
6. TACK WELD MOUNTING PLATE TO FRAME.

REPEAT ON PASSENGER SIDE

MB1258-17 - Sample Plate 01 - Template

STEP 2

YOUR CARDBOARD TEMPLATE

NOTE:
YOUR TEMPLATE SHAPE MAY BE
DIFFERENT THAN SHOWN

REMOVE PAINT
FROM FRAME

REPEAT ON PASSENGER SIDE

THE SHAPES & LOCATIONS OF AFTERMARKET LONG TRAVEL SUSPENSION BRACKETS WILL VARY BY MANUFACTURER. IF THERE IS ROOM, IDEALLY YOU WANT TO TIE INTO THE FRAME. YOU WILL CREATE YOUR OWN TUBE BACKING PLATE BY FIRST CREATING A CARDBOARD TEMPLATE OF THE AVAILABLE SPACE.

Plate 17 - Template Transfer

STEP 3

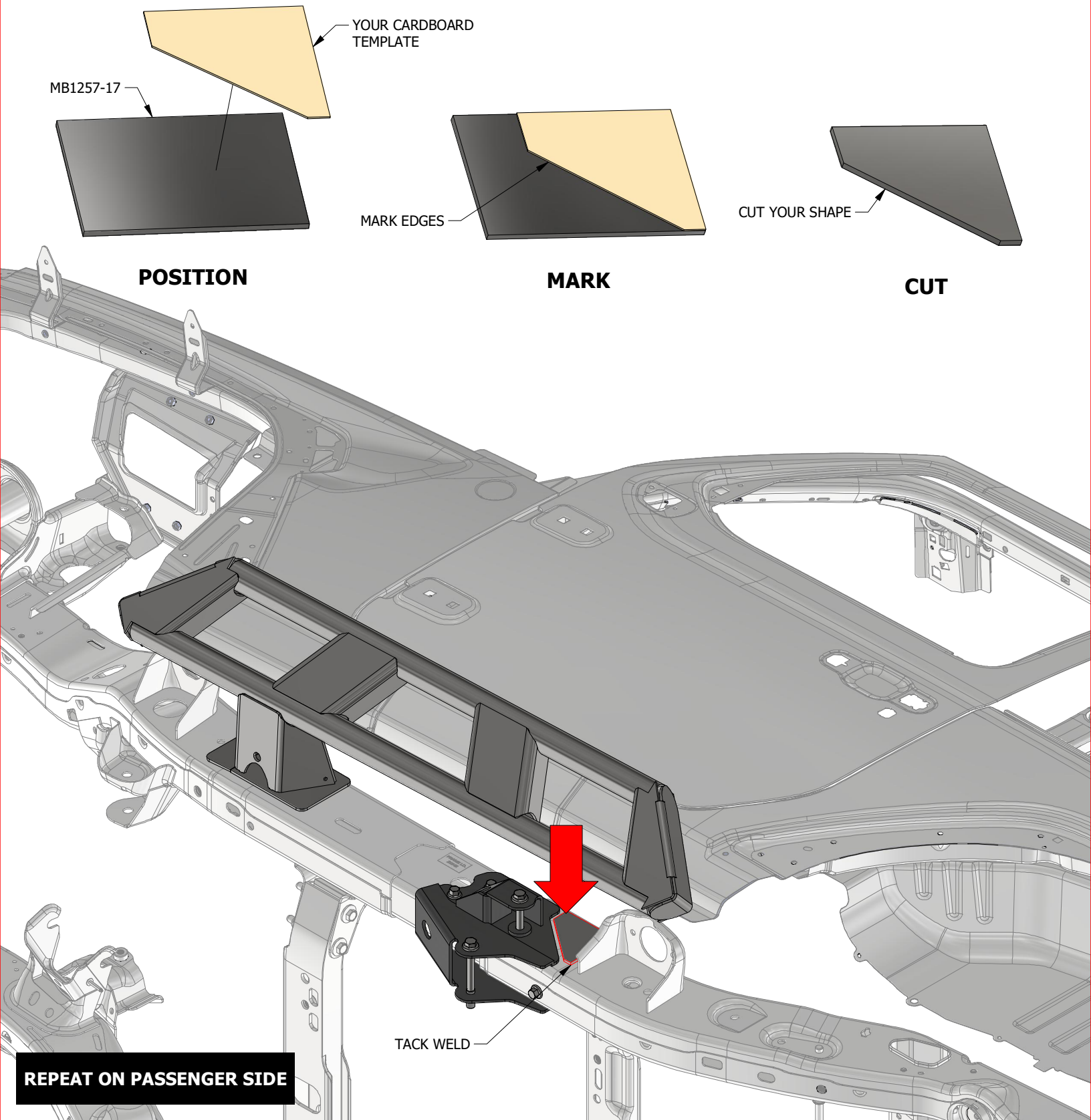

MB1257 - Assembly Instructions Frame Mounted Rocker Guards for 2 Door JK / JL

STEP 4



**MB1257-TUBE 03
BEFORE YOUR CUSTOM TRIMMING**

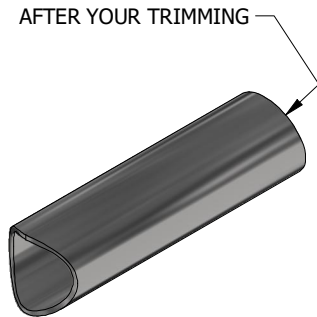

**MB1257-TUBE 03
AFTER YOUR CUSTOM TRIMMING**

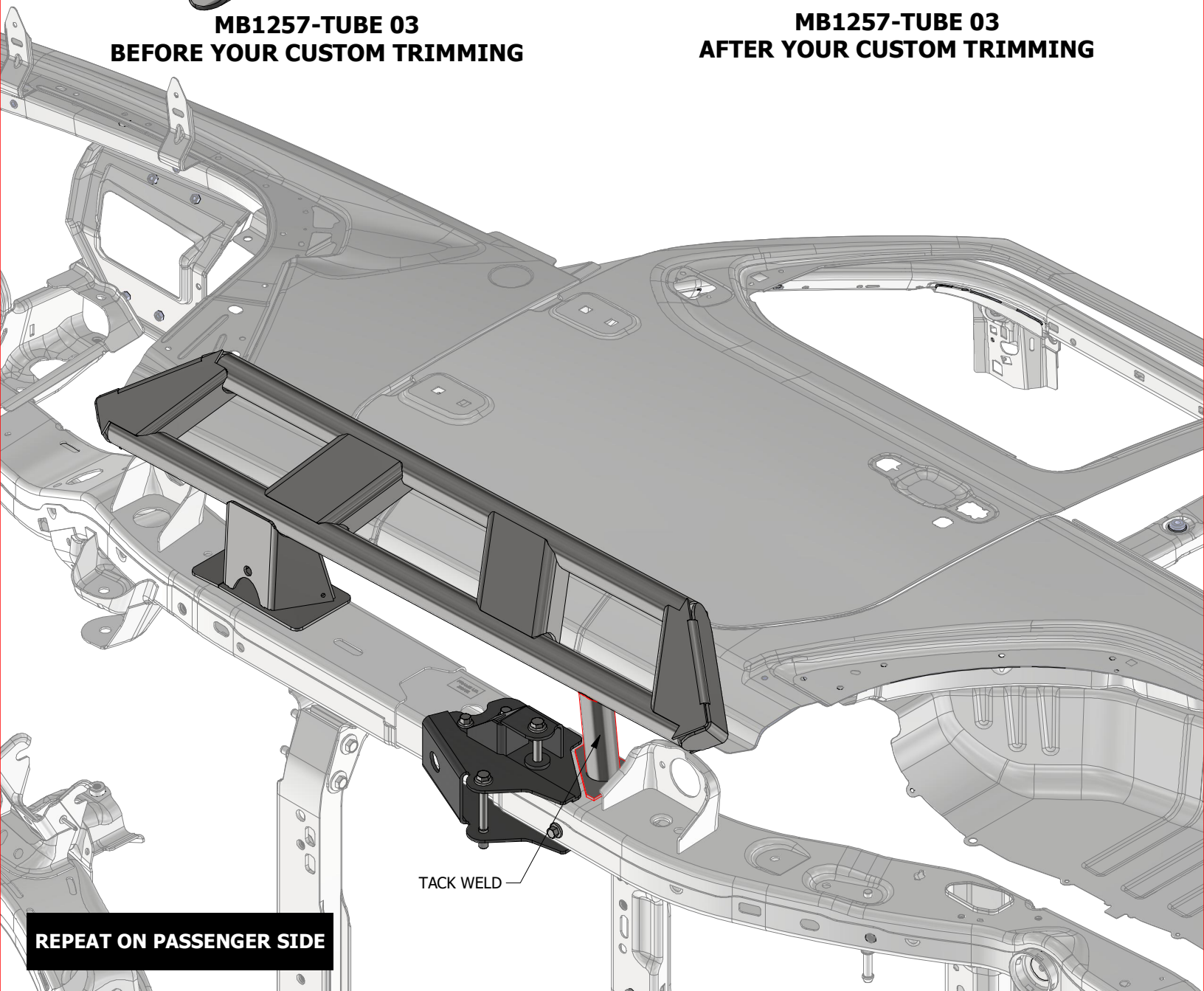

REPEAT ON PASSENGER SIDE

MB1257 - Assembly Instructions Frame Mounted Rocker Guards for 2 Door JK / JL

STEP 5

ONCE ALL PARTS ARE INSTALLED & TACK WELDED,
FULLY WELD THE PERIMETERS OF THE
MOUNTING PLATES AND TUBES YOU INSTALLED.

TOUCH UP ALL PAINT WHERE NEEDED.

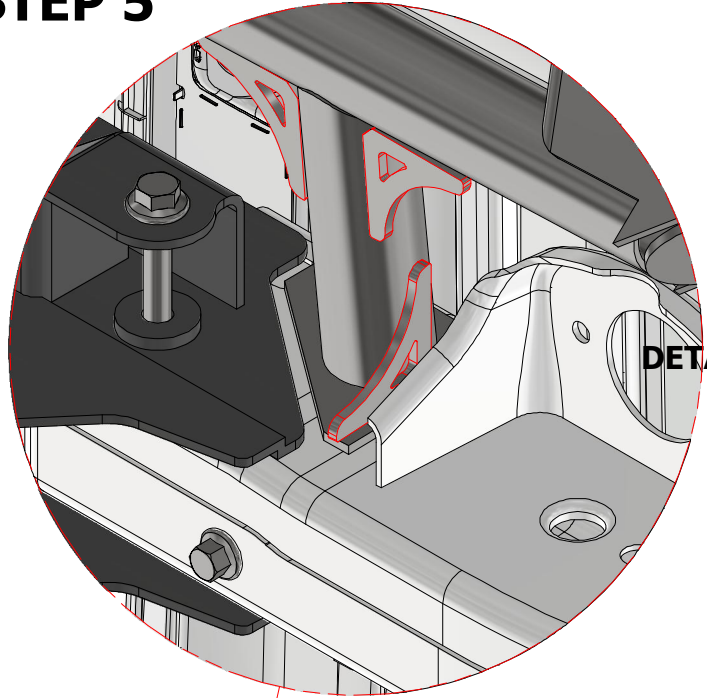

DETAIL B

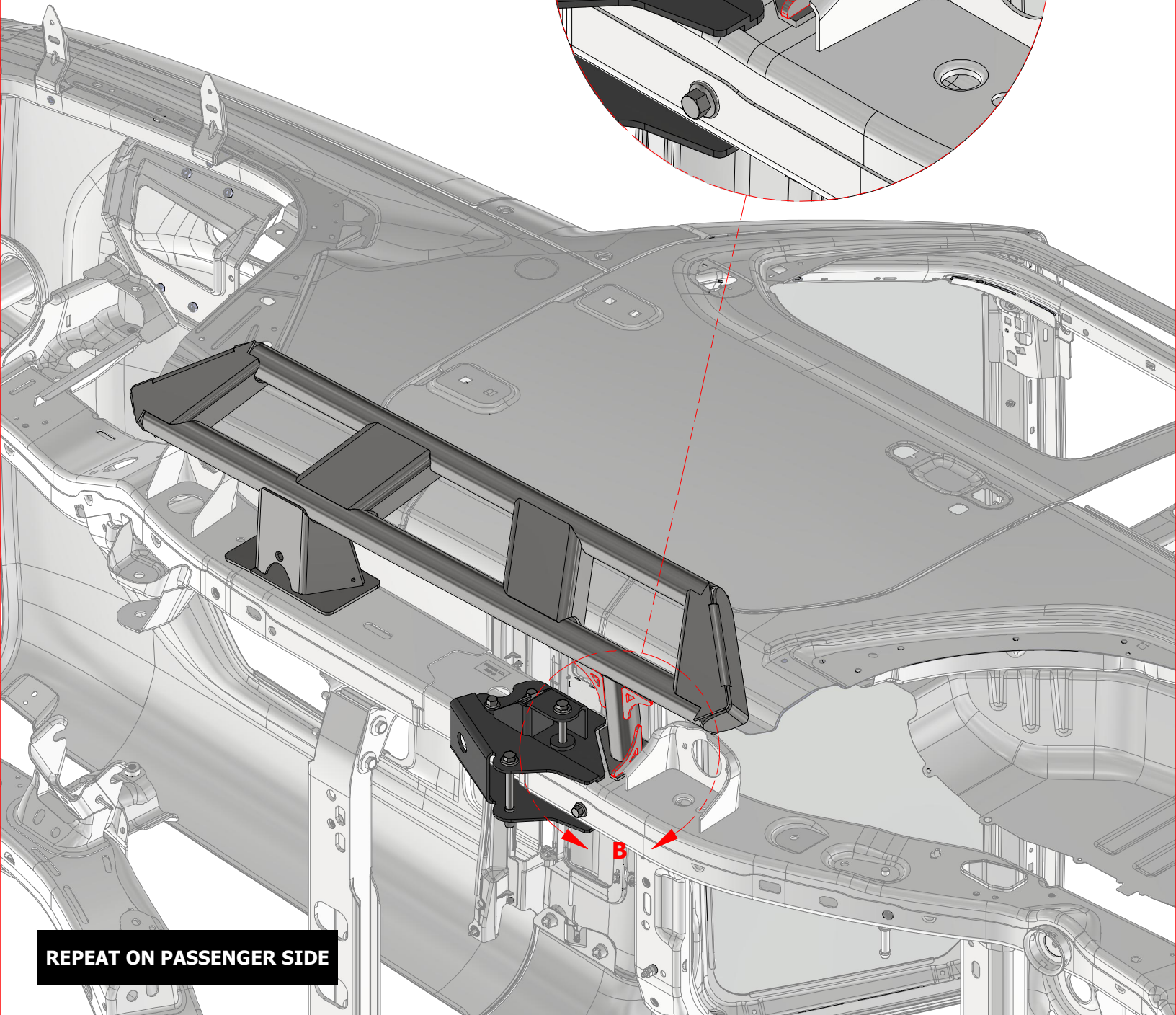

REPEAT ON PASSENGER SIDE