

**MB5026 - Assembly Instructions JL/JLU Rear Fuel Tank and Skid**

# JL/JLU REAR FUEL TANK FOR FACTORY FRAME

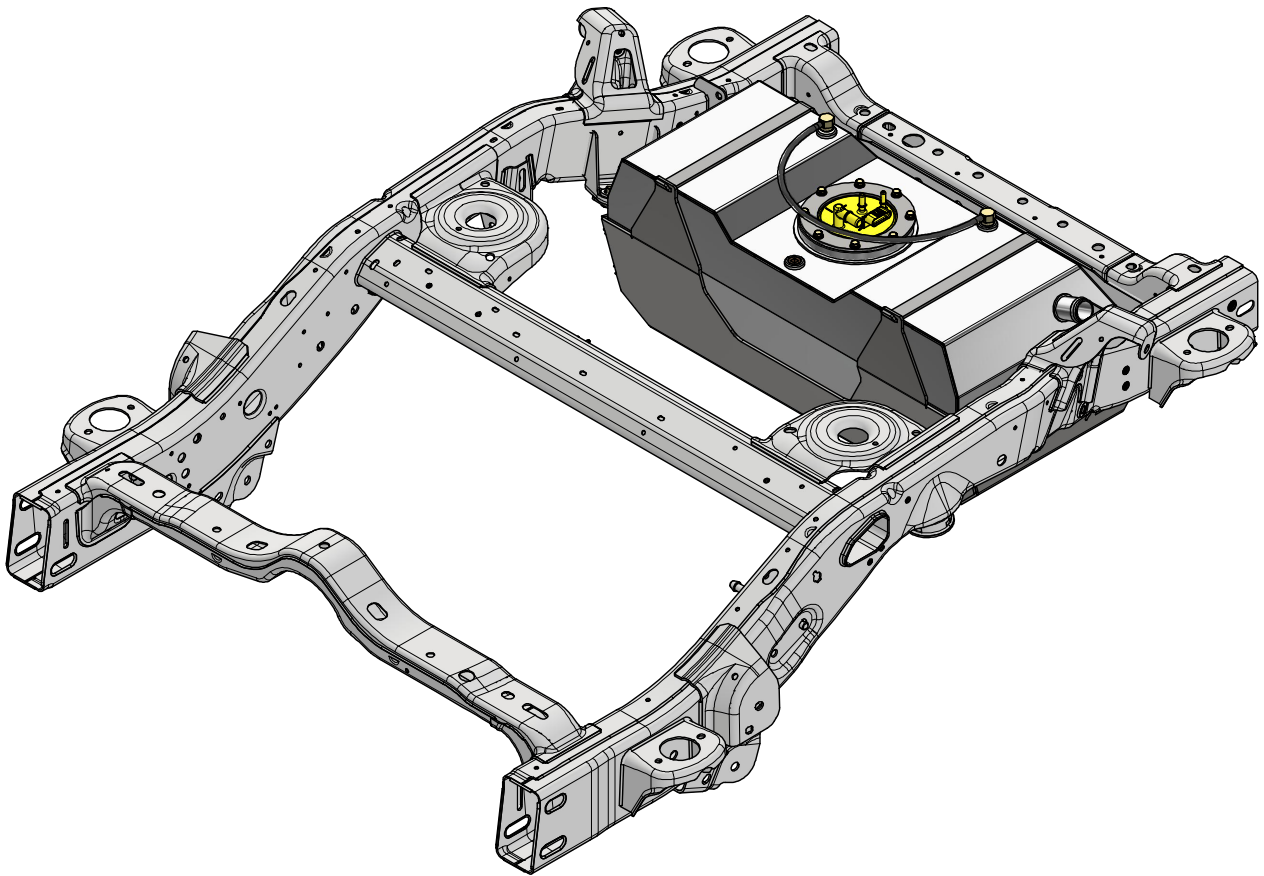

## ASSEMBLY INSTRUCTIONS

# **MB5026 - Assembly Instructions JL/JLU Rear Fuel Tank and Skid**

## **KIT COMPONENTS**

**RUBBER HOSE**  
5/16"; 24"  
Qty: 1

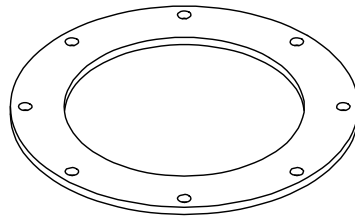

**MB5515-02**  
Qty 1

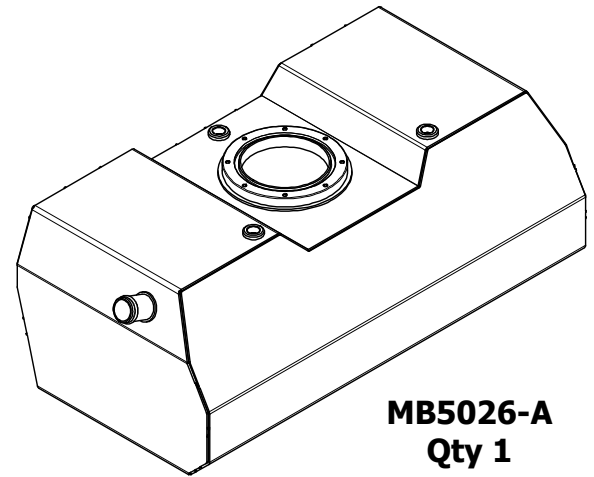

**MB5026-A**  
Qty 1

**RUBBER STRIP**  
Qty: 2

**MB5028**  
**FUEL EXTENSION ROD**  
Qty: 2

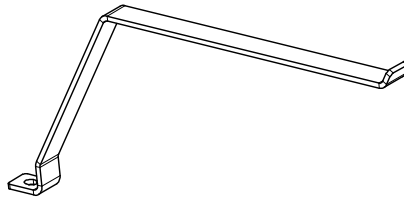

**MB5026-05**  
Qty 2

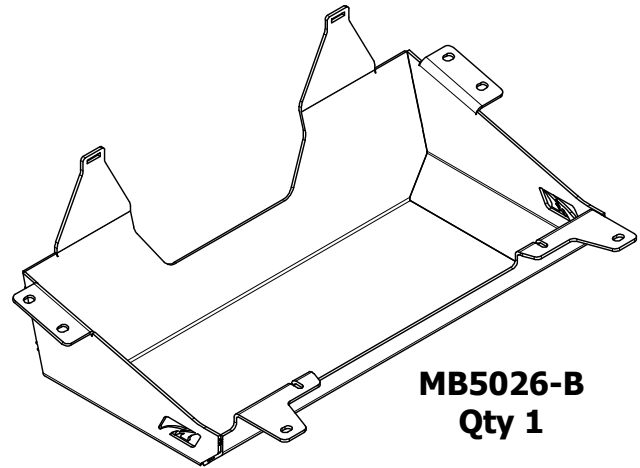

**MB5026-B**  
Qty 1

**HEX BOLT**  
1/4"-20 x 1"  
Qty 8

**LOCK WASHER**  
1/4"  
Qty 10

**FLAT WASHER**  
1/4"  
Qty 8

**ROLL OVER VALVE**  
Qty: 2

**NPT PLUG**  
1/2" NPT  
Qty: 1

**RETAINING RING**  
5mm  
Qty: 3

**HEX BOLT**  
3/8"-16 x 1-1/4"  
Qty 2

**FLAT WASHER**  
3/8"  
Qty 4

**NYLOCK NUT**  
3/8"-16  
Qty 2

**HOSE CLAMP**  
1/2"  
Qty: 2

**RIVNUT**  
M10 x 1.5  
Qty: 2

**HEX BOLT**  
M10-1.5 x 25mm  
Qty 6

**FLAT WASHER**  
7/16"  
Qty 6

# MB5026 - Assembly Instructions JL/JLU Rear Fuel Tank and Skid

## FUEL SENDING UNIT DISASSEMBLY

DISASSEMBLE THE FUEL SENDING UNIT AND REMOVE THE FACTORY EXTENSIONS RODS. THE FACTORY EXTENSION RODS POP OUT FROM THE TOP OF THE SENDING UNIT AND THE EXTENSION RODS CAN BE REMOVED. THE EXTENSION RODS CAN BE DIFFICULT TO REMOVE. TAKE CARE NOT TO DAMAGE THE FUEL SENDING UNIT TOP WHEN REMOVING THE EXTENSION RODS

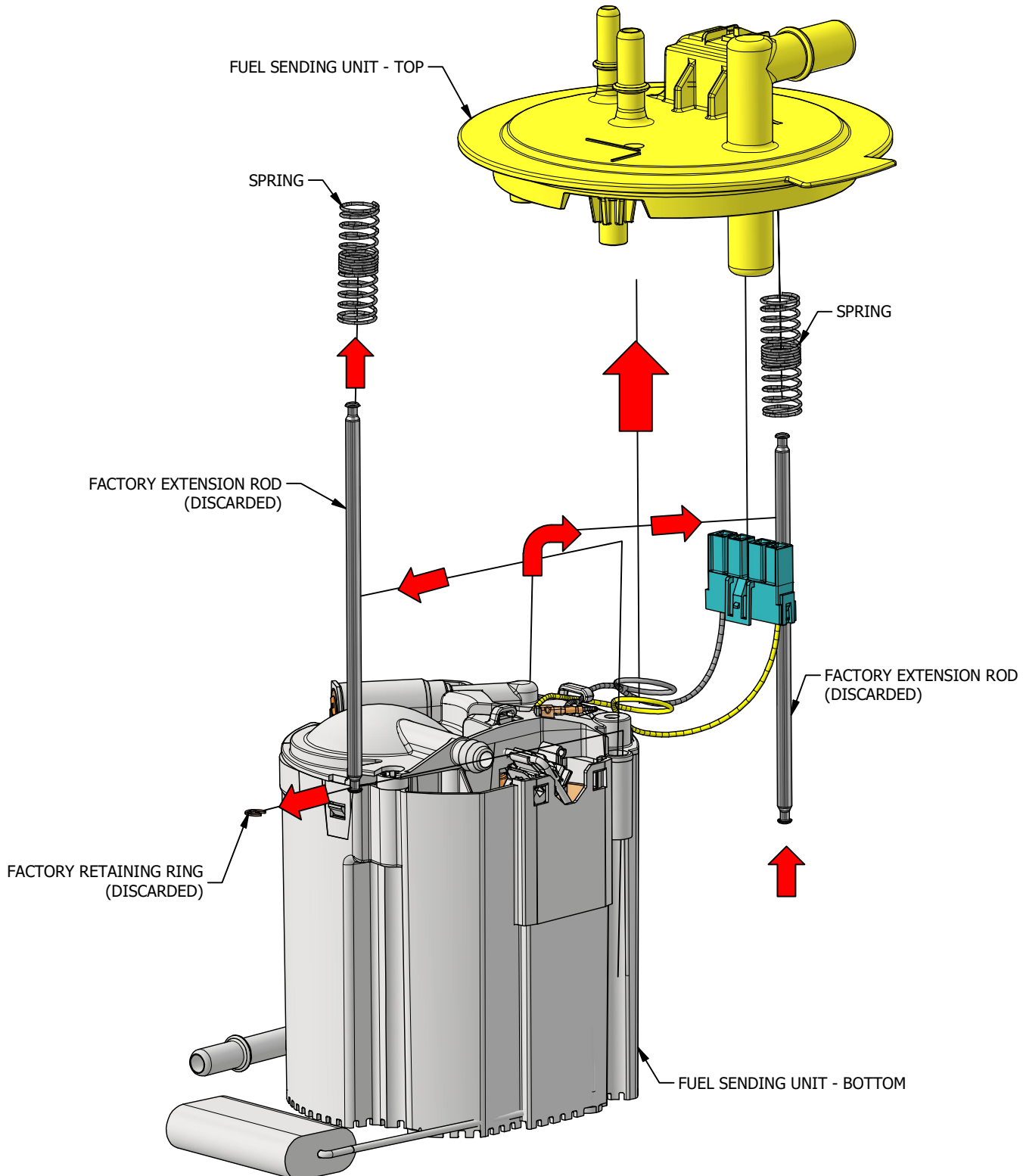

# MB5026 - Assembly Instructions JL/JLU Rear Fuel Tank and Skid

## FUEL SENDING UNIT RE-ASSEMBLY

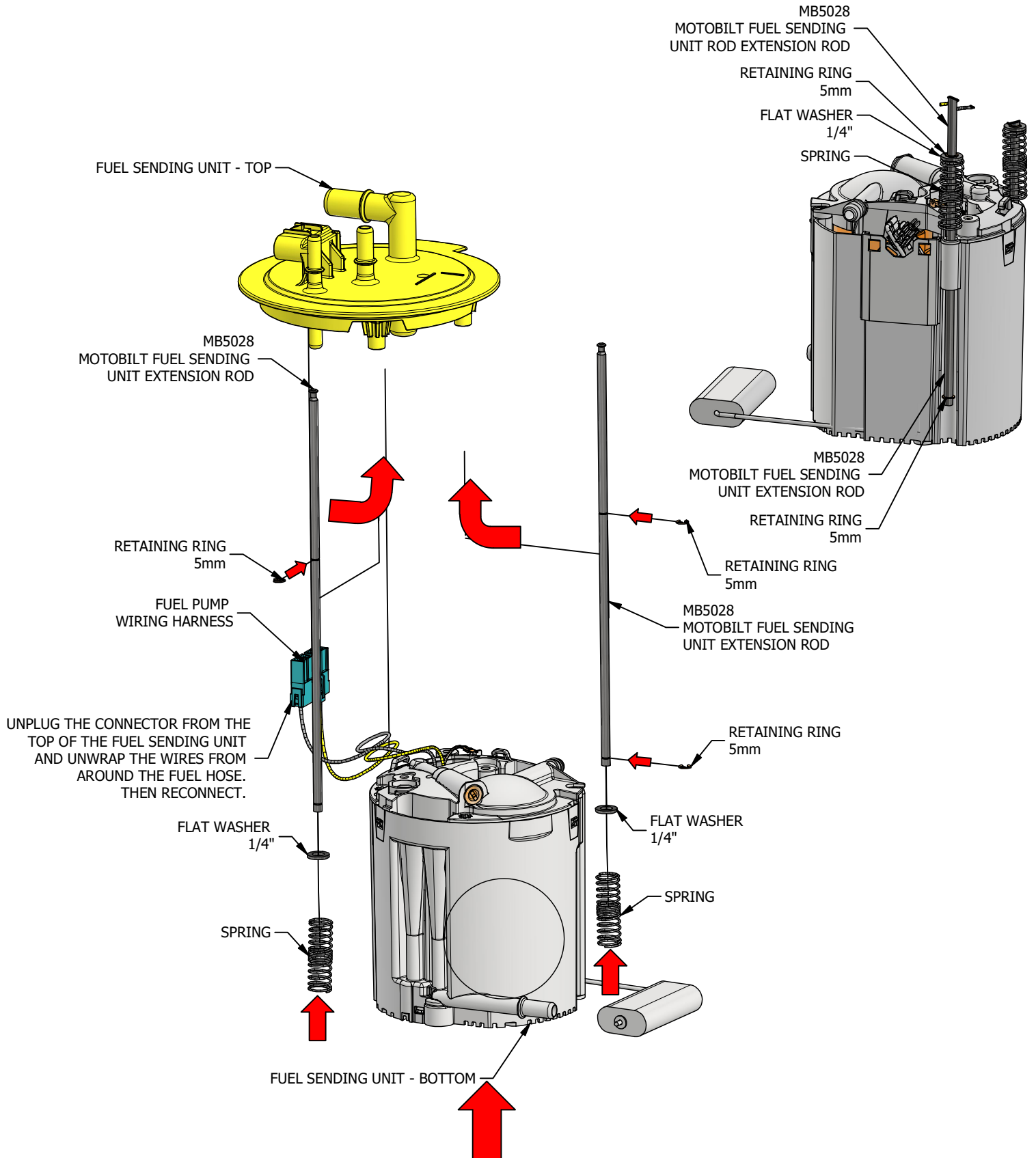

# MB5026 - Assembly Instructions JL/JLU Rear Fuel Tank and Skid

## TANK PREPARATION

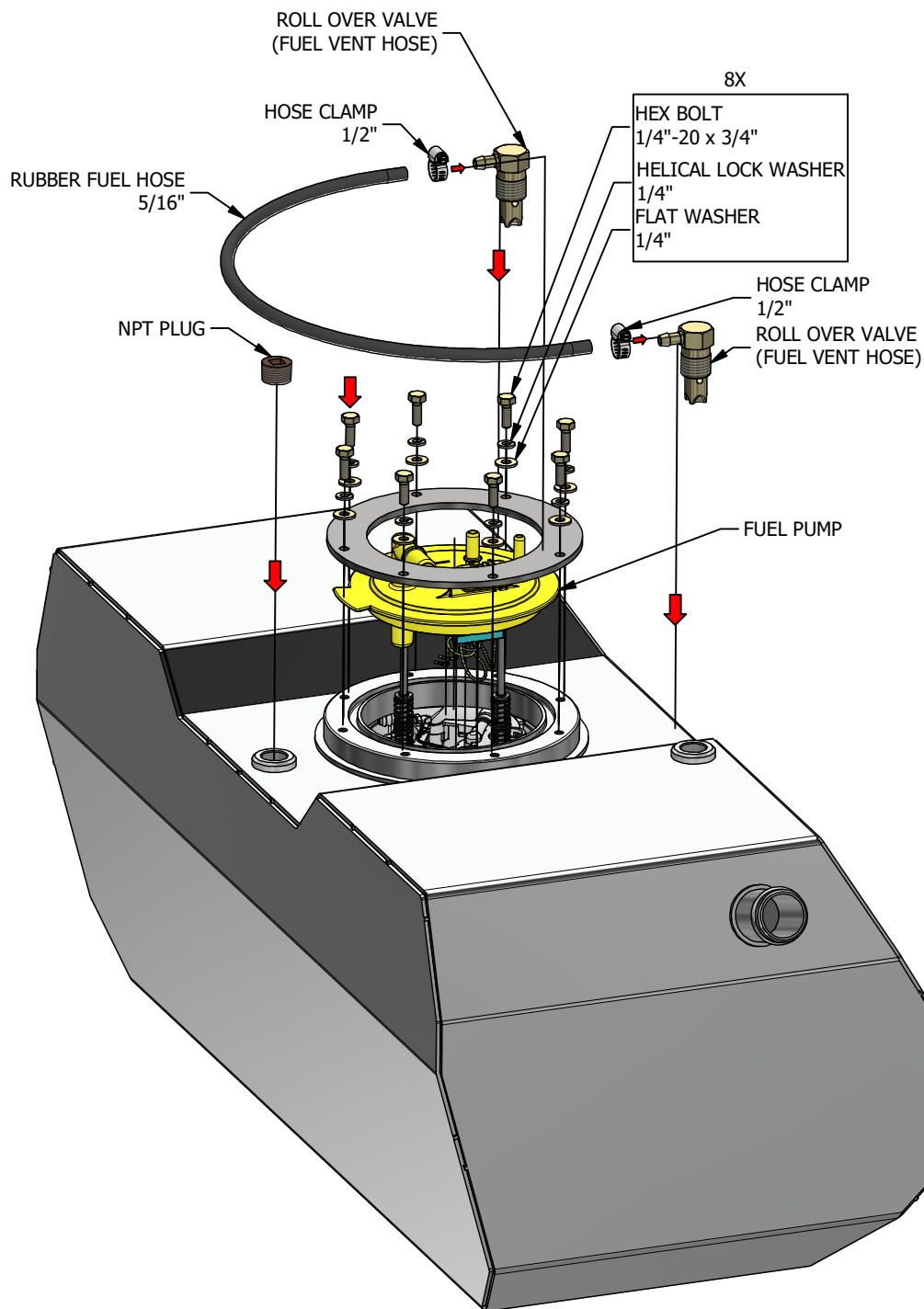

# MB5026 - Assembly Instructions JL/JLU Rear Fuel Tank and Skid

## SKID ASSEMBLY

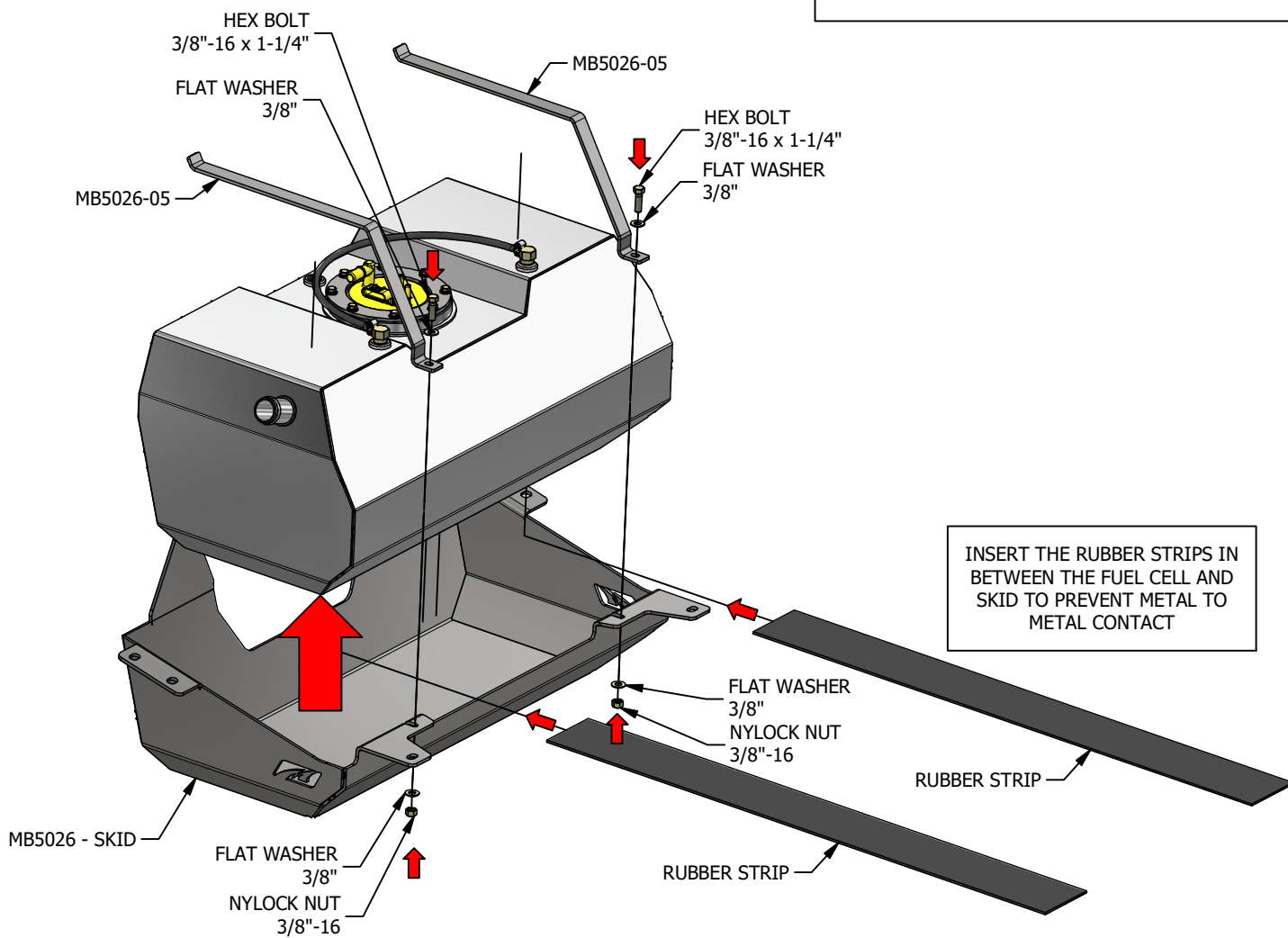
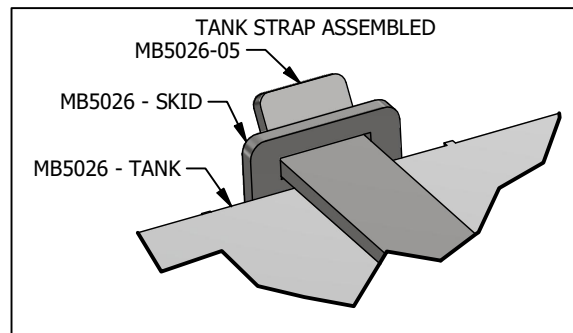

# MB5026 - Assembly Instructions JL/JLU Rear Fuel Tank and Skid

## RIVNUT INSTALLATION

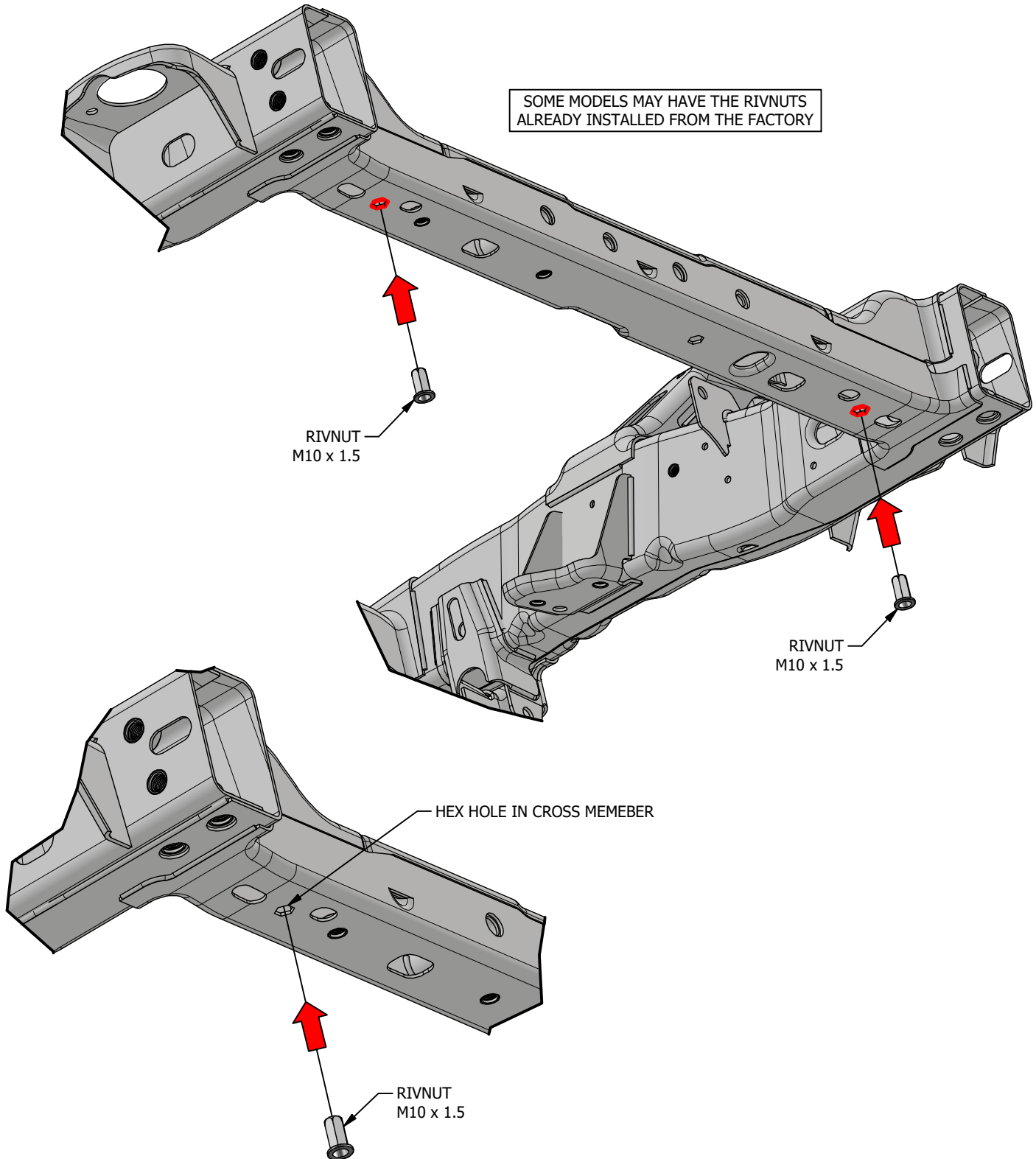



# MB5026 - Assembly Instructions JL/JLU Rear Fuel Tank and Skid

## MOUNTING TO FRAME

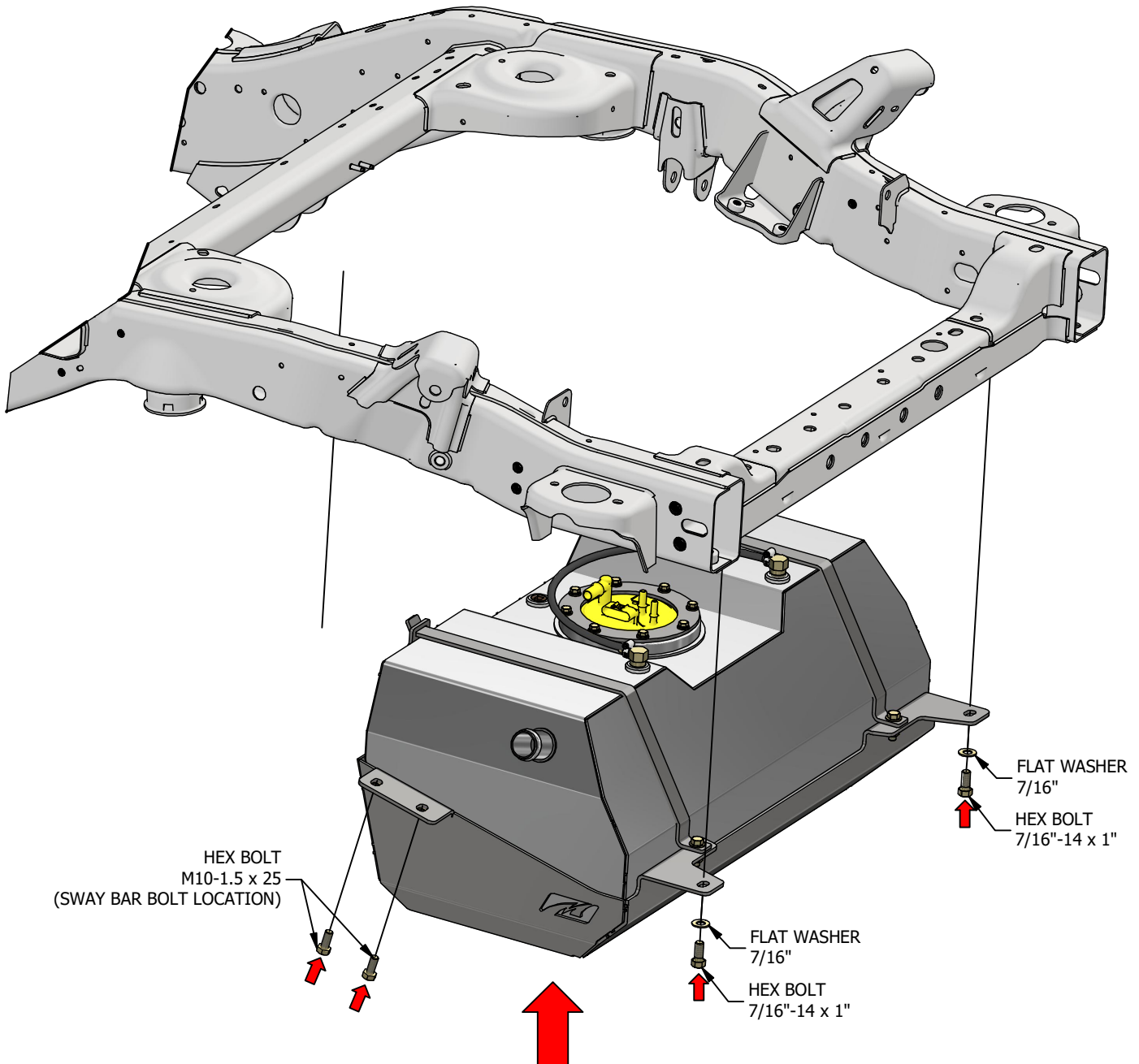

**NOTE:** TRIMMING OF THE REAR BUMPER MAY BE REQUIRED TO GAIN ACCESS TO THE HOLES IN THE CROSS MEMBER.



# MB5026 - Assembly Instructions JL/JLU Rear Fuel Tank and Skid

## BUMPER TRIMMING

SOME BUMPERS MAY REQUIRE TRIMMING TO GAIN ACCESS TO THE HOLES IN THE CROSS MEMBER REQUIRED TO MOUNT THE TANK. IF YOU HAVE A MOTOBILT REAR CRUSHER SERIES BUMPER FOLLOW THE DIRECTIONS BELOW TO CLEARANCE YOUR BUMPER FOR THE MOTOBILT REAR FUEL TANK.

