

# HIGH LINE FENDERS AND INNER FENDERS TJ/LJ

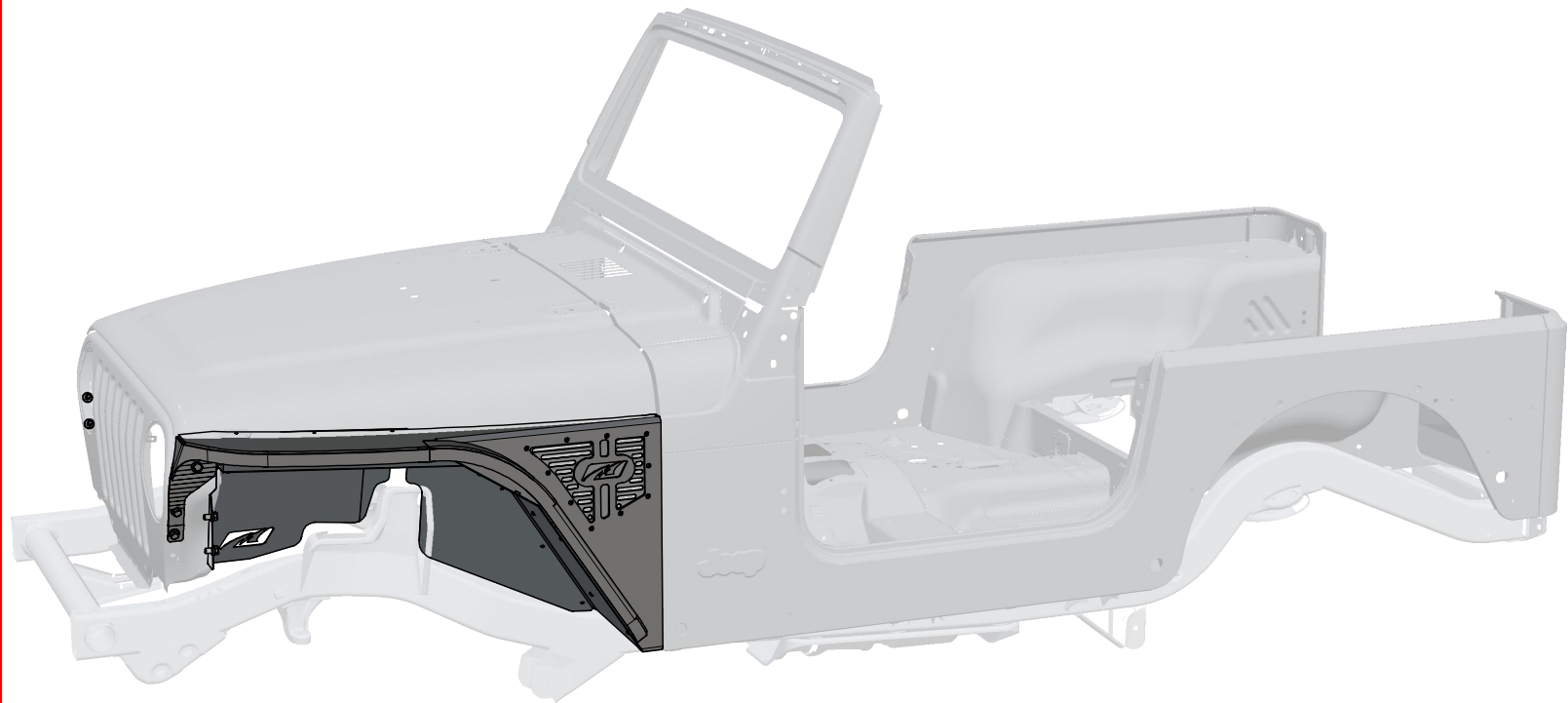

## ASSEMBLY INSTRUCTIONS

MB1083 - Assembly Instructions High Line Flat Fender and Inner Fender

KIT COMPONENTS - FENDER

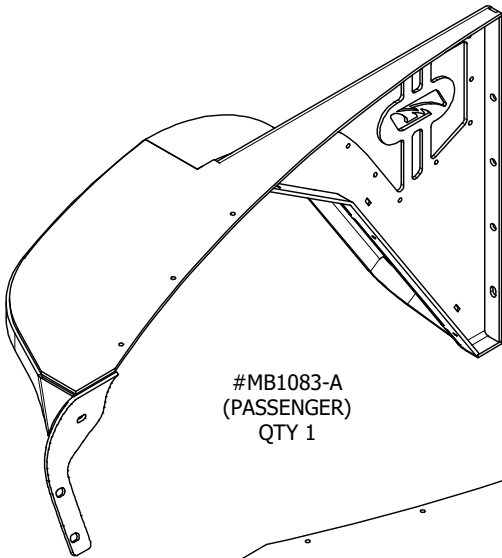

#MB1083-A  
(PASSENGER)  
QTY 1

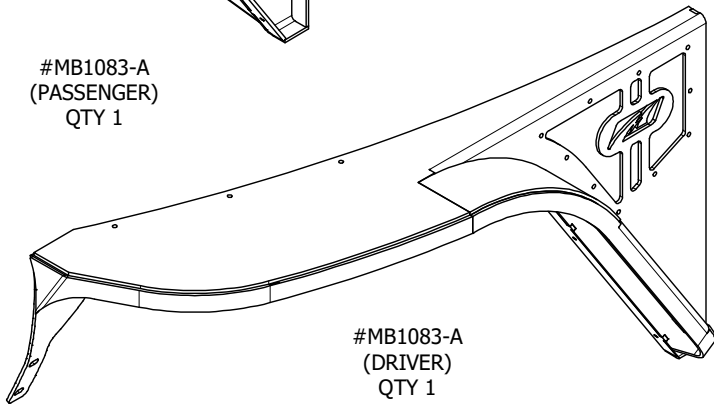

#MB1083-A  
(DRIVER)  
QTY 1

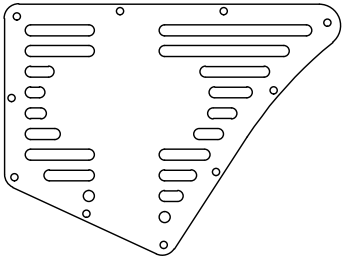

#MB1083-VT  
VENTED SIDE PLATE  
QTY 2

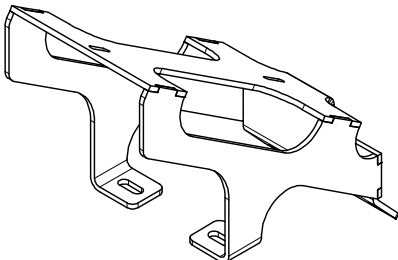

#MB1083-BA FENDER SUPPORT  
QTY 1

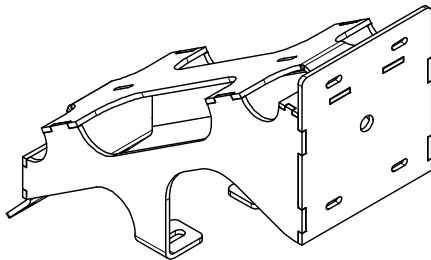

#MB1083-BA BATTERY SUPPORT  
QTY 1

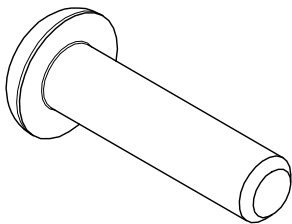

BUTTON HEAD SOCKET CAP SCREW STAINLESS  
#10-24 x 3/4"  
QTY 20

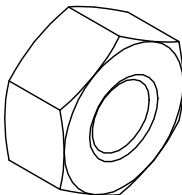

NYLOCK HEX NUT ZINC  
#10-24  
QTY 20

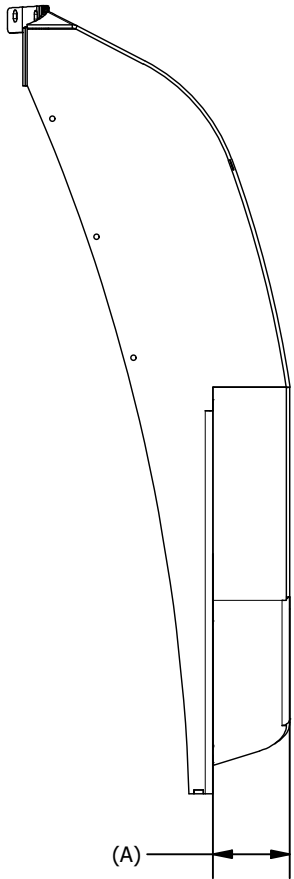
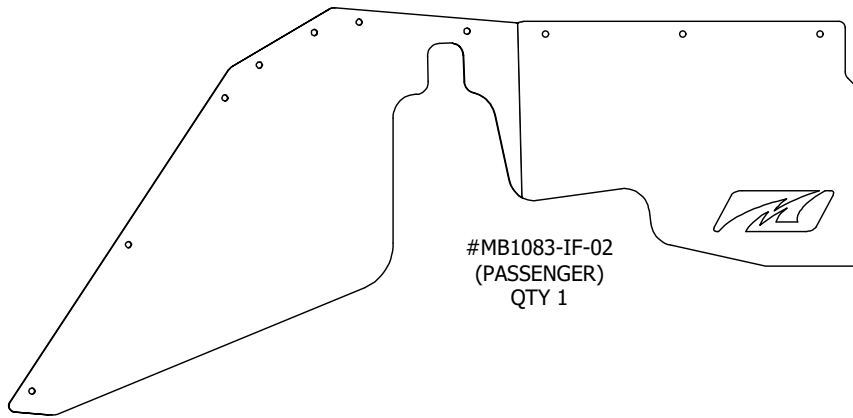

TABLE	
PART #	DIMENSION (in)
MB1083-0	0
MB1083-2	2
MB1083-4	4
MB1083-6	6

# MB1083 - Assembly Instructions High Line Flat Fender and Inner Fender

## KIT COMPONENTS - INNER FENDER



#MB1083-IF-02  
(PASSENGER)  
QTY 1

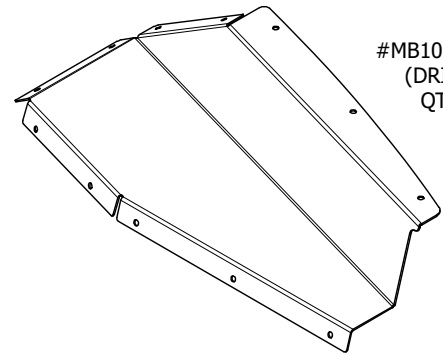

#MB1083-IF-01  
(DRIVER)  
QTY 1

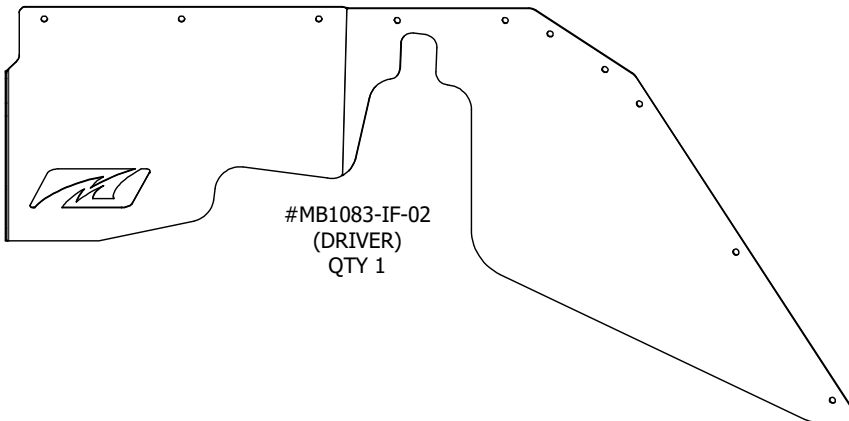

#MB1083-IF-02  
(DRIVER)  
QTY 1

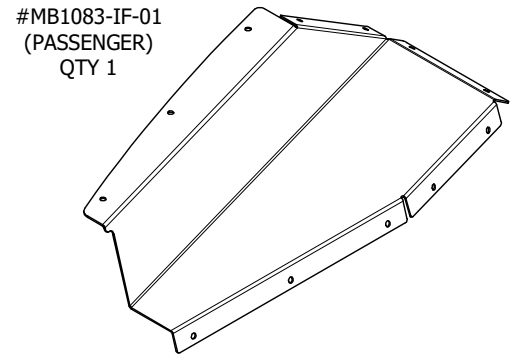

#MB1083-IF-01  
(PASSENGER)  
QTY 1

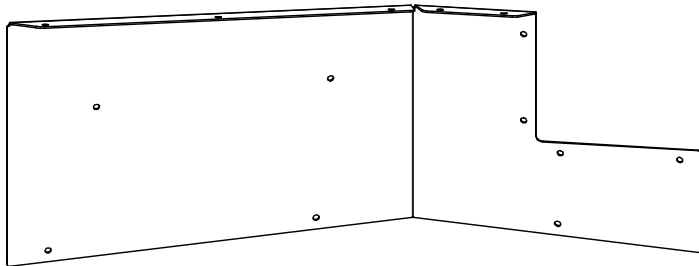

#MB1083-IF-03  
(PASSENGER)  
QTY 1

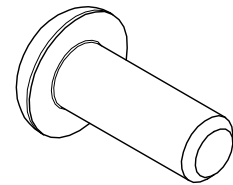

BUTTON HEAD SOCKET CAP SCREW STAINLESS  
#10-24 x 1/2"  
QTY 44

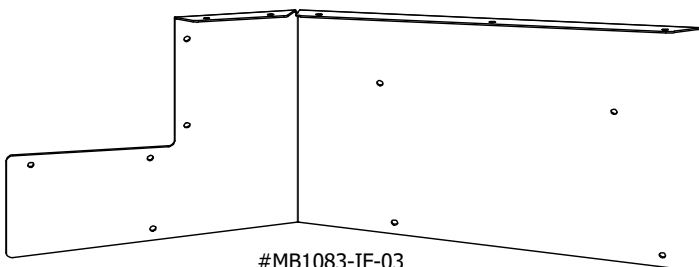

#MB1083-IF-03  
(DRIVER)  
QTY 1

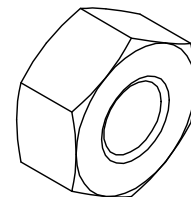

NYLOCK HEX NUT ZINC  
#10-24  
QTY 44

## MB1083 - Assembly Instructions High Line Flat Fender and Inner Fender

### HOOD TRIMMING

THE FACTORY AIR CLEANER AND FUSE BOX WILL NEED TO BE REMOVED OR RELOCATED.

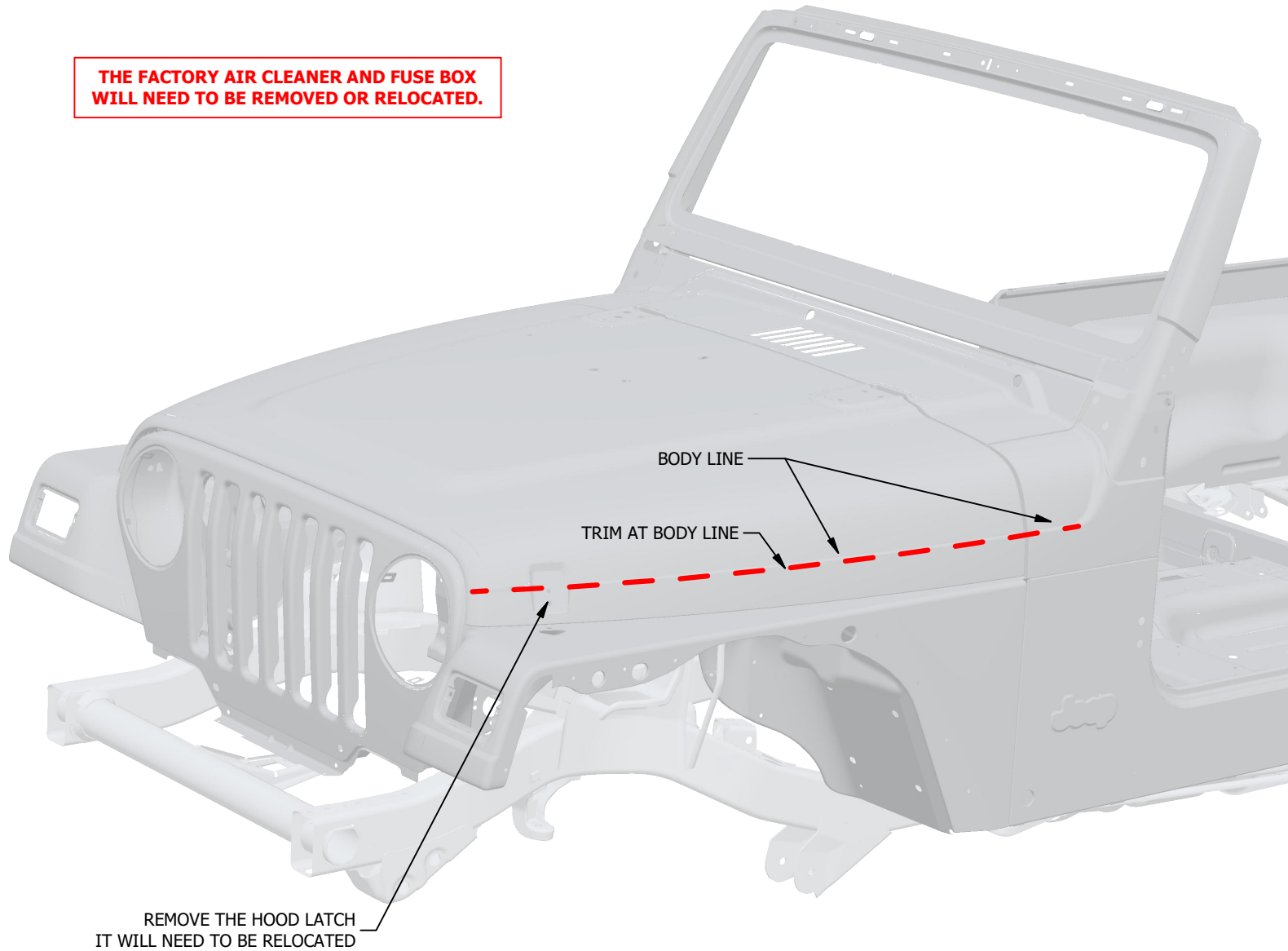

TRIM THE HOOD AT THE BODY LINE THAT STARTS AT THE COWL AND EXTENDS TO THE FRONT OF THE HOOD. YOU MAY WANT TO LEAVE SOME EXTRA MATERIAL AT THE BOTTOM OF THE HOOD TO TRIM LATER ON WHEN THE MOTOBILT FENDERS ARE FINALLY ATTACHED. THIS WILL ENSURE THE BODY GAP BETWEEN THE HOOD AND FENDERS WILL BE IDEAL.

# **MB1083 - Assembly Instructions High Line Flat Fender and Inner Fender**

## **FACTORY FENDER AND HOOD REMOVAL**

KEEP THE FACTORY  
HARDWARE AS IT WILL BE  
REUSED TO ATTACH THE  
MOTOBILT FENDERS

REMOVE OR FOLD BACK  
THE FACTORY HOOD

REMOVE PASSENGER  
FENDER AND  
INNER FENDER

REMOVE DRIVER FENDER  
AND INNER FENDER

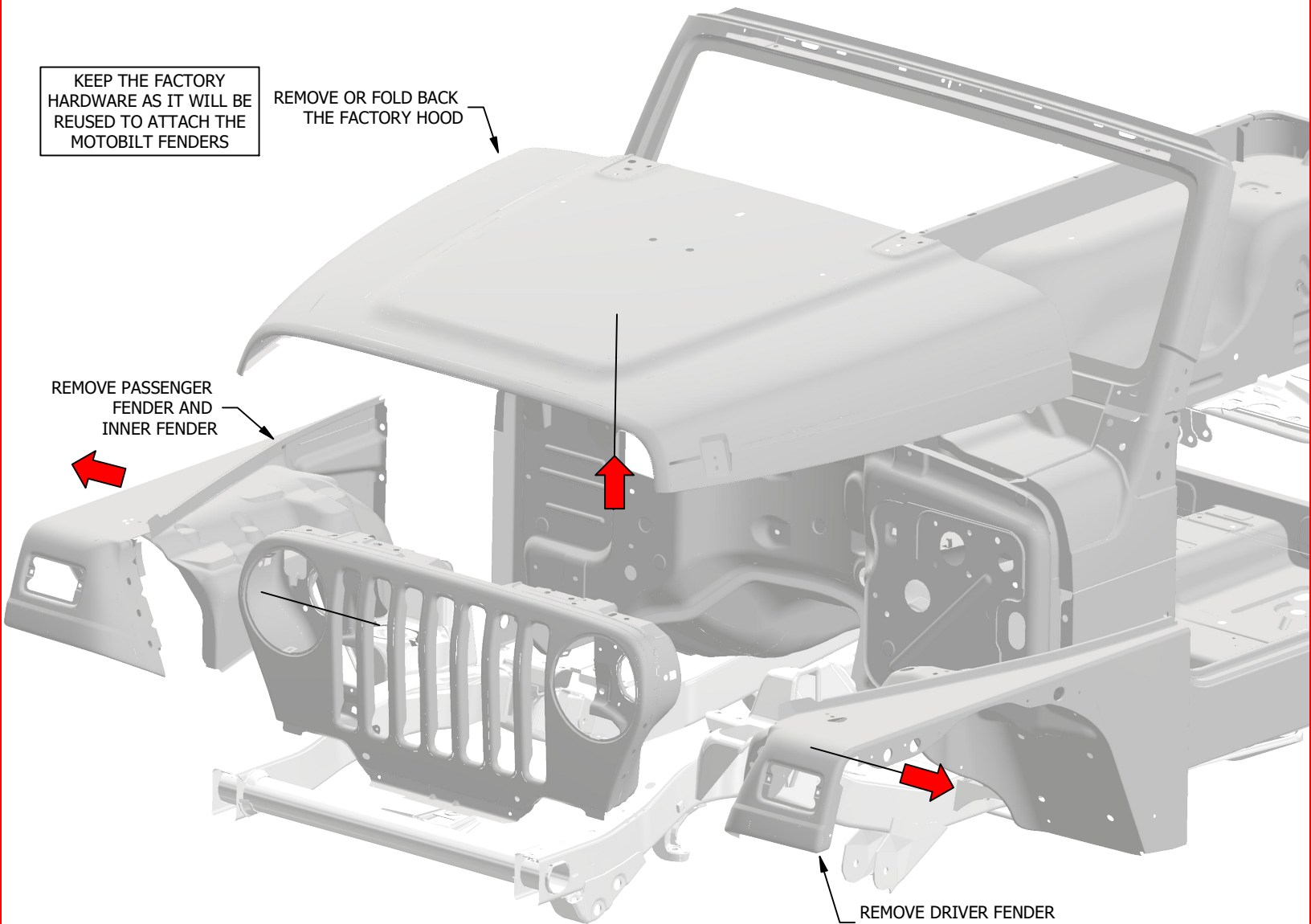

# **MB1083 - Assembly Instructions High Line Flat Fender and Inner Fender**

## **FENDER ASSEMBLY**

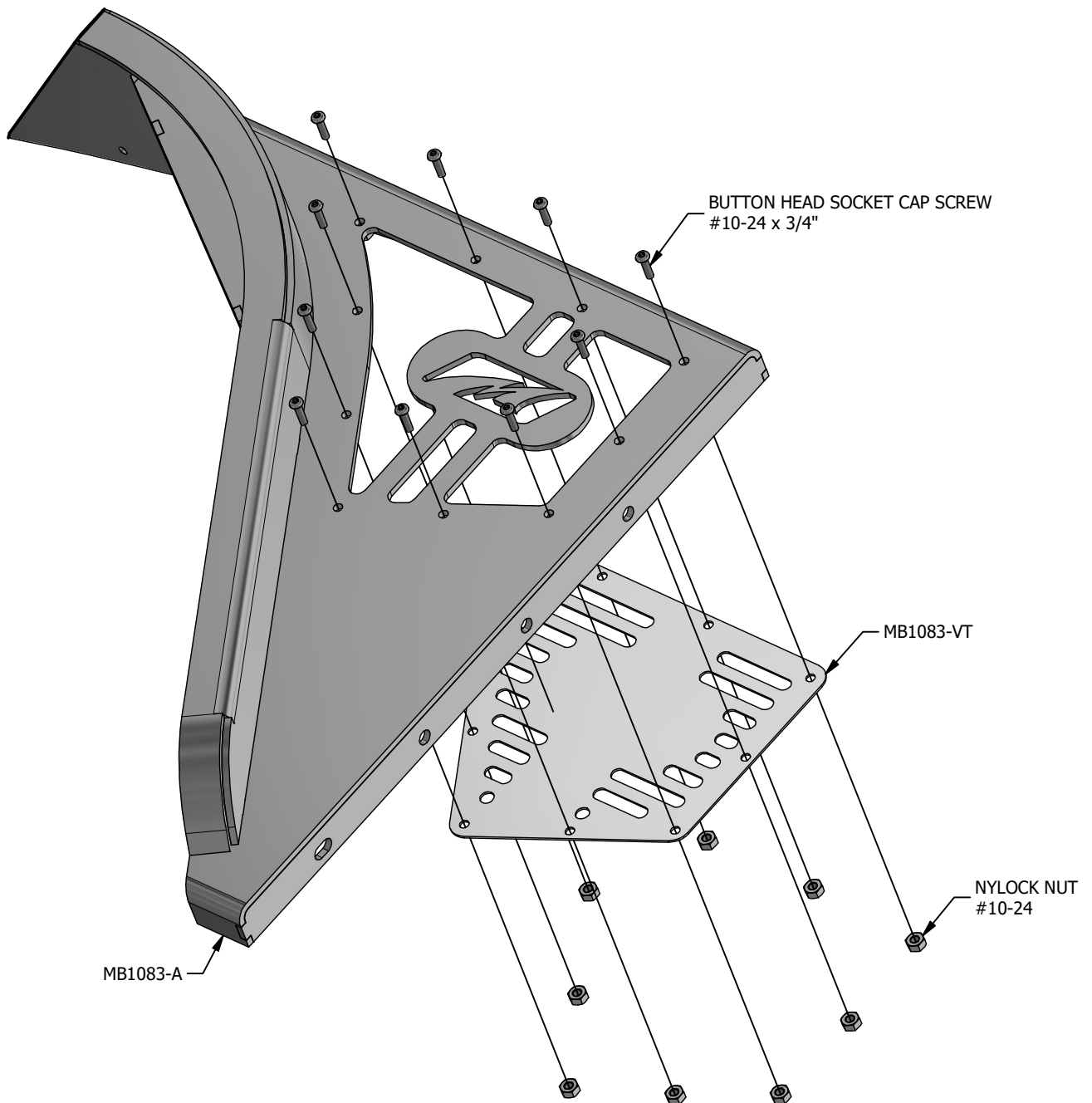

# MB1083 - Assembly Instructions High Line Flat Fender and Inner Fender

## FENDER SUPPORTS

INSTALL THE DRIVER SIDE  
FENDER SUPPORT

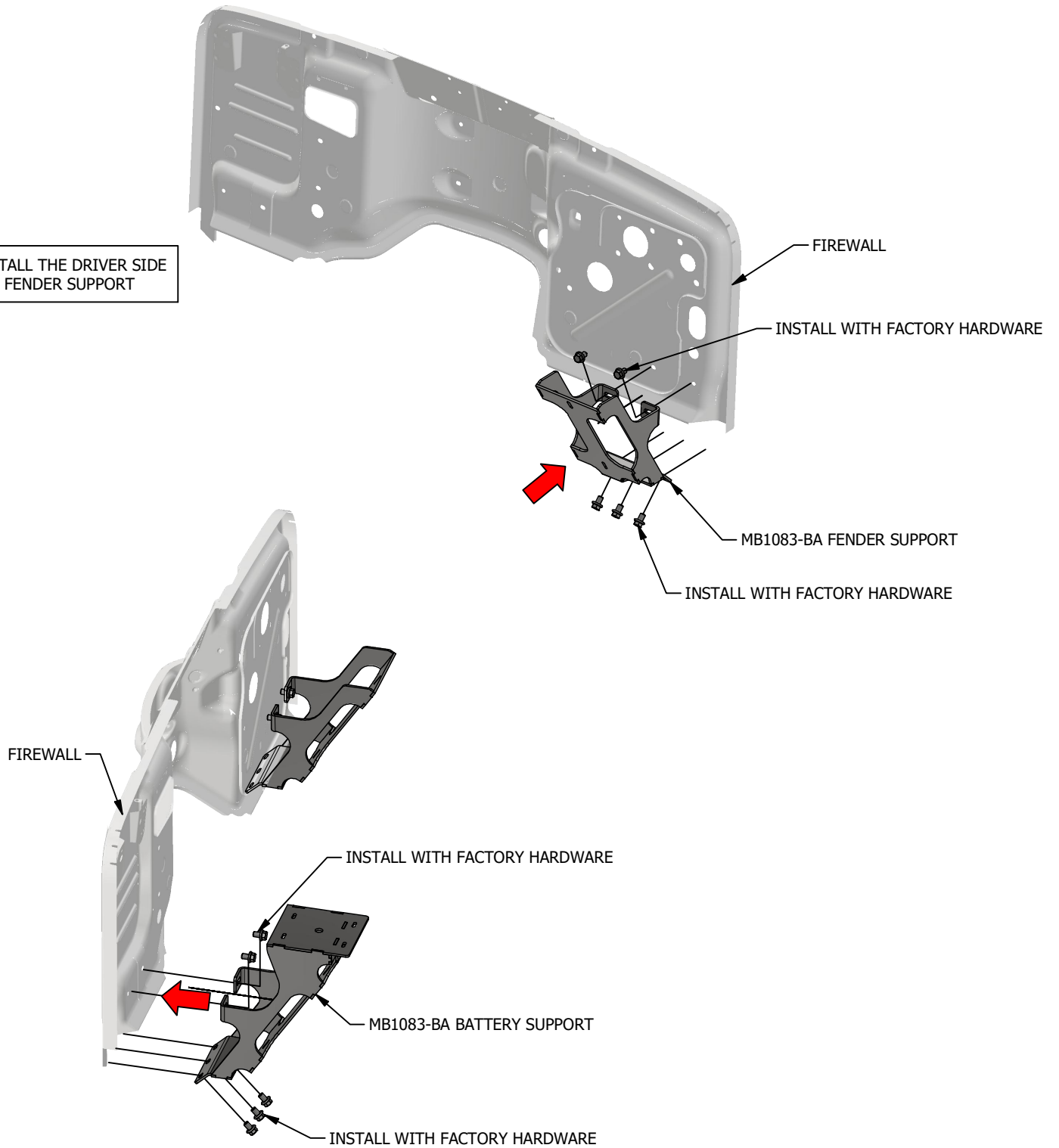

# MB1083 - Assembly Instructions High Line Flat Fender and Inner Fender

## FENDER INSTALL

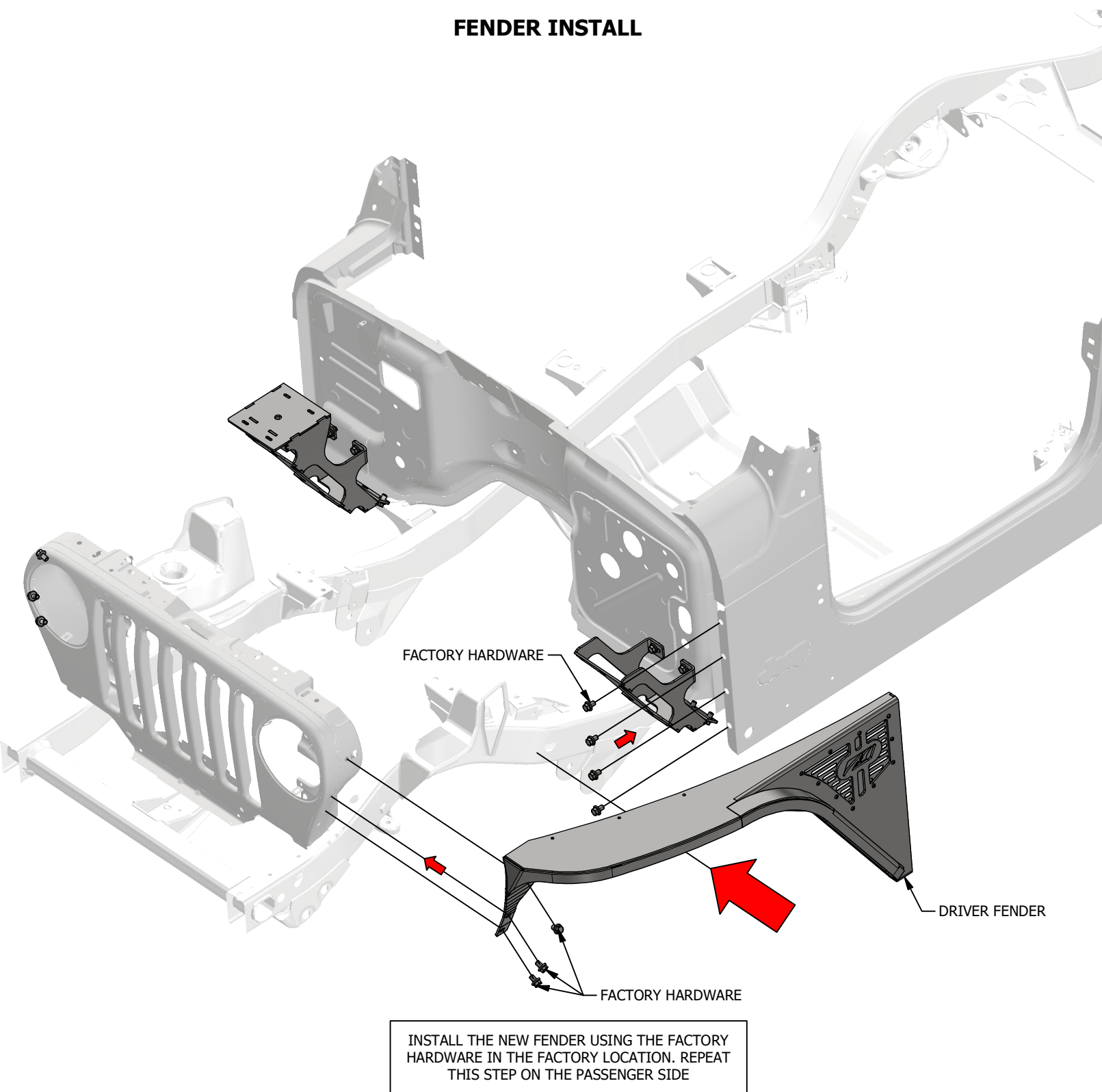



# MB1083 - Assembly Instructions High Line Flat Fender and Inner Fender

## INNER FENDER INSTALL

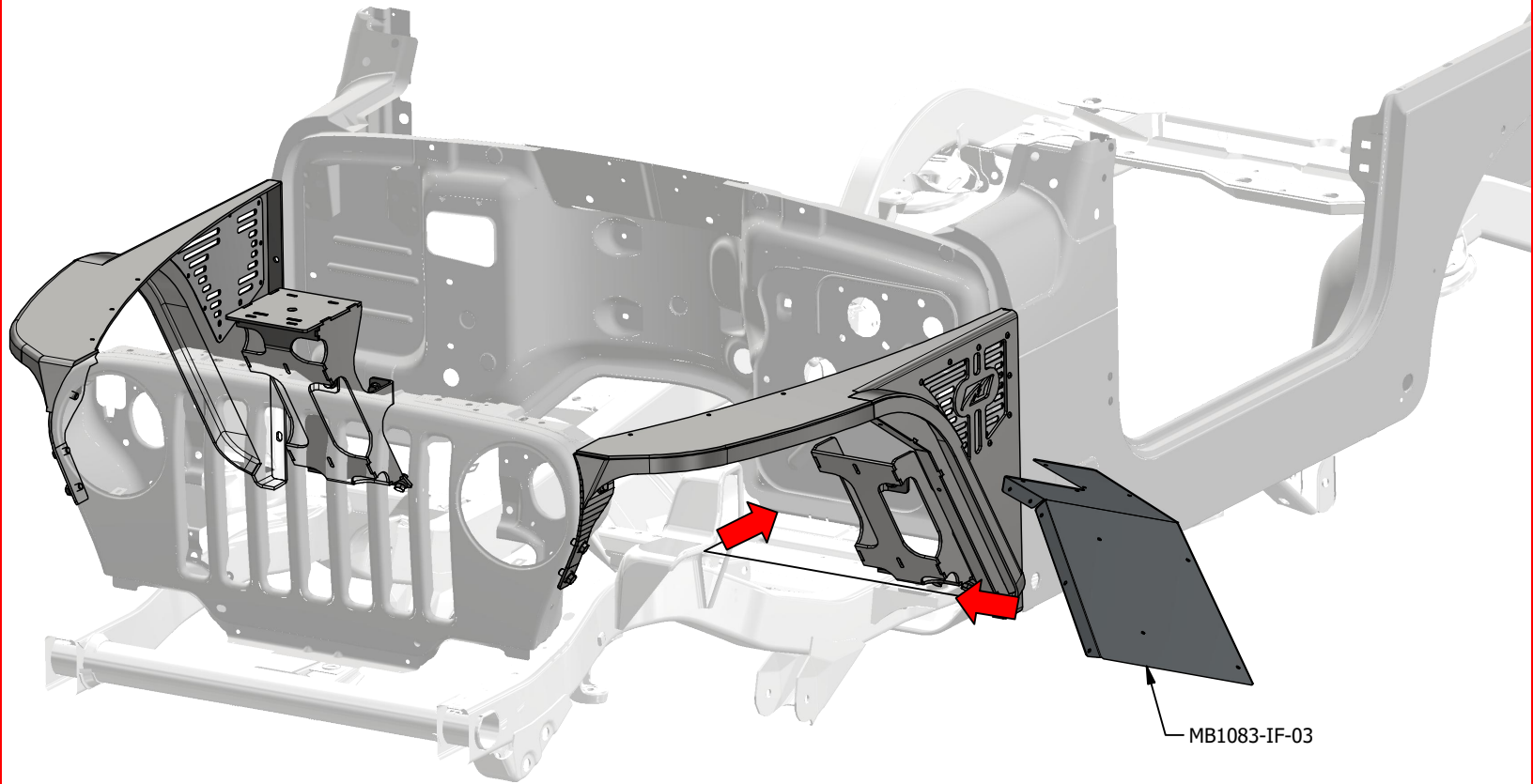

MB1083-IF-03

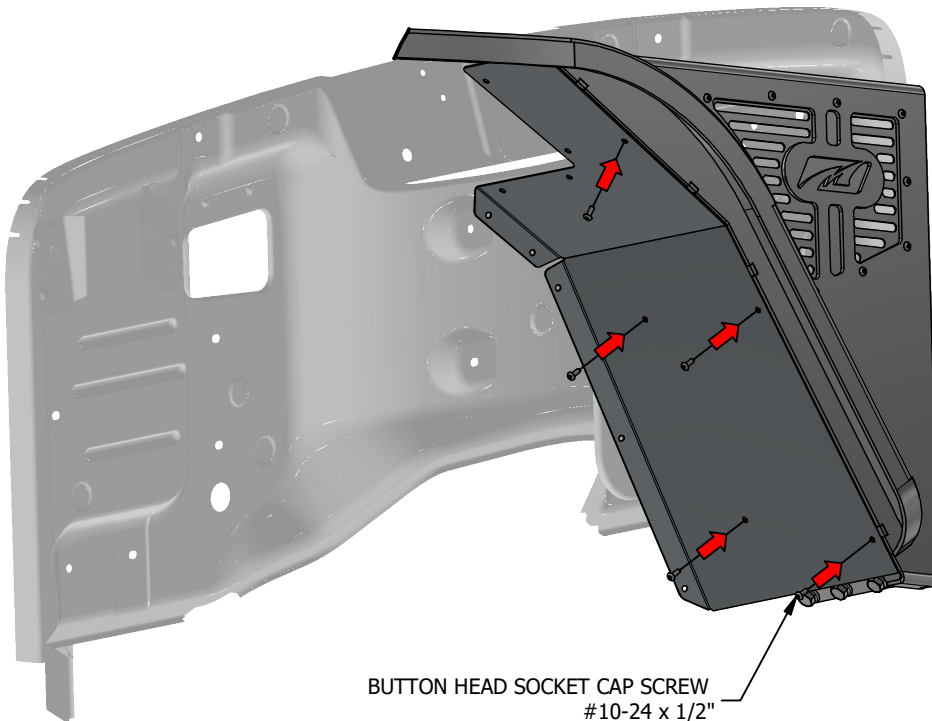

INSTALL THE MB1083-IF-03 INNER FENDER WITH #10 BUTTON HEAD SOCKET CAP SCREWS WITH #10 NYLOCK NUTS.

BUTTON HEAD SOCKET CAP SCREW  
#10-24 x 1/2"

# **MB1083 - Assembly Instructions High Line Flat Fender and Inner Fender**

## **INNER FENDER INSTALL**

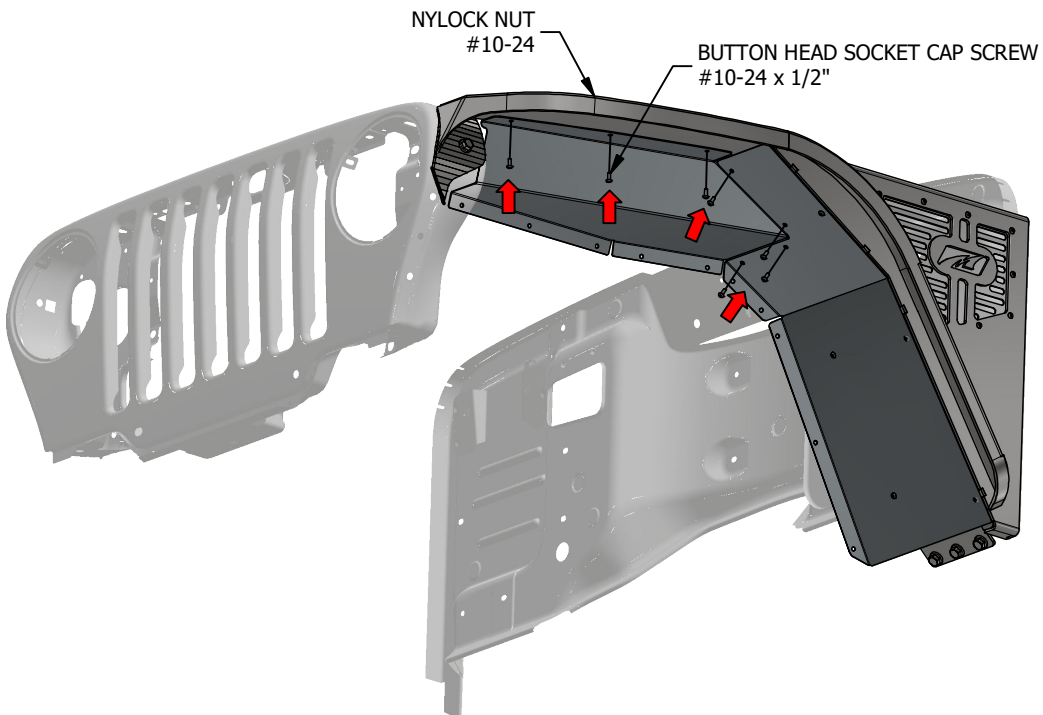
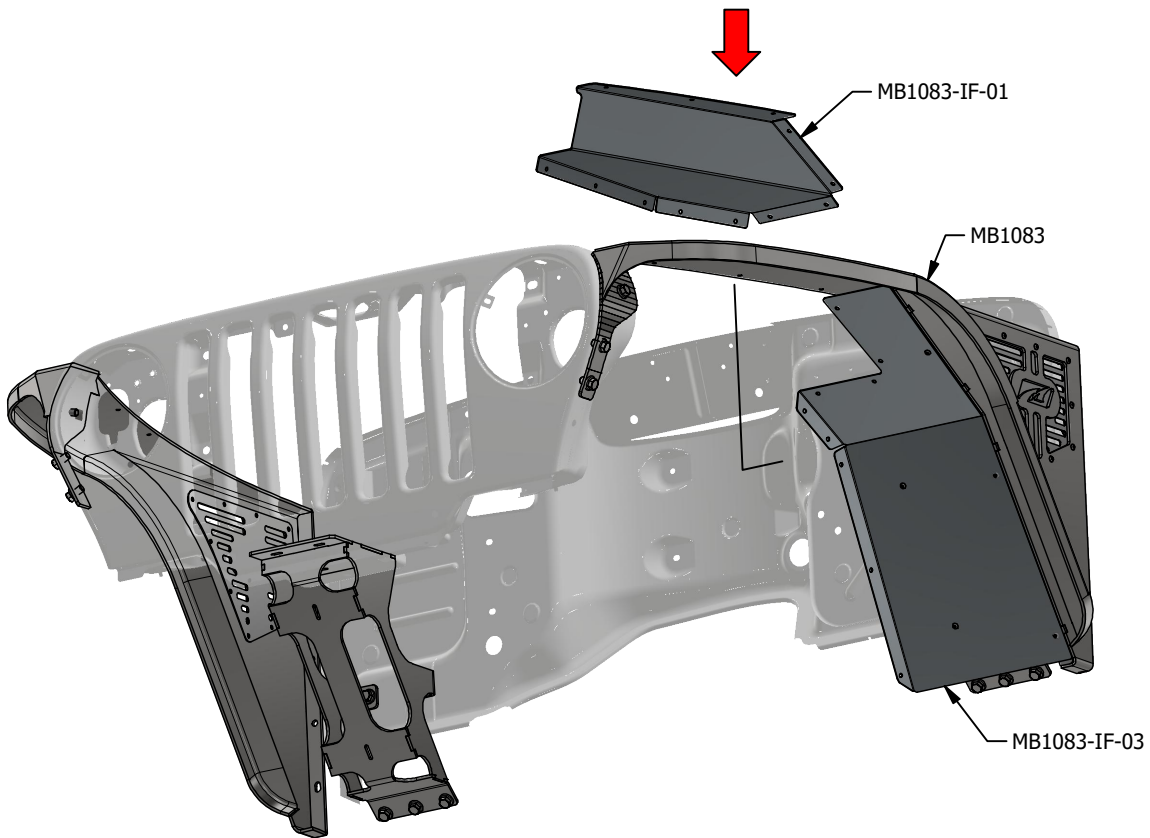

# MB1083 - Assembly Instructions High Line Flat Fender and Inner Fender

## INNER FENDER INSTALL

NOTE: THE AIR FILTER BOX AND FUSE BOX WILL NEED TO BE RELOCATED OR REMOUNTED ON THE NEW INNER FENDER.

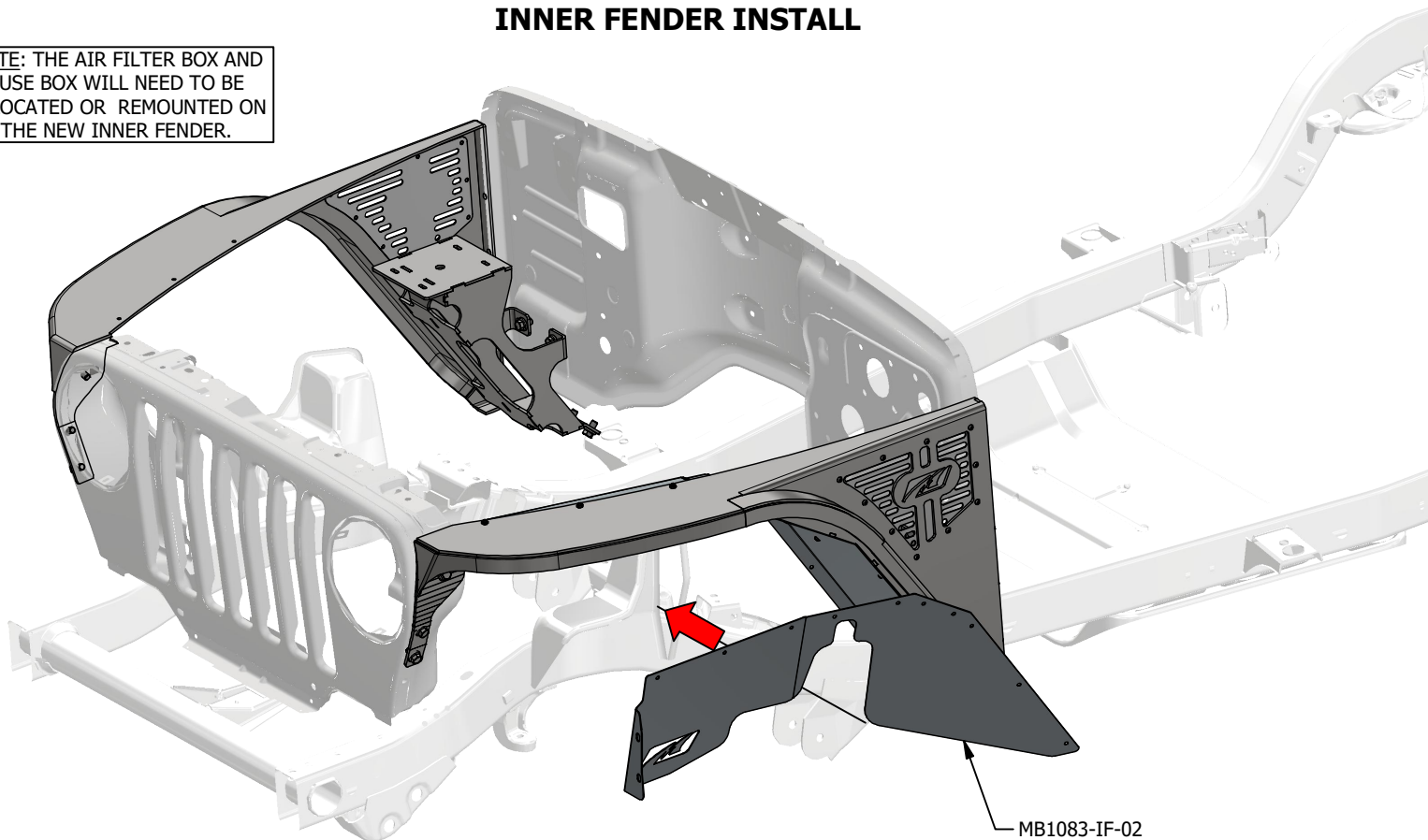

NYLOCK NUT  
#10-24  
(BACKSIDE)

BUTTON HEAD SOCKET CAP SCREWS  
#10-24 x 1/2"

FACTORY HARDWARE

REPEAT ON  
PASSENGER SIDE

