

Thank you for purchasing this Dynojet kit. This kit has been developed for a motorcycle which is set to the parameters listed at the right in the “Stage” description. If your motorcycle does not meet any of these parameters, please check with Dynojet before installation. For technical assistance contact your Dynojet distributor or call Dynojet U.S.A. (800)-992-4993



WARNING

**NO SMOKING!
NO OPEN FLAME!
WHILE INSTALLING
YOUR DYNOJET KIT**

2191 Mendenhall Dr. Suite 105
North Las Vegas, NV 89081
TEL: 702-399-1423
FAX: 702-399-1431
8am-5pm Pacific Time
Monday through Friday

Website Address
<http://www.dynojet.com>

The manufacturer and seller make no warranties express or implied which extend beyond the description of the goods contained herein. Any description of this product is for the purpose of identifying it and shall not be deemed to create an express warranty.

8111.001

U.S. models only

2000-2009 Buell Blast

For mildly tuned machines using the stock or high flow airbox. May also be used with a good aftermarket exhaust system.

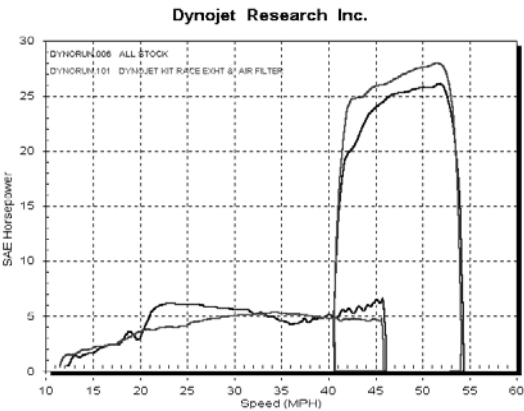

This graph shows a typical gain with a Dynojet jet kit.

Parts List

1	Main Jet	BJ150
1	Main Jet	BJ155
1	Main Jet	BJ160
1	Main Jet	BJ165
1	Main Jet	BJ170
1	Main Jet	BJ175
1	Fuel Needle	DNO870
1	E-Clip	DE0001
3	Adjusting Washers	DW0001
1	Emulsion Tube	DET007
1	Slide Spring	DSP009
1	Slide Drill	DD #29
1	Plug Drill	DD #5/32
1	Screw	DS0001

STAGE ONE INSTRUCTIONS

1. Remove the vacuum slide from the carb. Remove the stock needle & spacers, noting the order of assembly. Locate the slide lift hole using Fig. A. With the drill bit provided (DD #29) enlarge your slide lift hole. **Do not drill the needle hole.**

2. Install the Dynojet needle on groove #3 from the top. Install the Dynojet washers above the e-clip (Fig. A). Install the Dynojet slide spring (DSP009) in place of the stock slide spring, making sure spring is aligned properly.

*Due to the design of this motorcycle, when changing either the exhaust or the airbox, it is necessary to lean out the main jet. If you have any questions please call Dynojet.

3. Remove the stock main jet and remove the emulsion tube (Fig. B), sometimes referred to as the main jet holder. Replace the stock emulsion tube with the Dynojet emulsion tube provided (DET007). When the Dynojet emulsion tube is fully seated there will still be threads visible. Install the Dynojet main jet provided. Use the BJ170 main jet with a completely stock bike. Use the BJ165 main jet with an aftermarket exhaust. Use the BJ160 main jet with an aftermarket airbox. Use the BJ155 main jet with an aftermarket exhaust and airbox.

4. Locate the fuel mixture plug (Fig. B), if you see a screw head at Fig. B proceed to the adjusting procedure. With the DD #5/32 drill bit provided, carefully drill through the plug. **NOTE: The mixture screw is directly underneath this plug, be ready to pull back on the drill the instant you break through.** Use screw provided to secure and remove this plug. Carefully turn mixture screw in until lightly seated, then back out 2 turns.

Dynojet

8111.001

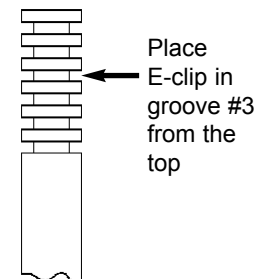

Fig. A

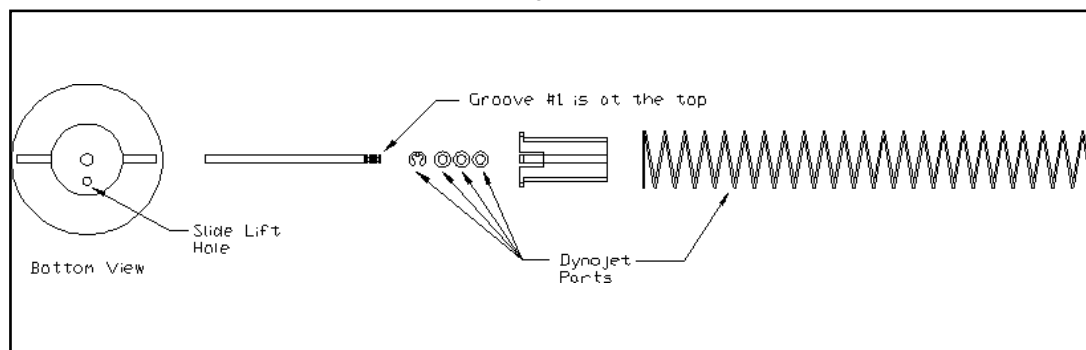

Fig. B

