

Thank you for purchasing this Dynojet kit. This kit has been developed for a motorcycle which is set to the parameters listed at the right in the “Stage” description. If your motorcycle does not meet any of these parameters please check with Dynojet before installation. For technical assistance contact your Dynojet distributor or call Dynojet U.S.A. (800)-992-4993



5117.002

U.S Models Only

2001-2006 Triumph Bonneville,
2003-2004 T100 800cc
Stage 1

WARNING

**NO SMOKING!
NO OPEN FLAME!
WHILE INSTALLING
YOUR DYNOJET KIT**

2191 Mendenhall Dr. Suite 105
North Las Vegas, NV 89081
TEL: 702-399-1423
FAX: 702-399-1431
8am-5pm Pacific Time
Monday through Friday

Website Address
<http://www.dynojet.com>

For mildly tuned machines using the stock airbox with stock or K&N filter. May also be used with a good aftermarket exhaust system.

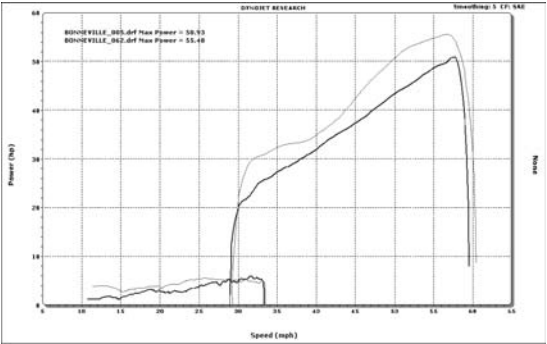

This graph shows a typical gain with a Dynojet jet kit.

The manufacturer and seller make no warranties express or implied which extend beyond the description of the goods contained herein. Any description of this product is for the purpose of identifying it and shall not be deemed to create an express warranty.

Parts List

2	Main Jets	DJ106
2	Main Jets	DJ110
2	Main Jets	DJ114
2	Main Jets	DJ118
2	Fuel Needles	DNO369
2	Slide Springs	DSP027
2	E-clips	DE0001
4	Adjusting Washers	DW0001
1	Plug Drill	DD 5/32
1	Screw	DS0001

STAGE ONE INSTRUCTIONS

Dynojet

5117.002

1. Remove the vacuum slides from the carbs. Remove the stock needles & spacers, noting the order of assembly.
2. Install the Dynojet needles on groove #3 from the top, using all stock spacers (Fig.A). Install the Dynojet washers above the E-clip (2 per needle).
3. Install the dynojet slide springs(DSP027), in-place of the stock slide springs.
4. Remove the main jets and replace with the Dynojet main jets provided. Use the DJ106 main jets with stock exhaust. Use the DJ110 main jets with aftermarket header or slip-on with high flowing baffles.
5. Locate the fuel mixture plug (Fig.B), if you see a screw head, proceed to adjusting procedure. With the DD #5/32 drill provided, carefully drill through the plug (s). **NOTE: the mixture screw is directly underneath this plug, be ready to pull back on the drill the instant you break thru.** Use screw provided to secure and remove the plug. Carefully turn mixture screws clockwise until they seat, then turn out 2-1/2 turns.

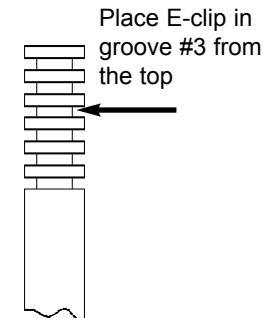

Fig. A

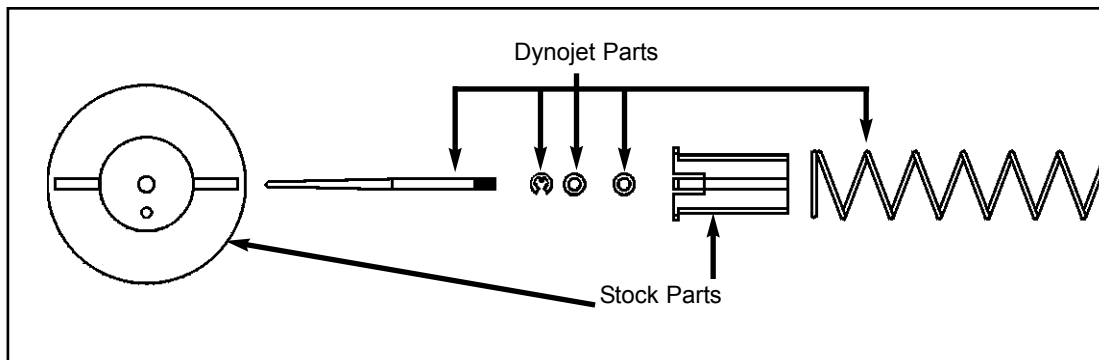

Fig. B

