

Thank you for purchasing this Dynojet kit. This kit has been developed for a motorcycle which is set to the parameters listed at the right in the “Stage” description. If your motorcycle does not meet any of these parameters please check with Dynojet before installation. For technical assistance contact your Dynojet distributor or call Dynojet U.S.A. (800)-992-4993

2191 Mendenhall Dr. Suite 105
North Las Vegas, NV 89031
TEL: 702-399-1423
FAX: 702-399-1431
8am-5pm Pacific Time
Monday through Friday

Website Address
<http://www.dynojet.com>

The manufacturer and seller make no warranties express or implied which extend beyond the description of the goods contained herein. Any description of this product is for the purpose of identifying it and shall not be deemed to create an express warranty.



4165.001

U.S Models Only

2000-01 Yamaha YZF1000 R1

Stage 1

For mildly tuned machines using the stock airbox, with stock or K&N filter. May also be used with a good aftermarket exhaust system. This kit was designed with the EXUP valve retained.

K&N filter #YA-1098

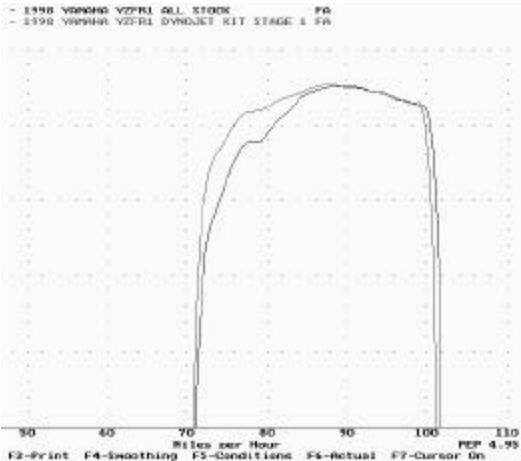

This graph shows a typical gain with a Dynojet jet kit.

WARNING

**NO SMOKING!
NO OPEN FLAME!
WHILE INSTALLING
YOUR DYNOJET KIT**

Parts List		
4	Main Jets	DJ130
4	Main Jets	DJ132
4	Main Jets	DJ134
4	Main Jets	DJ136
4	Main Jets	DJ138
4	Fuel Needles	DNO709
4	E-Clips	DE0001
4	Adjusting Washers	DW0001
4	Needle Springs	DSP77
4	Pilot Jets	DPJM018
1	Plug Drill	DD #5/32
1	Screw	DS0001

STAGE ONE INSTRUCTIONS

1. Remove the vacuum slides from the carbs. Remove the stock needles and spacers, noting the order of assembly (Fig. A).

2. Install the Dynojet needles on groove #3 from the top. Use all stock spacers (Fig. A). The small Dynojet washers are for half step increments and do not have to be installed at this time.

NOTE: The DSP77 springs do not have to be used, they are supplied in case the stock springs are misplaced. After installing the slides in the carbs be sure to check slide movement manually.

3. Remove the stock main jets and install the Dynojet main jets provided. If you are running the stock exhaust install the DJ132 main jets. If you are running the stock exhaust and a K&N filter install the DJ134 main jets. If you are running an aftermarket exhaust or slip-on with a high flowing baffle, use the DJ136 main jets. If you are running an aftermarket exhaust or slip-on with a high flowing baffle and a K&N filter, use the DJ138 main jets. Be sure that the jet you are changing is the main jet.

4. Remove the stock pilot jets and install the Dynojet pilot jets provided (DPJM018). The pilot jets are located next to the main jet.

5. Locate the fuel mixture plug (Fig. B). If you see a screw head at Fig. B proceed to adjusting procedure. With the DD #5/32 drill bit provided carefully drill through the plugs. **NOTE:** The mixture screw is directly underneath this plug, be ready to pull back on the drill the instant you break through. Use screw provided to secure and remove this plug. Carefully turn mixture screws clockwise until lightly seated, then back out 1-1/2 turns.

DYNOJET

4165.001

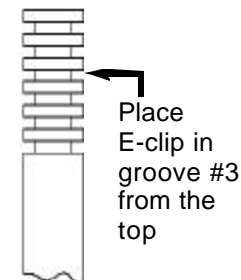

Fig. A

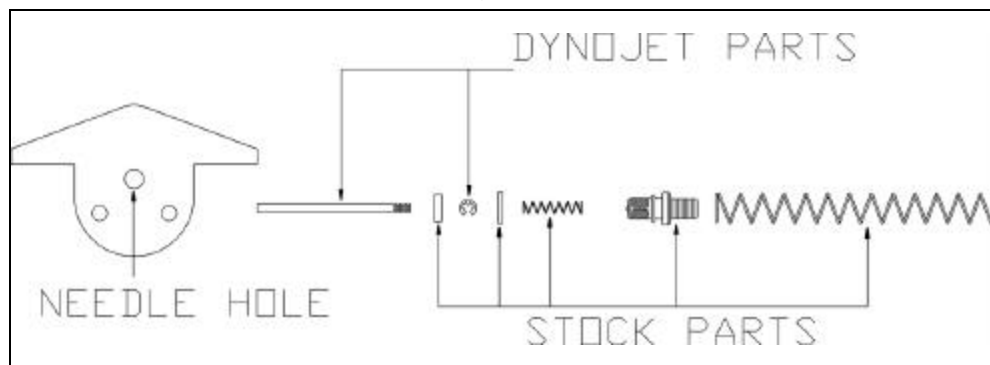
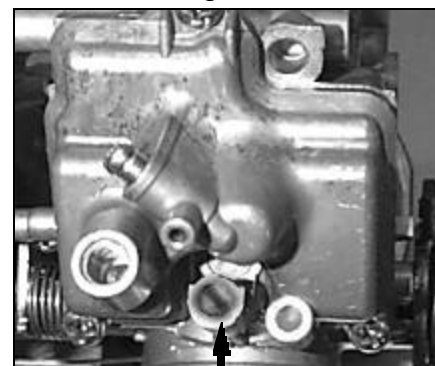

Fig. B



Mixture Screw