

Thank you for purchasing this Dynojet kit. This kit has been developed for a motorcycle which is set to the parameters listed at the right in the "Stage" description. If your motorcycle does not meet any of these parameters, please check with Dynojet before installation. For technical assistance contact your Dynojet distributor or call Dynojet U.S.A. (800)-992-4993

2191 Mendenhall Dr. Suite 105
North Las Vegas, NV 89031
TEL: 702-399-1423
FAX: 702-399-1431
8am-5pm Pacific Time
Monday through Friday

Website Address
<http://www.dynojet.com>

The manufacturer and seller make no warranties express or implied which extend beyond the description of the goods contained herein. Any description of this product is for the purpose of identifying it and shall not be deemed to create an express warranty.



4148.001

U.S Models Only

1996-2001 Yamaha XVZ1300A
Royal Star

Stage 1

For mildly tuned machines using the stock airbox with stock or K&N filter. May also be used with a good aftermarket exhaust system
K&N filter #YA-1595

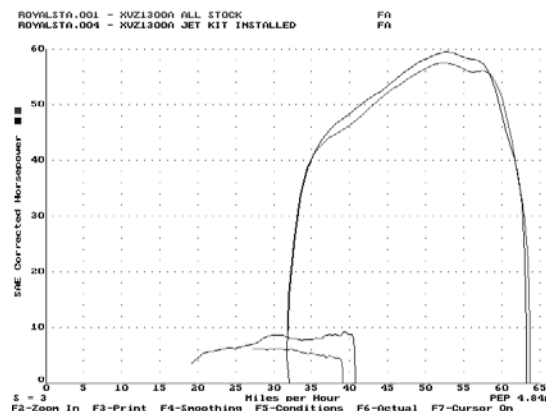

This graph shows a typical gain with a Dynojet jet kit.

WARNING

**NO SMOKING!
NO OPEN FLAME!
WHILE INSTALLING
YOUR DYNJET KIT**

Parts List

4	Fuel Needles	DNO470
4	Slide Springs	DSP009
4	Adjusting Washers	DW0001
4	E-Clips	DE0001
1	Plug Drill	DD #5/32
1	Screw	DS0001

STAGE ONE INSTRUCTIONS

DYNOJET

4148.001

Note: It is not necessary to remove the carburetors from this bike to install this kit.

1. Remove the vacuum slides from the carbs. Remove the stock needles and spacers noting the order of assembly (Fig.A).
2. Install the Dynojet needles on groove #3. Use all stock spacers (Fig. A). Install the Dynojet washers above the e-clip. Install the Dynojet slide springs (DSP009) in place of the stock springs.
3. Use the stock main jets.
4. Locate the fuel mixture plug (Fig. B), if you see a screw head at Fig. B proceed to the adjusting procedure. With the DD #5/32 drill bit provided, carefully drill through the plug. **NOTE:** The mixture screw is directly underneath this plug, be ready to pull back on the drill the instant you break through. Use screw provided to secure and remove this plug. Carefully turn mixture screw in until lightly seated, then back out 3-1/2 turns.

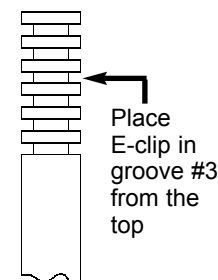

Note: The fuel mixture screws on this model have a large effect on fuel delivery at steady throttle. If experiencing poor fuel mileage, try adjusting the fuel mixture screws.

Fig. A

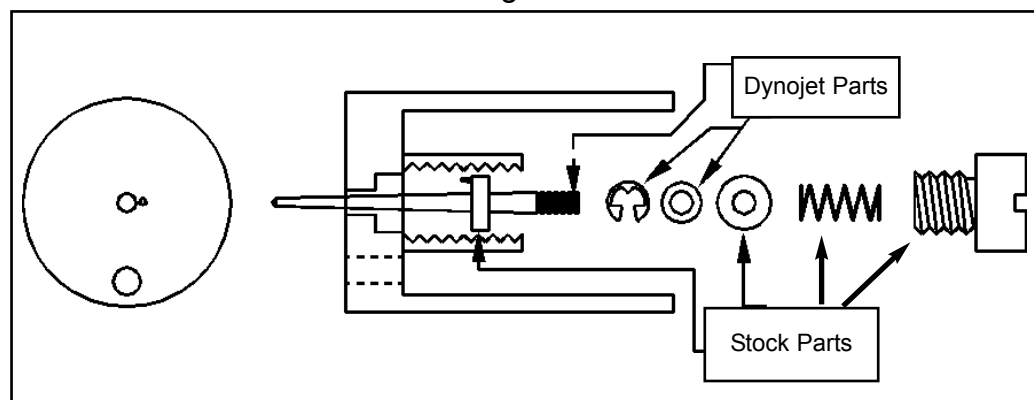

Fig. B

