

Thank you for purchasing this Dynojet kit. This kit has been developed for a motorcycle which is set to the parameters listed at the right in the "Stage" description. If your motorcycle does not meet any of these parameters please check with Dynojet before installation. For technical assistance contact your Dynojet distributor or call Dynojet U.S.A. (800)-992-4993

2191 Mendenhall Dr. Suite 105  
North Las Vegas, NV 89081  
TEL: 702-399-1423  
FAX: 702-399-1431  
8am-5pm Pacific Time  
Monday through Friday

Website Address  
<http://www.dynojet.com>

The manufacturer and seller make no warranties express or implied which extend beyond the description of the goods contained herein. Any description of this product is for the purpose of identifying it and shall not be deemed to create an express warranty.

# Dynojet

**2264.001**

U.S Models Only

*1993-97 Kawasaki KLX650*

**Stage 2**

For mildly tuned machines using modified stock airbox, with stock or K&N filter. May also be used with a good aftermarket exhaust system  
K&N filter #KA-6589

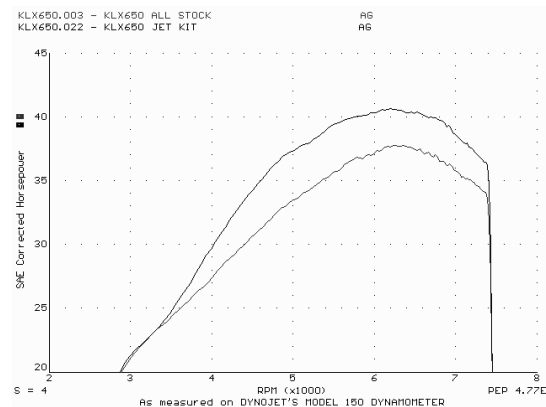

*This graph shows a typical gain with a Dynojet jet kit.*

# WARNING

**NO SMOKING!  
NO OPEN FLAME!  
WHILE INSTALLING  
YOUR DYNOJET KIT**

## Parts List

1	Main Jet	DJ144
1	Main Jet	DJ150
1	Main Jet	DJ155
1	Fuel Needles	DNO233
1	E-Clips	DE0001
2	Adjusting Washers	DW0001
1	Plug Drill	DD #5/32
1	Screw	DS0001

## STAGE ONE INSTRUCTIONS

**Dynojet**

**2264.001**

1. Remove the vacuum slide from the carb. Remove the stock needle and spacers, noting the order of assembly (Fig.A).

2. Install the Dynojet needle on groove #3 from the top. Use all stock spacers (Fig.A). Install the small Dynojet washers above the E-clip. After installing the slide in the the carb be sure to manually check slide movement.

3. Remove the stock main jet and replace with the Dynojet main jet provided. If you remove the complete airbox lid use the DJ150 main jet with the stock exhaust and use the DJ155 main jet with an aftermarket exhaust system or slip-on with high flow baffle. If you only remove the snorkel from the airbox lid use the DJ144 main jet with the stock exhaust and the DJ150 main jet for an a ftermarket exhaust system or slip-on with high flow baffle.

4. Locate the fuel mixture plug (Fig.B). If you see a screw head at Fig.B then proceed to the adjusting procedure. With the DD #5/32 drill bit provided carefully drill through the plug.

**NOTE:** *The mixture screw is directly underneath this plug, be ready to pull back on the drill the instant you break through.* Use screw provided to secure and remove this plug. Carefully turn the mixture screw clockwise until lightly seated, then back out 3 turns.

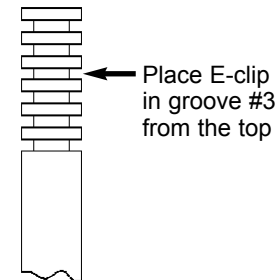

Fig. A

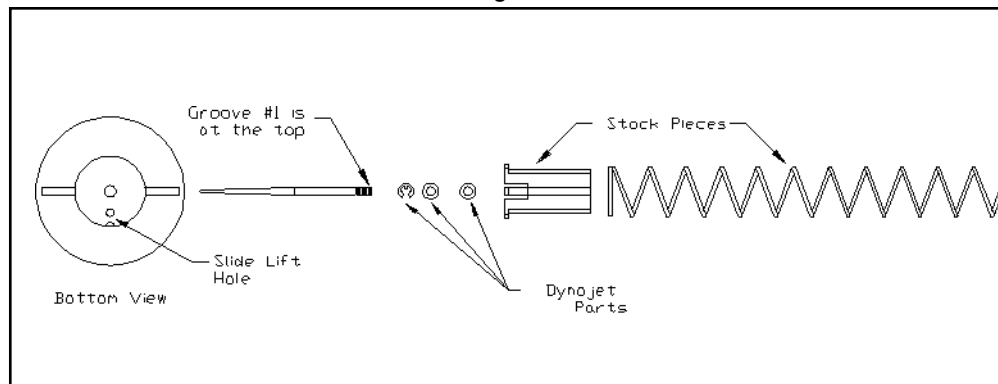

Fig. B

