

Thank you for purchasing this Dynojet kit. This kit has been developed for a motorcycle which is set to the parameters listed at the right in the "Stage" description. If your motorcycle does not meet any of these parameters please check with Dynojet before installation. For technical assistance contact your Dynojet distributor or call Dynojet U.S.A. (800)-992-4993

2191 Mendenhall Dr. Suite 105
North Las Vegas, NV 89031
TEL: 702-399-1423
FAX: 702-399-1431
8am-5pm Pacific Time
Monday through Friday

Website Address
<http://www.dynojet.com>

The manufacturer and seller make no warranties express or implied which extend beyond the description of the goods contained herein. Any description of this product is for the purpose of identifying it and shall not be deemed to create an express warranty.



2190.001

U.S Models Only

1998-2001 Kawasaki ZX11D

Stage 1

For mildly tuned machines using the stock air-box, with stock or K&N filter. May also be used with a good aftermarket exhaust system
K&N filter #KA-0010

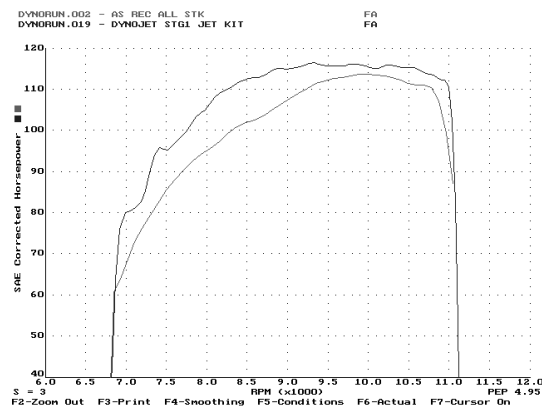

This graph shows a typical gain with a Dynojet jet kit.

WARNING

**NO SMOKING!
NO OPEN FLAME!
WHILE INSTALLING
YOUR DYNOJET KIT**

Parts List

4	Main Jet	DJ150
4	Main Jet	DJ155
4	Main Jet	DJ160
4	Fuel Needles	DNO228
4	E-Clips	DE0001
8	Adjusting Washers	DW0001
4	Slide Springs	DSP006
1	Slide Drill	DD #52
1	Plug Drill	DD #5/32
1	Screw	DS0001

STAGE ONE INSTRUCTIONS

DYNOJET
2190.001

1. Remove vacuum slides from carbs. Remove stock needles and spacers, noting order of assembly (Fig.A)
2. Using the drill bit provided (DD #52) drill an auxiliary slide lift hole in the position shown in Fig. B. By drilling this auxiliary hole you will get the optimum performance out of this kit. If for any reason you need to go back to stock use JB weld or a similar product to fill up this hole.
3. Install the Dynojet needles on groove #4 from the top. Use all stock spacers. Install the small Dynojet washers above the E-clip (2 per needle). Install the Dynojet slide springs (DSP006) in place of the stock slide springs. After installing the slides in the carbs be sure to check slide movement manually.
4. Remove the stock main jets and replace with the Dynojet main jets provided. If you are running the stock exhaust install the DJ155 main jets. If you are running an aftermarket exhaust or slip-on with high flowing baffle use the DJ160 main jets. Be sure that the jet you are changing is the main jet.
5. Locate the fuel mixture plug (Fig. B). If you see a screw head at Fig. B then proceed to the adjusting procedure. With the 5/32 drill bit provided carefully drill through the plug. **NOTE:** The mixture screw is directly underneath this plug, be ready to pull back on the drill the instant you break through. Use screw provided to secure and remove this plug. Carefully turn the mixture screws clockwise until lightly seated, then back out 2 3/4 turns.

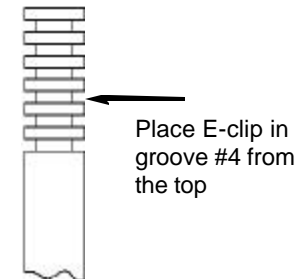

Fig. A

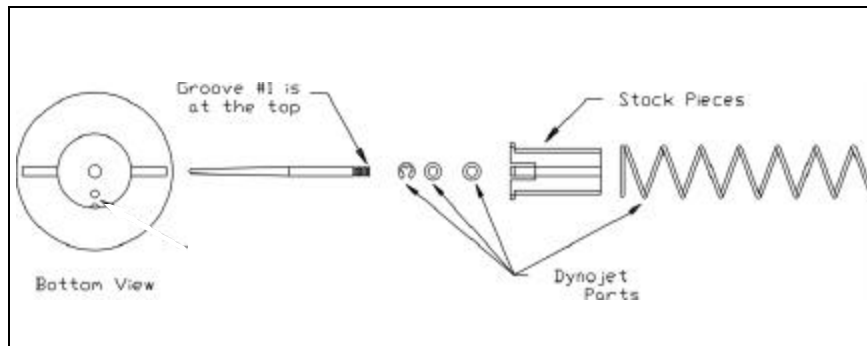
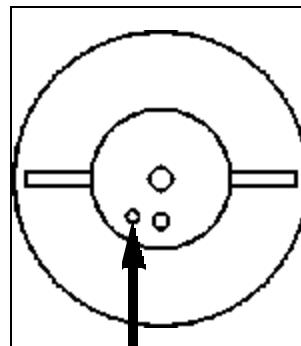

Fig. B



AUXILIARY SLIDE LIFT HOLE

Fig. C

