

Thank you for purchasing this Dynojet kit. This kit has been developed for a motorcycle which is set to the parameters listed at the right in the "Stage" description. If your motorcycle does not meet any of these parameters please check with Dynojet before installation. For technical assistance contact your Dynojet distributor or call Dynojet U.S.A. (800)-992-4993

2191 Mendenhall Dr. Suite 105
North Las Vegas, NV 89081
TEL: 702-399-1423
FAX: 702-399-1431
8am-5pm Pacific Time
Monday through Friday

Website Address
<http://www.dynojet.com>

The manufacturer and seller make no warranties express or implied which extend beyond the description of the goods contained herein. Any description of this product is for the purpose of identifying it and shall not be deemed to create an express warranty.

Dynojet

2126.003

U.S Models Only

1987-89 Kawasaki ZX750R

Stage 1,2,&3

STAGE 1

For mildly tuned machines using the stock airbox, with stock or K&N filter #KA-7587

STAGE 2

For mildly tuned machines using a modified stock airbox with a stock or K&N filter #KA-7587

STAGE 3

For mildly tuned machines using individual filters or velocity stacks. K&N filters #RC-2914

All stages may be used with a good aftermarket exhaust

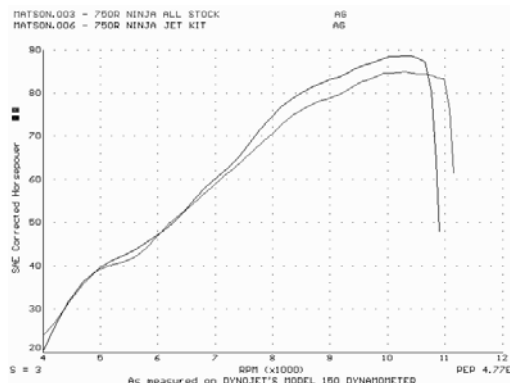

This graph shows a typical gain with a Dynojet jet kit.

WARNING

**NO SMOKING!
NO OPEN FLAME!
WHILE INSTALLING
YOUR JET KIT**

Parts List

4	Main Jet	DJ102
4	Main Jet	DJ118
4	Main Jet	DJ132
4	Fuel Needle	DNO228
8	Adjusting Washer	DW0001
4	E-clips	DE0001
4	Slide Springs	DSP005
1	Slide Drill	DD #30
1	Plug Drill	DD #5/32
1	Screw	DS0001
1	Insert	DIF19

STAGE ONE & TWO INSTRUCTIONS

****When running stage 2 you must modify your airbox per insert DIF19**

1. Remove the vacuum slides from the carbs. Remove the stock needles and spacers, noting order of assembly (Fig.A).
2. Locate your slide lift hole (Fig. A) Use the drill bit provided (DD #30) to enlarge your slide lift holes. The picture may not show your slide exactly. Drill your existing slide lift holes only, **do not** drill the needle hole or any new holes.
3. Install the Dynojet needles on groove #2 from the top. Use all stock spacers (Fig. A). Install the small Dynojet washers above the e-clip (2 per needle). Install the Dynojet slide springs (DSP005) in place of the stock slide springs. After installing the slides in the carbs be sure to check slide movement manually.
4. Remove the stock main jets and replace with the Dynojet main jets provided. If you are running **STAGE 1** install the DJ102 main jets. If you are running **STAGE 2** install the DJ118 main jets. Be sure that the jet you are changing is the main jet.
5. Locate the fuel mixture plug (Fig. B). If you see a screw head at Fig.B then proceed to the adjusting procedure. With the 5/32 drill bit provided carefully drill through the plug. **NOTE: The mixture screw is directly underneath this plug, be ready to pull back on the drill the instant you break through.** Use screw provided to secure and remove this plug. Carefully turn the mixture screw clockwise until lightly seated, then back out 3 turns.

Fig. A

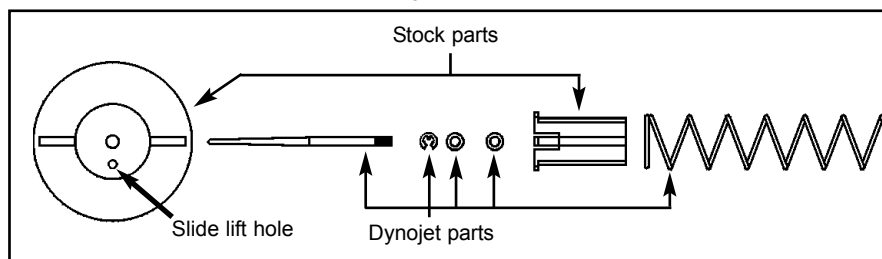

STAGE THREE INSTRUCTIONS

Dynojet

2126.003

1. Remove the vacuum slides from the carbs. Remove the stock needles and spacers, noting order of assembly (Fig.A).
2. Locate your slide lift hole (Fig. A) Use the drill bit provided (DD #30) to enlarge your slide lift holes. The picture may not show your slide exactly. Drill your existing slide lift holes only, **do not** drill the needle hole or any new holes.
3. Install the Dynojet needles on groove #2 from the top. Use all stock spacers (Fig. A). Install the small Dynojet washers above the e-clip (2 per needle). Install the Dynojet slide springs (DSP005) in place of the stock slide springs. After installing the slides in the carbs be sure to check slide movement manually.
4. Remove the stock main jets and replace with the Dynojet main jets provided. Install the DJ132 main jets. Be sure that the jet you are changing is the main jet.
5. Locate the fuel mixture plug (Fig. B). If you see a screw head at Fig.B then proceed to the adjusting procedure. With the 5/32 drill bit provided carefully drill through the plug. **NOTE: The mixture screw is directly underneath this plug, be ready to pull back on the drill the instant you break through.** Use screw provided to secure and remove this plug. Carefully turn the mixture screw clockwise until lightly seated, then back out 3 turns.

Fig. B

