

Thank you for purchasing this Dynojet kit. This kit has been developed for a motorcycle which is set to the parameters listed at the right in the "Stage" description. If your motorcycle does not meet any of these parameters please check with Dynojet before installation. For technical assistance contact your Dynojet distributor or call Dynojet U.S.A. (800)-992-4993

2191 Mendenhall Dr. Suite 105
North Las Vegas, NV 89031
TEL: 702-399-1423
FAX: 702-399-1431
8am-5pm Pacific Time
Monday through Friday

Website Address
<http://www.dynojet.com>

The manufacturer and seller make no warranties express or implied which extend beyond the description of the goods contained herein. Any description of this product is for the purpose of identifying it and shall not be deemed to create an express warranty.



1184.001
U.S. Models Only

*2001 Honda VT750
Spirit*

Stage 1

For mildly tuned machines using the stock airbox, with stock filter. May also be used with a good aftermarket exhaust system
K&N filter #N/A

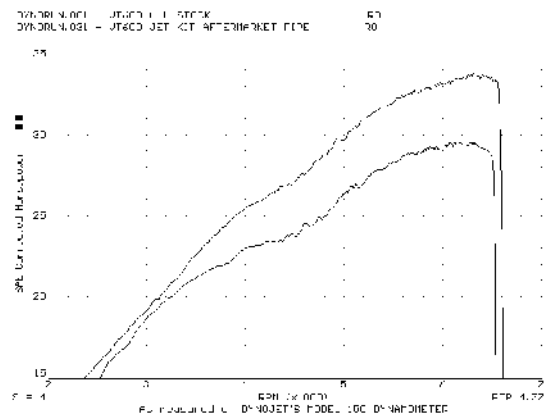

This graph shows a typical gain with a Dynojet jet kit.

WARNING

**NO SMOKING!
NO OPEN FLAME!
WHILE INSTALLING
YOUR DYNJET KIT**

Parts List

1	Main Jet	DJ100
1	Main Jet	DJ102
1	Main Jet	DJ104
1	Main Jet	DJ106
1	Main Jet	DJ108
2	Fuel Needles	DNO114
2	Adjusting Washers	DW0001
2	E-Clips	DE0001
2	Slide Spring	DSP044
1	Plug Drill	DD #5/32
1	Screw	DS0001

STAGE ONE INSTRUCTIONS

DYNOJET

1184.001

1. Remove the vacuum slides from the carbs. Remove the stock needles and spacers, noting the order of assembly (Fig. A).
2. Install the Dynojet needles on groove #3 from the top. Use all stock spacers (Fig. A). Install the small Dynojet washers above the E-clip.
3. Install the Dynojet slide spring (DSP044) in place of the stock slide spring. After installing the slides in the carbs be sure to check slide movement manually.
3. Remove the stock main jets and replace with the Dynojet main jets provided. If you are using the stock exhaust or an aftermarket exhaust with baffles, use the DJ102 main jets in the front (right) carburetor and the DJ104 main jets in the rear (left) carburetor. If you are using wide open exhausts without baffles use the DJ104 main jet in the front (right) carburetor and the DJ106 main jet in the rear (left) carburetor. Be sure that the jet you are changing is the main jet.
4. Locate the fuel mixture plug (Fig. B). If you see a screw head at Fig. B proceed to the adjusting procedure. With the plug drill (DD #5/32) provided, carefully drill through the plugs. **Note:** The mixture screw is directly underneath this plug, be ready to pull back on the drill the instant you break through. Use screw provided to secure and remove this plug. Carefully turn mixture screws clockwise until lightly seated then backout 3 turns.

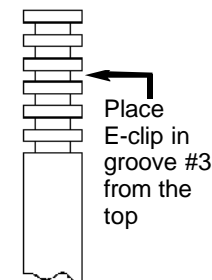

Fig. A

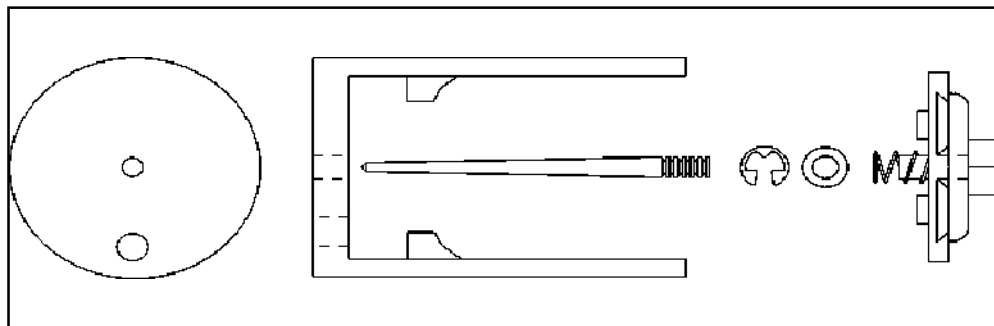
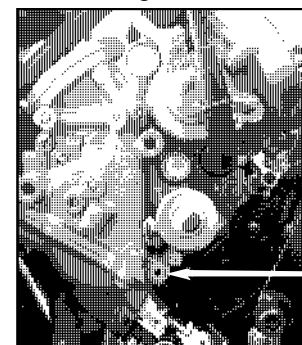

Fig. B



Mixture Screw
Location