

INSTALLATION INSTRUCTIONS

Flip Windshield: for Can-Am Defender

Item	Description
A	Windshield

A

Seal

**Roof, if equipped, must be removed
when installing Windshield.**

(kit contents continue on following pages)

Read instructions and view illustrations before beginning.

Need help with your installation?



sales@superatv.com



www.superatv.com



1-812-574-7777



8:00am - 9:00pm EST M-Th
8:00am - 7:00pm EST Friday
9:00am - 2:00pm EST Saturday

Thank You

For Choosing



Liability Statement

SuperATV's® products are designed to best fit user's ATV/UTV under stock conditions. Adding, modifying, or fabricating any factory or aftermarket parts will void any warranty provided by SuperATV® and is not recommended. SuperATV's® products could interfere with other aftermarket accessories. If user has aftermarket products on machine, contact SuperATV® to verify that they will work together.

Although SuperATV® has thousands of satisfied customers, user should be aware that installing lift kits, long travel, or suspension kits, tires, etc. will change the ride of machine and may increase maintenance and part wear. Operating any off-road machine while, or after, consuming alcohol and/or drugs increases risk of bodily harm or death. No warranty or representation is made as to this product's ability to protect user from severe injury or death. SuperATV® urges operators and occupants to wear a helmet and appropriate riding gear at all times.

By purchasing and installing SuperATV® products, user agrees that should damages occur, SuperATV® will not be held responsible for loss of time, use, labor fees, replacement parts, or freight charges. SuperATV®, nor any 3rd party, will not be held responsible for any direct, indirect, incidental, special, or consequential damages that result from any product purchased from SuperATV®. The total liability of seller to user for all damages, losses, and causes of action, if any, shall not exceed the total purchase price paid for the product that gave rise to the claim.

SuperATV® will warranty only parts provided by SuperATV®. Any damage or problems with OEM housings, bearings, seals, or other manufacturers' products will not be covered by SuperATV®. SuperATV® parts and products are not warrantied if item was not installed properly, misused, or modified.

(kit contents continued)

Item	Description	Item	Description
B	Top Frame	G	Right Male Hinge
C	Gas Strut x 2	H	Right Female Hinge
E	Lower Frame	J	Left Male Hinge
F	Handle Latch Plate	K	Left Female Hinge

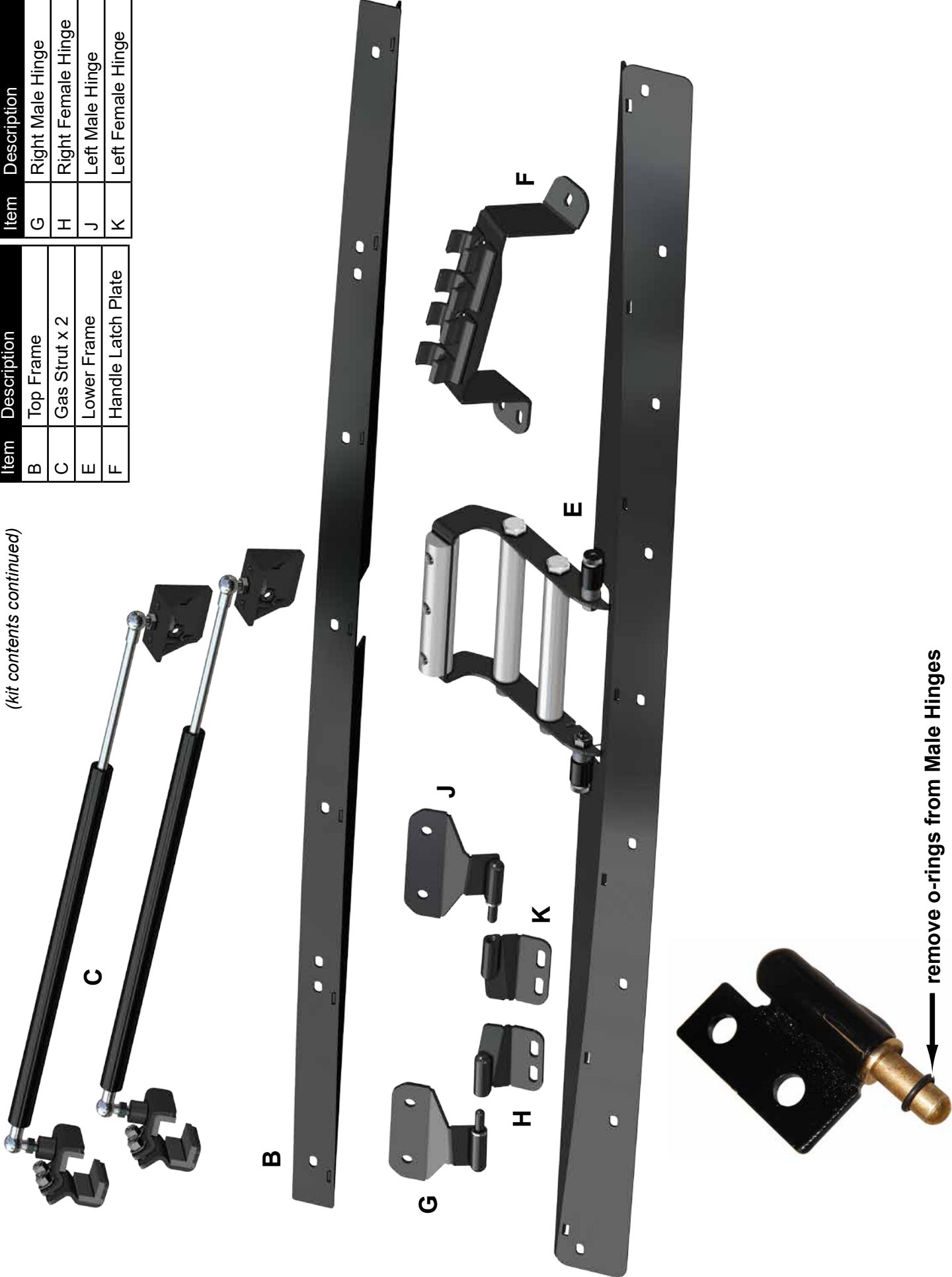

(kit contents continued)

18x  M6-1.0 x 20mm Lg. BHCS

4x  M6-1.0 x 25mm Lg. BHCS

3x  M6-1.0 x 30mm Lg. FHCS

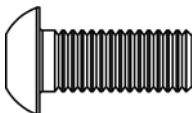
4x  M8-1.25 x 20mm Lg. BHCS

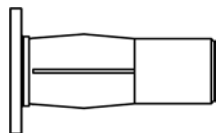
3x  M6 Rivet Nut

18x  M6-1.0 Nylock Nut

4x  M8-1.25 Nylock Nut

4x  M6-1.0 Jam Nut

Disregard any remaining hardware

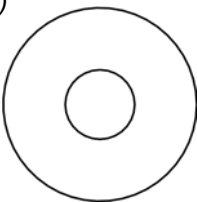
4x  M8 Flat Washer

4x  M6 Flat Washer

18x  M6 Sealing Washer

Rubber must face plastic when installing M6 Sealing Washer

Use hand tools only when assembling

Do not use power tools

When assembling, **do not tighten hardware completely unless noted.**

Windshield Cleaning:

- Do not use a dry cloth, or your hands, to wipe off Windshield; Scratching will occur.
 - Do not use window cleaning fluids (Windex, 409, etc) or any solvents (gasoline, denatured alcohol, acetone, etc).
 - Never use abrasive cleaners, abrasive pads, or gritty cloths.
1. Thoroughly rinse Windshield to float off dirt and mud.
 2. Using a soft cloth, or microfiber cloth, clean Windshield with warm water and a gentle detergent. Baby shampoo or hand washing soap are recommended.
 3. To prevent water spots, use a chamois and blot Windshield dry.

- Install Seal around outer edge of Windshield (A).

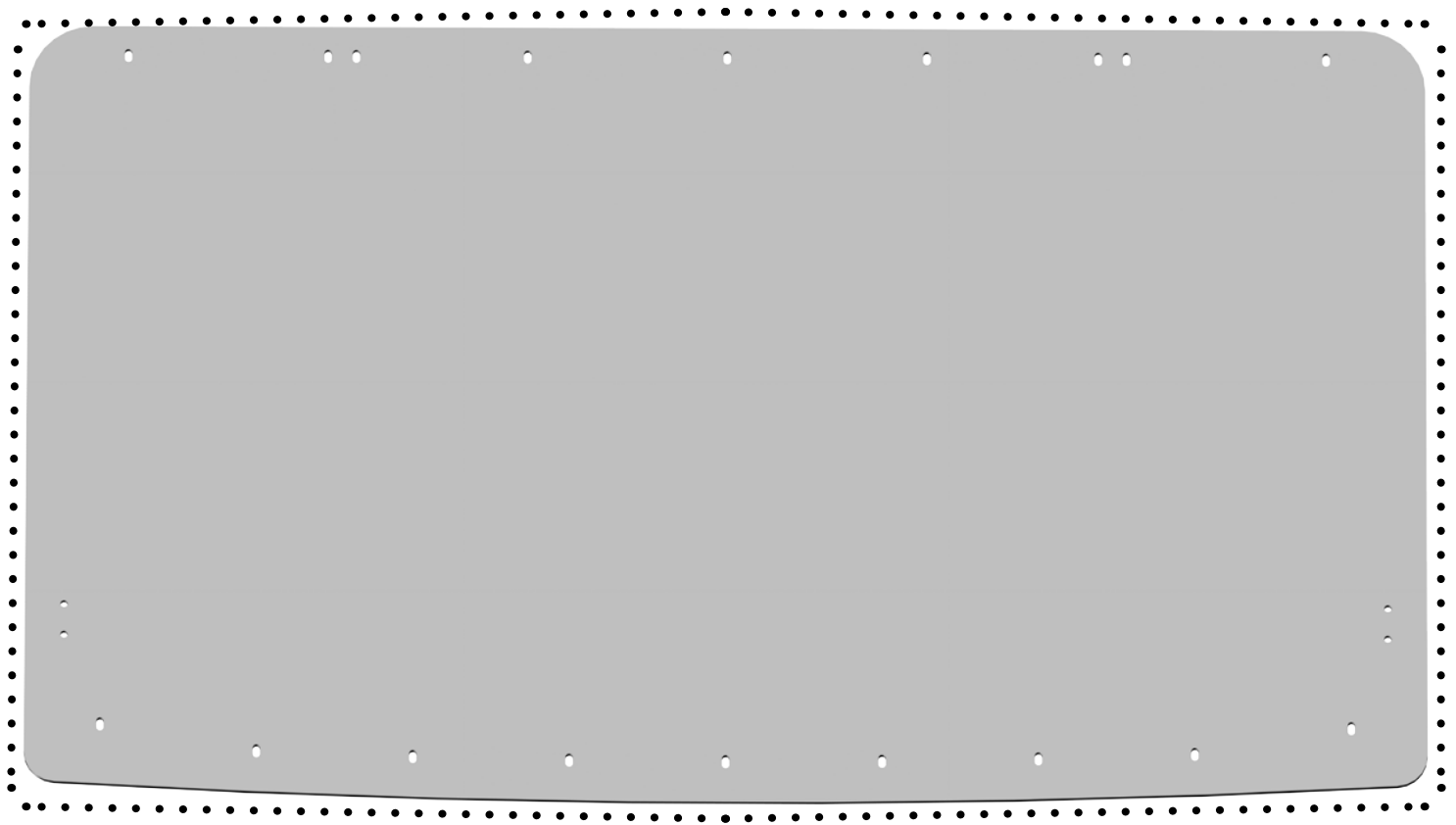

Soak Seal in hot water before cutting or installing to increase flexibility.



Seal

Seal



Bulb portion of Seal to always face towards vehicle

- Install Lower Frame (E) to Windshield (A) with hardware shown.

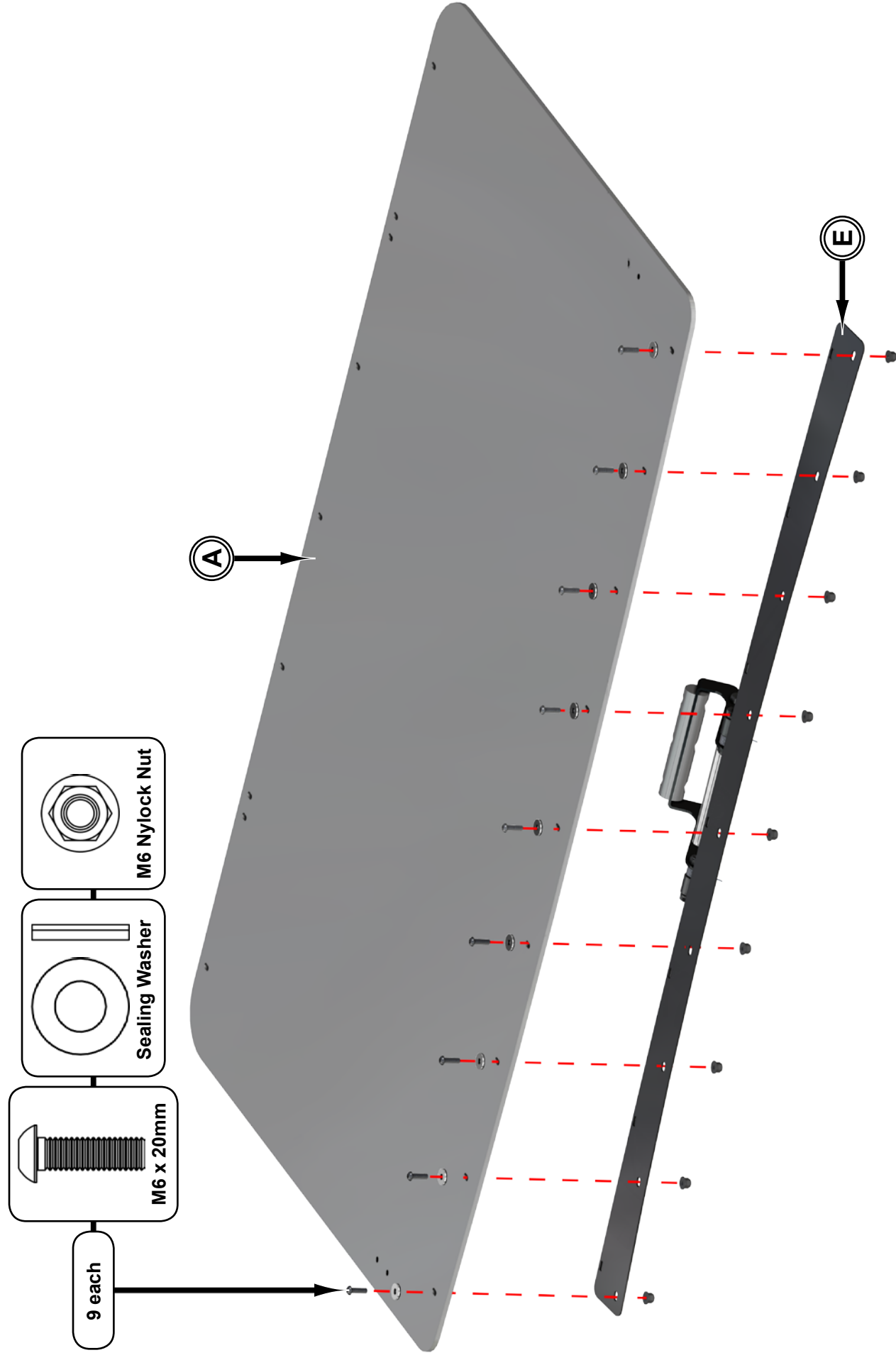

- Install Top Frame (B) to Windshield (A) with hardware shown.

- Install Right/Left Female Hinges (H-K) to Windshield (A) and Top Frame (B) with hardware shown.

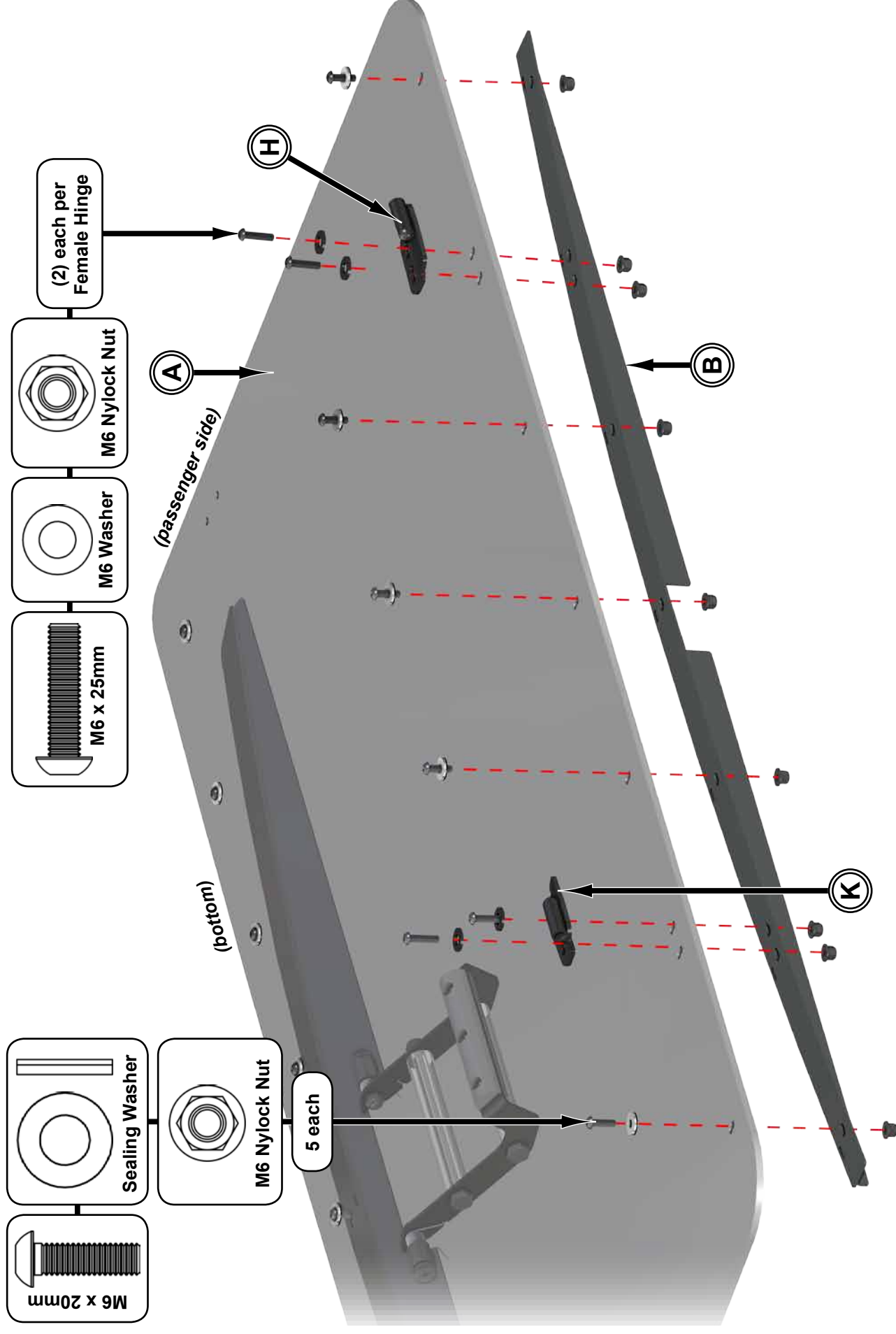

- Place Windshield (A) onto machine.
- Insert Left Male Hinge (J) into Left Female Hinge (K) and secure to Frame with hardware shown.
- Repeat for opposite Hinge.

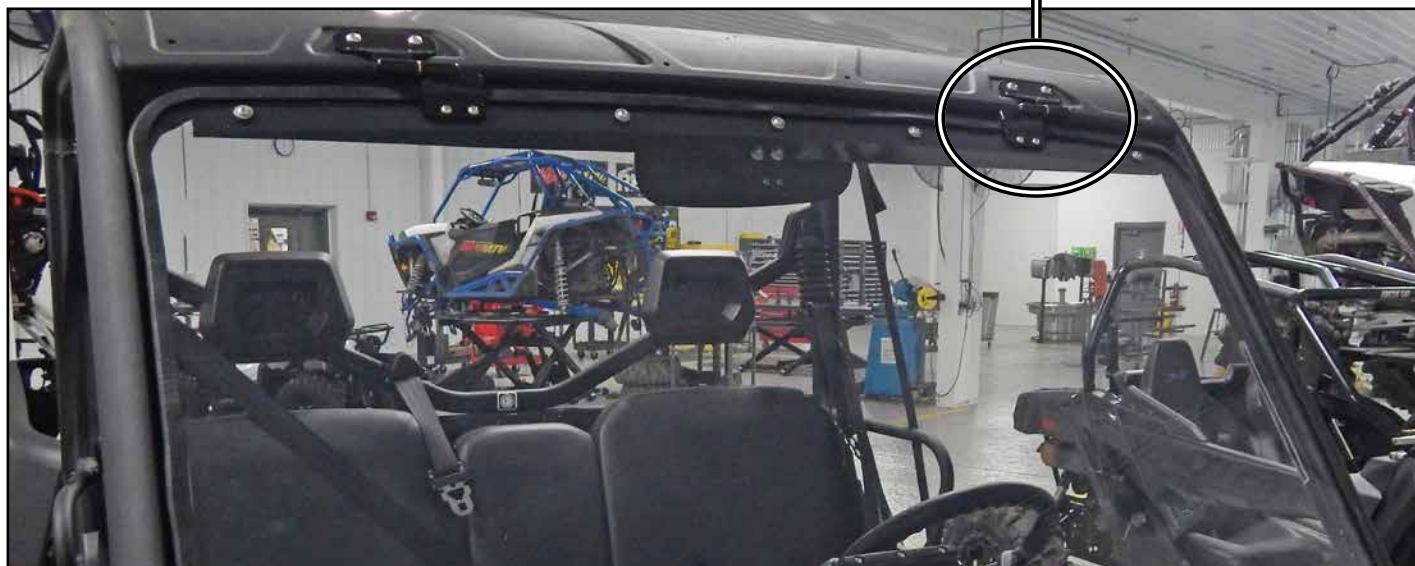
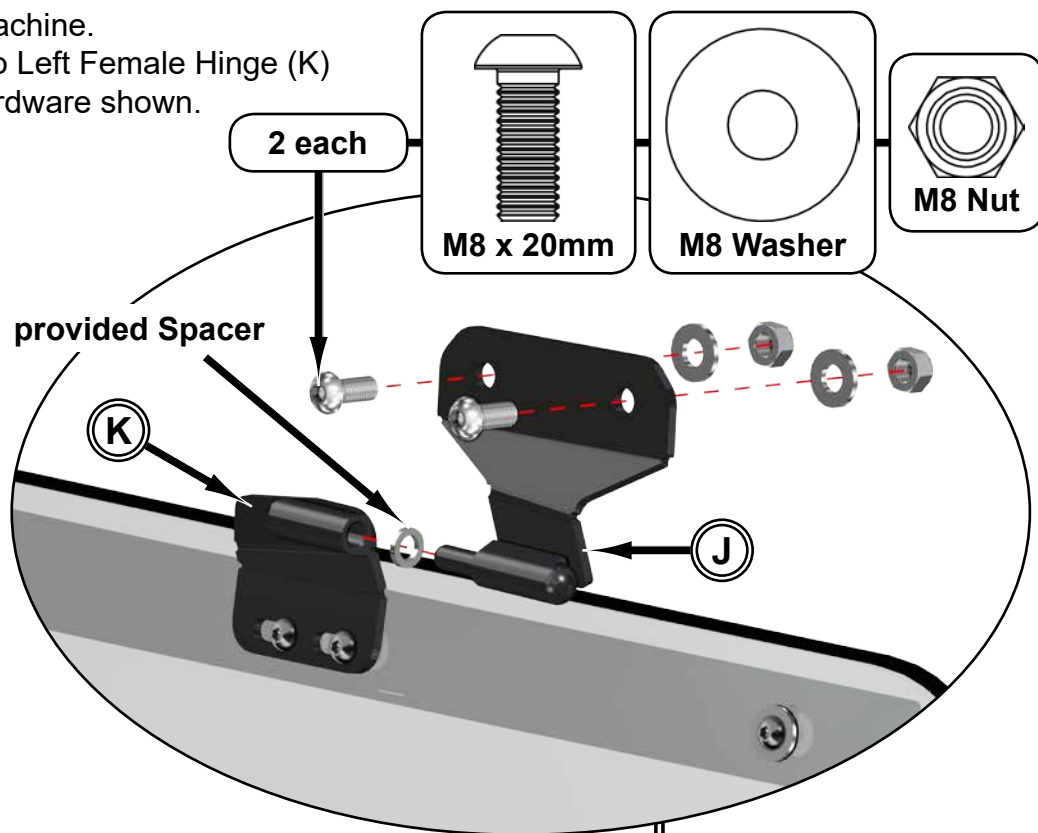

- Center Windshield (A) side-to-side on machine and tighten hardware completely.

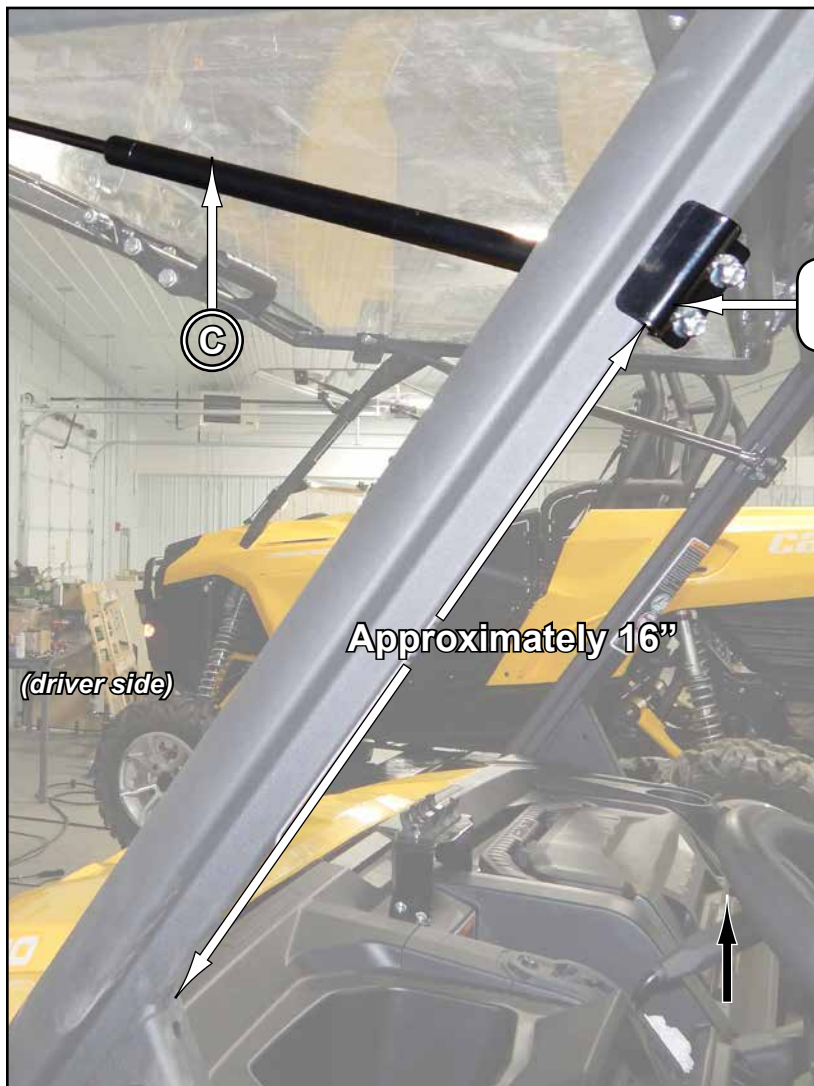

Place around Frame at distance shown and slightly tighten hardware.

- Secure to Windshield (A) with hardware shown.

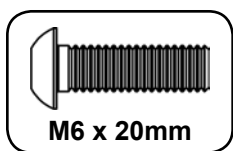

2 each

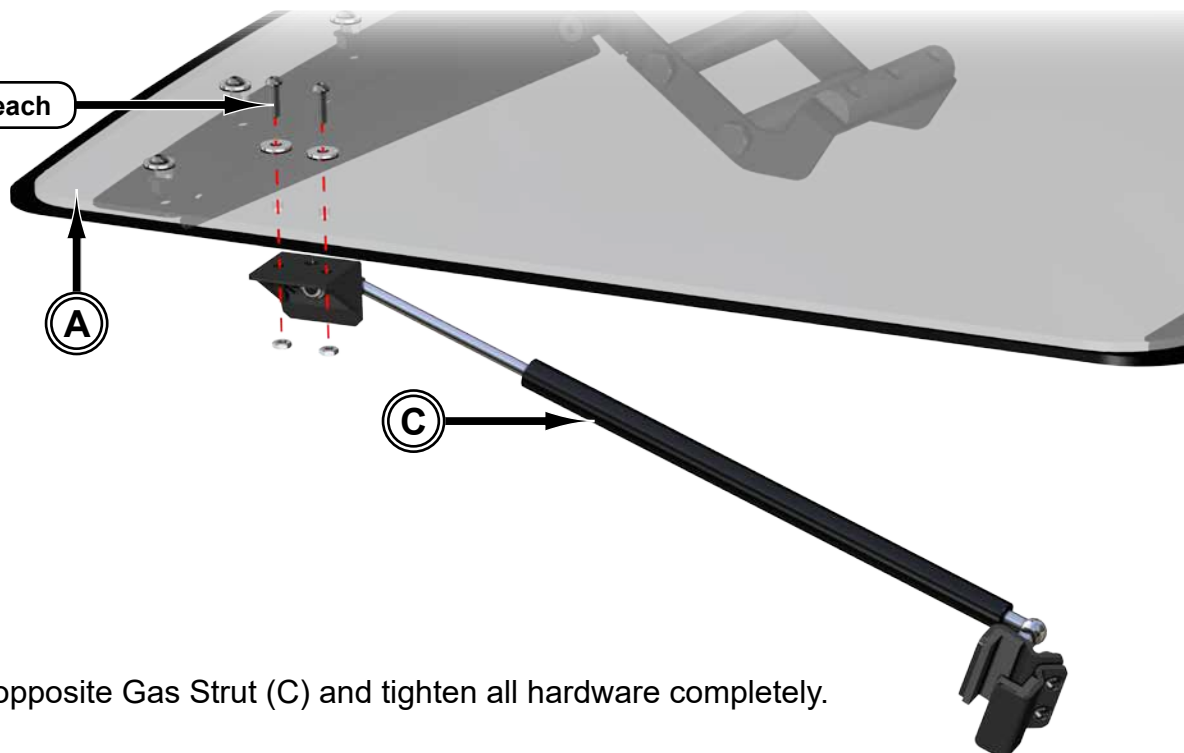
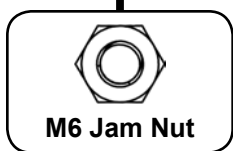

Repeat steps for opposite Gas Strut (C) and tighten all hardware completely.

Handle Latch Plate (F) installation

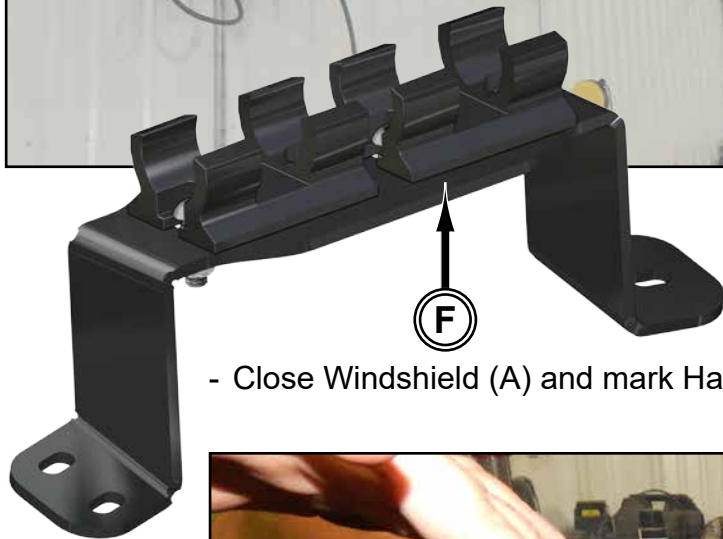

- Close Windshield (A) and mark Handle Latch Plate (F) hole locations onto Dash.



- Drill so that holes are Ø10mm.

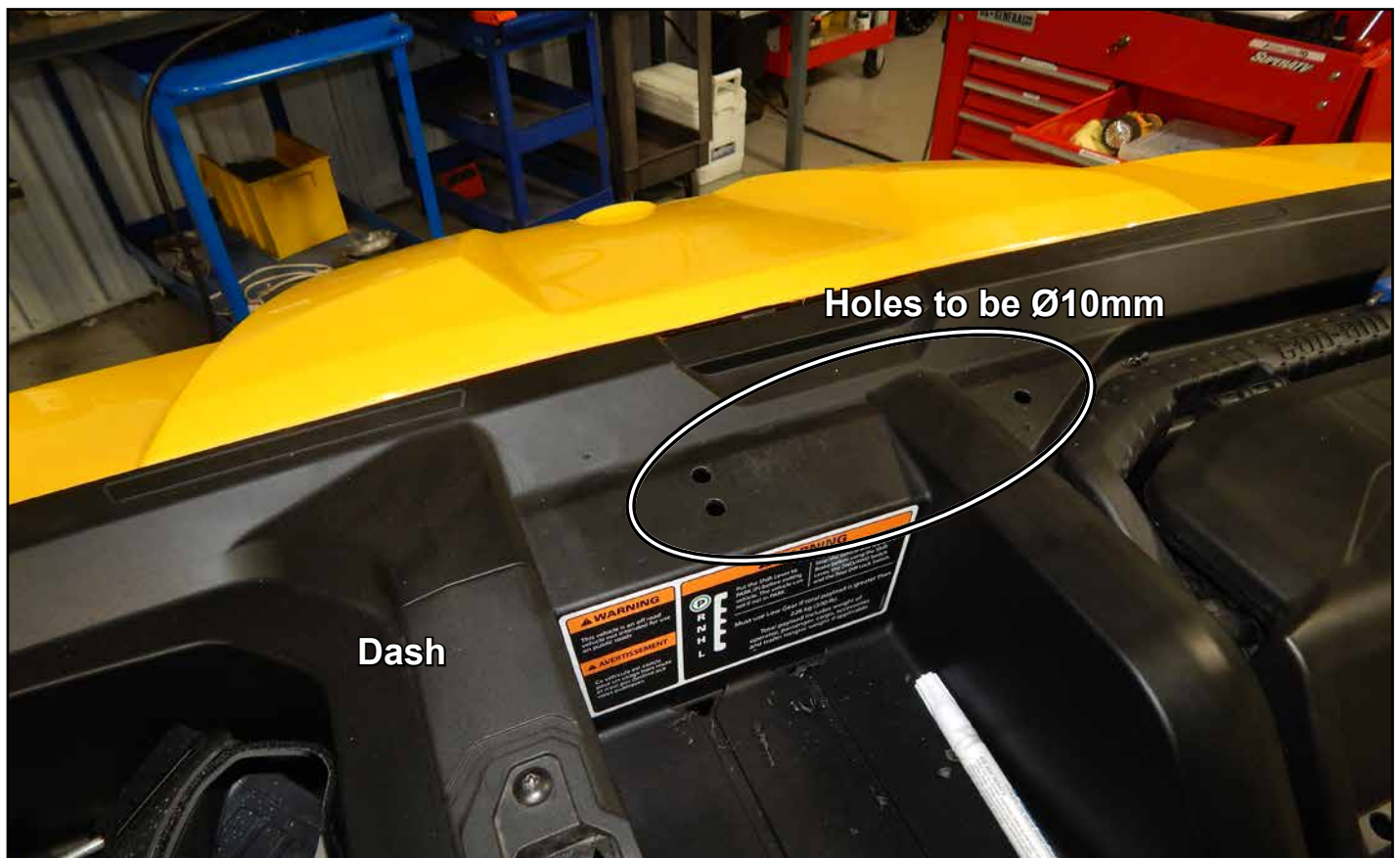

- Insert Rivet Nuts into holes.



- [illegible]