

1992-2014 FORD E-SERIES VAN INSTALLTION INSTRUCTIONS

Please read before installing

- *Stainless steel hardware may bind together when tightening—It is recommended that you apply an anti-seize assembly lubricant to the threads of each bolt before assembly*
- *The ladder is designed to fit either behind the rear wheel on a regular or extended body Ford van.*
- *The Van body is curved so if you want to mount it further back on an extended Van the ladder may not fit as well and look to be at an angle.*



Included Hardware:

PRE-KIT 350457

- | | |
|---|---|
| • 70060 - 1/4-20 x 1" Button Head Cap Screw, SS | 2 |
| • 70009 - 1/4 x 5/8 Washer SS (.03" Thick) | 4 |
| • 70008 - 1/4-20 Nylock Nuts SS | 2 |
| • Clips, Ladder Ford Van | 2 |
| ○ 70009 - 1/4 x 5/8 Washer SS (.03" Thick) | 4 |
| ○ 70008 - 1/4-20 Nylock Nuts SS | 4 |
| ○ 70003 - 8-32 x 1/2" Bolt P-Pan MS SS | 4 |
| • Antiseize Packet, 2g | 1 |

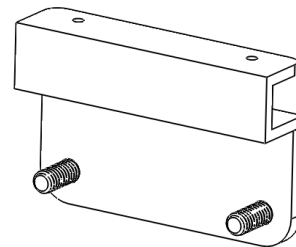

x2
Ford Ladder Clip

Installation Instructions

1. Fit the ladder onto the van by hooking the lower plate under and behind the pinch weld of the van (See **Figure 1**)
2. Fastening the top of the ladder:
 - a. Make sure the Phillips head screws are fully backed out first.
 - b. Make sure the ladder is positioned where you want it along the vehicle.
 - c. Press the two separate brackets on top of ladder onto the drip rail.
 - i. Tighten down the Phillips head screws.
3. Use a clamp or two to hold the lower plate tight against the pinch weld.
4. Drill 2 - 1/4" holes through the bottom plate and pinch weld.
5. Insert the 1/4"-20 x 3/4" Hex bolts, with 1/4" washers through the drilled holes and fasten with 1/4"-20 Nylock Nuts.
6. Tighten nuts on the top brackets. **DO NOT OVERTIGHTEN!!** As they are small bolts It is easy to snap the threads.

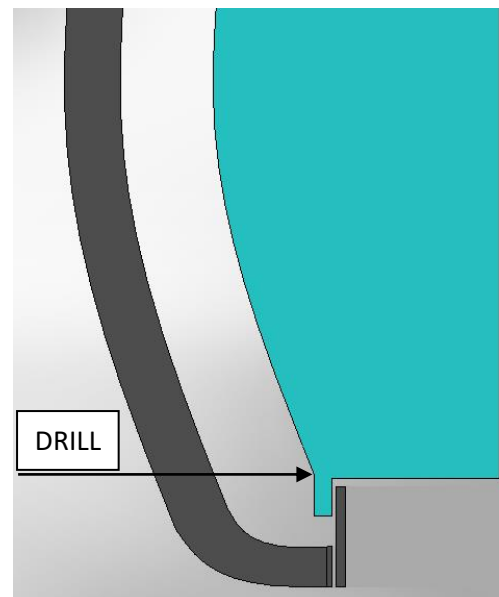

**Figure 1: Drawing of van bottom with
 ladder seen from rear of vehicle**