

Item	Description	Qty
A	Front Brackets	2
B	Spring Spacers	1 Pr
C	Support Bar	1

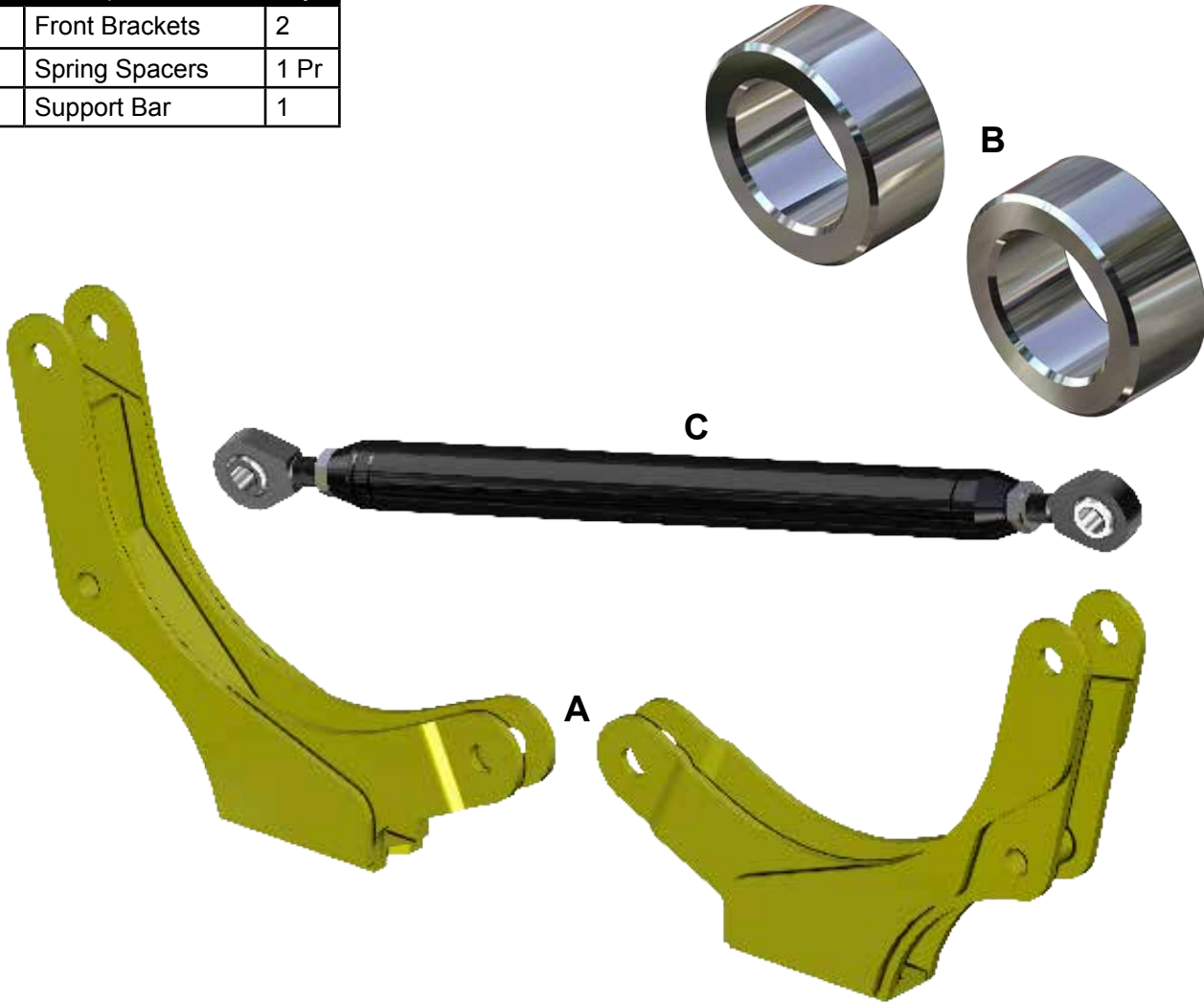

kit contents continue on following page

Read instructions and view illustrations before beginning.

Need help with your installation?

✉ sales@superatv.com 💻 www.superatv.com

☎ 1-812-574-7777 🕒 8:00am - 9:00pm EST M-Th
 8:00am - 7:00pm EST Friday
 9:00am - 2:00pm EST Saturday

*Thank You
 For Choosing*



Liability Statement
 SuperATV's[®] products are designed to best fit user's ATV/UTV under stock conditions. Adding, modifying, or fabricating any factory or aftermarket parts will void any warranty provided by SuperATV[®] and is not recommended. SuperATV's[®] products could interfere with other aftermarket accessories. If user has aftermarket products on machine, contact SuperATV[®] to verify that they will work together.

Although SuperATV[®] has thousands of satisfied customers, user should be aware that installing lift kits, long travel, or suspension kits, tires, etc. will change the ride of machine and may increase maintenance and part wear. Operating any off-road machine while, or after, consuming alcohol and/or drugs increases risk of bodily harm or death. No warranty or representation is made as to this product's ability to protect user from severe injury or death. SuperATV[®] urges operators and occupants to wear a helmet and appropriate riding gear at all times.

By purchasing and installing SuperATV[®] products, user agrees that should damages occur, SuperATV[®] will not be held responsible for loss of time, use, labor fees, replacement parts, or freight charges. SuperATV[®], nor any 3rd party, will not be held responsible for any direct, indirect, incidental, special, or consequential damages that result from any product purchased from SuperATV[®]. The total liability of seller to user for all damages, losses, and causes of action, if any, shall not exceed the total purchase price paid for the product that gave rise to the claim.

SuperATV[®] will warranty only parts provided by SuperATV[®]. Any damage or problems with OEM housings, bearings, seals, or other manufacturers' products will not be covered by SuperATV[®]. SuperATV[®] parts and products are not warranted if item was not installed properly, misused, or modified.

(kit contents continued)

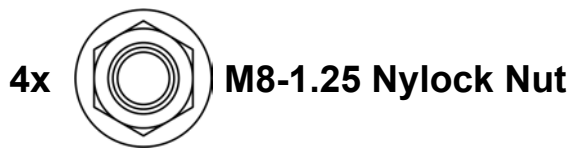
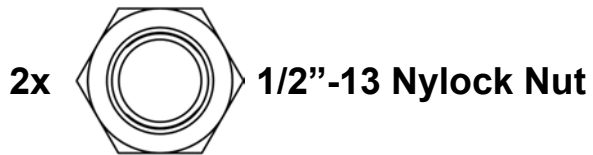
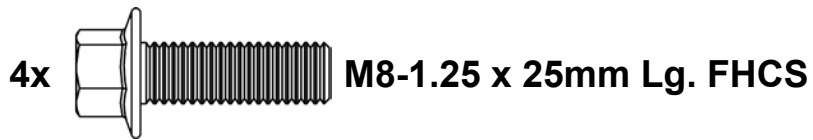
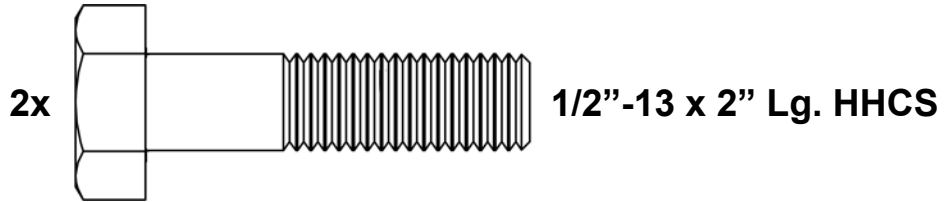

Front Removal: *Keep all components removed from machine.*



- Install Front Brackets (A) to Frame; See following page.



Front installation: *Do not tighten hardware completely unless noted.*

- Install Front Brackets (A) to Frame with hardware shown.
- Repeat for opposite side.

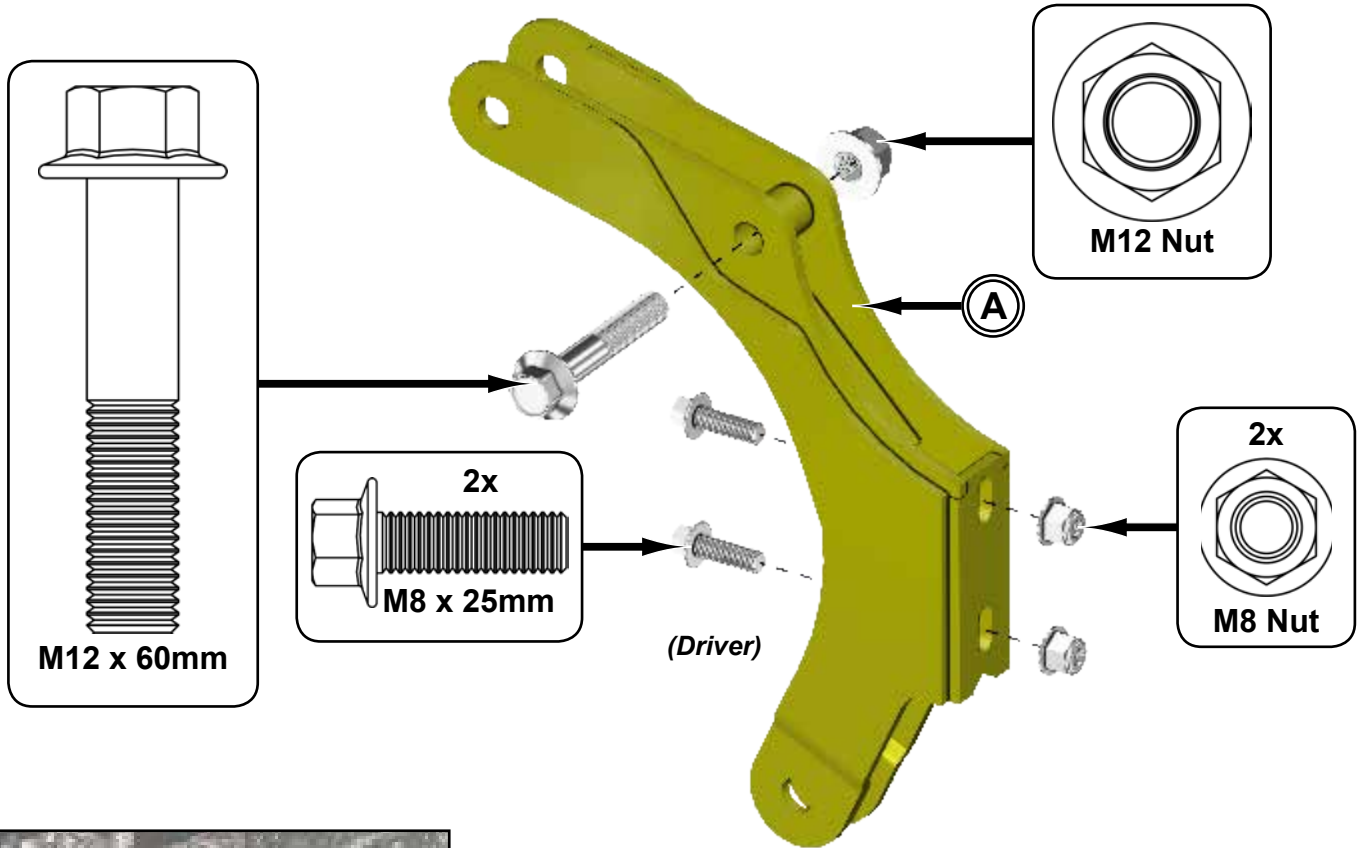

Tighten hardware completely.

Front installation continued: *Do not tighten hardware completely unless noted.*

- Measure distance between Front Brackets (A) as shown and set Support Bar (C) to that dimension.
- Install Support Bar (C) to Front Brackets (A) with hardware shown.

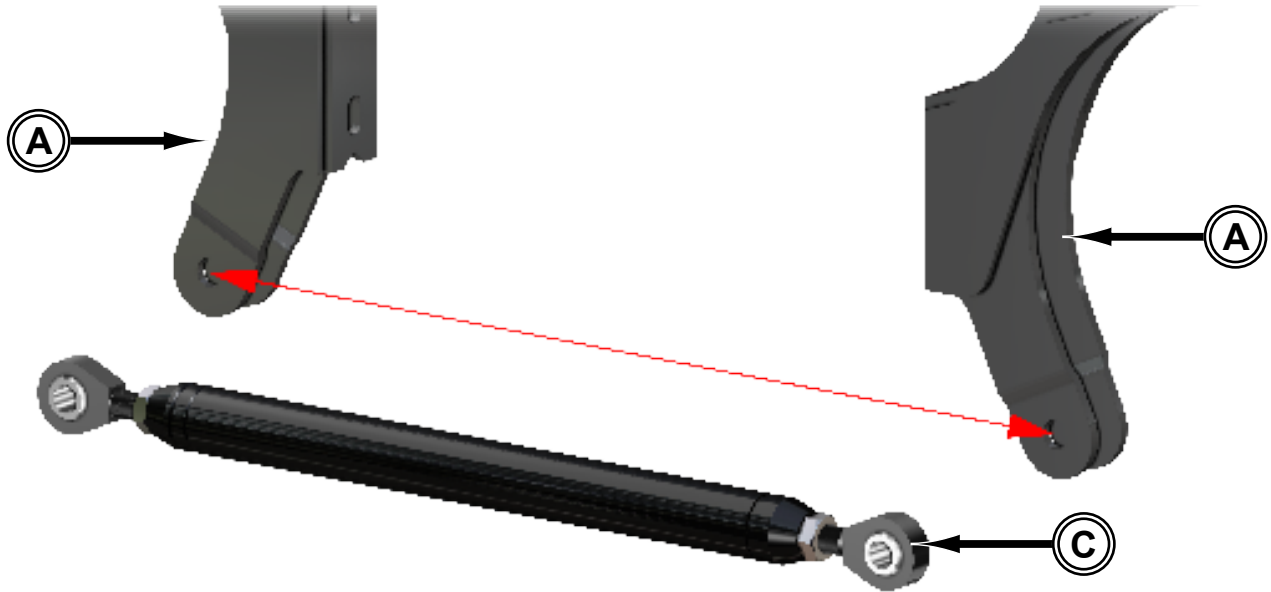

Tighten hardware completely.

Front installation continued: *Do not tighten hardware completely unless noted.*

- Install Shocks to Front Brackets (A) with stock hardware.

SHOCKS MUST BE ROTATED SO THAT RESERVOIR IS TO INSIDE OF MACHINE

- Tighten hardware completely.



Rear Removal: *Keep all components removed from machine.*



SuperATV highly recommends using a Spring Compressor when removing Springs

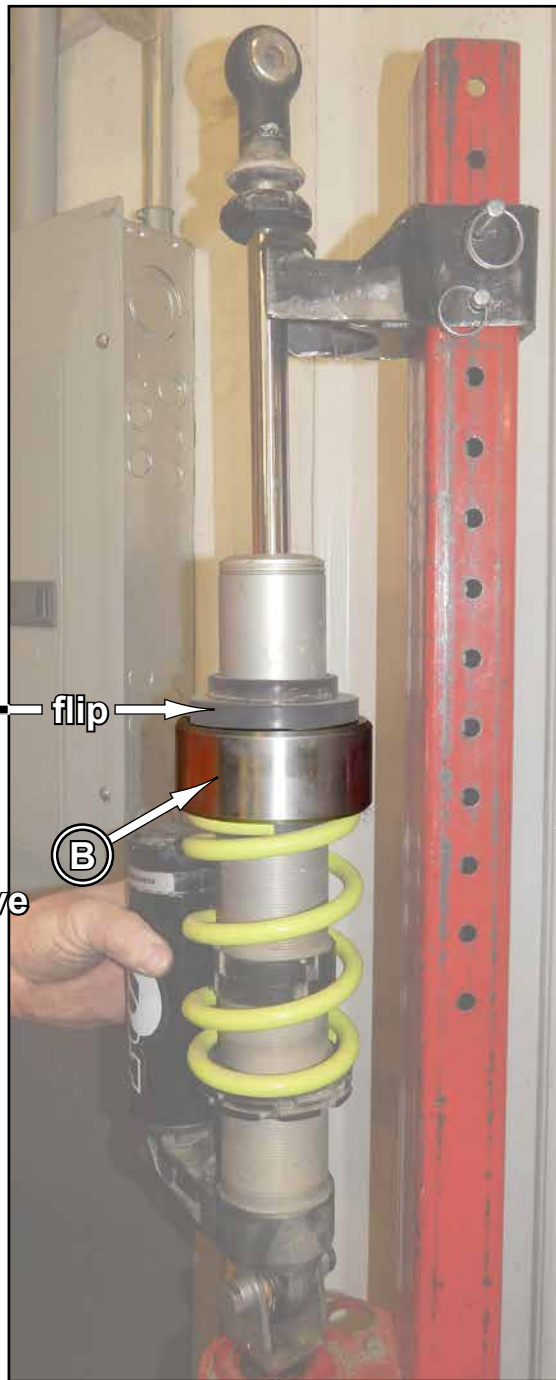
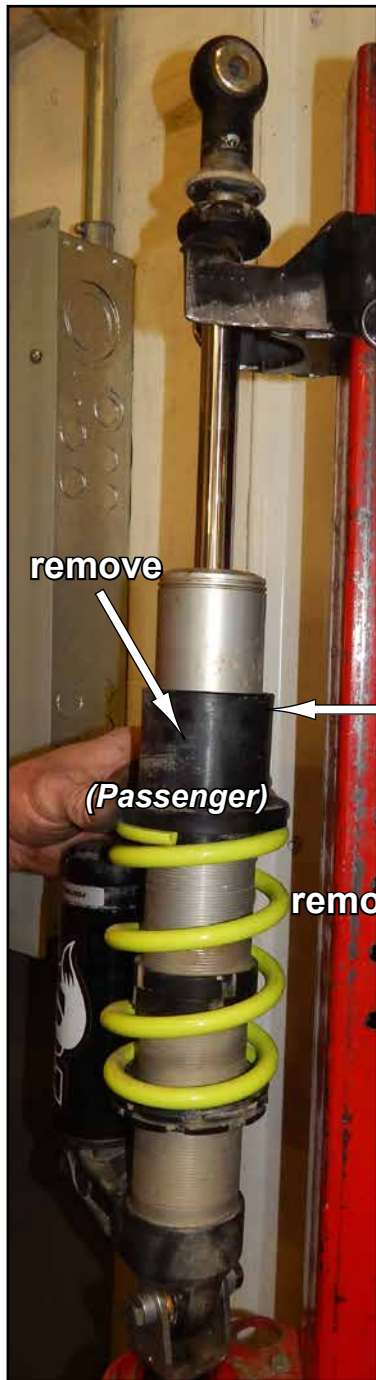

adjust Nut so that distance is 1-1/2"
from top of Nut to Mount

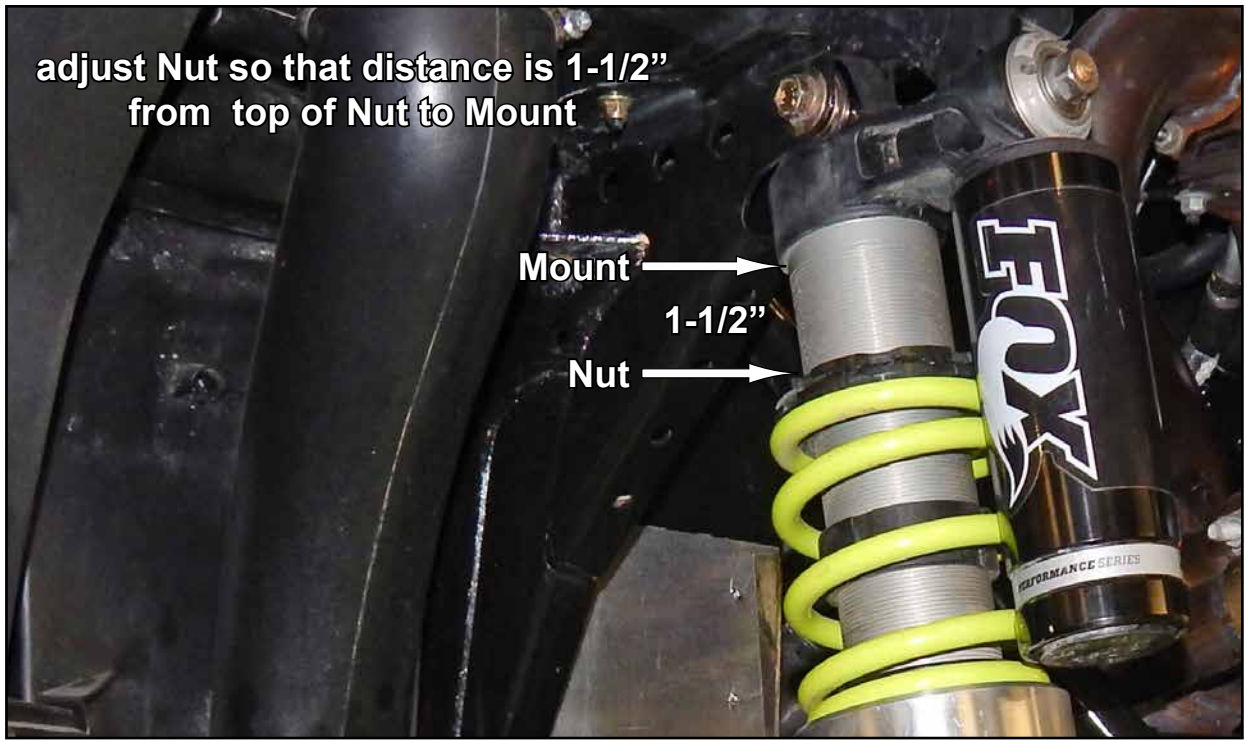

Install Shocks to machine with stock hardware.



(Driver)