

## INSTALLATION INSTRUCTIONS

### Flip Windshield: for Polaris Ranger<sup>®</sup> 900

Item	Description
A	Windshield



**Bulb Seal**

*(kit contents continue on following pages)*

**Read instructions and view illustrations before beginning.**

#### Need help with your installation?



[sales@superatv.com](mailto:sales@superatv.com)



[www.superatv.com](http://www.superatv.com)



1-812-574-7777



8:00am - 9:00pm EST M-Th  
8:00am - 7:00pm EST Friday  
9:00am - 2:00pm EST Saturday

*Thank You  
For Choosing*



#### Liability Statement

SuperATV's<sup>®</sup> products are designed to best fit user's ATV/UTV under stock conditions. Adding, modifying, or fabricating any factory or aftermarket parts will void any warranty provided by SuperATV<sup>®</sup> and is not recommended. SuperATV's<sup>®</sup> products could interfere with other aftermarket accessories. If user has aftermarket products on machine, contact SuperATV<sup>®</sup> to verify that they will work together.

Although SuperATV<sup>®</sup> has thousands of satisfied customers, user should be aware that installing lift kits, long travel, or suspension kits, tires, etc. will change the ride of machine and may increase maintenance and part wear. Operating any off-road machine while, or after, consuming alcohol and/or drugs increases risk of bodily harm or death. No warranty or representation is made as to this product's ability to protect user from severe injury or death. SuperATV<sup>®</sup> urges operators and occupants to wear a helmet and appropriate riding gear at all times.

By purchasing and installing SuperATV<sup>®</sup> products, user agrees that should damages occur, SuperATV<sup>®</sup> will not be held responsible for loss of time, use, labor fees, replacement parts, or freight charges. SuperATV<sup>®</sup>, nor any 3rd party, will not be held responsible for any direct, indirect, incidental, special, or consequential damages that result from any product purchased from SuperATV<sup>®</sup>. The total liability of seller to user for all damages, losses, and causes of action, if any, shall not exceed the total purchase price paid for the product that gave rise to the claim.

SuperATV<sup>®</sup> will warranty only parts provided by SuperATV<sup>®</sup>. Any damage or problems with OEM housings, bearings, seals, or other manufacturers' products will not be covered by SuperATV<sup>®</sup>. SuperATV<sup>®</sup> parts and products are not warranted if item was not installed properly, misused, or modified.

(kit contents continued)

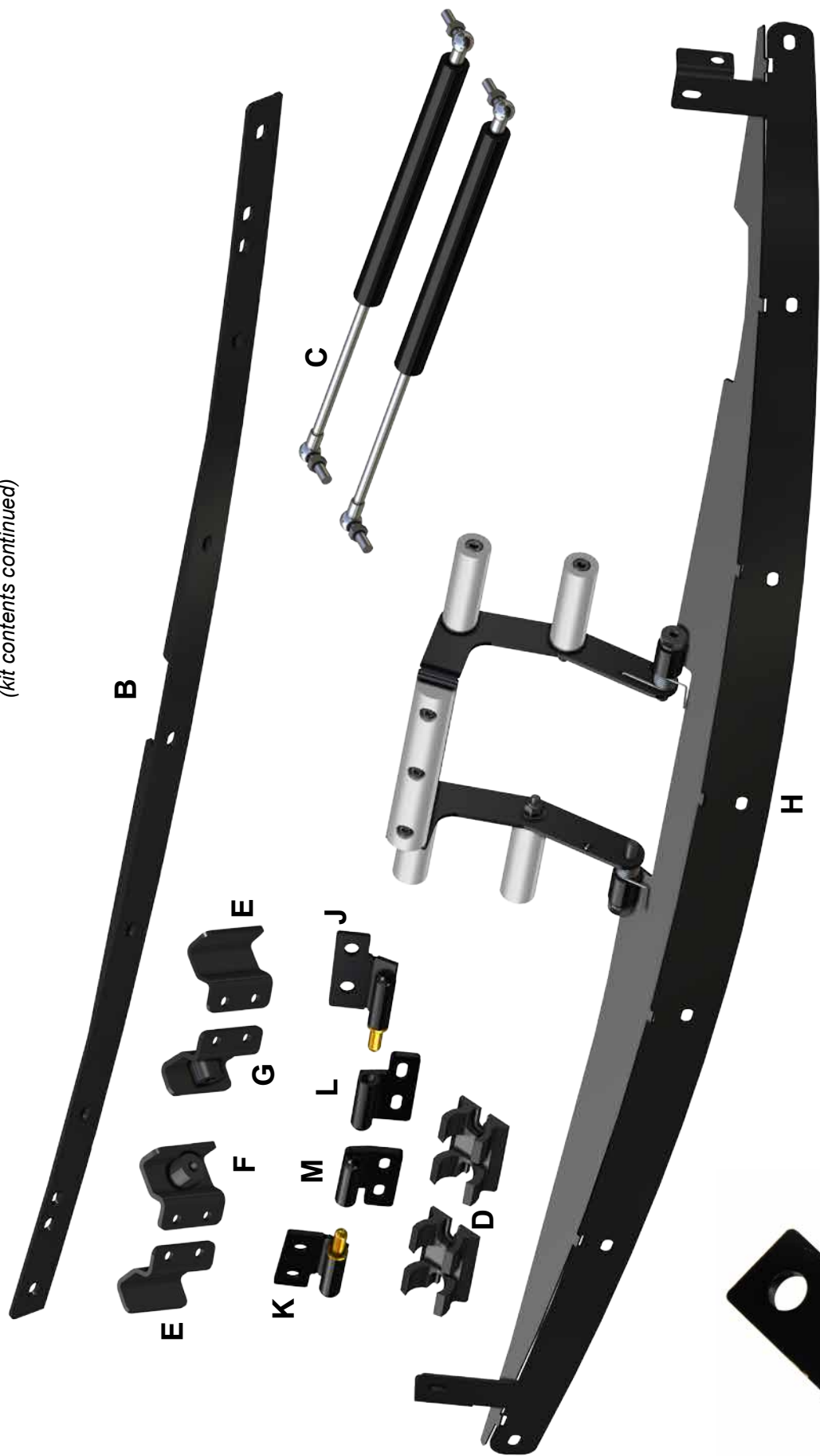

Item		Description	Qty
B	Top Frame		1
C	Gas Strut		2
D	Catch		2
E	Strut Clamp		2
F	Right Strut Bracket		1
G	Left Strut Bracket		1
H	Lower Frame		1
J	Left Male Hinge		1
K	Right Male Hinge		1
L	Left Female Hinge		1
M	Right Female Hinge		1

(kit contents continued)

21x  M6-1.0 x 20mm Lg. BHCS

28x  M6-1.0 Nylock Nut

4x  M6 Washer

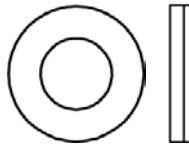
16x  M6 Sealing Washer

7x  M6-1.0 x 16mm Lg. BHCS

2x  M8-1.25 Nylock Nut

4x  M8-1.25 Nylock Nut

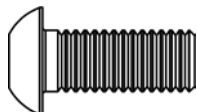
4x  M8-1.25 x 20mm Lg. BHCS

  
Rubber must face plastic when installing M6 Sealing Washer

*Disregard any remaining hardware*

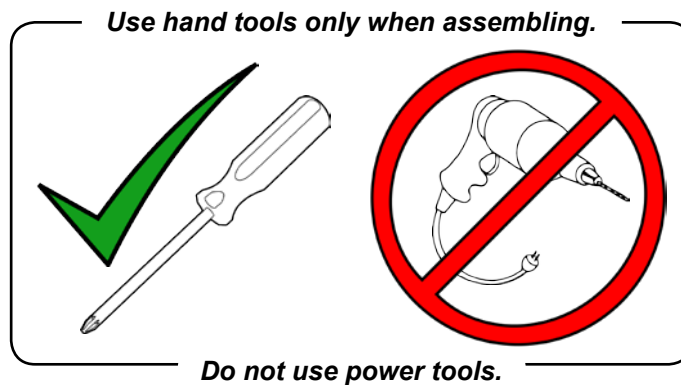

**⚠ When assembling, do not tighten hardware completely. ⚠**

**Windshield Cleaning:**

- Do not use a dry cloth, or your hands, to wipe off Windshield; Scratching will occur.
  - Do not use window cleaning fluids (Windex, 409, etc) or any solvents (gasoline, denatured alcohol, acetone, etc).
  - Never use abrasive cleaners, abrasive pads, or gritty cloths.
1. Thoroughly rinse Windshield to float off dirt and mud.
  2. Using a soft cloth, or microfiber cloth, clean Windshield with warm water and a gentle detergent. Baby shampoo or hand washing soap are recommended.
  3. To prevent water spots, use a chamois and blot Windshield dry.

**Reference only; do not assemble completely at this time.**



**Install Seal to Windshield (A) as shown:**  
***seal shown off for clarity only.***

***To ease installation, soak Seal in hot water before cutting or installing to increase flexibility.***

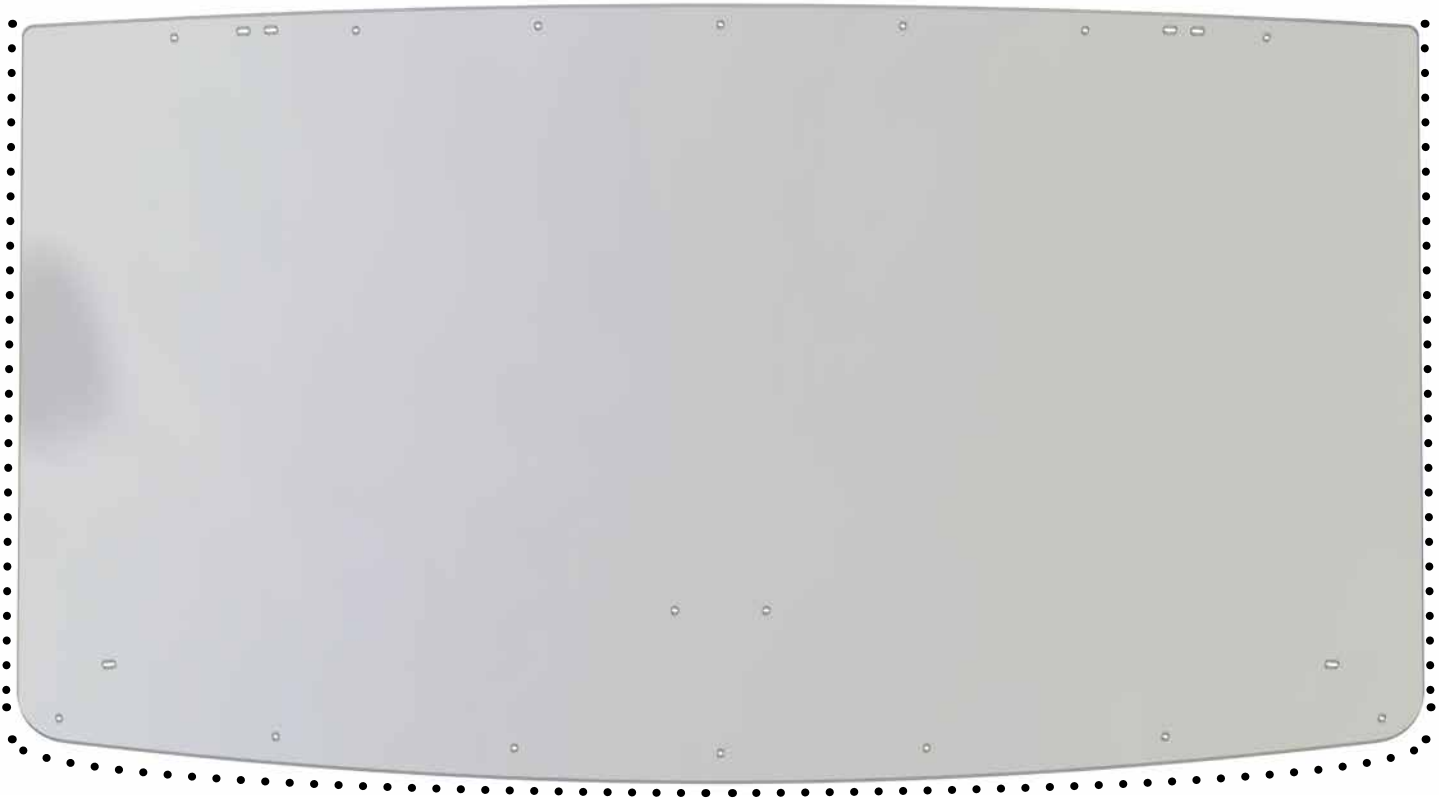

**Bulb Seal**

**Bulb Seal**



**Bulb portion of Seal to  
face towards vehicle**

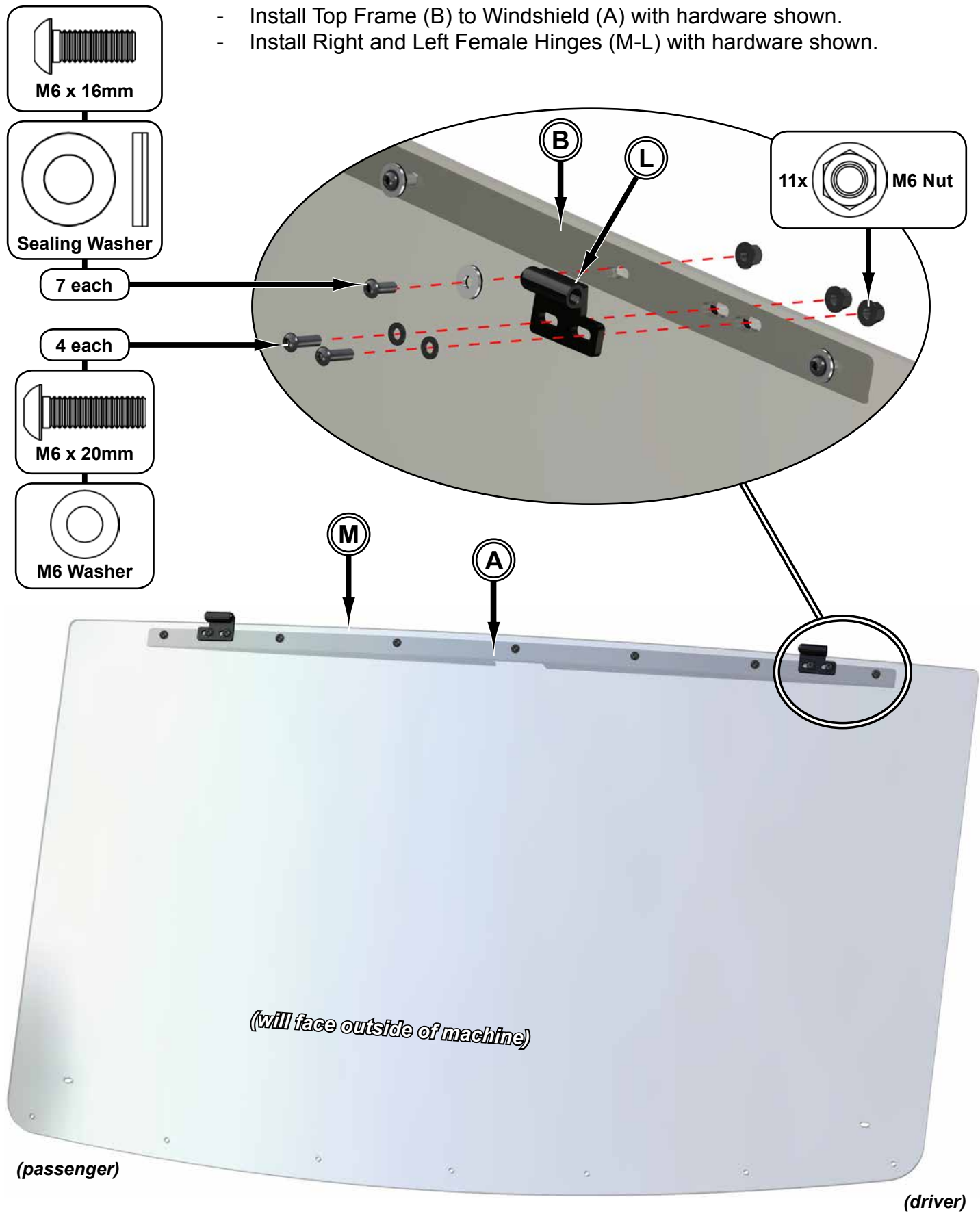

- Install Lower Frame (H) to Windshield (A) with hardware shown.

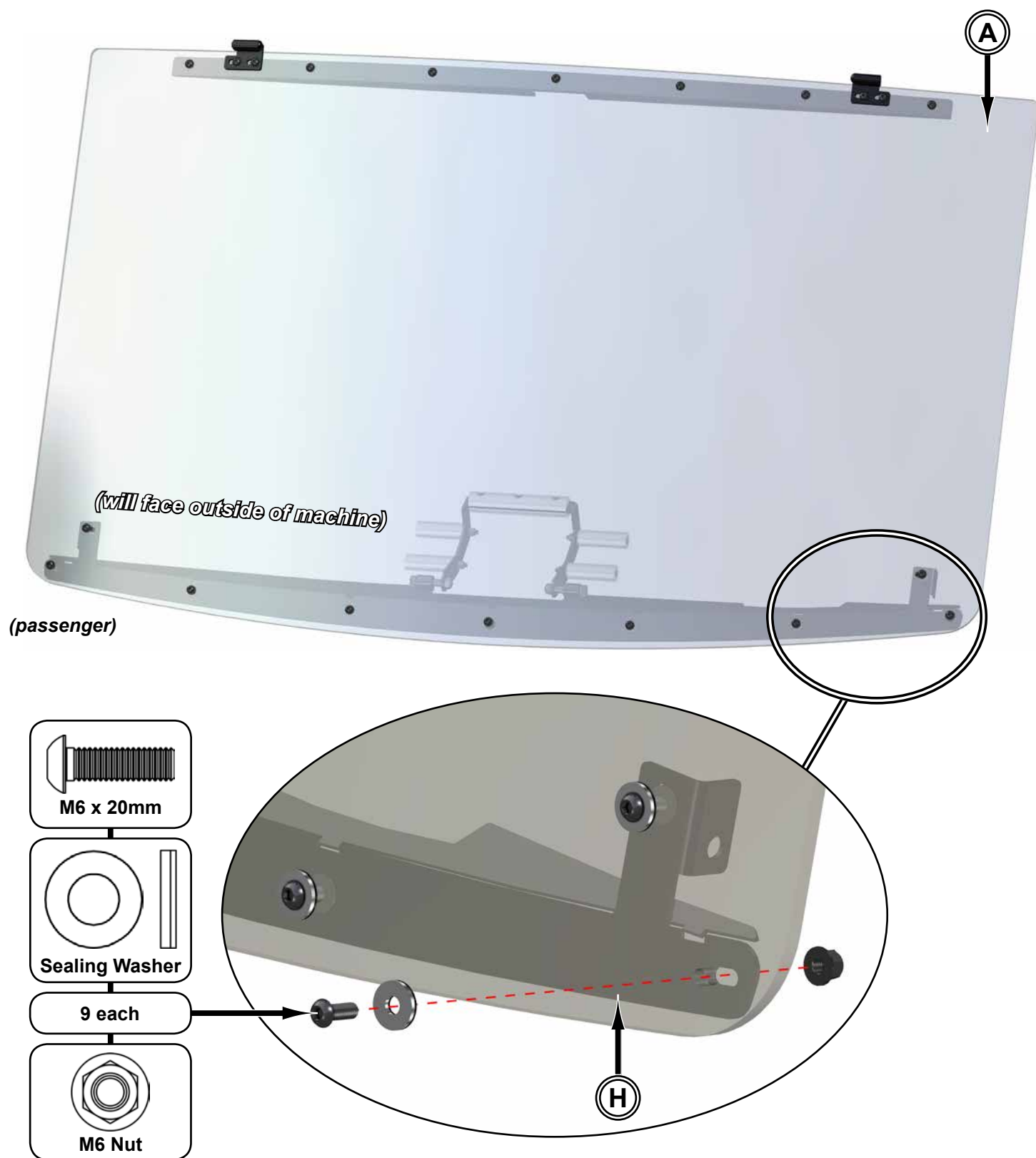



- Insert Left Male Hinge (J) into Left Female Hinge (L). *Provided Spacer must be installed.*
- Secure Left Male Hinge (J) to hole located in stock Windshield Mount Plate with hardware shown.
- Repeat for Right side.

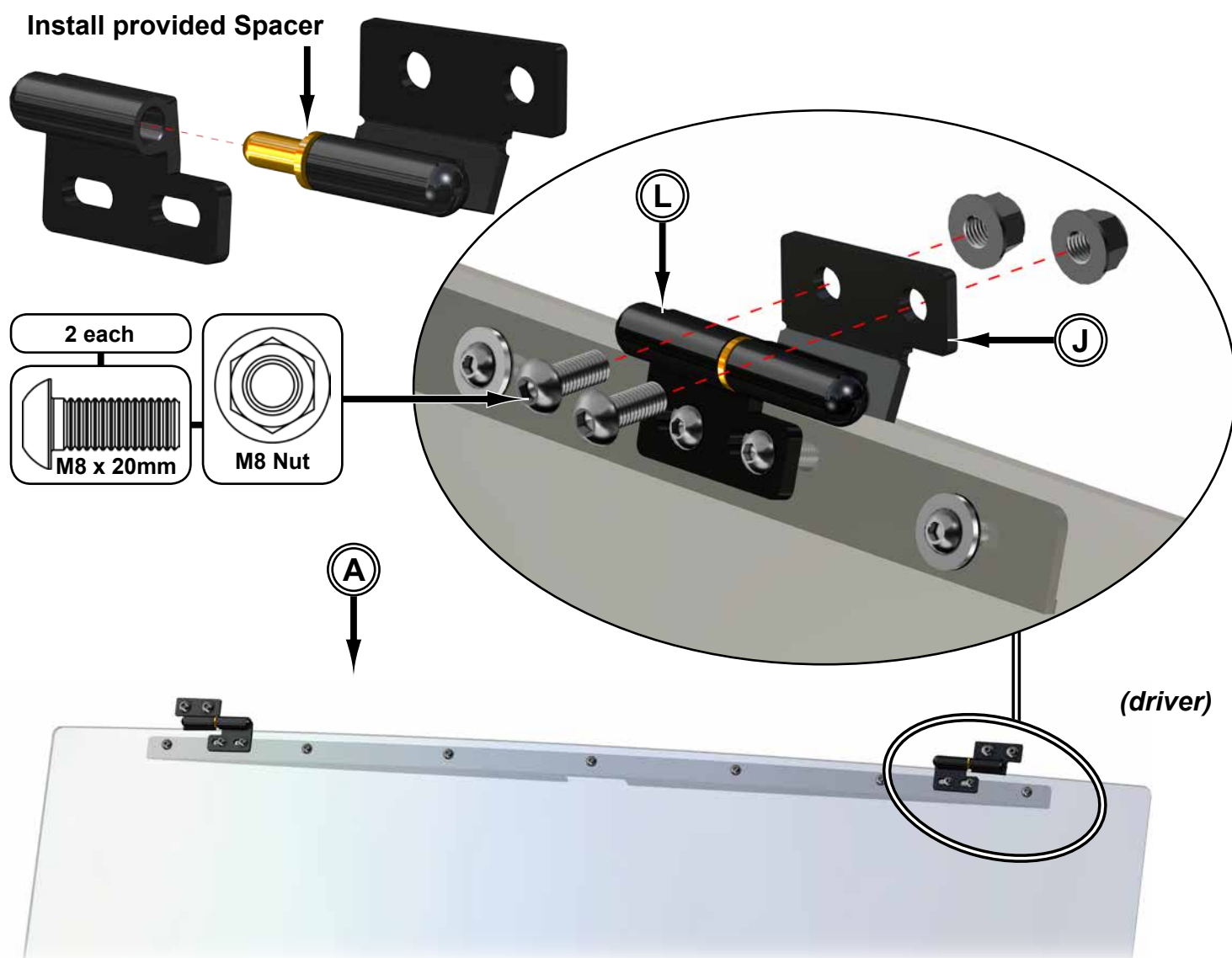
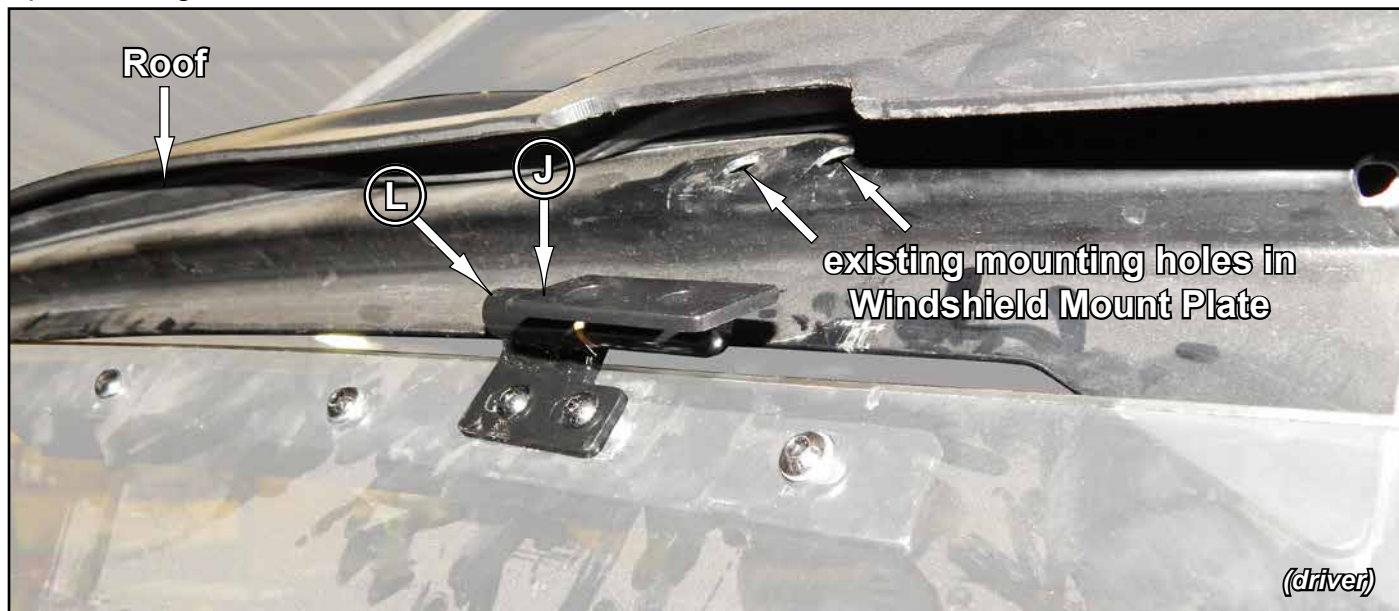



## Hinge Alignment

To avoid binding when opening and closing Windshield, align Hinges before tightening hardware.

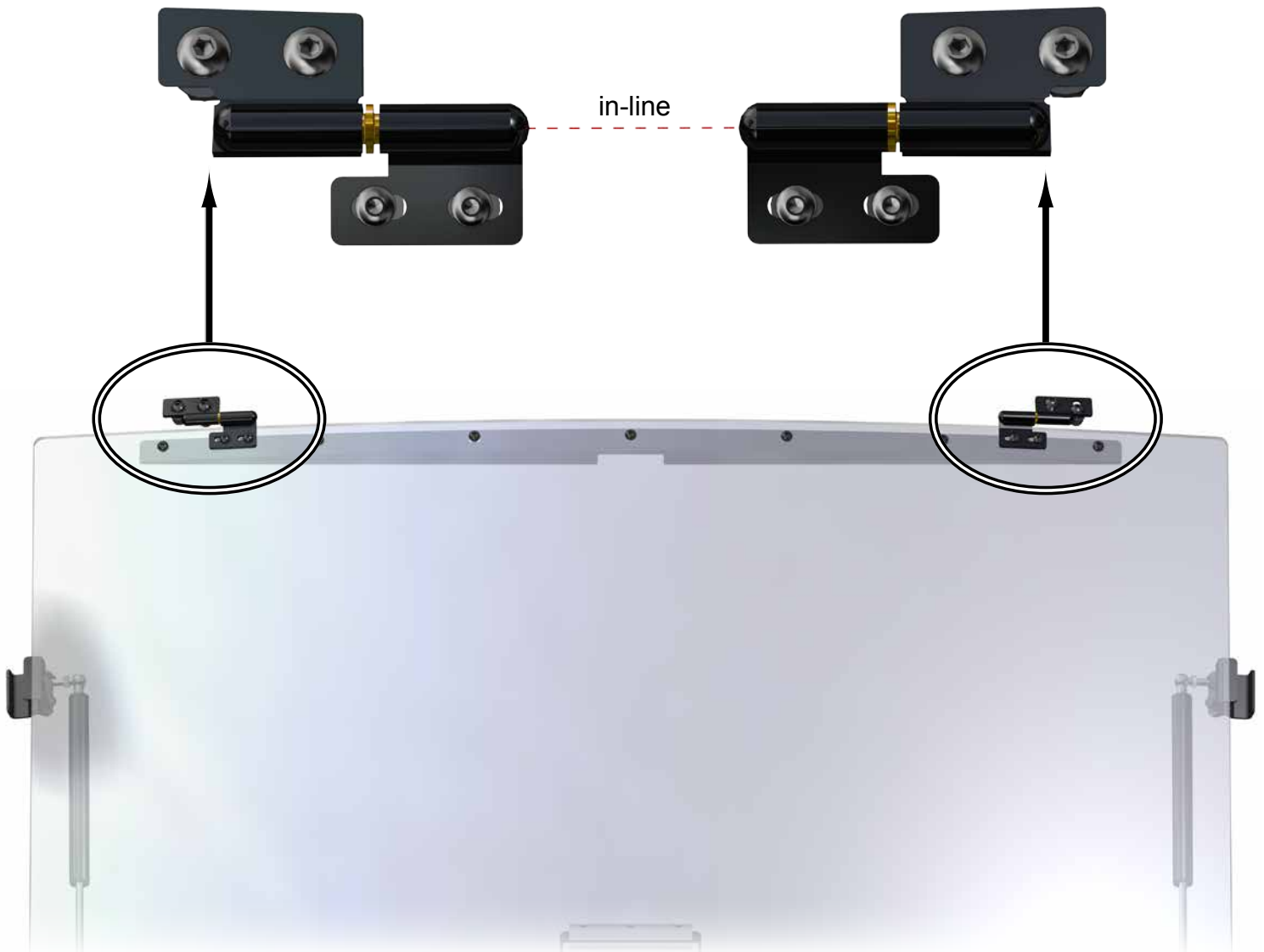

- Place Strut Clamp (E) and Left Strut Bracket (G) around Cab Frame as shown.
- Secure with hardware shown.
- Repeat for opposite side.

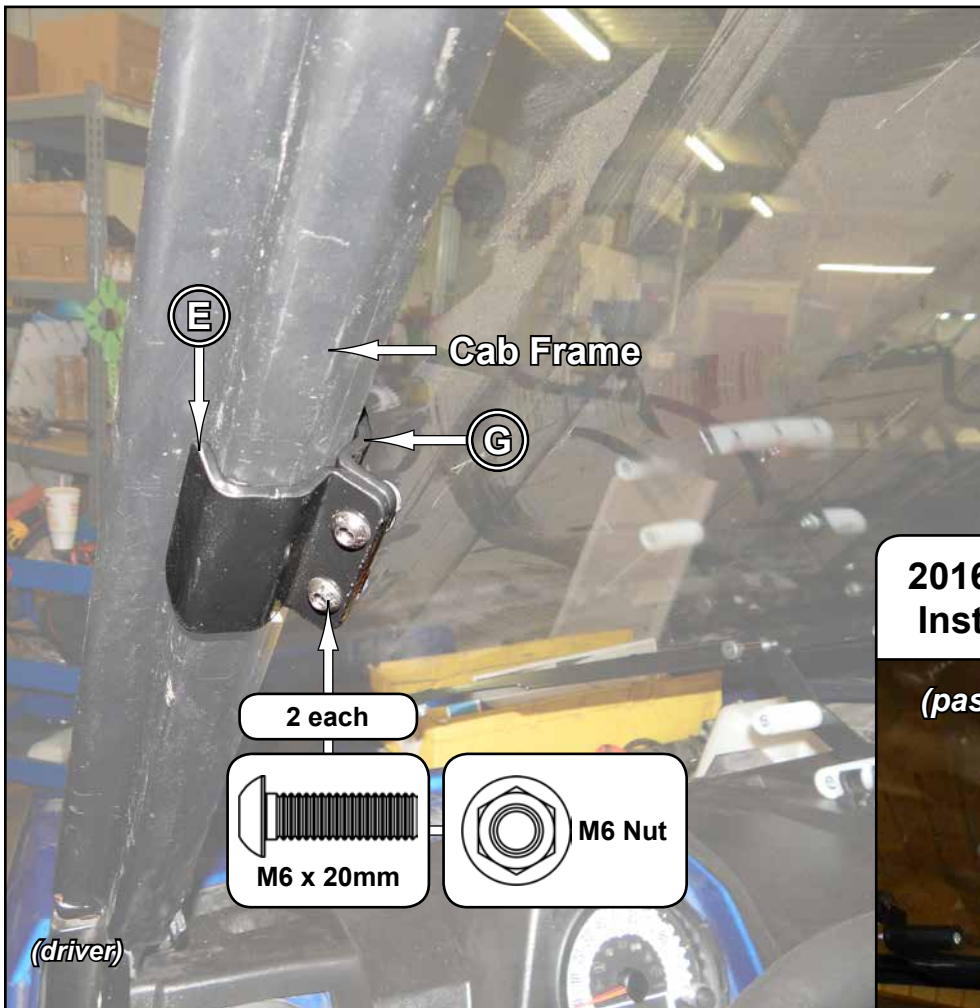

**2016+ models have a Grab Bar. Install components as shown.**

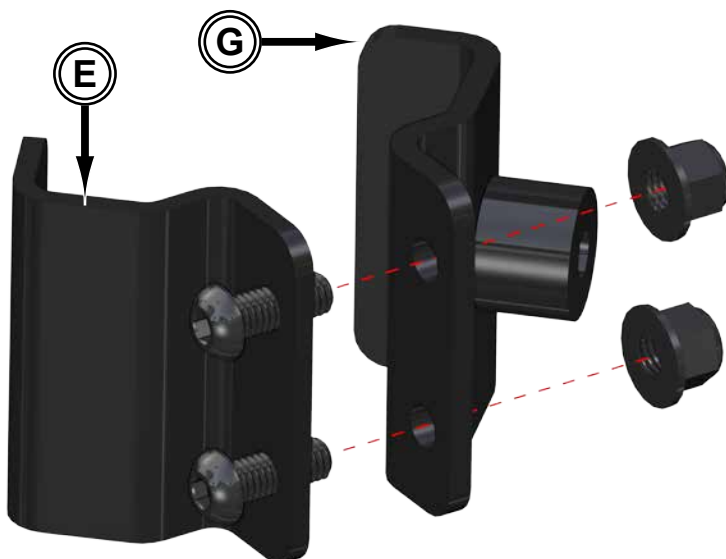

## Strut (C) Installation

- Install Strut (C) to Left Strut Bracket (G).
- Repeat for Right Strut Bracket (F).



- Open Windshield (A) to just under 90° and secure Strut (C) to Lower Frame (H) with M8 Nylock Nut.

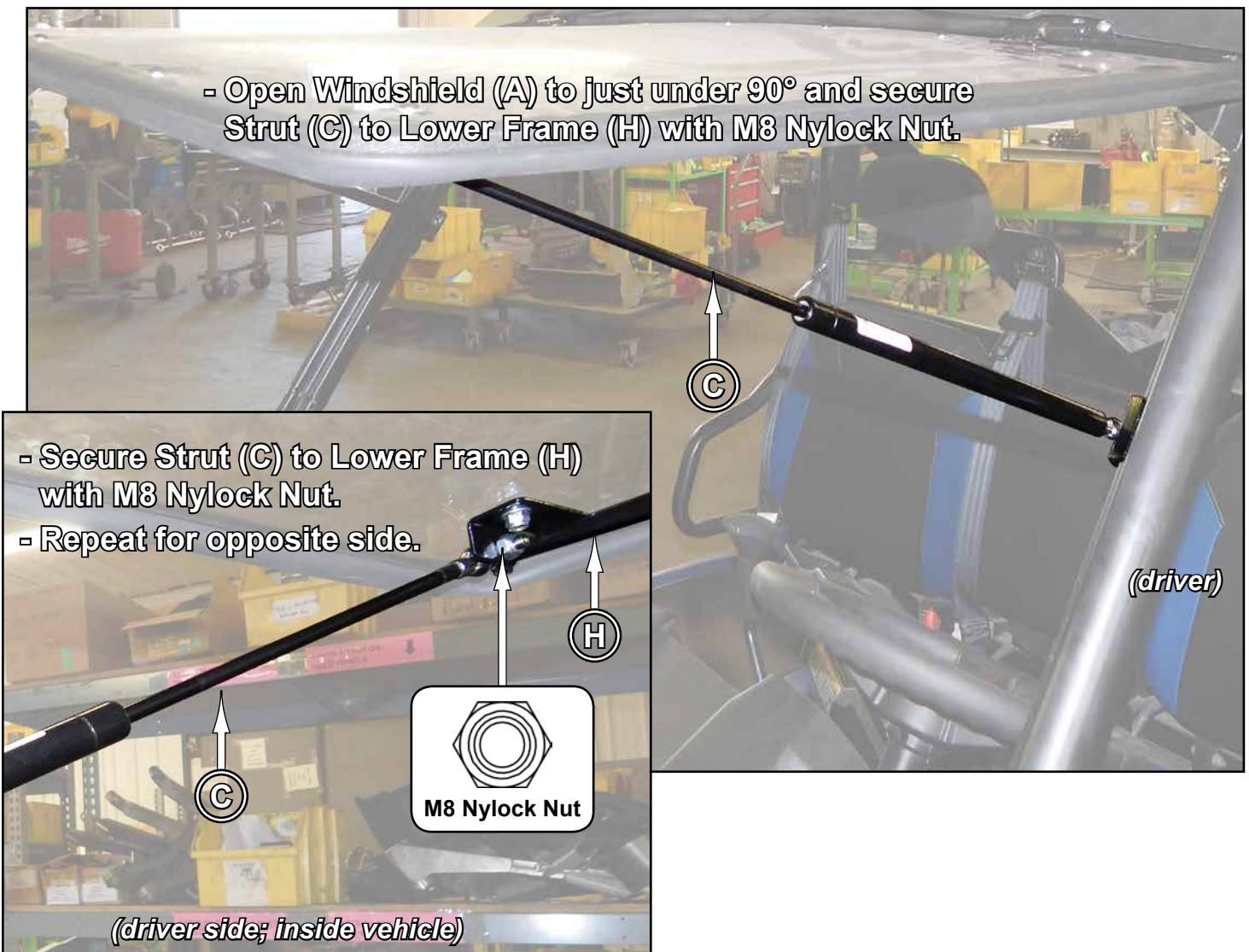



Extra hands are recommended for following steps:

- Close Windshield (A).
- Ensure that Windshield (A) is aligned to machine and Seal is in contact with Dash and Cage Frame as shown.
- ***Tighten all hardware completely.***



## Catch (D) installation

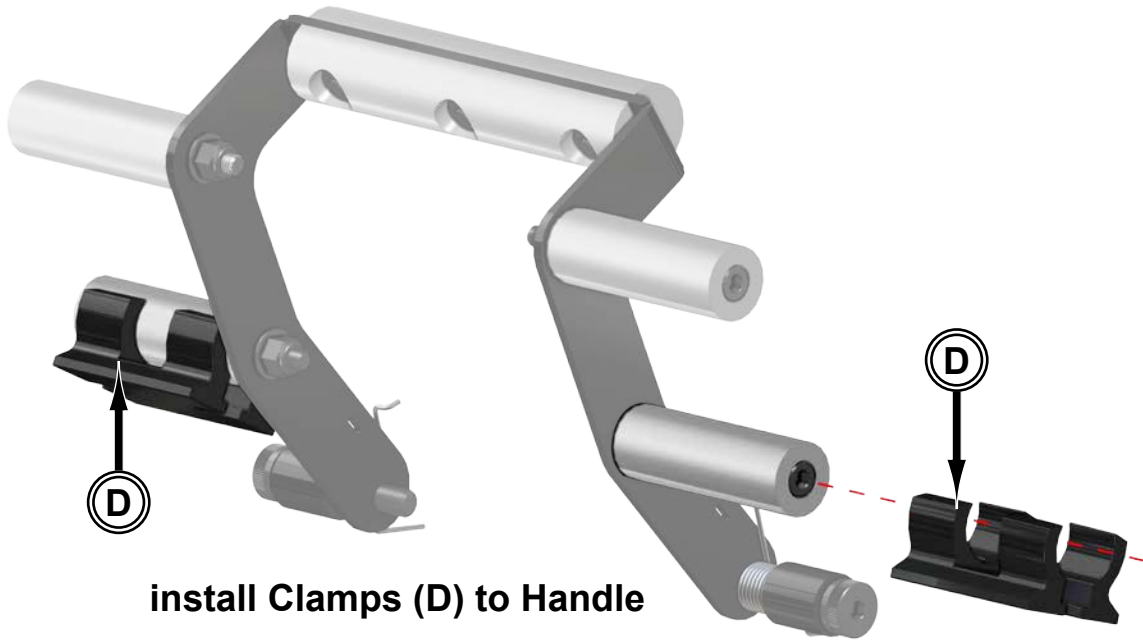

**install Clamps (D) to Handle**

- Close Windshield (A).
- Ensure that Windshield (A) is aligned to machine and Seal is in contact with Dash as shown.
- Mark location of Clamps (D) onto Dash.
- Open Windshield (A).
- Remove Dash and drill holes where Clamp (D) hardware will install.

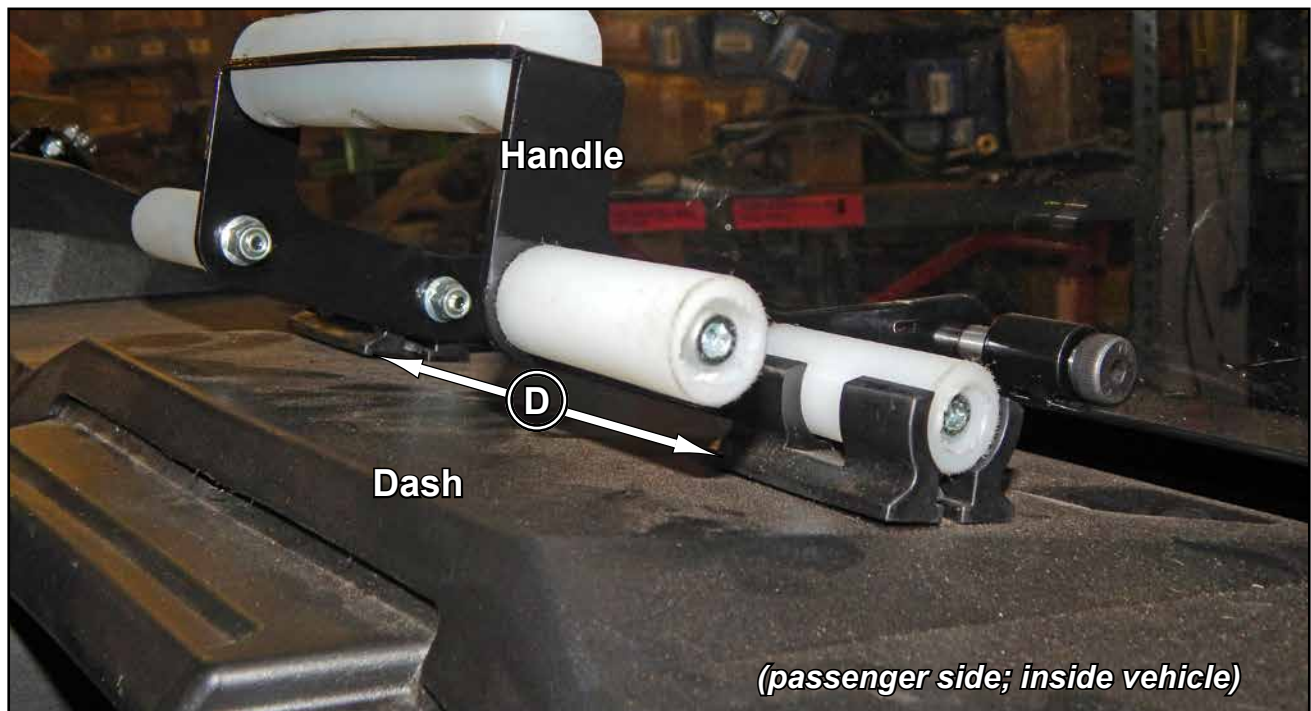

## Catch (D) installation continued

- Secure Clamps (D) with hardware shown. Tighten hardware completely and reinstall Dash to machine.

