



P.O. Box 1719
 Corona, CA 92878
 Support: 951-493-7100
 www.aFeFilters.com

Intake Kit Installation Instructions: Toyota Tacoma / 4Runner / FJ '03-'07 V6-4.0L

Kit Part #	51/54-81162 / 75-81162		Tools Required:	Part List:	1) Clamp #048	2) Nylon spacers
Make:	Toyota		5/16" nut driver	1) Air Filter Replacement P/N (24-91021, Pro Guard 7 72-90044 or Pro Dry S 21-90044)	1) 15.5" trim seal	1) Isolation mount, M8
Model	Year	Engine	10mm socket w/ extension and ratchet	1) Intake tube	9) Button head M6x1x10	1) Nut, M8
Tacoma	2005-2007	V6 - 4.0L	12mm socket w/ extension and ratchet	1) Housing	1) 16" Length 5/32" Hose	1) Cover, aluminum
FJ	2007	V6 - 4.0L	13mm socket w/ extension and ratchet	1) Coupler, reducer	1) Washer, M8	1) Brass fitting, hose 3/16x1/8
4Runner	2003-2007	V6 - 4.0L	Flat head/slotted screwdriver	1) Clamp #052	2) Screws M4, MAF sensor	1) Coupler, hump
			5/32" allen wrench	1) Clamp #072	1) Gasket, MAF sensor	
					1) adapter, filter	



Complete kit with parts.

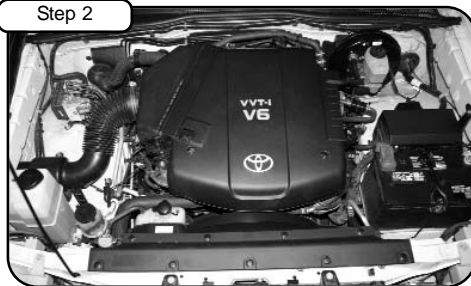

Complete stock intake.



Remove engine cover with 10mm socket. With 10mm socket remove the 2 bolts holding in OE airbox. Disconnect the MAF sensor.

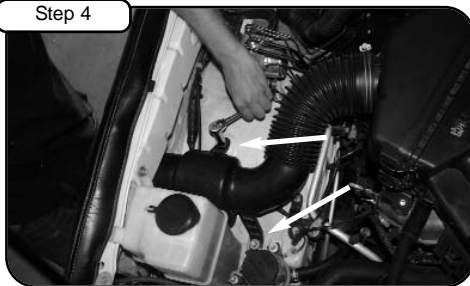

With 12mm socket, loosen the two bolts holding in OE intake snorkel.

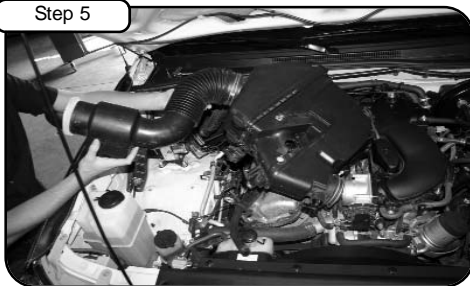

Disconnect vacuum and valve cover vent line. Remove OE intake out of vehicle. (Remove and save the two OE rubber grommets & spacers that hold in air box from step 3)

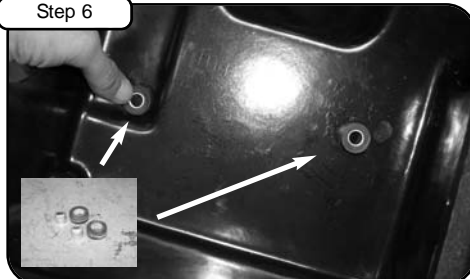

With grommets removed from OE intake, place on to new housing with metal spacers.



With 10mm socket with extension, remove bolt holding AC bracket. Insert M8 isolation mount and hand tighten firmly. (It may be necessary to clean the threads of undercoating or paint)

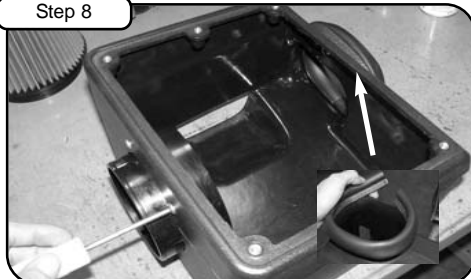

Place 5/2" adapter in to housing. Use M6 button head screws provided and tighten using 5/32" allen key. Place 3/4" bulb seal on to side vent of housing.



Place housing in to vehicle and tighten using 12mm socket or wrench. With M8 nut & washer provided tighten down housing on to isolation mount with 13mm wrench.



Remove MAF sensor from OE airbox using phillips screwdriver. Re-install to new aFe tube with hardware provided (make sure gasket and nylon spacers are between tube and sensor) using flat head screwdriver. Install brass hose fitting.



Place couplers on to tube with clamps provided, and install loose to allow repositioning.



Remove M6 insert from OE air box, loosen using adjustable wrench. Re-install on to new tube and tighten. Connect large vent hose and connect small vent hose (5/32" hose provided) between tube and fuel regulator.



Place high FLOW filter into housing and tighten using 5/16" nut driver. Place cover on to housing using button head screws provided, tighten using 5/32" allen key. (place filter into housing at slight angle)



Temporarily install engine cover and position tube to align stud from step 12. Tighten coupler clamps and then tighten engine cover nut using 10mm socket.



Your installation is now complete. Check all clamps and hoses periodically. Thank you for choosing aFe!

Note: Filter Cleaning and Re-oiling: When cleaning your aFe filter, be sure to use only aFe's "Restore Kit" (aFe P/N: 90-50001 blue oil aerosol, or aFe P/N: 90-50501 blue squeeze bottle oil or aFe P/N: 90-50000 gold oil aerosol, or aFe P/N: 90-50500 gold squeeze bottle oil).
 Filter Replacement: Magnum FLOW PN: 24-91021 (black w/blue media) or ProGUARD 7™ PN: 72-90044 Pro Dry S P/N 21-90044 (black w/white media) Pro Dry S cleaning: see cleaning instruction sheet 06-00074